



6,000 - 8,000 SF  
Industrial facility

# For sublease

10000 6<sup>th</sup> Street SW | Cedar Rapids, Iowa 52404



## Availability overview

Available: 6,000 - 8,000 SF

Total building size: 20,025 SF

Sublease rate: \$15.00/SF/Year/Gross

Sublease expiration: 9/30/2029

- Dock doors: 3-5
- Clear height: 30'
- Office space
- Close proximity to Interstate 380
- Minutes away from the Eastern Iowa Airport

# 6th Street SW



Images / Floor plan

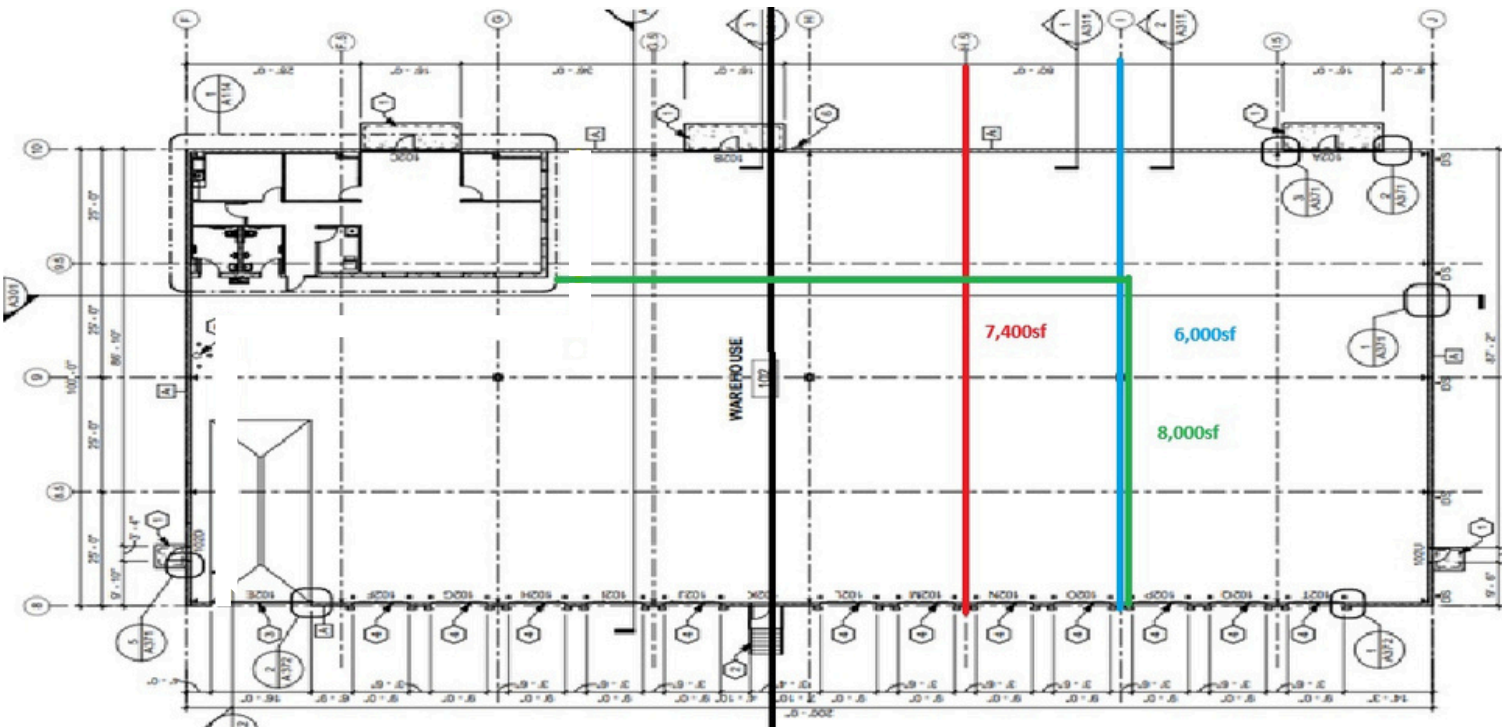

# 6th Street SW

Cedar Rapids, Iowa 52404

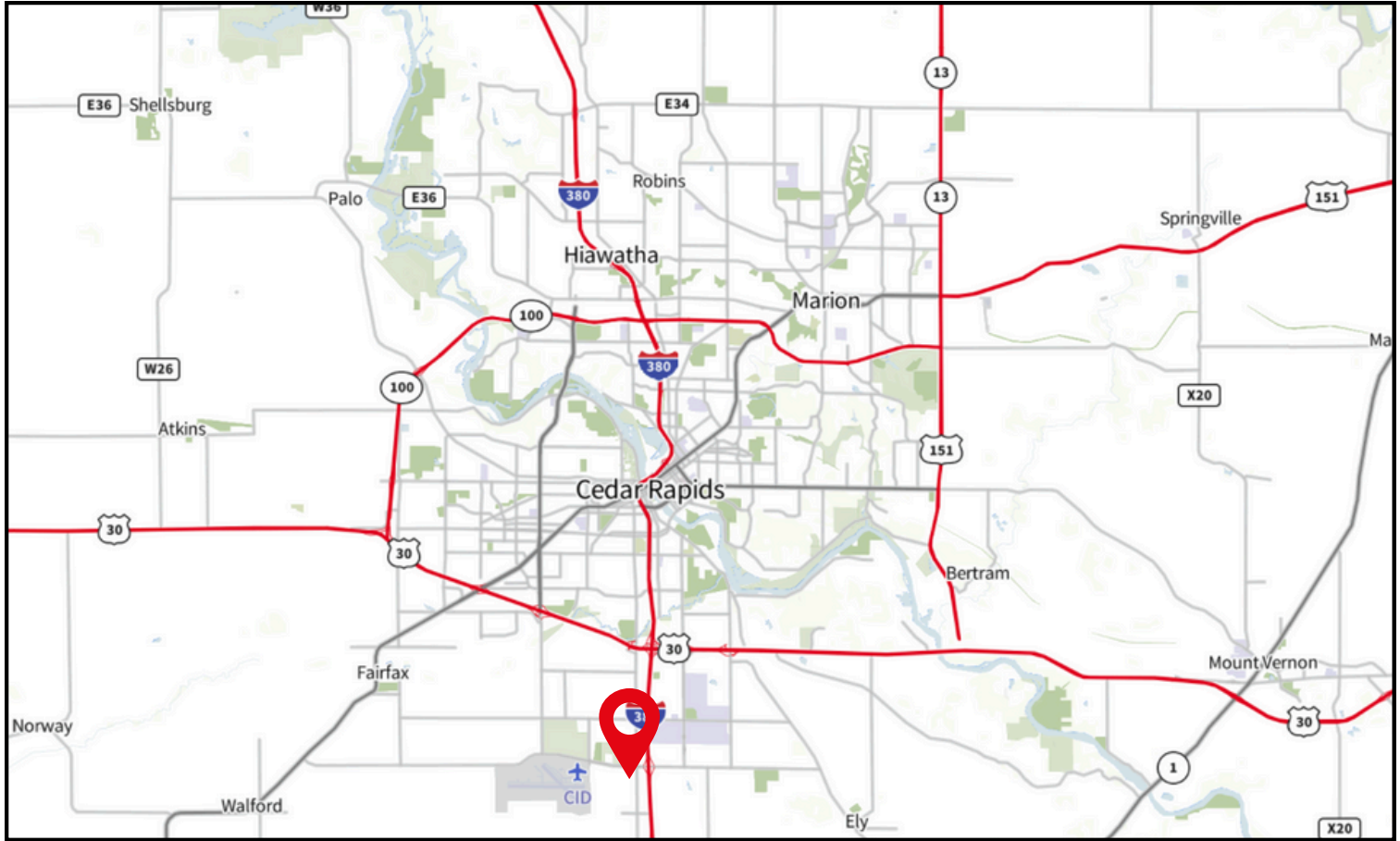

## Contact

### Michael Minard, CCIM

Senior Vice President  
+1 563 508 4649  
michael.minard@jll.com

### Jack High

Analyst  
+1 319 899 9992  
jack.high@jll.com

[jll.com/des-moines](https://jll.com/des-moines)

Jones Lang LaSalle Americas, Inc., a licensed real estate broker in 48 states | DISCLAIMER Although information has been obtained from sources deemed reliable, neither Owner nor JLL makes any guarantees, warranties or representations, express or implied, as to the completeness or accuracy as to the information contained herein. Any projections, opinions, assumptions or estimates used are for example only. There may be differences between projected and actual results, and those differences may be material. The Property may be withdrawn without notice. Neither Owner nor JLL accepts any liability for any loss or damage suffered by any party resulting from reliance on this information. If the recipient of this information has signed a confidentiality agreement regarding this matter, this information is subject to the terms of that agreement. ©2025. Jones Lang LaSalle IP, Inc. All rights reserved.