

23.8 ACRES CHESTNUTHILL TWP., Monroe County PA



1628 SR 209, Brodheadsville, PA 18322

List Price \$1,575,000

- 500' of frontage along SR209**
- Zoned GC**
- Flood Zone X**
- Parcel # 02/9/1/41**
- Public Utilities are limited to electric**
- Site requires on site septic and private well**

- Traffic counts in excess of 19,000 VPD**
- Close proximity to Interstate 476 & Interstate 80**
- 90 miles from both New York & Philadelphia**



www.joamatoproperties.com

Liana M. Kissinger

Chief Operating Officer

570-287-5343

Liana@joamatoproperties.com

Pleasant Valley Town Centre

Chestnuthill Township
Monroe County
Pennsylvania

1. THE DATE OF THE PLAN SHALL BE THE DATE OF THE PLAN.
2. THE DATE OF THE PLAN SHALL BE THE DATE OF THE PLAN.
3. THE DATE OF THE PLAN SHALL BE THE DATE OF THE PLAN.
4. THE DATE OF THE PLAN SHALL BE THE DATE OF THE PLAN.
5. THE DATE OF THE PLAN SHALL BE THE DATE OF THE PLAN.
6. THE DATE OF THE PLAN SHALL BE THE DATE OF THE PLAN.
7. THE DATE OF THE PLAN SHALL BE THE DATE OF THE PLAN.
8. THE DATE OF THE PLAN SHALL BE THE DATE OF THE PLAN.
9. THE DATE OF THE PLAN SHALL BE THE DATE OF THE PLAN.
10. THE DATE OF THE PLAN SHALL BE THE DATE OF THE PLAN.

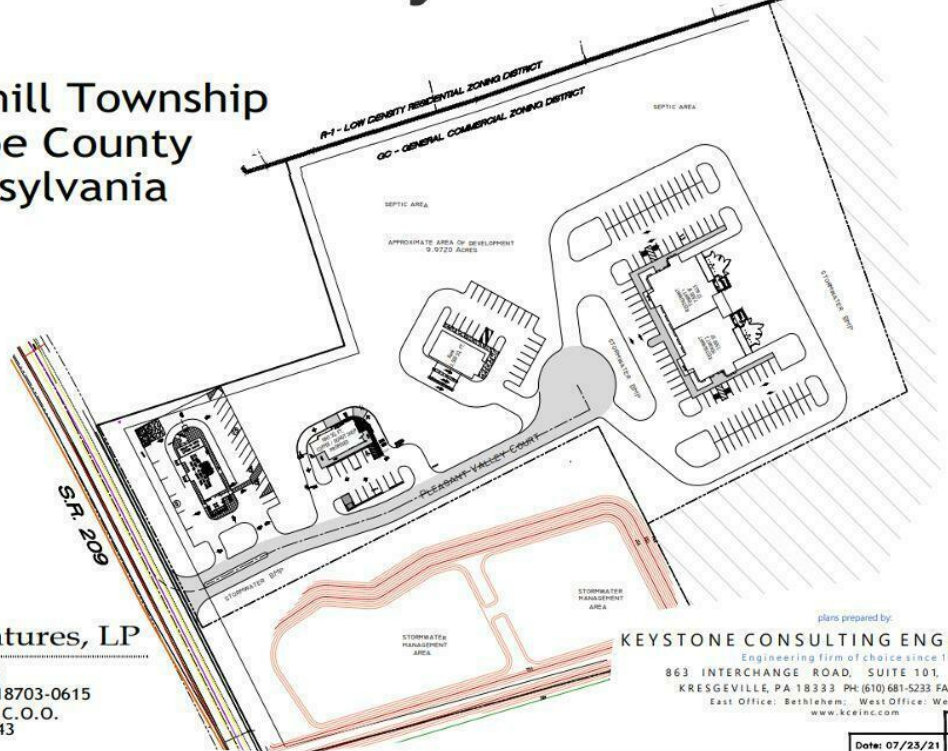

Joe Amato Ventures, LP
P.O. Box 615
Wilkes Barre, PA 18703-0615
Liana Kissinger, C.O.O.
570-287-5343

plans prepared by:
KEYSTONE CONSULTING ENGINEERS, INC.
Engineering firm of choice since 1972.
863 INTERCHANGE ROAD, SUITE 101, P.O. BOX 639
KRESGEVILLE, PA 18333 PH: (610) 681-5233 FAX: (610) 681-5248
East Office: Bethlehem, West Office: Woxcoville
www.kceinc.com

File Number: CN-21-040
Date: 07/23/21
Revised Date:



www.joamatoproperties.com

