

# HIGH IMAGE FREESTANDING BUILDING

8930 CENTER AVENUE | RANCHO CUCAMONGA | CALIFORNIA

LEASE RATE  
**\$1.45/SF**  
**GROSS**



**AVAILABLE FOR LEASE**  
**±10,452 SQUARE FEET**

 [JONESINDUSTRIALTEAM.COM](http://JONESINDUSTRIALTEAM.COM)

PLEASE CONTACT:

**JONES**  
INDUSTRIAL TEAM

**KEN JONES, SIOR**  
Senior Vice President/Principal  
[kjones@lee-assoc.com](mailto:kjones@lee-assoc.com)  
909.373.2726  
DRE # 01703262

**BEN PALITZ**  
Senior Associate  
[bpalitz@lee-assoc.com](mailto:bpalitz@lee-assoc.com)  
909.373.2910  
DRE # 02093182

**COLE MCFETTERS**  
Associate  
[cmcfetters@lee-assoc.com](mailto:cmcfetters@lee-assoc.com)  
909.373.2733  
DRE #02203508

3535 Inland Empire Boulevard | Ontario | California 91764 | 909-989-7771 | [lee-associates.com](http://lee-associates.com) | Corporate DRE #: 00976995

All information furnished regarding property for sale, rental or financing is from sources deemed reliable, but no warranty or representation is made to the accuracy thereof and same is submitted to errors, omissions, change of price, rental or other conditions prior to sale, lease or financing or withdrawal without notice. No liability of any kind is to be imposed on the broker herein.

 **LEE & ASSOCIATES**  
COMMERCIAL REAL ESTATE SERVICES

# PROPERTY OVERVIEW

## KEY HIGHLIGHTS



**±10,452 SF**  
BUILDING SIZE



**±2,260 SF**  
OFFICE SPACE



**400 AMPS**  
277/480 VOLTS (VERIFY)



**16'**  
MINIMUM CLEARANCE



**TWO (2)**  
GROUND LEVEL LOADING DOORS  
(12' X 14')



**FULLY FENCED**  
AND SECURED YARD

## PROPERTY HIGHLIGHTS

- RECENTLY RENOVATED
- BUILT IN 2003
- ±0.63-ACRE PARCEL OF LAND
- HIGH IMAGE BUSINESS PARK
- 0.40 GPM / 2,000 SF SPRINKLER SYSTEM
- ±22 VEHICLE PARKING SPACES

**AVAILABLE JANUARY 01, 2026**





# SITE PLAN

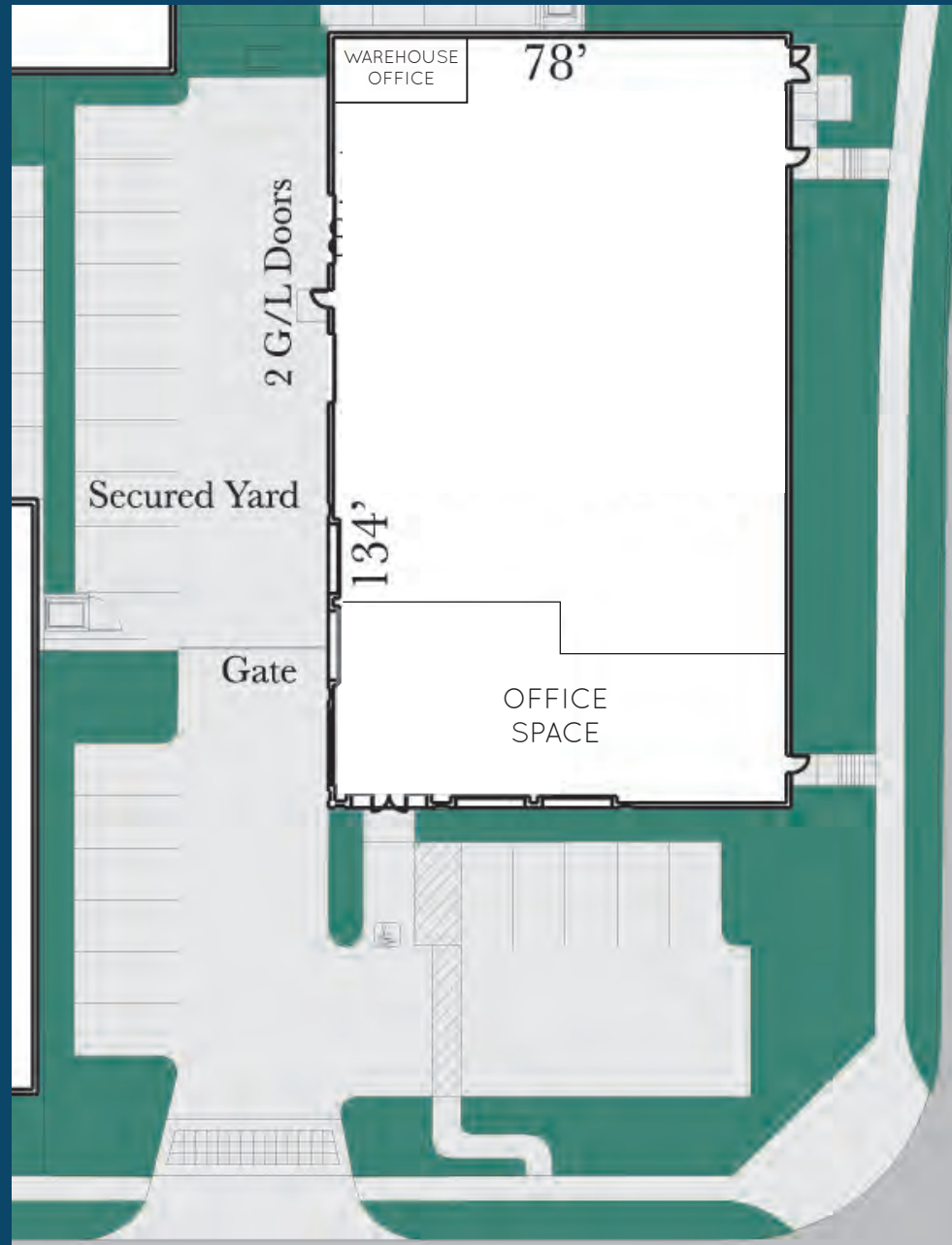

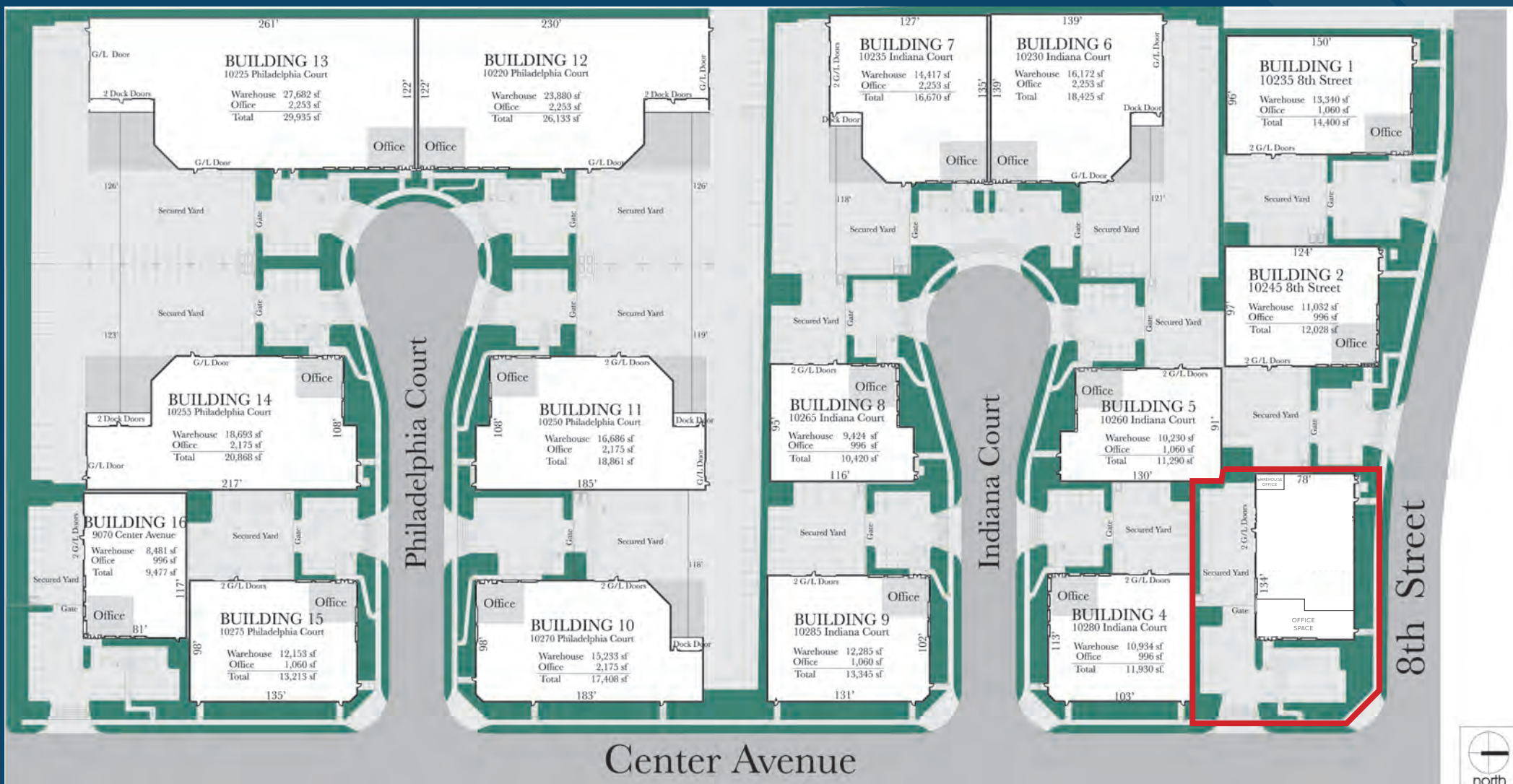

Center Avenue

8th Street





# LOCATION MAP

