

**FOR SALE**

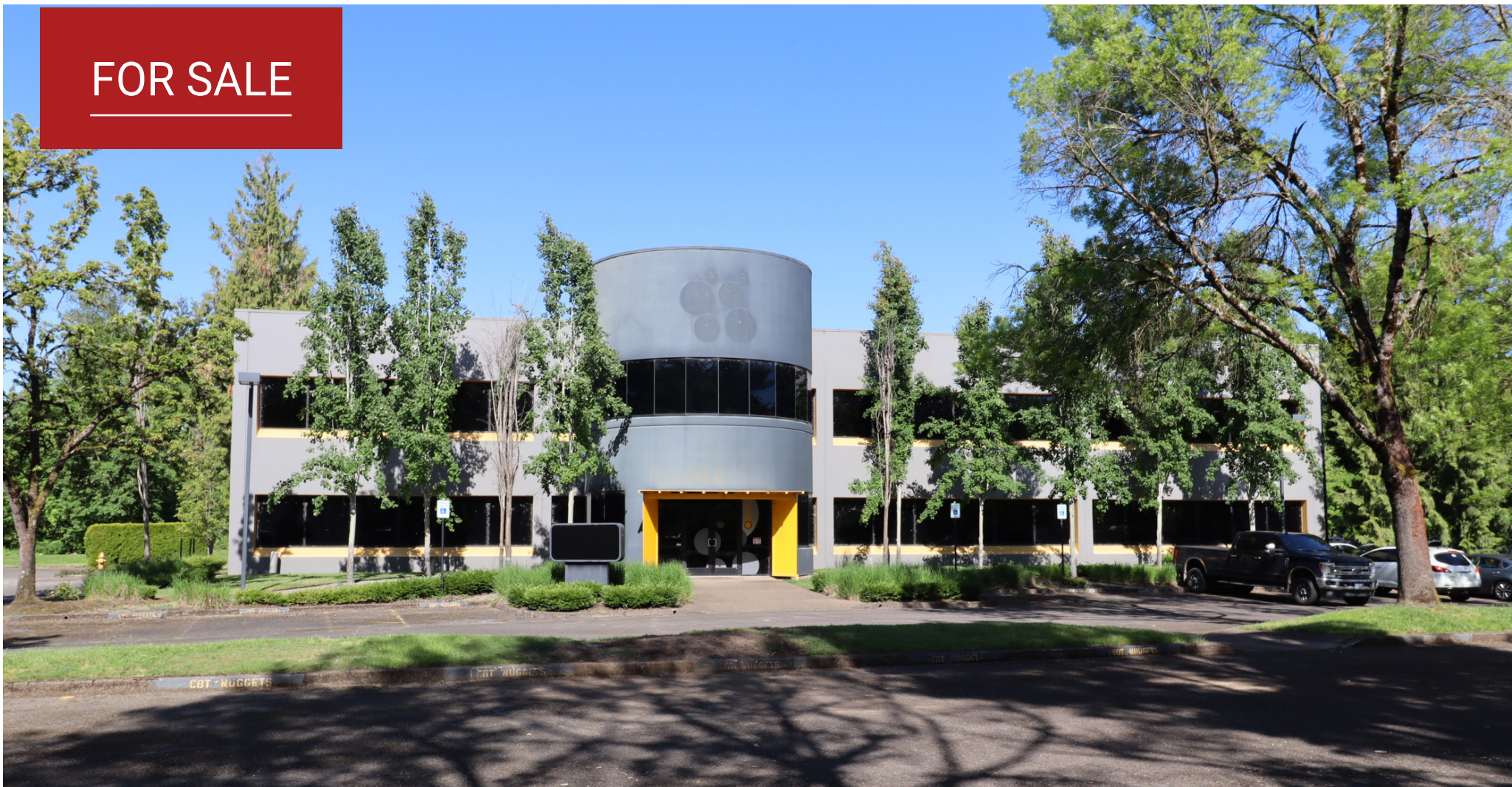

**1550 VALLEY RIVER DRIVE - EUGENE, OREGON**

**PREMIER RIVERFRONT CLASS A CORPORATE  
OFFICE BUILDING  
22,434 SQUARE FEET**

*Purchase Price: \$7,750,000*

**Campbell**  
COMMERCIAL  
REAL ESTATE  
[www.campbellre.com](http://www.campbellre.com)

*For more information, contact:*

**TIM CAMPBELL**  
[timc@campbellre.com](mailto:timc@campbellre.com) | (541) 484-2214  
Licensed in the State of Oregon

**BILL NEWLAND**  
[bill@campbellre.com](mailto:bill@campbellre.com) | (541) 484-2214  
Licensed in the State of Oregon

The information in this package was obtained from sources deemed reliable, and is not guaranteed by agent. Package is subject to change, error or omission, prior sale or lease, correction or withdrawal. Any party contemplating purchase is urged to conduct their own independent study and inspection.



# Class A Office Building

1550 VALLEY RIVER DRIVE - EUGENE, OR

**1550 VALLEY RIVER DRIVE** is the iconic corporate office building that has been completely modernized. Formerly occupied by CBT Nuggets, this Class A building is arguably one of the nicest office spaces in the Eugene area. Located in the Valley River area and along the Willamette River, the property sits minutes from downtown and is surrounded by dining, shopping, and outdoor recreation amenities. This building is a must have for a corporate office.



## Modern corporate office building available for sale

22,434 SQUARE FEET

2-STORY BUILDING

OPEN OFFICE LAYOUT WITH MEETING  
ROOMS AND PRIVATE OFFICES

TENANT LOUNGE / KITCHEN AREA

MULTI-PURPOSE CONFERENCE ROOMS

WORKOUT FACILITY

DETACHED MEETING / CONFERENCE ROOM

OUTDOOR PATIO

ELEVATOR SERVED

WATERFRONT VIEWS

SURFACE PARKING

**SALE PRICE: \$7,750,000**

# FIRST FLOOR

1550 VALLEY RIVER DRIVE - EUGENE, OR



The information in this package was obtained from sources deemed reliable, and is not guaranteed by agent. Package is subject to change, error or omission, prior sale or lease, correction or withdrawal. Any party contemplating purchase is urged to conduct their own independent study and inspection.

# SECOND FLOOR

1550 VALLEY RIVER DRIVE - EUGENE, OR

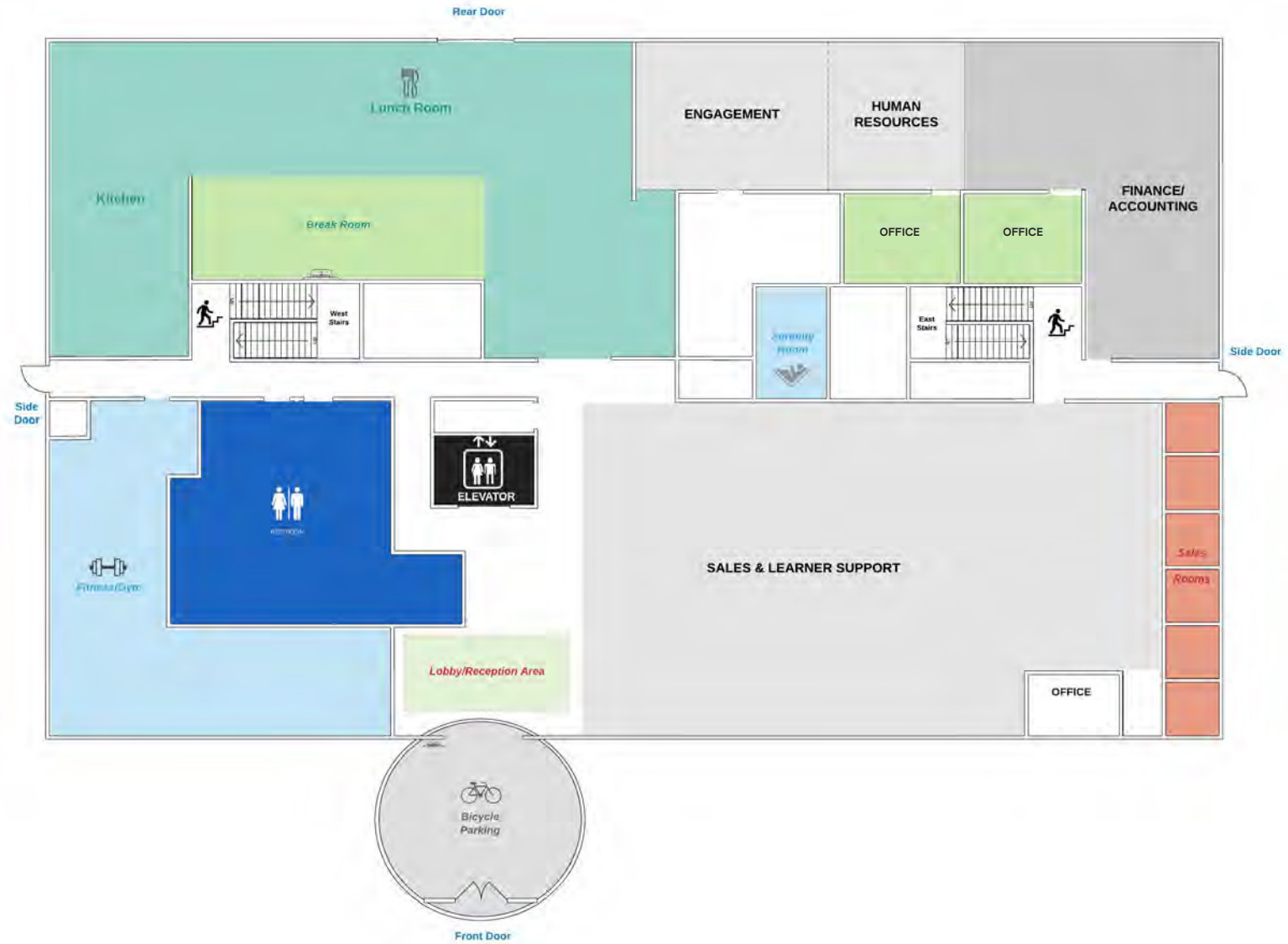

The information in this package was obtained from sources deemed reliable, and is not guaranteed by agent. Package is subject to change, error or omission, prior sale or lease, correction or withdrawal. Any party contemplating purchase is urged to conduct their own independent study and inspection.



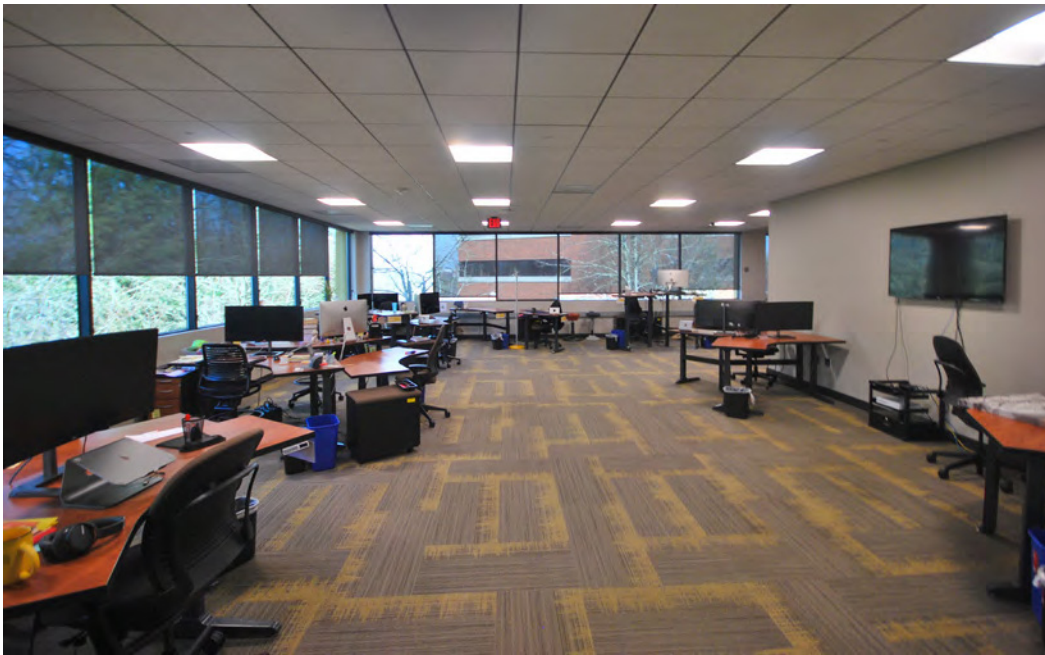

The information in this package was obtained from sources deemed reliable, and is not guaranteed by agent. Package is subject to change, error or omission, prior sale or lease, correction or withdrawal. Any party contemplating purchase is urged to conduct their own independent study and inspection.





The information in this package was obtained from sources deemed reliable, and is not guaranteed by agent. Package is subject to change, error or omission, prior sale or lease, correction or withdrawal. Any party contemplating purchase is urged to conduct their own independent study and inspection.





The information in this package was obtained from sources deemed reliable, and is not guaranteed by agent. Package is subject to change, error or omission, prior sale or lease, correction or withdrawal. Any party contemplating purchase is urged to conduct their own independent study and inspection.



# AERIAL TENANT MAP

1550 VALLEY RIVER DRIVE - EUGENE, OR



The information in this package was obtained from sources deemed reliable, and is not guaranteed by agent. Package is subject to change, error or omission, prior sale or lease, correction or withdrawal. Any party contemplating purchase is urged to conduct their own independent study and inspection.



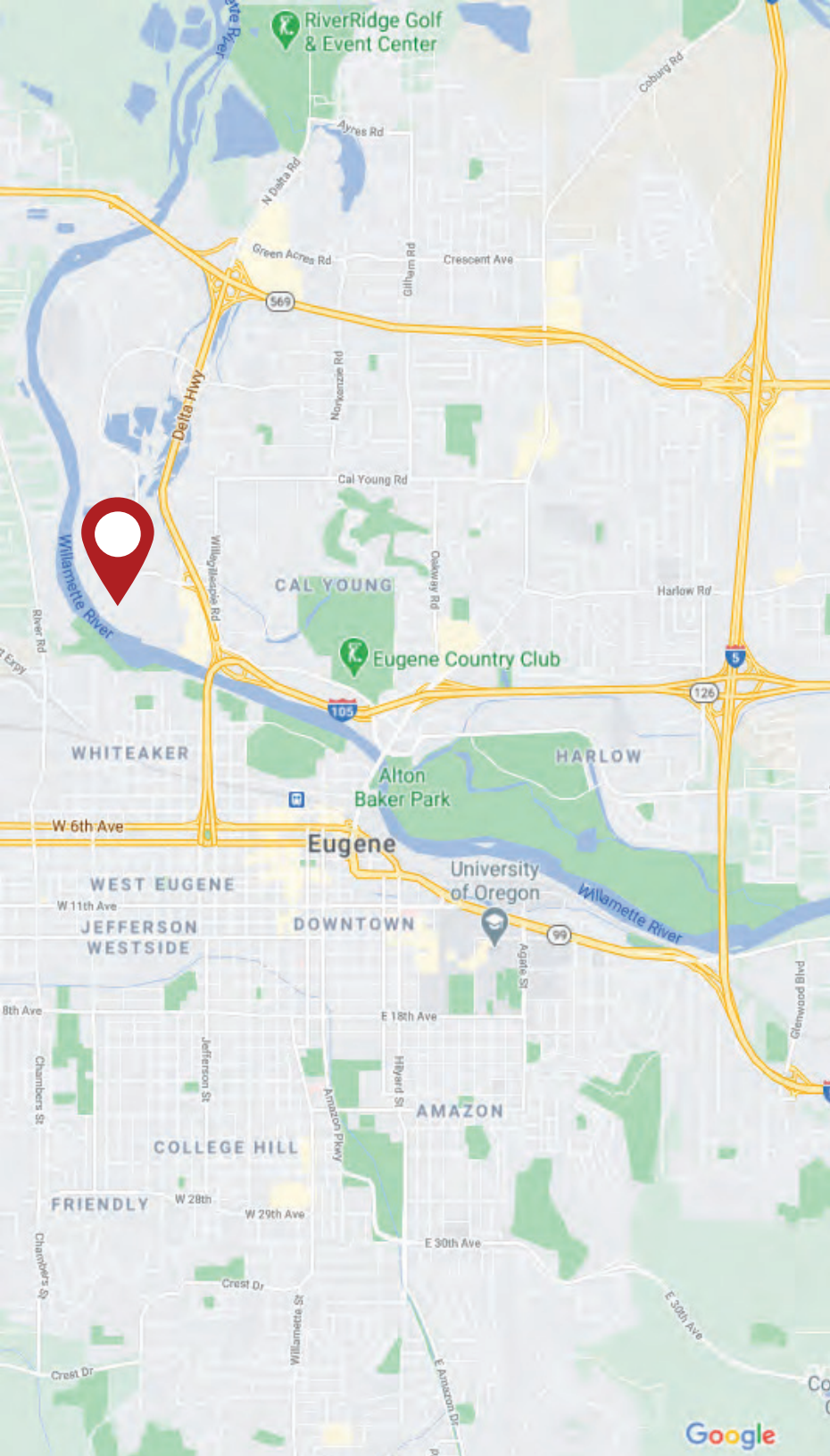

## PREMIER RIVERFRONT CLASS A CORPORATE OFFICE BUILDING

1550 VALLEY RIVER DRIVE  
EUGENE, OREGON 97401

*For more information contact:*

**TIM CAMPBELL**  
timc@campbellre.com | (541) 484-2214  
Licensed in the State of Oregon

**BILL NEWLAND**  
bill@campbellre.com | (541) 484-2214  
Licensed in the State of Oregon

**Campbell**  
COMMERCIAL  
REAL ESTATE

701 High Street, Suite 300  
Eugene, Oregon 97401  
www.campbellre.com