



**PINNACLE  
REALTY**  
OF NEW YORK, LLC

EXCLUSIVE LISTING

**FOR LEASE**



**2095 SOUTHERN BLVD.**

**BRONX, NY 10460**

# Ground Lease or Built to Suit Retail Land for Lease

Densely Populated and  
Heavily Trafficked Location.

Type  
**Land / Retail**



SQUARE FOOT

**19,500** RSF



ZONING

**R7-1/  
C1-4**



PARCEL ID

**3108**  
BLOCK



**8**  
LOT

PRICE

**Upon Request**

**718-784-8282 / PINNACLERENY.COM**

All information is from sources deemed reliable and is submitted subject to errors, omission, changes of price or other conditions, prior sale, rent and withdrawal without notice.

# Property Overview

## Features

- Built-to-Suit or Ground Lease
- Estimated 13,000 Vehicles Per Day
- One of the Most Densely Populated Areas of the Country
- Approximately 74,117 Residents per Square Mile

## Nearby

- Bronx Zoo
- Bronx Botanical Gardens
- Yankee Stadium
- St. Barnabas Hospital
- Fordham University
- Little Italy

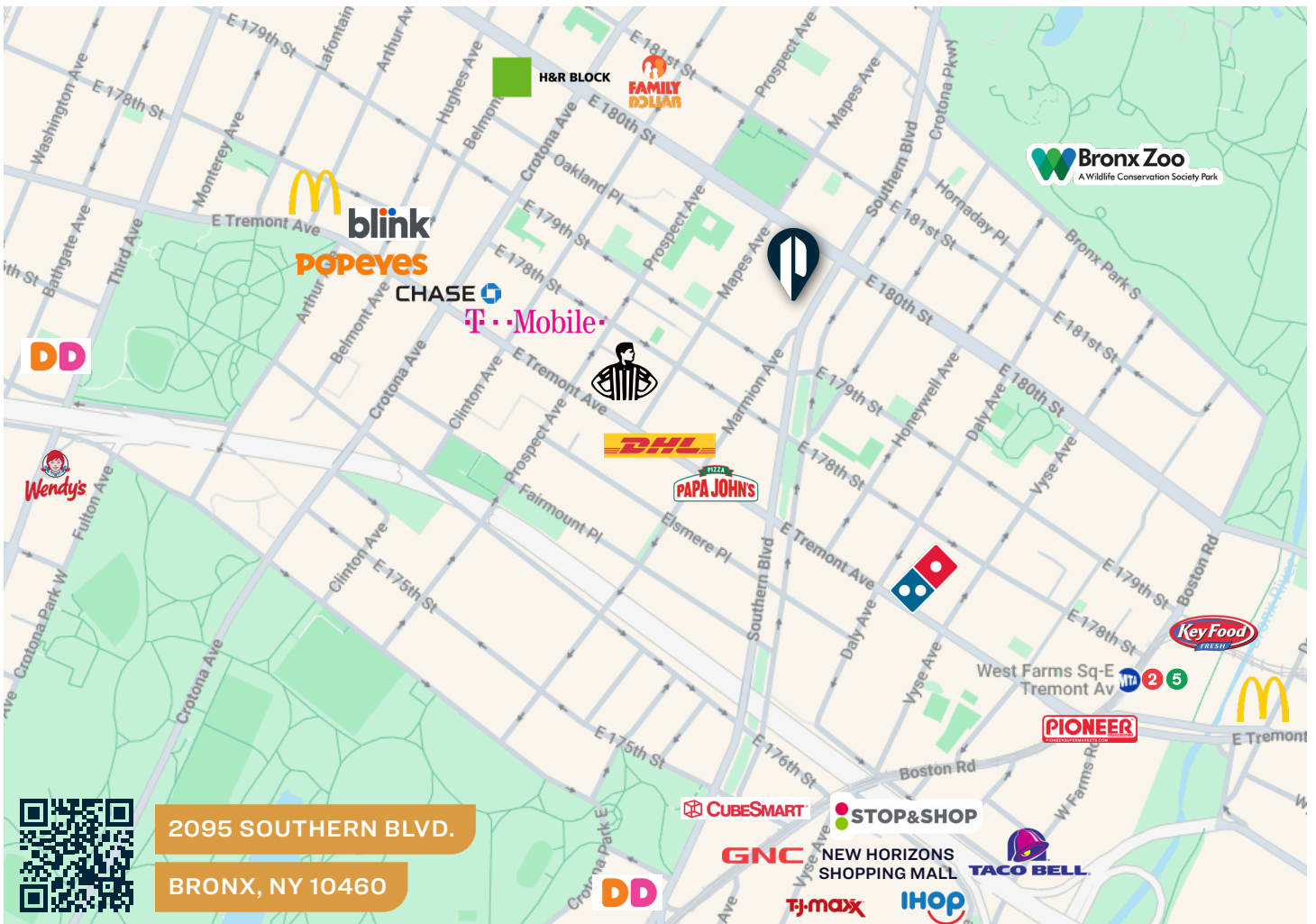

2095 SOUTHERN BLVD.

BRONX, NY 10460

## TRANSPORTATION

**2 5** E 180 STREET



I-27  
I-95: CROSS  
BRONX EXPY  
BRONX RIVER  
PKWY



BX19: SOUTHERN  
BLVD/E 180 ST  
BX40, BX42:  
E 180 ST/  
SOUTHERN BLVD



718-784-8282 / PINNACLERENY.COM

All information is from sources deemed reliable and is submitted subject to errors, omission, changes of price or other conditions, prior sale, rent and withdrawal without notice.



## PICTURES



## SITE PLAN

### POTENTIAL 6,500 SQUARE FOOT BUILDING SET BACK WITH PARKING

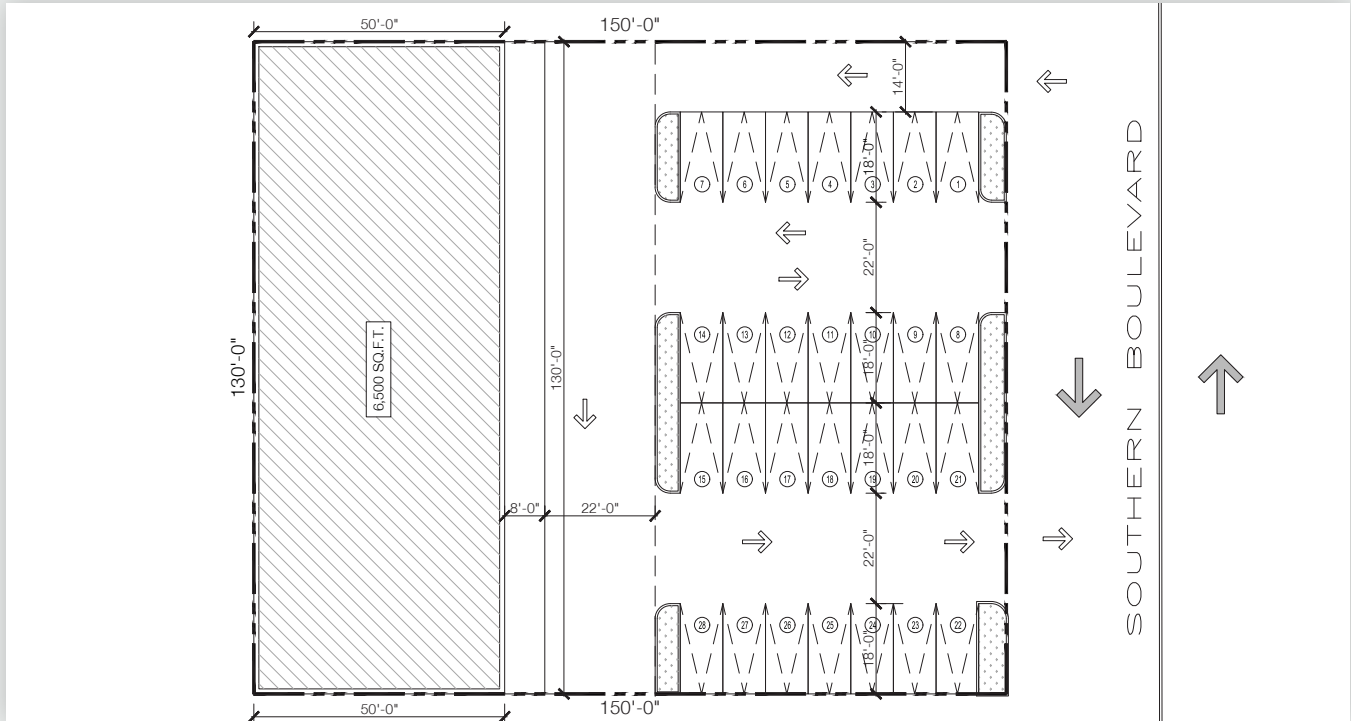

### POTENTIAL DRIVE-THROUGH BUILDING WITH PARKING

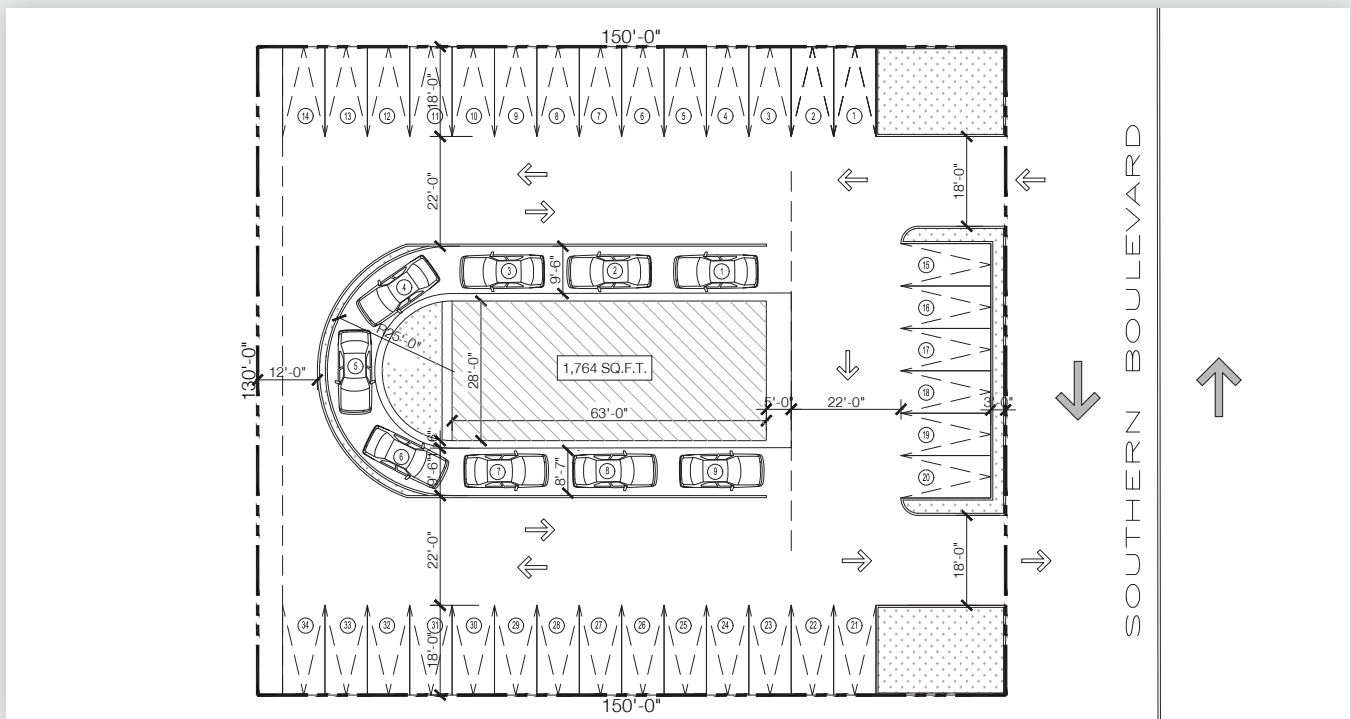

## SITE PLAN

### POTENTIAL DRIVE-THROUGH BUILDING WITH PARKING

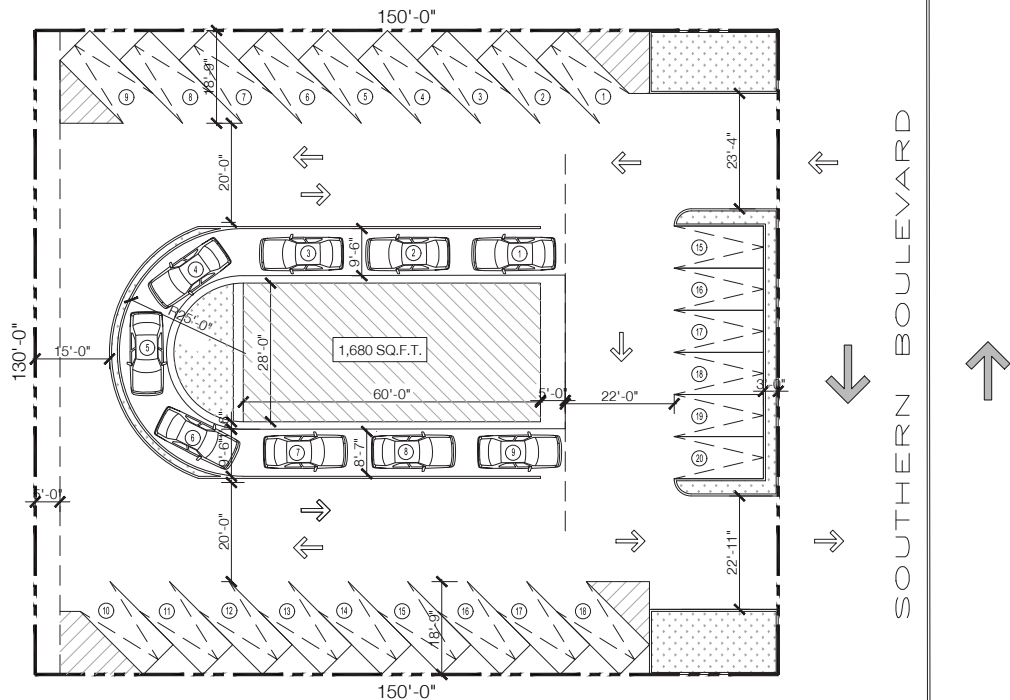

**PINNACLE  
REALTY**  
OF NEW YORK, LLC

34-07 Steinway Street, Suite 202  
Long Island City, NY 11101  
718-784-8282  
[pinnaclereny.com](http://pinnaclereny.com)

FOR MORE INFORMATION ABOUT THIS PROPERTY CONTACT EXCLUSIVE AGENTS:

**PAUL BRALOWER**  
Associate Broker  
[pbralower@pinnaclereny.com](mailto:pbralower@pinnaclereny.com)  
718-371-6402

**FEDERICO MAZZEO**  
Salesperson  
[fmazzeo@pinnaclereny.com](mailto:fmazzeo@pinnaclereny.com)  
718-371-6424

**BRENDAN BURKE**  
Associate Broker  
[bburke@pinnaclereny.com](mailto:bburke@pinnaclereny.com)  
718-371-6403

**ARIEL CASTELLANOS**  
Associate Broker  
[acastellanos@pinnaclereny.com](mailto:acastellanos@pinnaclereny.com)  
718-371-6412

**FREDRIC STEIN**  
Associate Broker  
[fstein@pinnaclereny.com](mailto:fstein@pinnaclereny.com)  
718-371-6409