

# Concourse 100

100 Concourse Parkway, Hoover, AL 35244

1,850 - 4,847 Sq Ft

Office/Medical - For Lease



## Location



## Property Highlights

- Available Suites from 1,850 Sq. Ft. to 4,847 Sq. Ft.
- Build-to-Suit Suites - Ideal for office and/or medical.
- Building common conference room.
- Great suburban setting, beautiful lake surrounded by walking trail and lake views.
- In the City of Hoover (Shelby County) no occupational tax.
- Minutes from Valleydale Road, Hwy 31 & I-65.
- Rates: \$19.50 Sq. Ft./Yr (including utilities, janitorial (net of telco/inet); Full Service).

**NAI Chase Commercial**

Commercial Real Estate Services, Worldwide.

3100 Lorna Road, Suite 100, Birmingham, AL, 35216  
www.chasecommercial.com

Randy Thomas

thomasr@chasecommercial.com

C 205 229-5417

Glenn Ponder

glennponder@chasecommercial.com

C 205 356-9884

# Concourse 100

100 Concourse Parkway, Hoover, AL 35244

## Site Plan

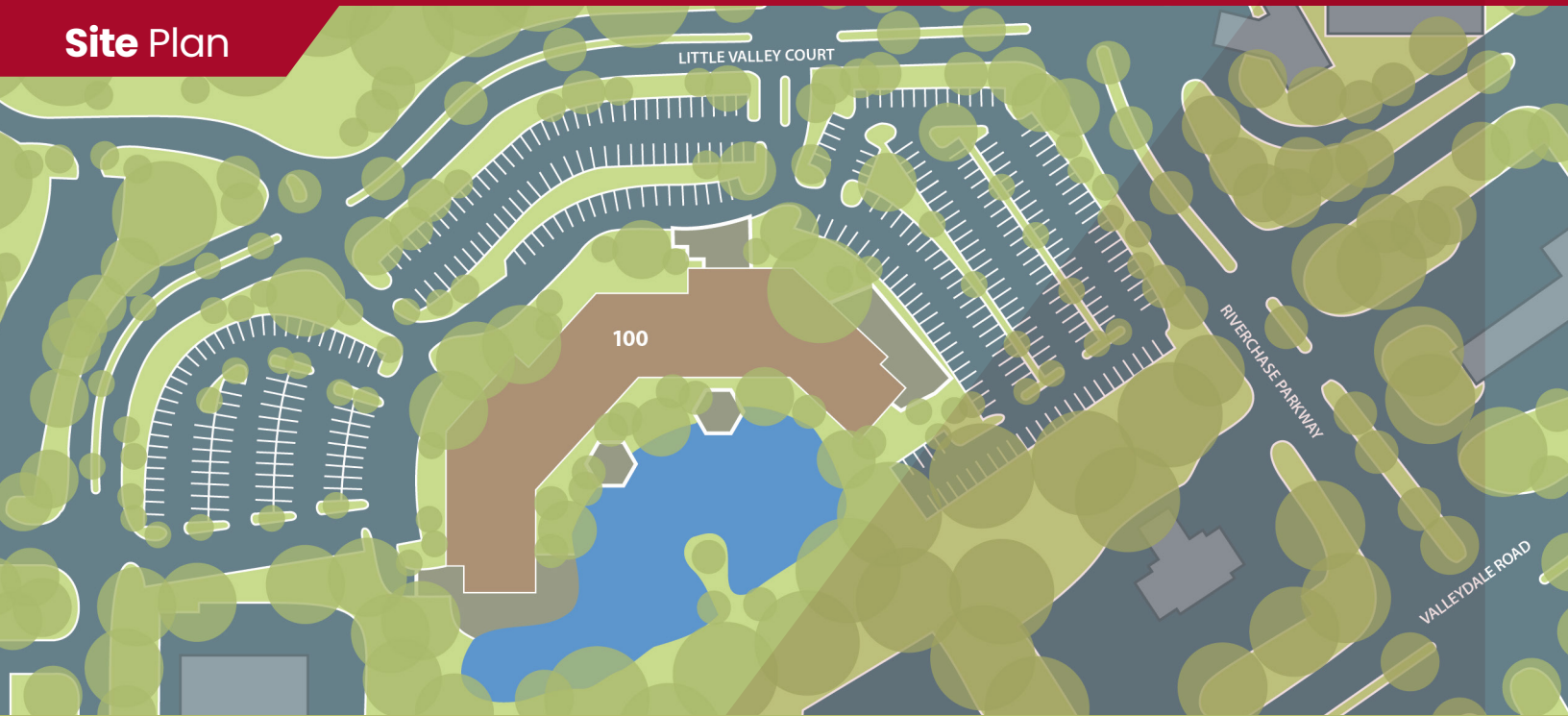

## More Information



For more information and to see other available properties, check out this listing at [chasecommercial.com](http://chasecommercial.com) or scan the QR code on your mobile device.



**NAI Chase Commercial**

Commercial Real Estate Services, Worldwide.

3100 Lorna Road, Suite 100, Birmingham, AL 35216  
[www.chasecommercial.com](http://www.chasecommercial.com)



INDIVIDUAL MEMBERSHIPS

NO WARRANTY OR REPRESENTATION, EXPRESS OR IMPLIED, IS MADE AS TO THE ACCURACY OF THE INFORMATION CONTAINED HEREIN, AND THE SAME IS SUBMITTED SUBJECT TO ERRORS, OMISSIONS, CHANGE OF PRICE, RENTAL OR OTHER CONDITIONS, PRIOR SALE, LEASE OR FINANCING, OR WITHDRAWAL WITHOUT NOTICE, AND OF ANY SPECIAL LISTING CONDITIONS IMPOSED BY OUR PRINCIPAL. NO WARRANTIES OR REPRESENTATIONS ARE PROPERTY OR HAZARDS CONTAINED THEREIN.