



125 CREMONA DRIVE

SUITE 210
GOLETA CA
93117

FOR SUBLEASE

±5,755SF CLASS A OFFICE SUITE
NEW RATE - \$5,500/Mo Gross

Strategically located in Goleta's dynamic
high-tech corridor with easy access to
US 101 Fwy, Santa Barbara Airport,
new housing projects & core amenities



MAJOR SUBLEASE RATE REDUCTION

PRESENTED BY

JUSTIN DIEM
805.879.9634
jdiem@radiusgroup.com
CA LIC. 02058176



 **RADIUS®**
Commercial Real Estate



125 Cremona Dr. presents a prime opportunity to establish a presence in one of Goleta's most premier office buildings, located in the city's tech hub. The space features a modern design and includes a kitchenette, spacious bullpen, four private offices, a conference room, and two small rooms for storage. Conveniently located between Hollister Ave and US-101, the property offers excellent accessibility along with incredible mountain views from the second floor. Contact the listing agents for showings and more information.

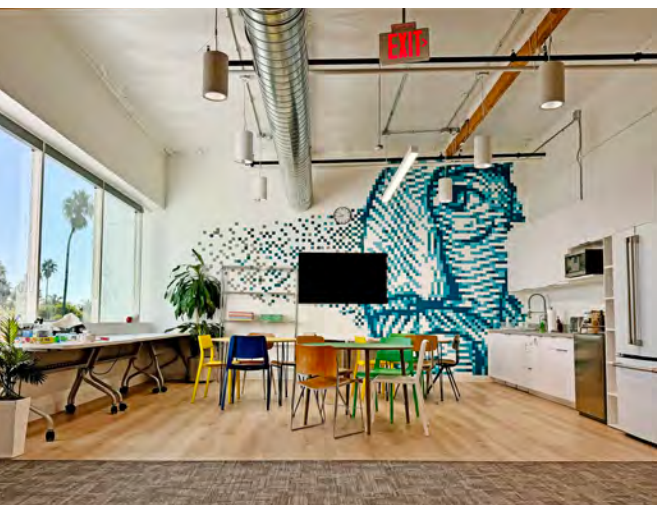

Offering Specifics

Size

±5,755 SF

New Sublease Rate

\$5,500/Month Gross

Sublease Term

Through September 30, 2026

Existing Furniture

Available

Elevator

Yes

Parking

3/1,000

Utilities

Paid by Tenant

Kitchenette

Yes

Restrooms

Common
(Common restroom in shared gym has showers)

HVAC

Yes

Fire Sprinklers

Throughout

Zoning

Business Park

© 05/20/25 Radius Group Commercial Real Estate, Inc. DRE lic. 01334755. All rights reserved. Content and/or images may not be used without permission. The information provided here has been obtained from the owner of the property or from other sources deemed reliable. We have no reason to doubt its accuracy, but we do not guarantee it.

PRESENTED BY

JUSTIN DIEM

805.879.9634

jdiem@radiusgroup.com

CA LIC. 02058176



125 CREMONA DR

SUITE 210 • GOLETA CA 93117

MAJOR SUBLEASE RATE REDUCTION

±5,755 SF Class A Office Suite Located
in Goleta's Burgeoning Tech Corridor

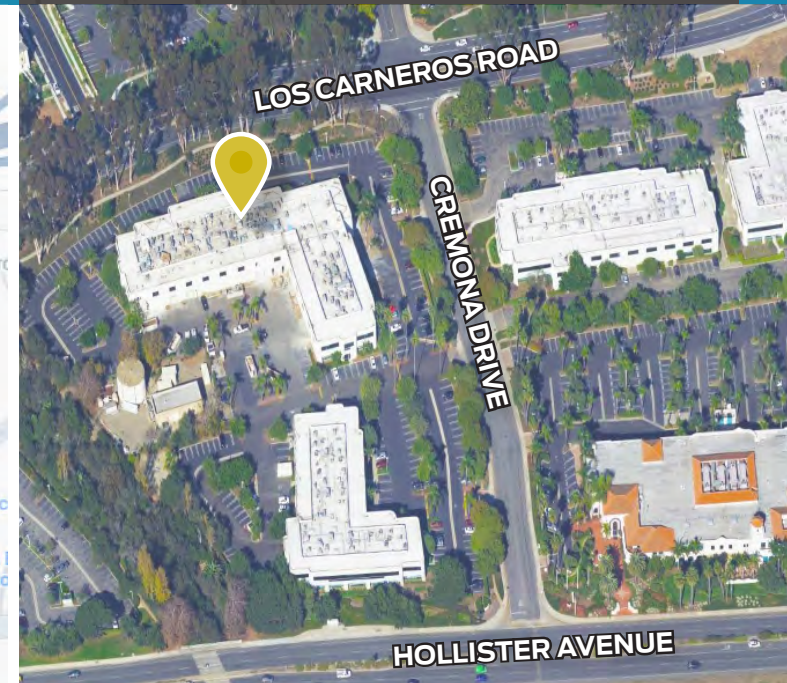
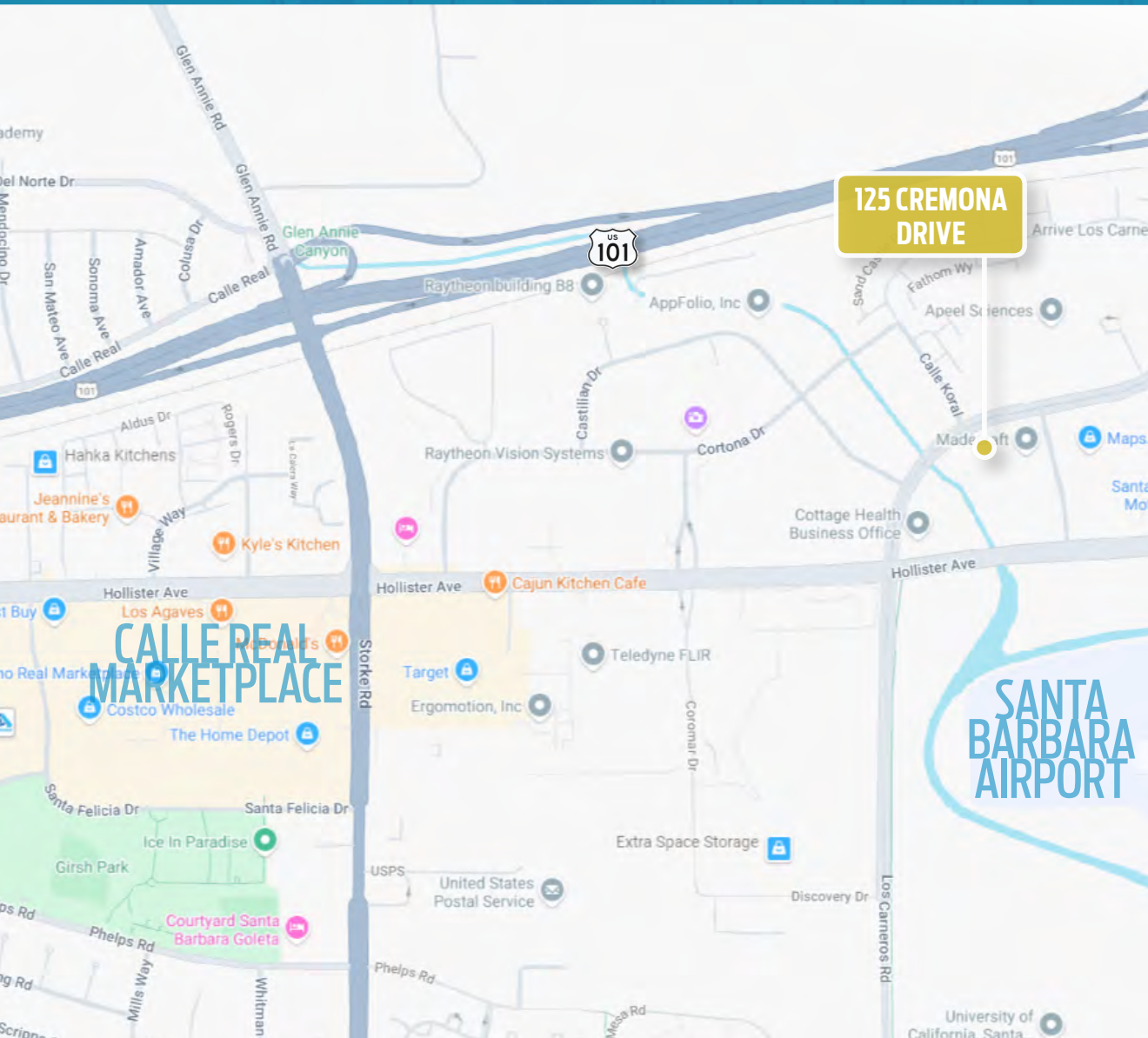

© 05/20/25 Radius Group Commercial Real Estate, Inc. DRE lic. 01334755. All rights reserved. Content and/or images may not be used without permission. The information provided here has been obtained from the owner of the property or from other sources deemed reliable. We have no reason to doubt its accuracy, but we do not guarantee it.

PRESENTED BY

JUSTIN DIEM
805.879.9634
jdiem@radiusgroup.com
CA LIC. 02058176



125 CREMONA DR

SUITE 210 • GOLETA CA 93117

MAJOR SUBLEASE RATE REDUCTION

±5,755 SF Class A Office Suite Located
in Goleta's Burgeoning Tech Corridor

FLOOR PLAN • ±5,755 SF

LOS CARNEROS ROAD

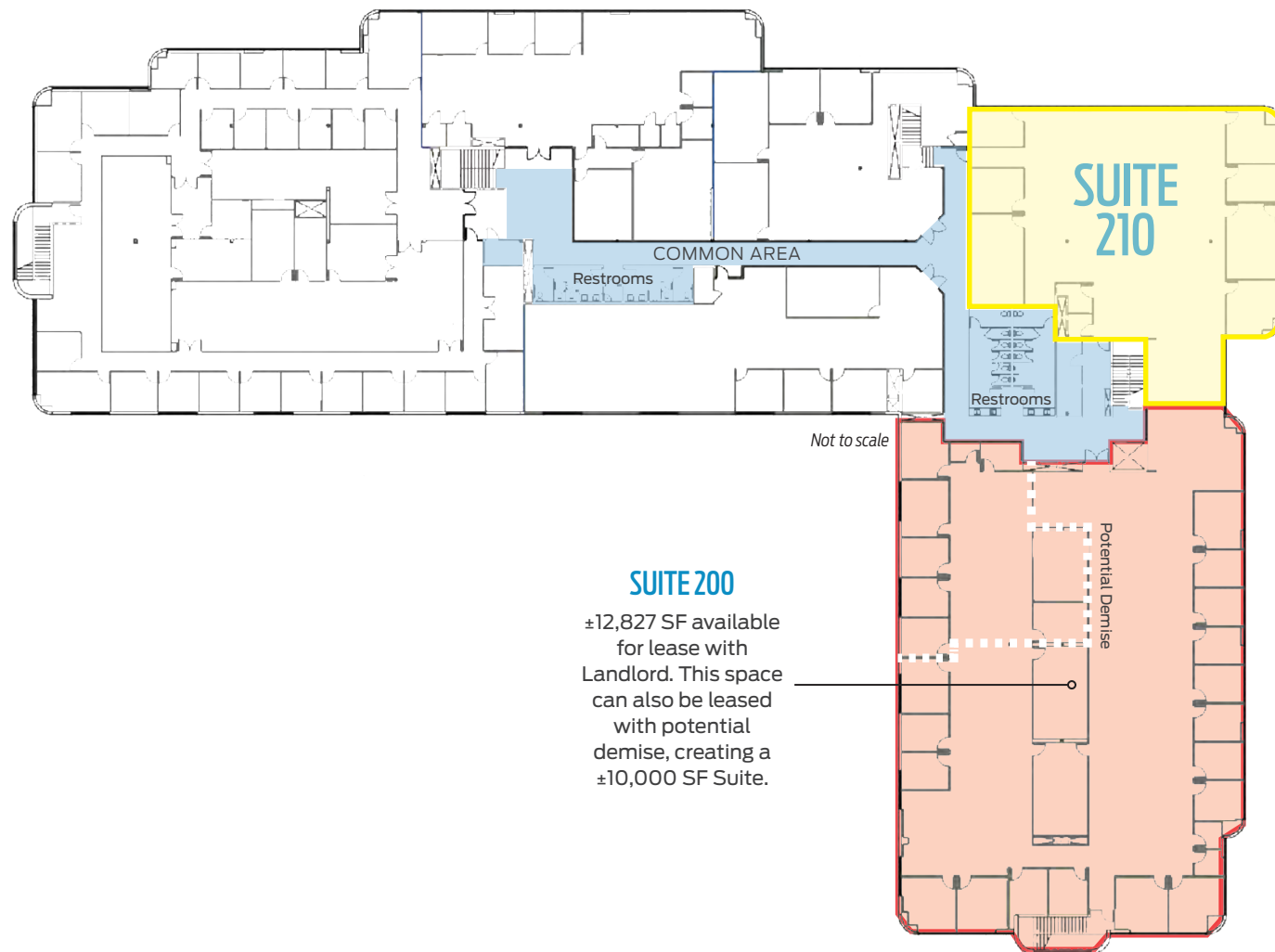

© 05/20/25 Radius Group Commercial Real Estate, Inc. DRE lic. 01334755. All rights reserved. Content and/or images may not be used without permission. The information provided here has been obtained from the owner of the property or from other sources deemed reliable. We have no reason to doubt its accuracy, but we do not guarantee it.

PRESENTED BY

JUSTIN DIEM
805.879.9634
jdiem@radiusgroup.com
CA LIC. 02058176



125 CREMONA DR

SUITE 210 • GOLETA CA 93117

MAJOR SUBLEASE RATE REDUCTION

±5,755 SF Class A Office Suite Located
in Goleta's Burgeoning Tech Corridor

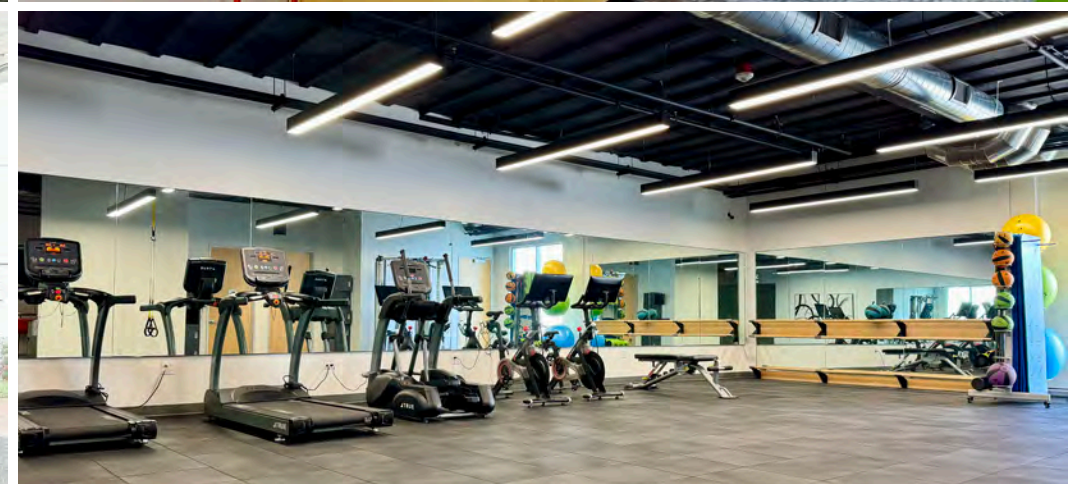

© 05/20/25 Radius Group Commercial Real Estate, Inc. DRE lic. 01334755. All rights reserved. Content and/or images may not be used without permission. The information provided here has been obtained from the owner of the property or from other sources deemed reliable. We have no reason to doubt its accuracy, but we do not guarantee it.

PRESENTED BY

JUSTIN DIEM
805.879.9634
jdiem@radiusgroup.com
CA LIC. 02058176



125 CREMONA DR
SUITE 210 • GOLETA CA 93117

MAJOR SUBLEASE RATE REDUCTION

±5,755 SF Class A Office Suite Located
in Goleta's Burgeoning Tech Corridor

SELECT NEARBY AMENITIES & BUSINESSES

ELLWOOD MESA OPEN SPACE
& SPERLING PRESERVE

CAMINO REAL MARKETPLACE



HOLLISTER VILLAGE PLAZA



GLEN ANNIE
GOLF CLUB

HOLLISTER
VILLAGE
RESIDENTIAL
DEVELOPMENT

SOUTH COAST TECH CORRIDOR

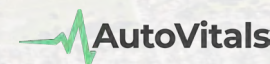

CABRILLO BUSINESS PARK



UCSB CAMPUS

GOLETA
BEACH PARK



PRESENTED BY

JUSTIN DIEM
805.879.9634
jdiem@radiusgroup.com
CA LIC. 02058176

