

4295-4395 ORCHARD LAKE RD.
WEST BLOOMFIELD, MICHIGAN

RETAIL/MEDICAL FOR LEASE
2,400 Square Feet Available



SIGNATURE ASSOCIATES
KNOW SIGNATURE | KNOW RESULTS

CROSSWINDS MALL



REASONABLE AND AFFORDABLE LEASE RATES

PROPERTY FEATURES

- 2,400 square feet available
- Excellent main road frontage
- Tremendous main road visibility with ample parking
- Diverse tenant mix – great opportunity to start or expand your own business
- Excellent opportunity for retail or medical in a high-profile neighborhood center
- Join Kroger, CVS, Secretary of State, Cosmo Salon, and more
- Lease Rate: \$25.00/sq. ft. NNN



For more information, please contact:

MARVIN PETROUS
(248) 359 0647
mpetrous@signatureassociates.com

SIGNATURE ASSOCIATES
One Towne Square, Suite 1200
Southfield, MI 48076
www.signatureassociates.com

4295-4395 Orchard Lake Rd. – West Bloomfield, MI

Retail/Office For Lease

2,400
Square Feet
AVAILABLE



For more information, please contact:

MARVIN PETROUS
(248) 359 0647
mpetrous@signatureassociates.com

SIGNATURE ASSOCIATES
One Towne Square, Suite 1200
Southfield, MI 48076
www.signatureassociates.com

4295-4395 Orchard Lake Rd. – West Bloomfield, MI

Retail/Office For Lease

2,400
Square Feet
AVAILABLE

Interior Photos Suite 170



For more information, please contact:

MARVIN PETROUS
(248) 359 0647
mpetrous@signatureassociates.com

SIGNATURE ASSOCIATES
One Towne Square, Suite 1200
Southfield, MI 48076
www.signatureassociates.com

4295-4395 Orchard Lake Rd. – West Bloomfield, MI

Retail/Office For Lease

**2,400
Square Feet
AVAILABLE**

Site Plan

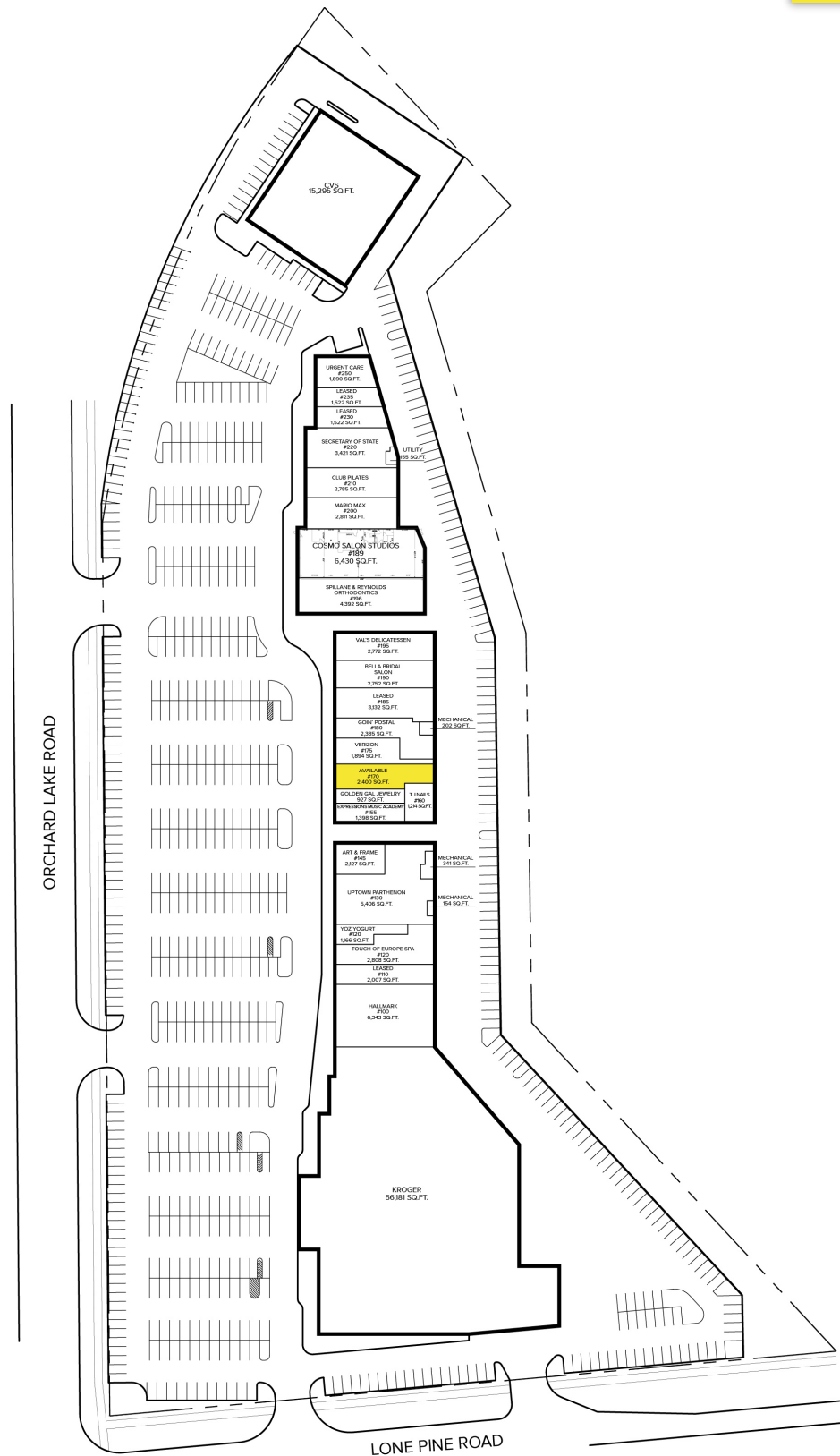

For more information, please contact:

MARVIN PETROUS
 (248) 359 0647
 mpetrous@signatureassociates.com

SIGNATURE ASSOCIATES
 One Towne Square, Suite 1200
 Southfield, MI 48076
 www.signatureassociates.com

4295-4395 Orchard Lake Rd. – West Bloomfield, MI

Retail/Office For Lease

2,400
Square Feet
AVAILABLE



DEMOGRAPHICS

	POPULATION	MED. HH INCOME
1 MILE	5,614	\$187,858
3 MILE	51,461	\$143,288
5 MILE	154,073	\$120,659

TRAFFIC COUNTS (TWO-WAY)

35,599	Orchard Lake Rd. N of Lone Pine Rd.
37,510	Orchard Lake Rd. S of Lone Pine Rd.
10,922	Lone Pine Rd. E of Orchard Lake Rd.
26,577	Pontiac Trail & Orchard Lake Rd.



For more information, please contact:

MARVIN PETROUS
(248) 359 0647
mpetrous@signatureassociates.com

SIGNATURE ASSOCIATES
One Towne Square, Suite 1200
Southfield, MI 48076
www.signatureassociates.com