

# Bentonville Office

2701 Otis Corley Drive, Suite 3 | Bentonville, AR



FOR SUBLEASE



## PROPERTY HIGHLIGHTS

- 2,500 ± SF available for Sublease
- Asking Rate: \$17.00/FS
- Furniture can be included
- Sublease runs through 11/30/2026
- Includes a kitchenette, in-suite bathrooms, multiple private offices & conference space
- Located near SAM'S Club Home Office & Walmart Home Office
- Close proximity to I-49 & U.S. Highway-62

FOR MORE INFORMATION  
PLEASE CONTACT:

**SARAH KATE ELLIS**  
sellis@sagepartners.com

**ETHAN FOWLER**  
efowler@sagepartners.com

**479 845 3000**  
**sagepartners.com**

\*Information deemed reliable but not guaranteed

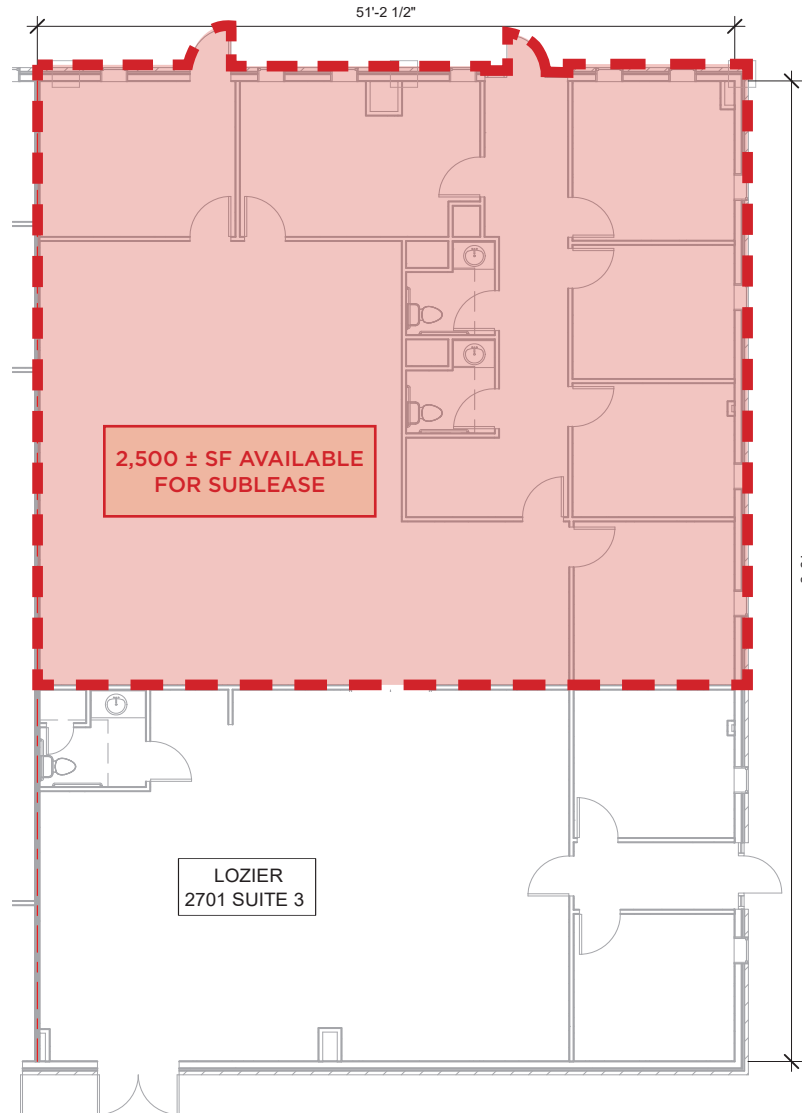

1 2701 SUITE 3  
1/8" = 1'-0" ↓

3,779 SF  
2701

# INTERIOR PHOTOS 2701 OTIS CORLEY DRIVE, SUITE 3 | BENTONVILLE, AR



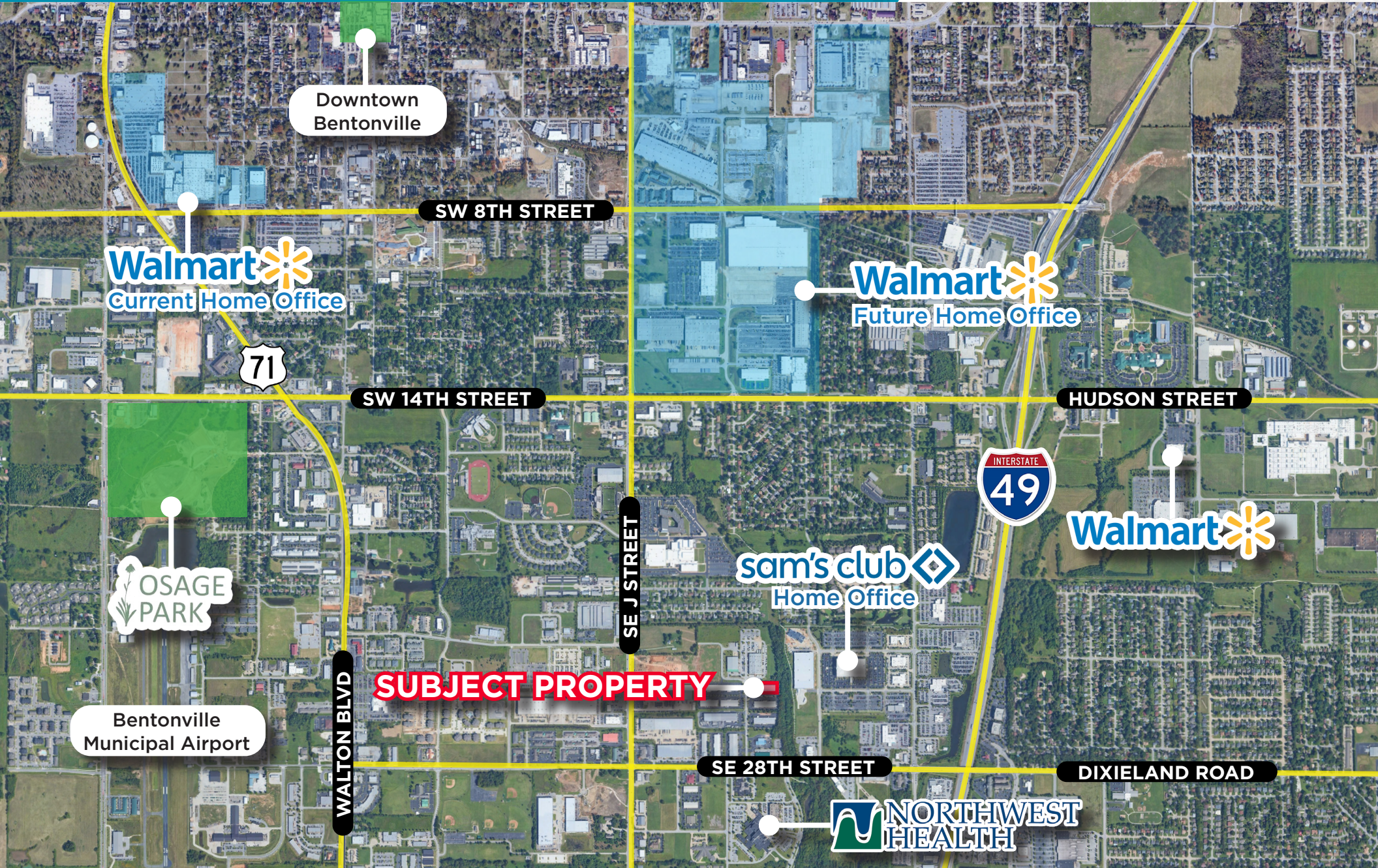

Downtown  
Bentonville

SW 8TH STREET

**Walmart**  
Current Home Office

**Walmart**  
Future Home Office

SW 14TH STREET

HUDSON STREET

71

INTERSTATE  
49

OSAGE  
PARK

**sam's club**  
Home Office

**Walmart**

SE J STREET

**SUBJECT PROPERTY**

Bentonville  
Municipal Airport

WALTON BLVD

SE 28TH STREET

DIXIELAND ROAD

**NORTHWEST  
HEALTH**