



2300 N. Main St.

High Point, North Carolina 27262

Property Features

- Ground Lease Only
- .638 Acres with existing building
- Area Retailers: Home Depot, Ross, TJ Maxx, Harris Teeter, PetsMart, Tuesday Morning, and Office Depot
- Located at the intersection of N. Main St. (Hwy 311) and E. Parris Ave.
- Traffic Count (2017):
- Eastchester Dr. (NC Hwy 68) - 24,000 VPD
- N. Main St. (US Hwy 311) - 27,000 VPD
- Demographics (2018)



	1 Mile	3 Miles	5 Miles
Population	8,165	56,953	108,808
Households	3,697	22,381	42,320
Avg. HH Income	\$60,414	\$61,064	\$65,979

Lease Rate: \$6,500/Month NNN

For more information, contact:

Robbie Perkins, CCIM, SIOR

+1 336 337 0059 • rperkins@naipt.com

Tammy Dixon, CMB®, AMP

+1 336 681 0861 • tdixon@naipt.com

NO WARRANTY OR REPRESENTATION, EXPRESS OR IMPLIED, IS MADE AS TO THE ACCURACY OF THE INFORMATION CONTAINED HEREIN, AND THE SAME IS SUBMITTED SUBJECT TO ERRORS, OMISSIONS, CHANGE OF PRICE, RENTAL OR OTHER CONDITIONS, PRIOR SALE, LEASE OR FINANCING, OR WITHDRAWAL WITHOUT NOTICE, AND OF ANY SPECIAL LISTING CONDITIONS IMPOSED BY OUR PRINCIPALS NO WARRANTIES OR REPRESENTATIONS ARE MADE AS TO THE CONDITION OF THE PROPERTY OR ANY HAZARDS CONTAINED THEREIN ARE ANY TO BE IMPLIED.

348 N. Elm Street
Greensboro, North Carolina 27401
+1 336 373 0995

naipt.com

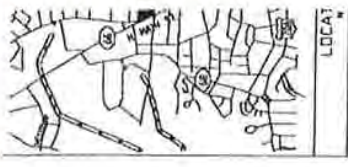

SITE INFO

PROJECT

1. HOME DEPOT BRAND
2. HOME DEPOT BRAND
3. HOME DEPOT BRAND

TOTAL AREA

BUILDING

1. BUILDING
2. GARAGE
3. TOTAL FLOOR AREA
4. EXISTING GARAGE
5. EXISTING GARAGE
6. EXISTING GARAGE
7. EXISTING GARAGE
8. EXISTING GARAGE

PARKING

1. HOME DEPOT BRAND
2. HOME DEPOT BRAND
3. HOME DEPOT BRAND
4. HOME DEPOT BRAND
5. HOME DEPOT BRAND
6. HOME DEPOT BRAND
7. HOME DEPOT BRAND
8. HOME DEPOT BRAND
9. HOME DEPOT BRAND
10. HOME DEPOT BRAND
11. HOME DEPOT BRAND

- GENERAL NOTES:**
1. CONTRACTOR SHALL VERIFY ALL DIMENSIONS AND CONDITIONS OF EXISTING STRUCTURE AND UTILITIES PRIOR TO CONSTRUCTION.
 2. CONTRACTOR SHALL VERIFY ALL DIMENSIONS AND CONDITIONS OF EXISTING STRUCTURE AND UTILITIES PRIOR TO CONSTRUCTION.
 3. CONTRACTOR SHALL VERIFY ALL DIMENSIONS AND CONDITIONS OF EXISTING STRUCTURE AND UTILITIES PRIOR TO CONSTRUCTION.
 4. CONTRACTOR SHALL VERIFY ALL DIMENSIONS AND CONDITIONS OF EXISTING STRUCTURE AND UTILITIES PRIOR TO CONSTRUCTION.
 5. CONTRACTOR SHALL VERIFY ALL DIMENSIONS AND CONDITIONS OF EXISTING STRUCTURE AND UTILITIES PRIOR TO CONSTRUCTION.
 6. CONTRACTOR SHALL VERIFY ALL DIMENSIONS AND CONDITIONS OF EXISTING STRUCTURE AND UTILITIES PRIOR TO CONSTRUCTION.
 7. CONTRACTOR SHALL VERIFY ALL DIMENSIONS AND CONDITIONS OF EXISTING STRUCTURE AND UTILITIES PRIOR TO CONSTRUCTION.
 8. CONTRACTOR SHALL VERIFY ALL DIMENSIONS AND CONDITIONS OF EXISTING STRUCTURE AND UTILITIES PRIOR TO CONSTRUCTION.
 9. CONTRACTOR SHALL VERIFY ALL DIMENSIONS AND CONDITIONS OF EXISTING STRUCTURE AND UTILITIES PRIOR TO CONSTRUCTION.
 10. CONTRACTOR SHALL VERIFY ALL DIMENSIONS AND CONDITIONS OF EXISTING STRUCTURE AND UTILITIES PRIOR TO CONSTRUCTION.
 11. CONTRACTOR SHALL VERIFY ALL DIMENSIONS AND CONDITIONS OF EXISTING STRUCTURE AND UTILITIES PRIOR TO CONSTRUCTION.

APPROVED BY THE CITY ENGINEER FOR THE CITY OF HIGH POINT, NORTH CAROLINA, ON BEHALF OF THE CITY ENGINEER.

APPROVED BY THE CITY ENGINEER FOR THE CITY OF HIGH POINT, NORTH CAROLINA, ON BEHALF OF THE CITY ENGINEER.

APPROVED BY THE CITY ENGINEER FOR THE CITY OF HIGH POINT, NORTH CAROLINA, ON BEHALF OF THE CITY ENGINEER.

APPROVED BY THE CITY ENGINEER FOR THE CITY OF HIGH POINT, NORTH CAROLINA, ON BEHALF OF THE CITY ENGINEER.

APPROVED BY THE CITY ENGINEER FOR THE CITY OF HIGH POINT, NORTH CAROLINA, ON BEHALF OF THE CITY ENGINEER.

APPROVED BY THE CITY ENGINEER FOR THE CITY OF HIGH POINT, NORTH CAROLINA, ON BEHALF OF THE CITY ENGINEER.

APPROVED BY THE CITY ENGINEER FOR THE CITY OF HIGH POINT, NORTH CAROLINA, ON BEHALF OF THE CITY ENGINEER.

APPROVED BY THE CITY ENGINEER FOR THE CITY OF HIGH POINT, NORTH CAROLINA, ON BEHALF OF THE CITY ENGINEER.

APPROVED BY THE CITY ENGINEER FOR THE CITY OF HIGH POINT, NORTH CAROLINA, ON BEHALF OF THE CITY ENGINEER.

APPROVED BY THE CITY ENGINEER FOR THE CITY OF HIGH POINT, NORTH CAROLINA, ON BEHALF OF THE CITY ENGINEER.

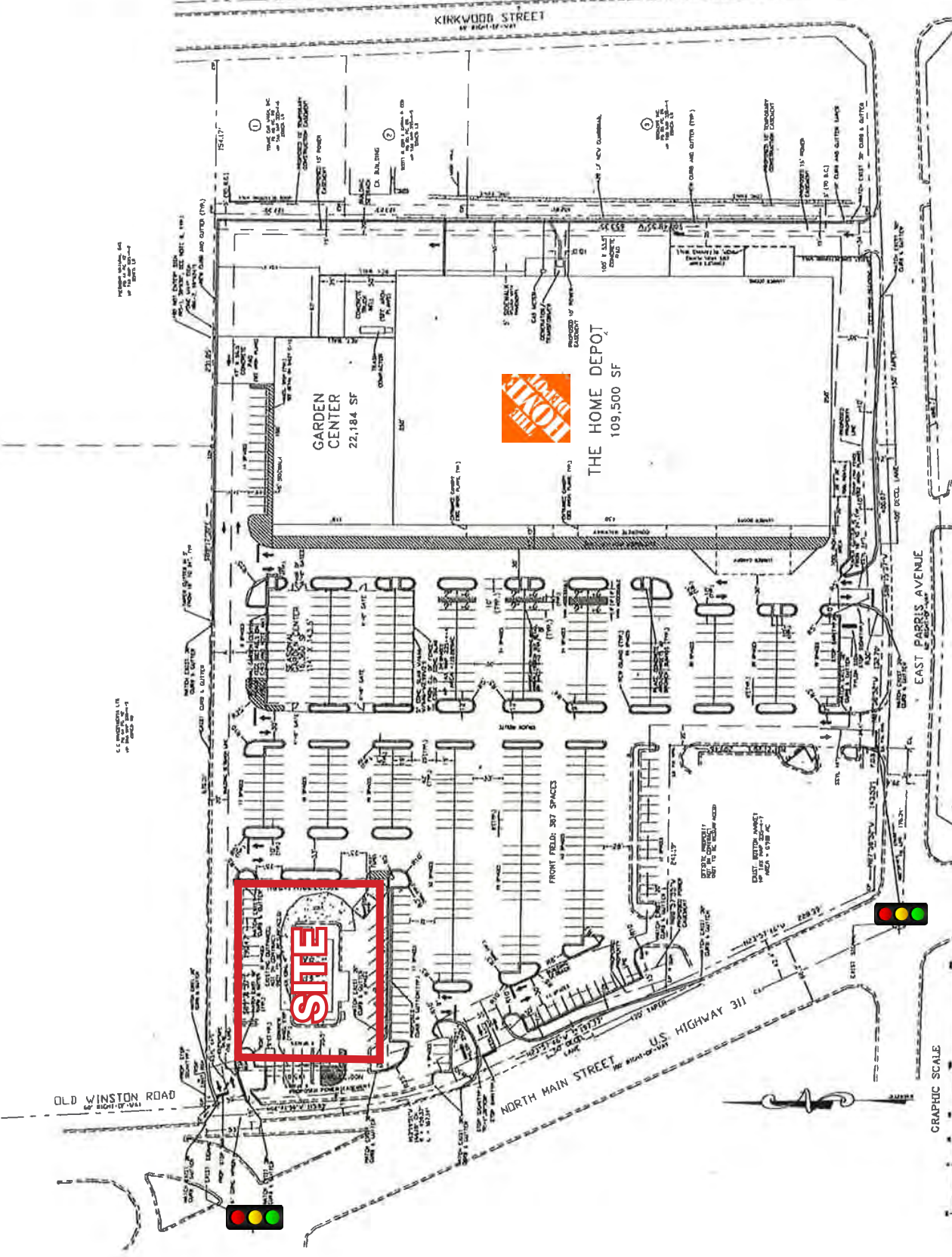

FLOOD PLAIN STATEMENT

THIS PROPERTY LIES IN ZONE "C" PER CITY OF HIGH POINT FLOOD PLAN FOR MAP 330-1-14.8. THIS PROPERTY IS NOT LOCATED WITHIN THE 100 YEAR FLOOD PLAIN PER RESPONSE PG 27 OF PL.



Owner's certificate of Compliance

I, _____, accept this submission as my plan of development and

