



Humble Medical Office Plaza

9346 Humble Westfield Rd & 19451 Hightower Ln | Humble, TX 77338



Welcoming A New Patient Experience

Building Features

- Three Building 14,263 SF Medical Plaza
- New Construction Built 2025
- Free surface parking
- 3.50/1,000 SF Parking ratio
- Close proximity to affluent areas including Atascocita, Humble, Kingwood
- 1 mile from Memorial Hermann Northwest Hospital

[Building Video](#)

[View Building Website](#)



HUMBLE MEDICAL OFFICE PLAZA

9346 Humble Westfield Rd

BUILDING TWO

3,516 SF

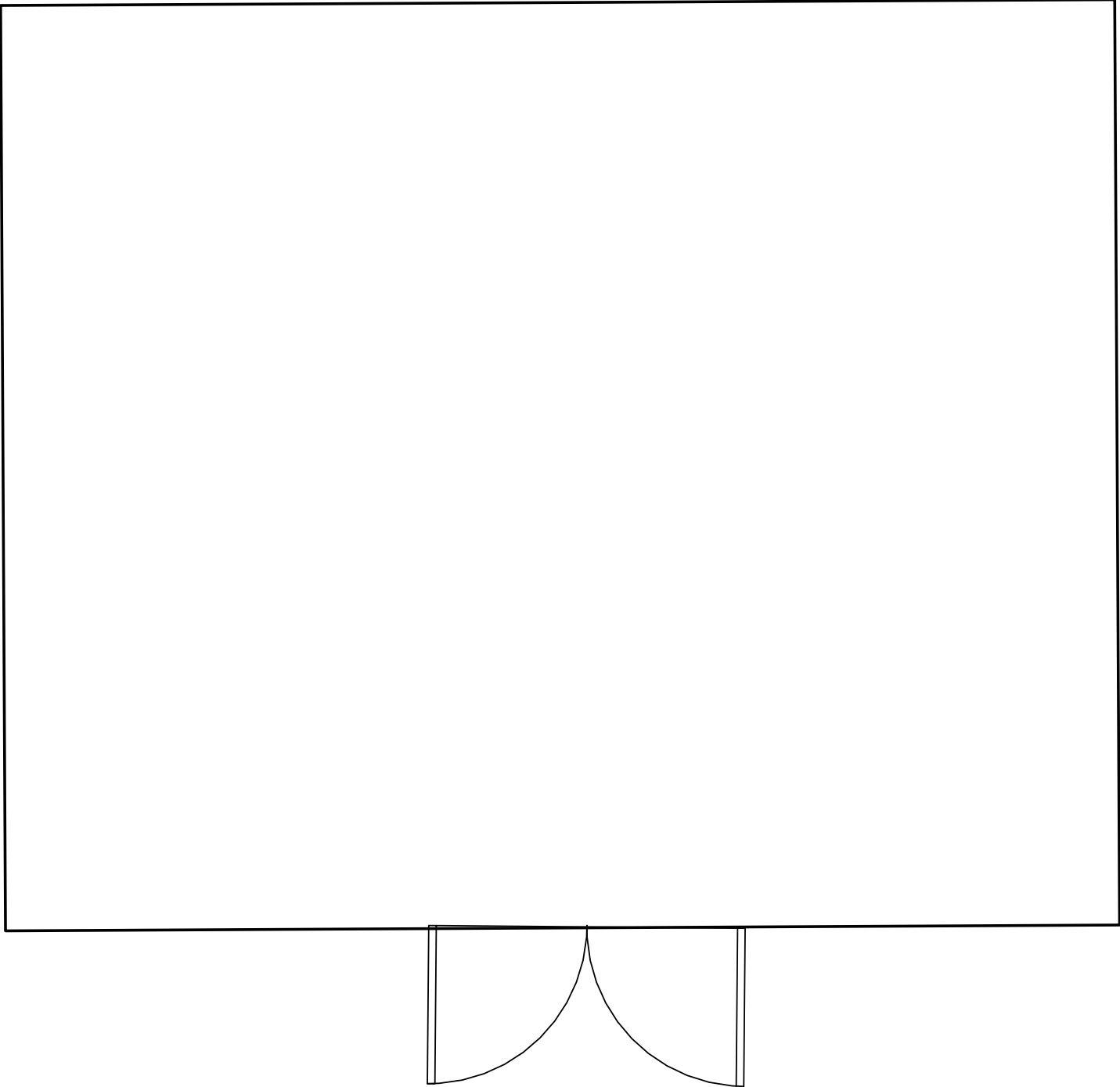

HUMBLE MEDICAL OFFICE PLAZA

19451 Hightower Lane

6,822 SF

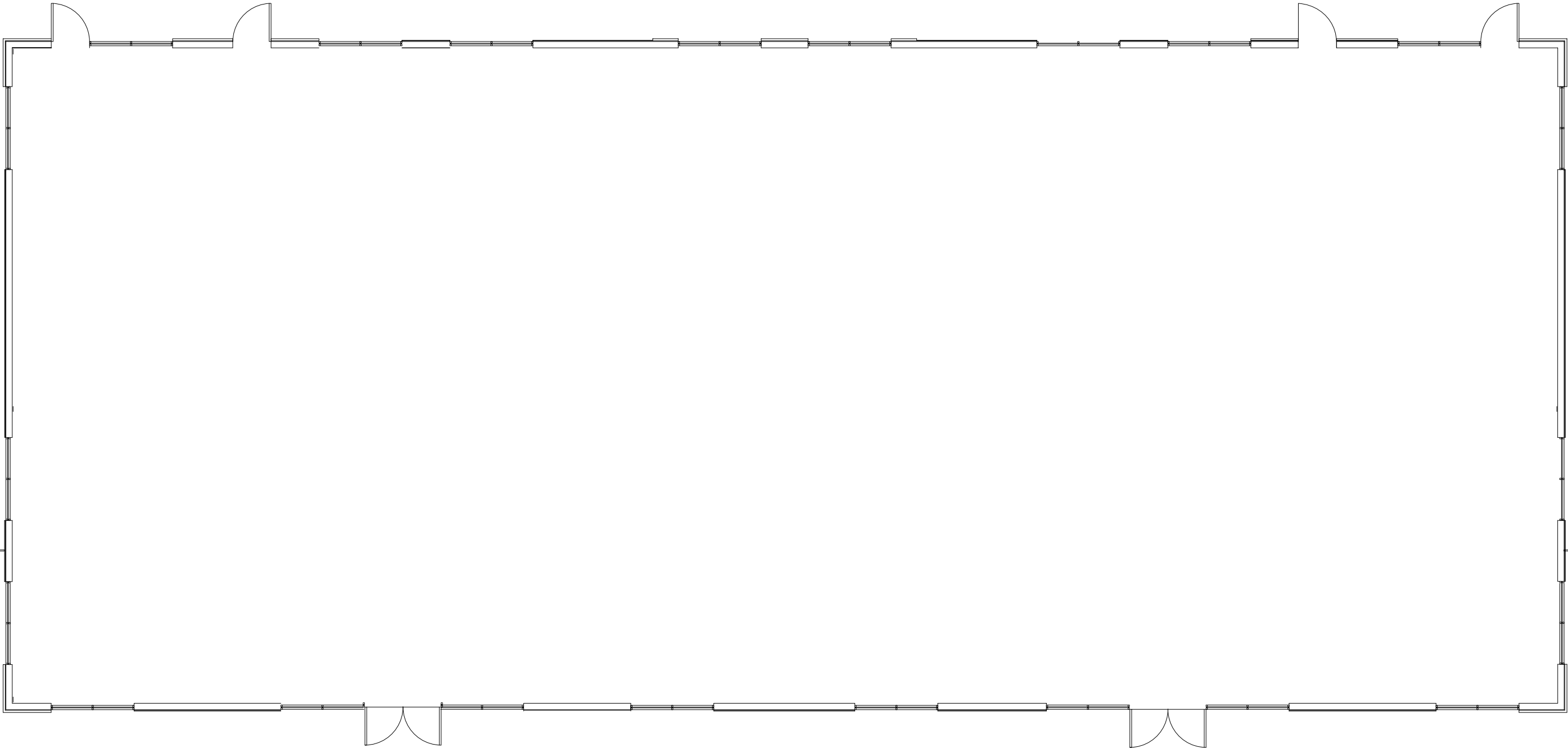

Premier Location

Conveniently located in Humble with easy access to major through-ways.

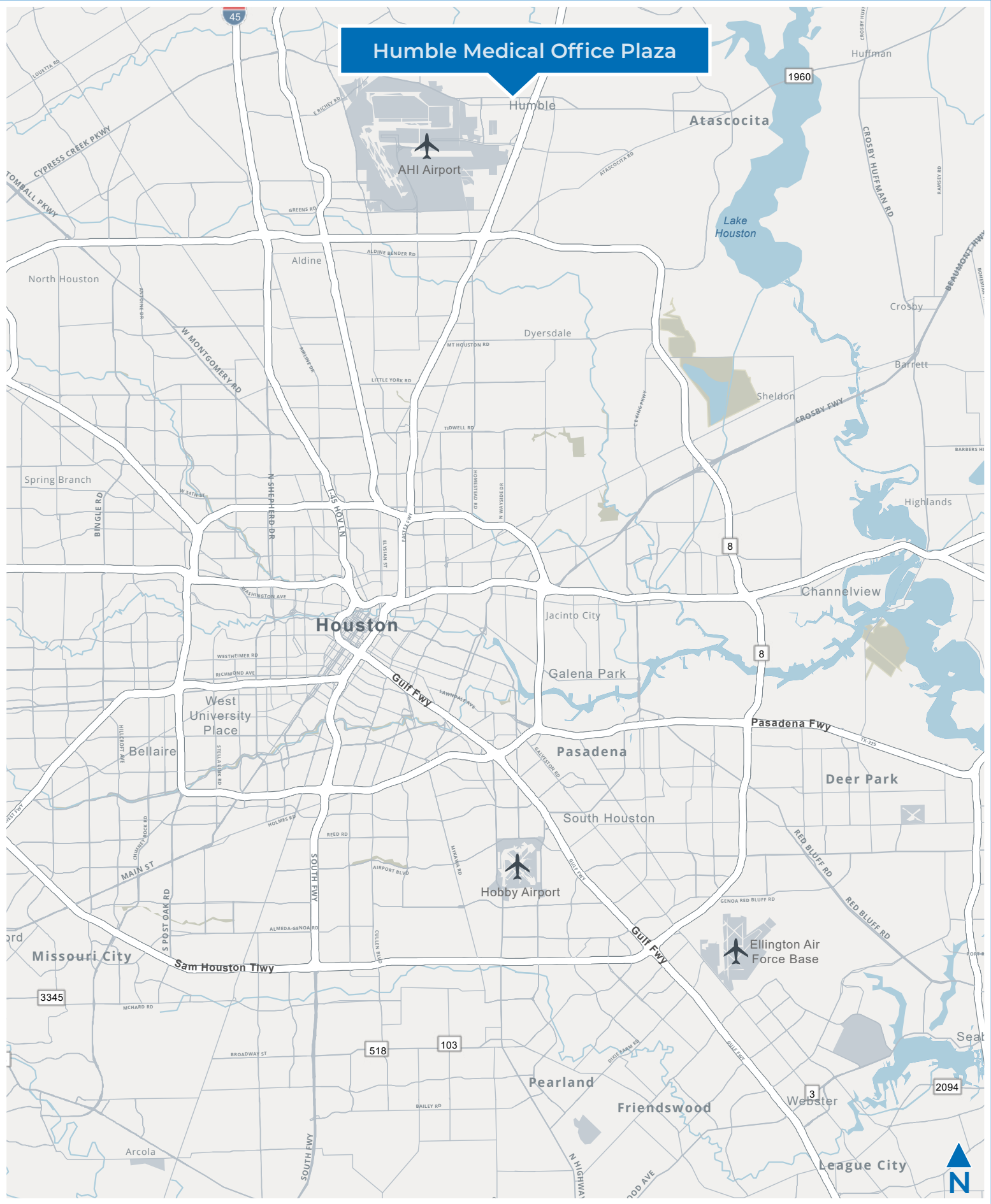

Centralized in a Thriving Community

Humble Medical Office Plaza is in Humble, located about 20 minutes northeast of downtown Houston. With its excellent parks, recreational facilities, and proximity to Lake Houston, Humble offers a relaxed lifestyle surrounded by natural beauty. Whether you're enjoying a concert at the Charles Bender Performing Arts Center or shopping at Deerbrook Mall, there's a strong sense of connection and hometown spirit that defines life in Humble.



Golf Club Of Houston



Memorial Hermann Northeast Hospital



George Bush Intercontinental Airport

Healthcare

49%

Private Insurance

\$6k

Healthcare Spending

74%

Doctor Visits in 2025

Employment

16%

Service Employment

27%

Blue Collar Employment

57%

White Collar Employment

Economics

34

Median Age

\$97k

Per Household Income

Population

125k

Total population

140k

Total Daytime Population

*Demographics is within 5 miles of the property

Humble Medical Office Plaza

9346 Humble Westfield Rd & 19451 Hightower Ln | Humble, TX 77338

LEASING INFORMATION

Christian Connell

713.231.1588

Christian.Connell@transwestern.com



The information provided herein was obtained from sources believed reliable; however, Transwestern makes no guarantees, warranties or representations as to the completeness or accuracy thereof. The presentation of this property is submitted subject to errors, omissions, change of price or conditions, prior sale or lease, or withdrawal without notice. Copyright © 2025 Transwestern.