

FORMER STARBUCKS FOR LEASE
9235 WESTHEIMER ROAD
HOUSTON, TEXAS 77063

Former Starbucks
Available 2166 SF
w / drive-thru

ABOUT THE PROPERTY

- The Property offers a former Starbucks 2,166 square foot building with Drive-Through for lease
 - Located on Westheimer Road, one of the five busiest street in the Houston MSA, seeing over +/- 63,000 CPD
 - Situated in the heart of Houston, the 4th largest city in the USA
 - Over 500,000 people live within a 5-mile radius of this property
 - Located in between a number of national retailers such as Aldi, Dollar Tree, Taco Bell, LA Fitness, Chick-Fil-A and Wells Fargo
 - This an outparcel in front of a WhiteWater Express Car Wash
 - A minimum of 30 parking spaces available on site
-
- Population (5-mile radius, 2024) – approximately 560,000
 - Households (5-mile radius, 2024) – approximately 230,000
 - Average Income (5-mile radius, 2024) – approximately \$89,400
 - Consumer Spending (5-mile radius, 2024) – approximately \$6.3 billion



SITE LAYOUT

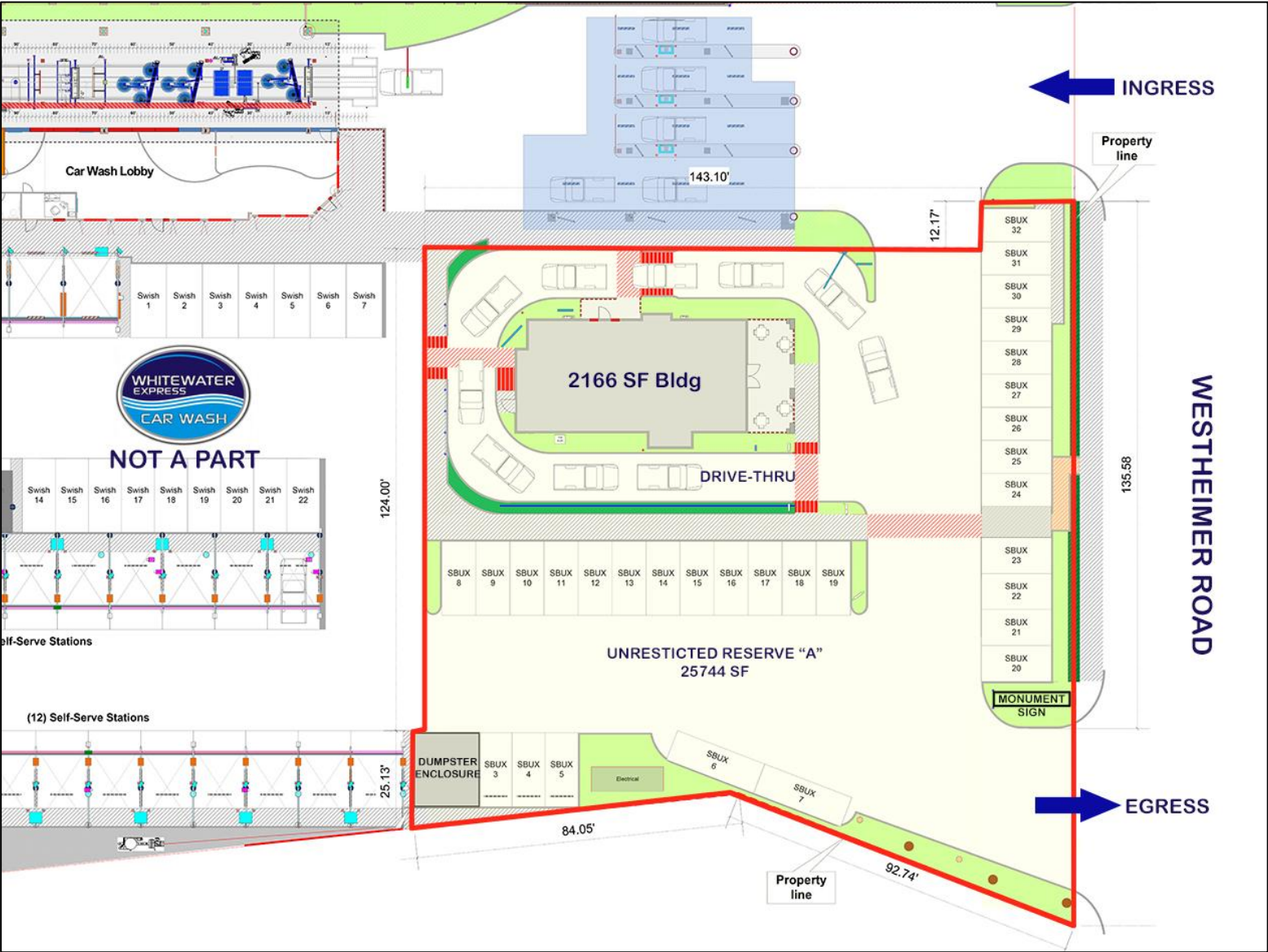

PROPERTY PHOTOS

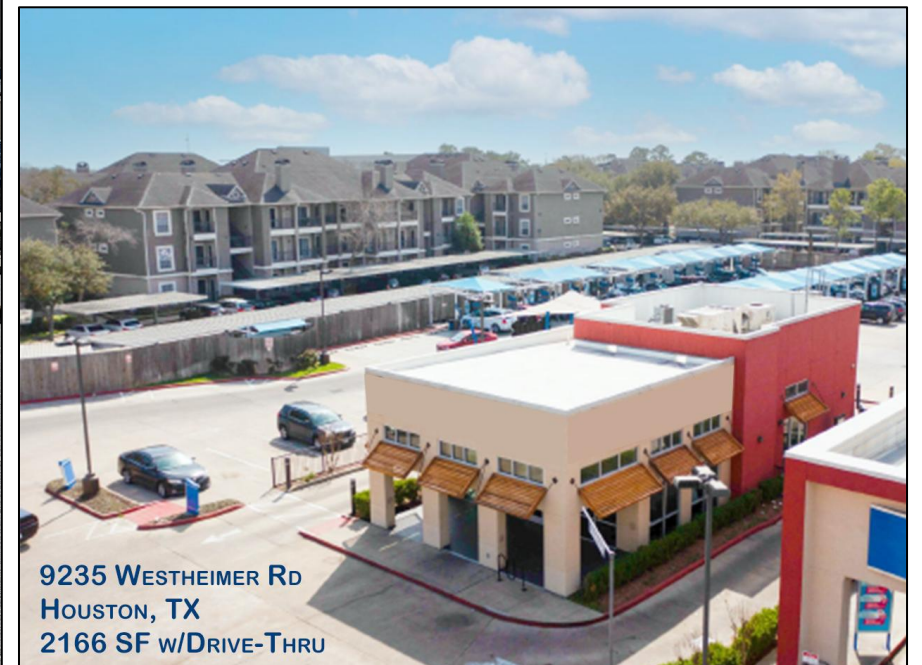

PROPERTY SUMMARY

PROPERTY ATTRIBUTES

Gross Leasable Area	2,166 SF
Site Size	25,744 SF
Zoning	N/A: Commercial
Parking	30+ Parking Spaces
Year Built/Renovated	2013
Utilities	Available
Rental Rate	Please Call
NNN Expenses	Tenant Responsibility
Space Description	Former Starbucks w/Drive-Thru



CONTACT

MONUMENT
SIGN

9235 WESTHEIMER

Fred Ghabriel | Pierre Bejjani

e: fred@ghabriel.com | pebejjani@gmail.com

t: (713) 823-2121 | (832) 605-4222

