

PRIME OFFICE SPACE

FOR LEASE

HISTORIC DOWNTOWN SUMMERVILLE

\$23.00SF NNN

## EXCELLENT LOCATION

212 E. 2ND NORTH ST., STE. B, SUMMERVILLE, SC 29483



**RE/MAX**  
COMMERCIAL®

RE/MAX SOUTHERN SHORES  
Robert Pratt  
(843) 343-6085:cell  
robert@robertpratt.com

419 N. CEDAR ST.

| SUMMERVILLE |

SOUTH CAROLINA

PRIME OFFICE SPACE

FOR LEASE

HISTORIC DOWNTOWN SUMMERVILLE

\$23.00SF NNN



- Approx. 1,188sf
- 0.30 Acre
- New Construction
- Ample Parking
- Dorch. Co. 137-07-14-006
- Delivery Summer 2024
- Cold Shell Delivery
- NNN \$6.00/sf
- NNN = Taxes, Insurance & CAM
- Total Monthly \$2871.00
- Zoned D-MX Town of Summerville
- 2 Blocks off Main Street
- Established Professional & Retail Businesses in Surrounding Area

**RE/MAX**  
COMMERCIAL®

RE/MAX SOUTHERN SHORES  
Robert Pratt  
(843) 343-6085:cell  
robert@robertpratt.com

419 N. CEDAR ST.

| SUMMERVILLE |

SOUTH CAROLINA

PRIME OFFICE SPACE

FOR LEASE

HISTORIC DOWNTOWN SUMMERVILLE

\$23.00SF NNN



419 N. CEDAR ST.

| SUMMERVILLE |

SOUTH CAROLINA

HISTORIC DOWNTOWN SUMMERVILLE

\$23.00SF NNN



# What's in My Community?

Places that make your life richer and community better

212 E 2nd North St, Summerville, South Carolina, 29483  
1 mile



This infographic was inspired by the visionary [Plan Melbourne](#) and the hyper proximity 20-minute neighbourhoods concept. Points of interest are grouped into civic themes which contribute to livability and community engagement.

Points of interest are sourced from [Foursquare](#) and updated 3 times per year. Each category shows a maximum of 1250 locations. © 2024 Esri

PRIME OFFICE SPACE

FOR LEASE

HISTORIC DOWNTOWN SUMMERVILLE

\$23.00SF NNN

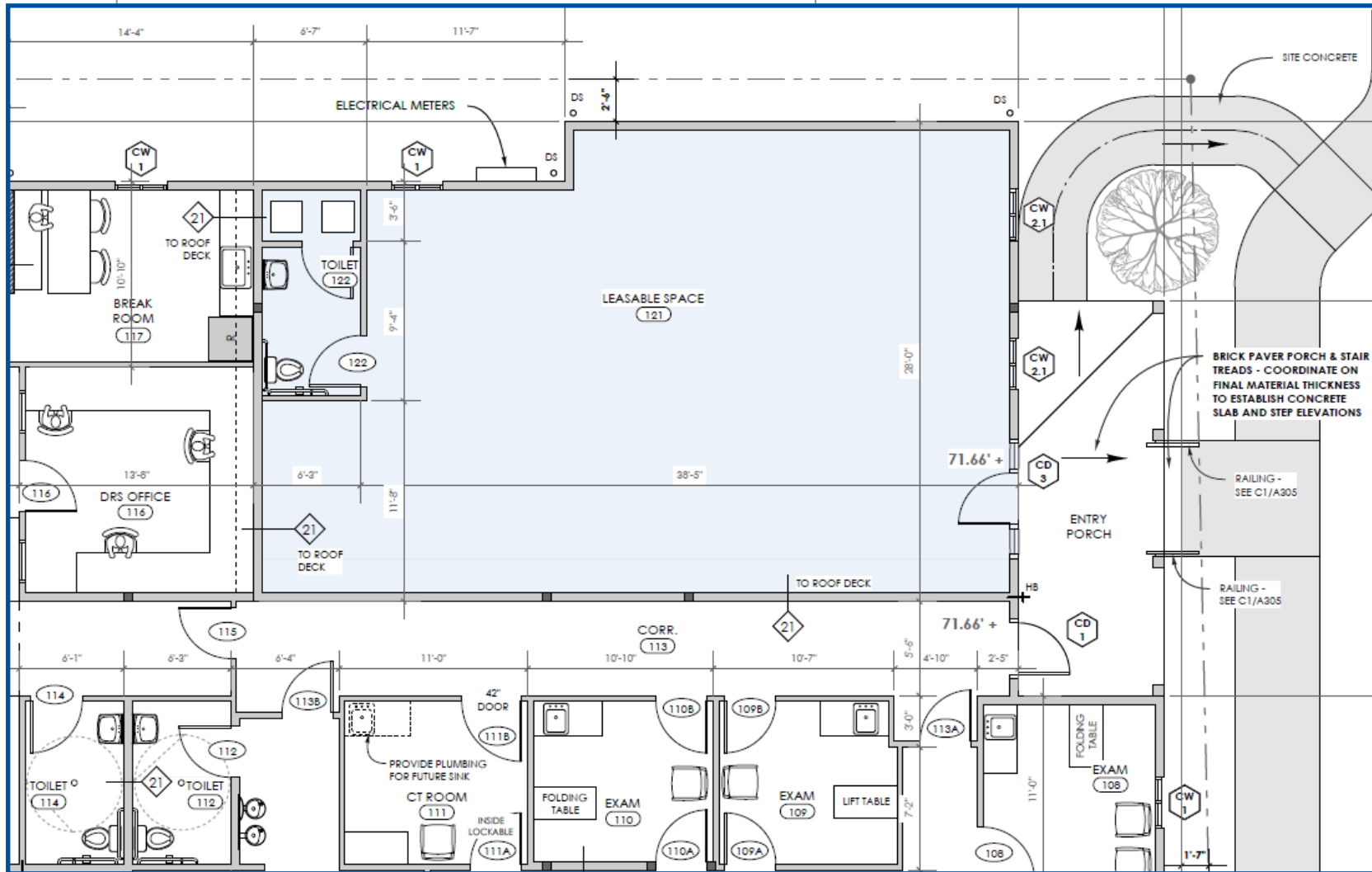

RE/MAX SOUTHERN SHORES  
 Robert Pratt  
 (843) 343-6085:cell  
 robert@robertpratt.com