

**FOR LEASE**  
**Class "A" Office Space**

**PROPERTY**  
Kimball Lakes Office Park

**LOCATION**  
2101 E Kirkwood Blvd., Southlake, TX



*Class "A" Office Building Space For Lease*



## PROPERTY HIGHLIGHTS

- SF Available – 1,264 sq ft.
- Building & Suite Number – 2101 Kirkwood Blvd Suite 200 Southlake TX 76092
- Space Condition (Spec, 2nd Gen, Shell, etc.) – Space is high end finish out with kitchen included
- Rental Rate/SF - \$22/sq ft to \$24/SF
- Additional Expenses (Full Service, Mod Gross, NNN – if NNN, please provide estimate per SF) \$10/sq ft NNN
- TIA Offered (Yes/No – Amount) - Negotiable
- Floor Plans of Proposed Space - Attached
- Parking Ratio – 6 dedicated plus 1 handicapped space, plus shared parking when others not occupied.
- Signage Available for Space – Keystone next to front door at tenants expense



PROPERTY HIGHLIGHTS	
Address	2101 KIRKWOOD BLVD., SUITE 120 SOUTHLAKE, TX 76092
Year Built	2016
Stories	1
Building Class	A
Building Rentable SF	5,990 SF
Rent Rate	\$22-24/SF + NNN
Suites	Suite 200 – 1,264 SF FOR LEASE
Zoning	Medical/Office Zoning
Excellent Demographics	Primed to serve Southlake's affluent, rapidly growing community with households within two miles boasting an average income of \$229,055/year
Parking	Plenty of Surface Parking Spaces
Great Location	The building has superb visibility and location on Kirkwood Blvd. just north of Highway 114.





# PROPERTY OVERVIEW

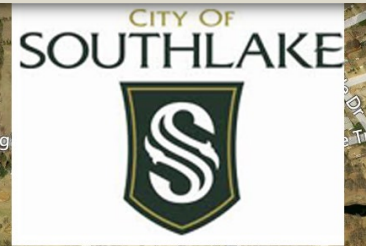

**FOR LEASE**  
2101 E. Kirkwood Blvd.  
Southlake, TX 76092



SPACE  
PLANS



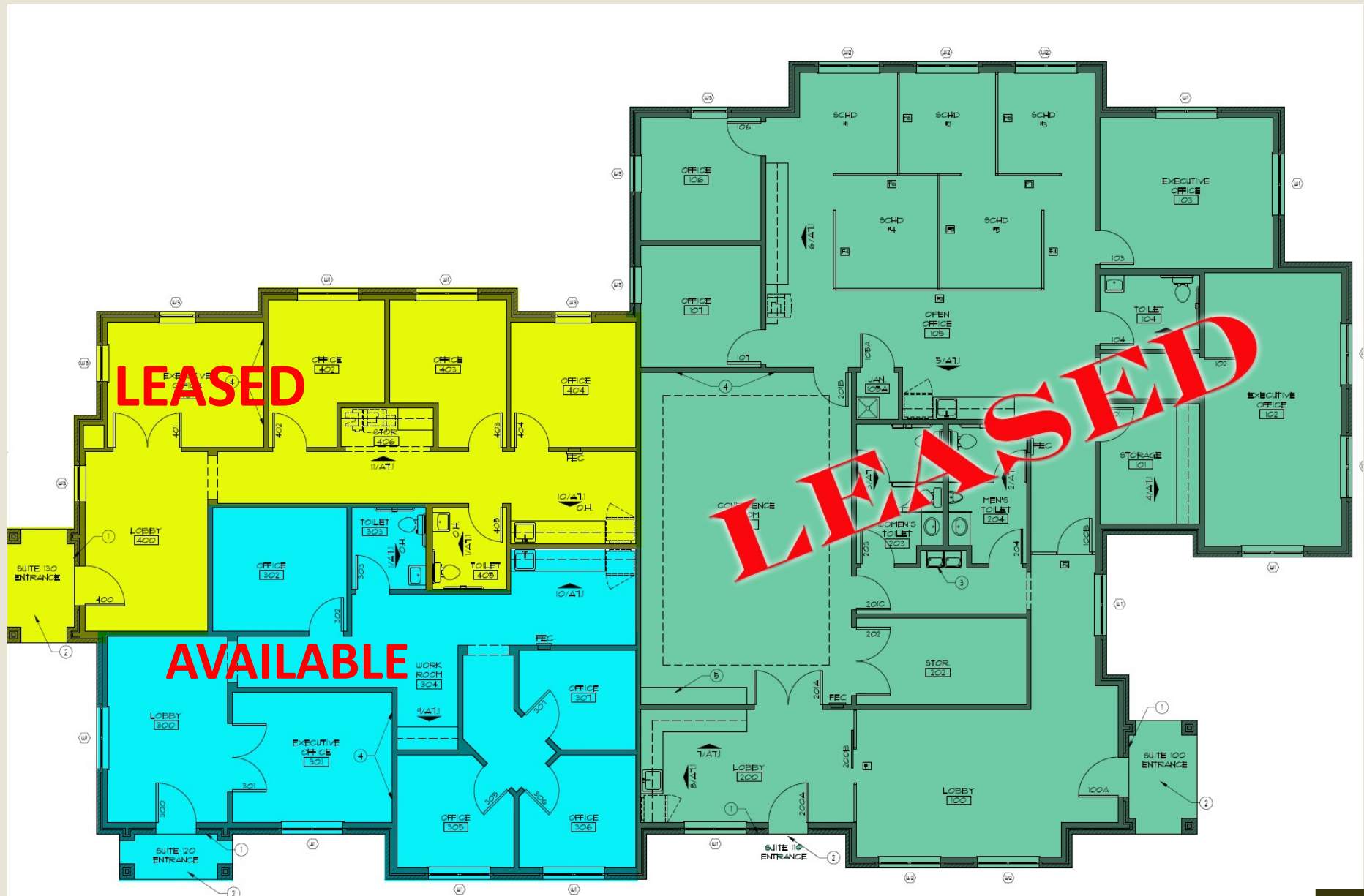





**CONTACT INFORMATION**

**PAUL BLIGHT**

Partner

C: 214.682.7192

O: 214.637.4300

[pblight@glaciercommercial.com](mailto:pblight@glaciercommercial.com)

**STACEY YEARIAN**

Vice President

C: 214.682.7192

O: 214.637.4300

[yearian@glaciercommercial.com](mailto:yearian@glaciercommercial.com)

**KIMBALL LAKES OFFICE PARK | 2101 Kirkwood Blvd Suite 120 Southlake TX 76092**



[glaciercommercial.com](http://glaciercommercial.com)

©2024 Glacier Commercial Realty L.P.

All rights reserved. The information contained herein was obtained from sources believed to be reliable. It is subject to verification. The presentation of this property is submitted subject to errors, omissions, change of price or conditions, prior to sale or lease, or withdrawal without notice