

# POTOMAC INDUSTRIAL CENTER

STREAM

9610 GUNSTON COVE ROAD  
LORTON, VA 22079



## PRIME WAREHOUSE LOCATION

**21,987 SF  
AVAILABLE**

## AVAILABILITIES

**Suite E** 21,987 SF: 4 Docks, 1 Drive-In

## FEATURES

- ▶ 1 Minute Drive To Lorton I-95 Exit
- ▶ 1,000 SF Office
- ▶ Multiple Docks & Drive Ins
- ▶ 22'-26' Ceiling Heights
- ▶ 24' X 50' Column Spacing
- ▶ Free Surface Parking
- ▶ High Speed Fiber Internet
- ▶ Clear I-95 Visibility

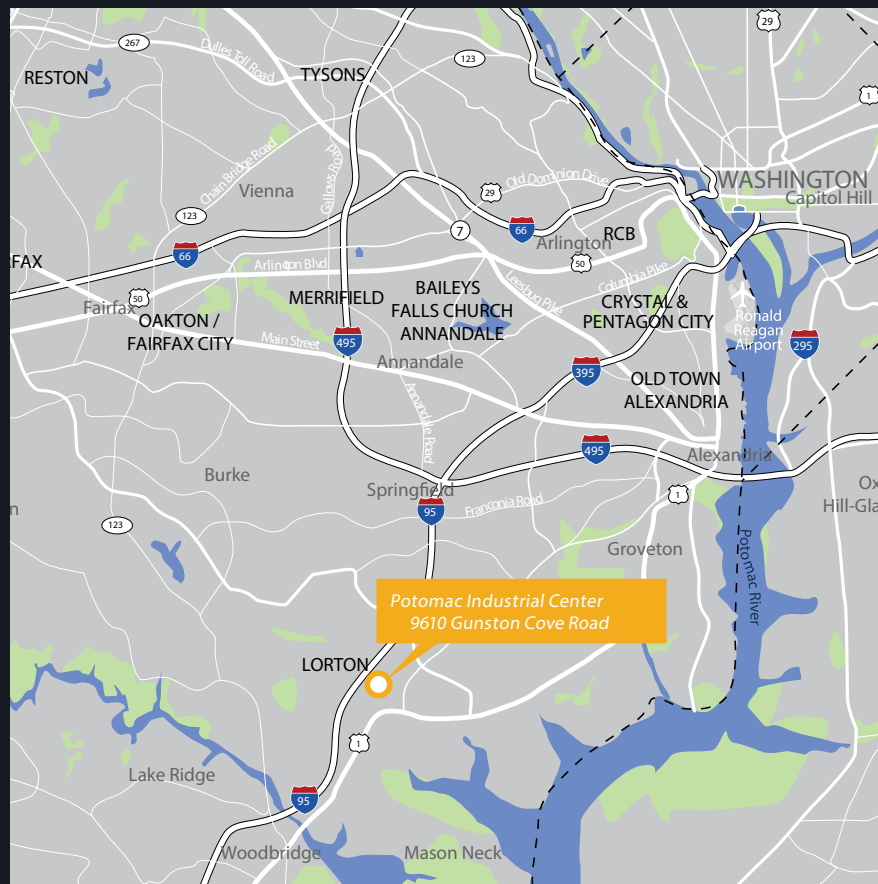

SITE PLAN



FLOOR PLAN

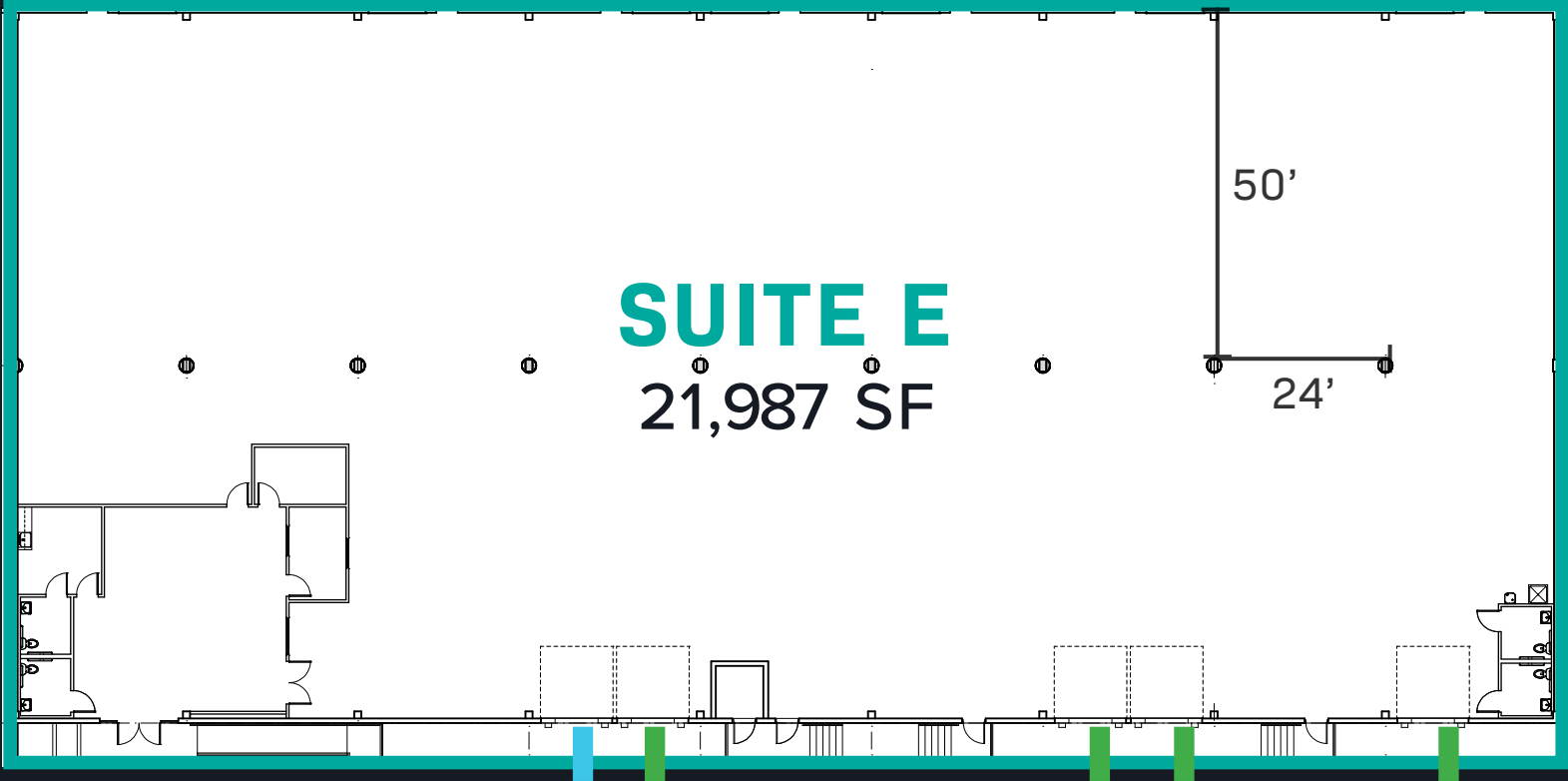

21,987 SF  
4 DOCKS 1  
DRIVE-IN

**KEY**

- DOCK
- DRIVE-IN





LORTON RD

LORTON RD



GUNSTON COVE RD

LORTON MARKET ST

**POTOMAC**  
INDUSTRIAL CENTER

E



**CAULLEY DERINGER**  
703.705.2907  
caulley.deringer@streamrealty.com

**ANDREW HASSETT**  
703.705.2921  
andrew.hassett@streamrealty.com

**STEVE CLOUD**  
703.705.2918  
steve.cloud@streamrealty.com