

# 410W207

INWOOD | MANHATTAN





## RETAIL



- › 100' FROM THE **1** SUBWAY TRAIN
- › DIRECTLY ADJACENT TO MTA BUS STOP
- › ON-SITE PARKING
- › ALL USES CONSIDERED
- › DOUBLE-HEIGHT STOREFRONTS WITH UP TO 18' CEILINGS
- › DIRECT ACCESS TO STORAGE SPACE ON THE LOWER LEVEL
- › RESIDENTIAL BUILDING ABOVE WILL INCLUDE 700 UNITS
- › SURROUNDING BUILDINGS WILL BRING AN ADDITIONAL 1,000 UNITS ONLINE IN 2025

# FLOOR PLAN



# 410W207

**30,000 SF OF RETAIL AVAILABLE**  
**ALL USES CONSIDERED**

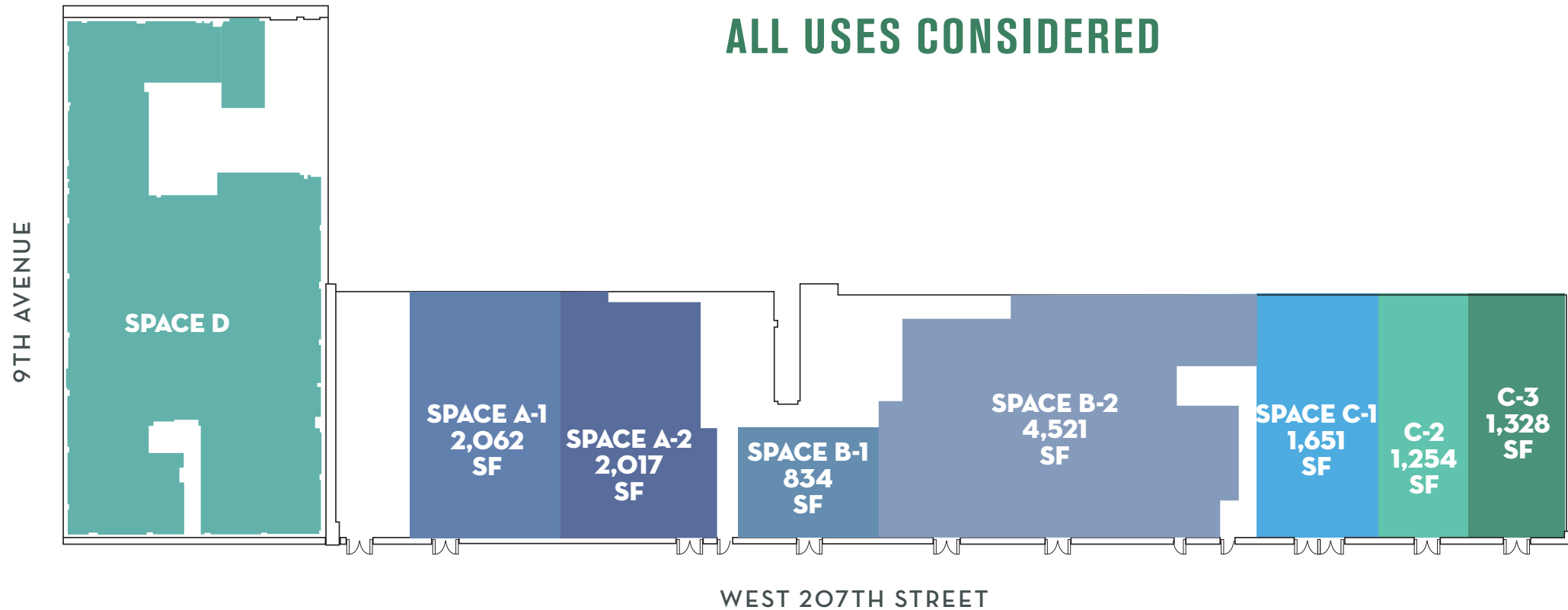

\*SUGGESTED DIVISIONS ONLY

SPACE-D

POSSIBLE DIVISIONS



# 410W207

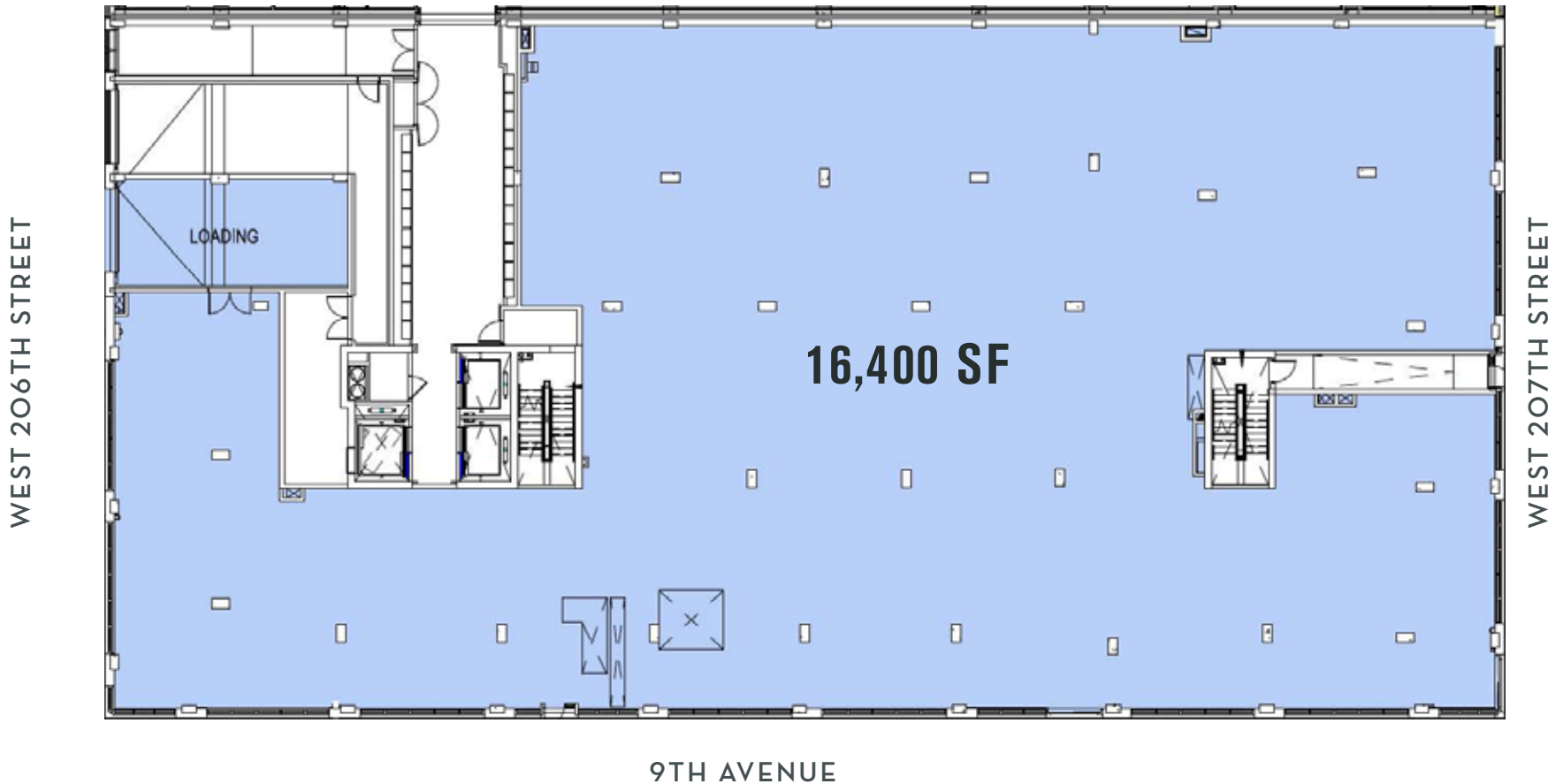

# SPACE-D

## POSSIBLE DIVISIONS



# 410W207

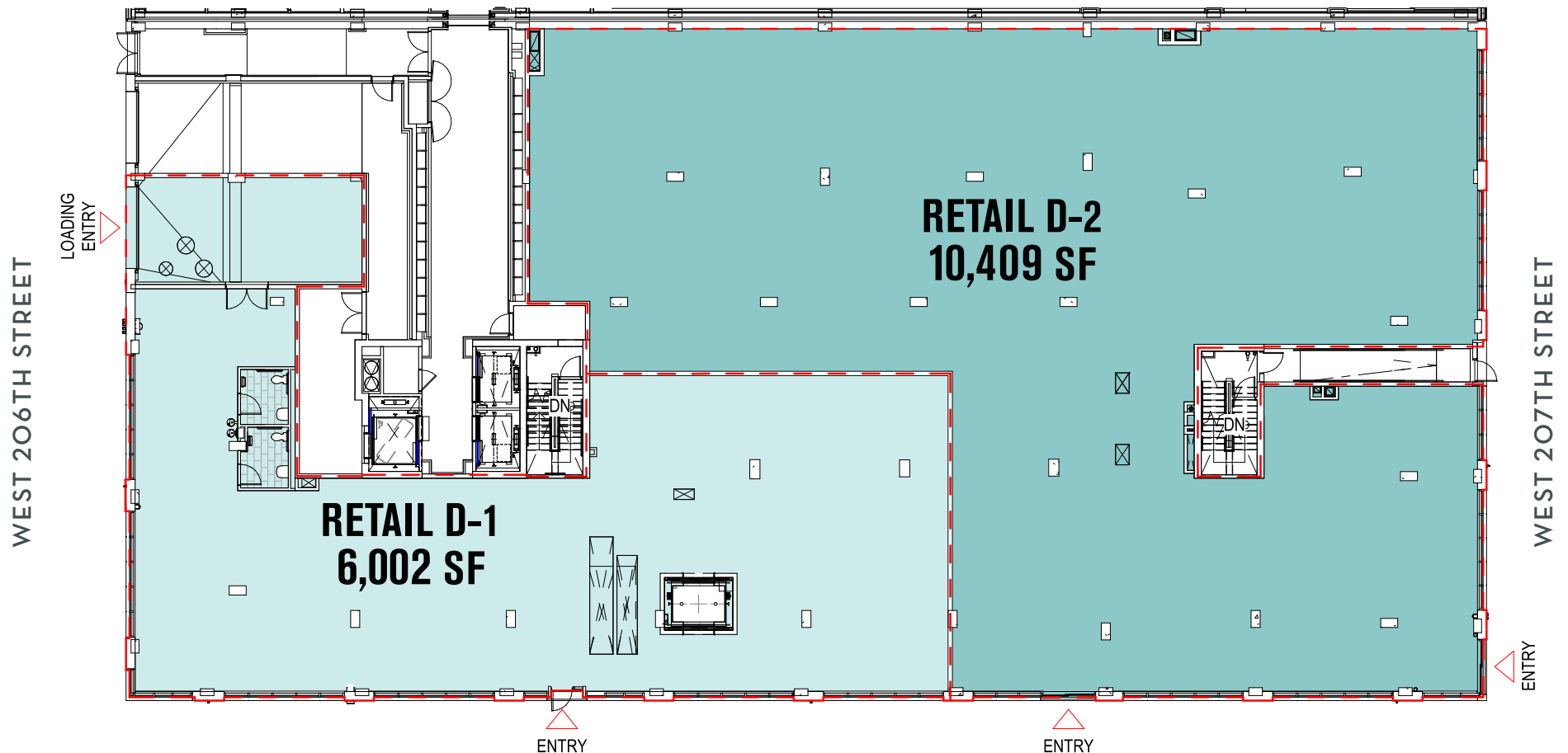

NOTE: OPTION 1 REQUIRES ADDITION OF 2ND  
STOREFRONT ENTRY DOOR IN RETAIL D-1

SPACE-D

POSSIBLE DIVISIONS



# 410W207

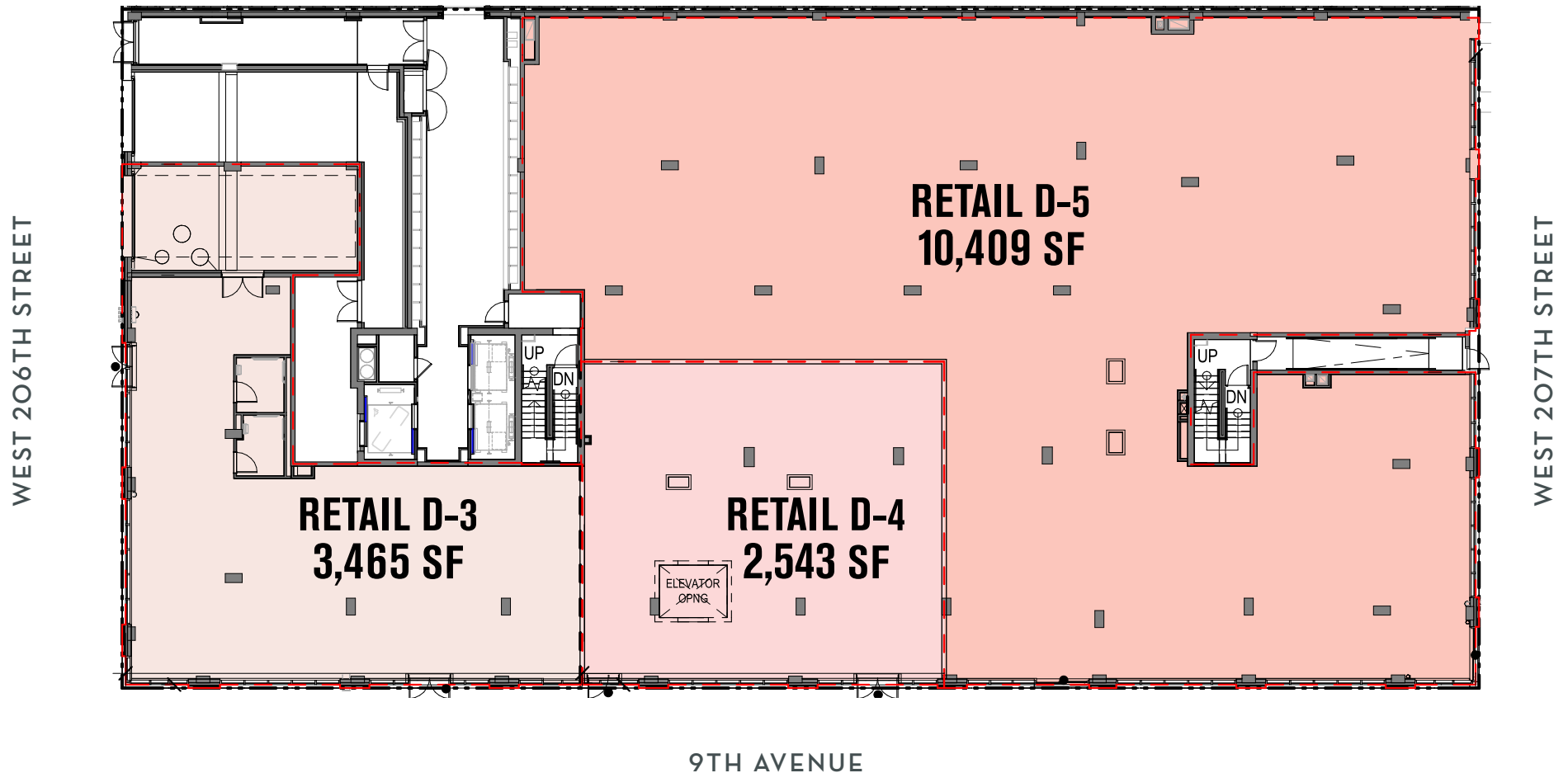

# ZONING

## BALANCE OF SHERMAN LANDING DEVELOPMENT

# 410W207



- In addition to 410 West 207th Street, four blocks to the South and East were upzoned and will commence development in future:

- **Site 2:** 620 units
- **Site 3:** 160 units
- **Site 4:** 600 units
- **Site 5:** 330 units

- A transformed Ninth Avenue will create a cohesive center of community-supporting retail

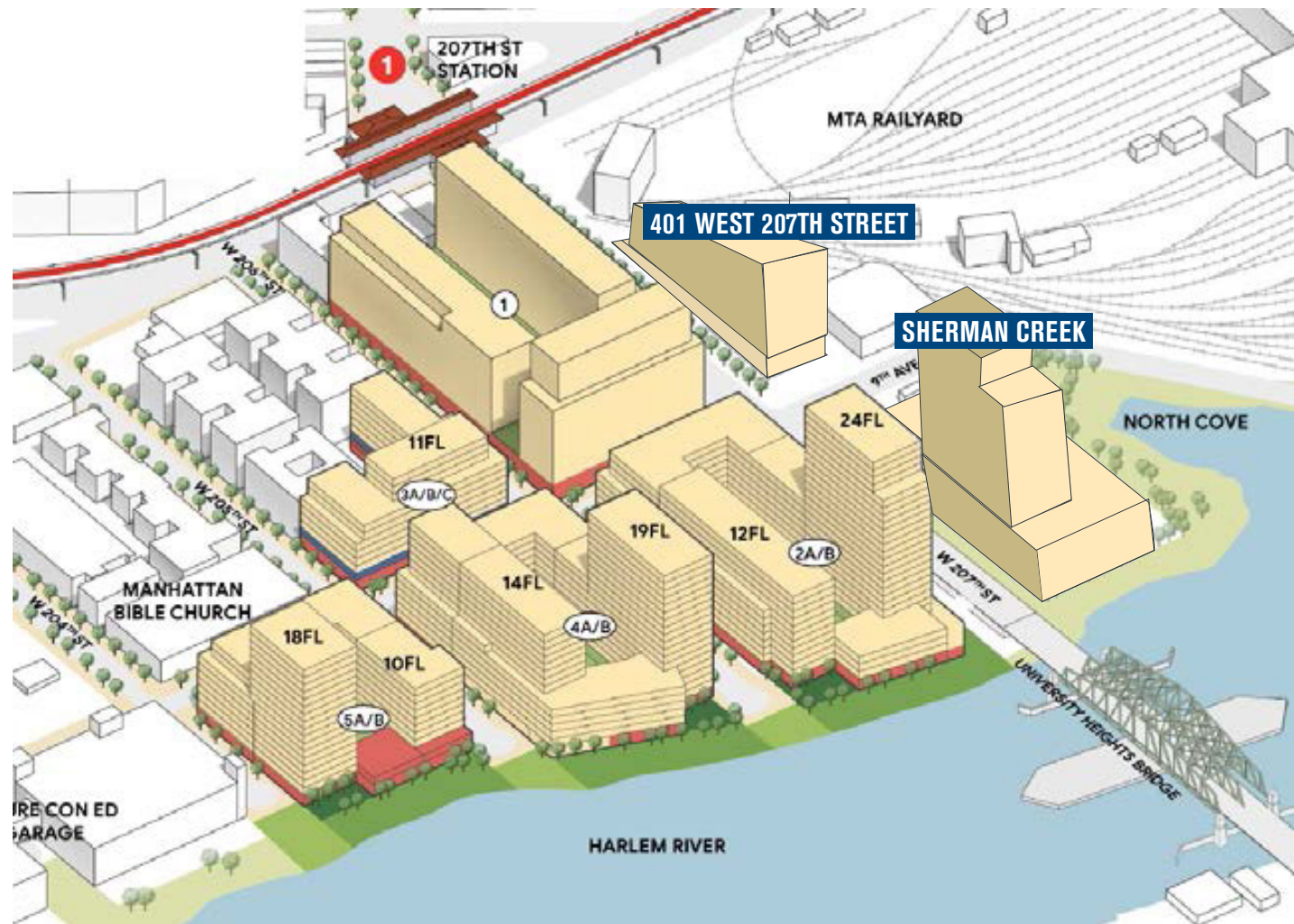



# ZONING

PLANNED INWOOD  
WATERFRONT IMPROVEMENTS



# 410W207



# ZONING

## DEVELOPMENT IN THE BRONX



# 410W207

### **FORDHAM LANDING SOUTH (FIRST PHASE)**

- First phase of development is south of the University Heights Bridge
- First building contains 350,000 SF medical/community facility building, 505 apartments, public waterfront esplanade

### **SECOND PHASE (NORTH OF BRIDGE) TO COMMENCE REZONING**

## DEMOGRAPHICS

### .5 MILE



POPULATION  
**39,210**



AVG. HH INCOME  
**\$81,905**



% POPULATION  
ANNUAL GROWTH  
(2024-2029)  
**3.04%**

### .75 MILE



POPULATION  
**82,177**



AVG. HH INCOME  
**\$79,788**



% POPULATION  
ANNUAL GROWTH  
(2024-2029)  
**2.91%**

## AVERAGE DAILY TRAFFIC VOLUME

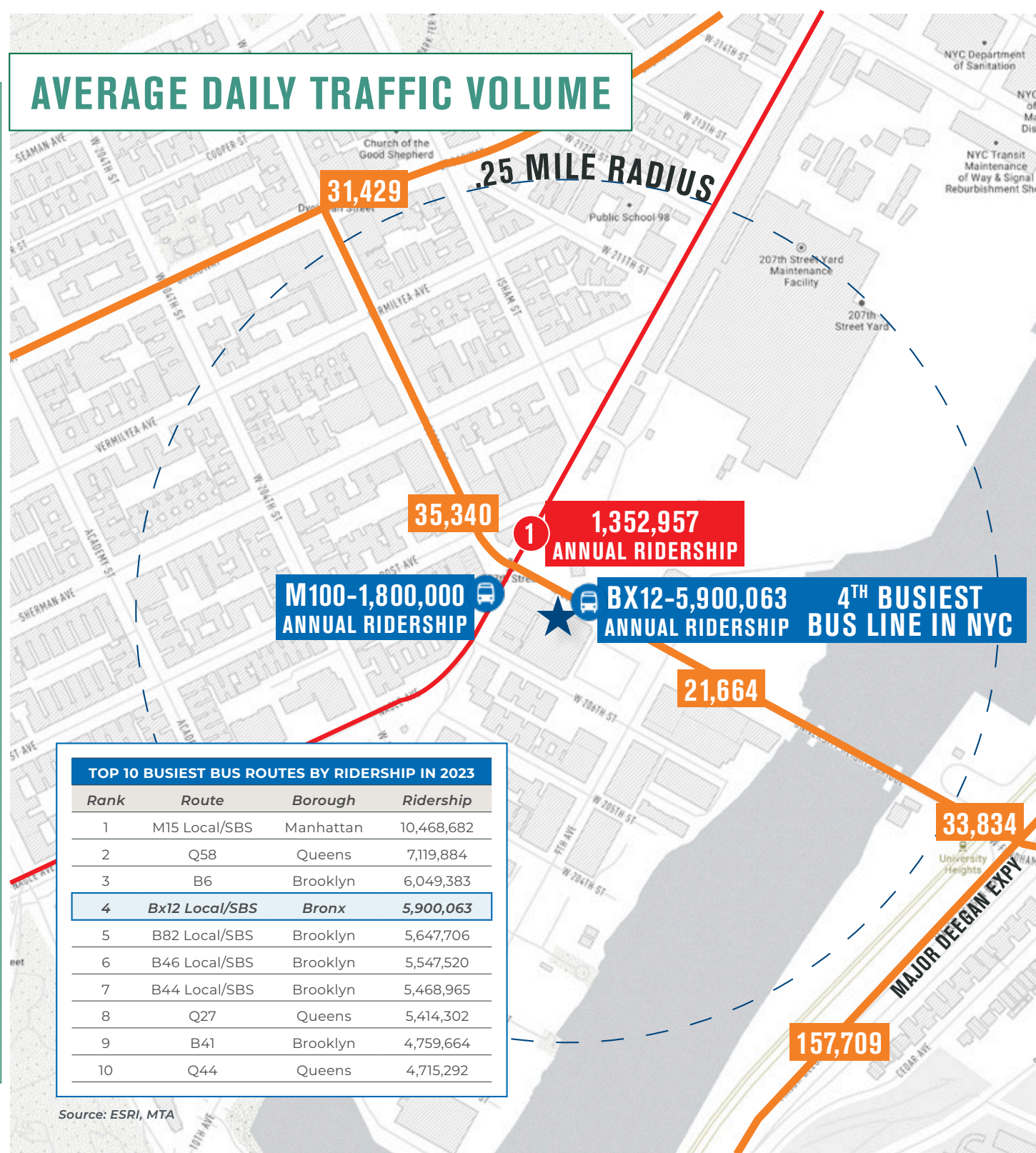

Source: ESRI, MTA

## AREA TENANTS



# 410W207

Bank of America 

Foot Locker



CHASE 



GNC  
LIVE WELL.

Capital One

T-Mobile



CVS/pharmacy

Apple Bank 



Walgreens



# 410W207

INWOOD | MANHATTAN

FOR MORE INFORMATION, PLEASE CONTACT EXCLUSIVE AGENTS:

**STEVE LORENZO**

PRINCIPAL

845.629.1640

[SLORENZO@LEE-ASSOCIATES.COM](mailto:SLORENZO@LEE-ASSOCIATES.COM)

**JEFFREY LOPEZ**

DIRECTOR

646.284.4047

[JLOPEZ@LEE-ASSOCIATES.COM](mailto:JLOPEZ@LEE-ASSOCIATES.COM)



**LEE &  
ASSOCIATES**

All information supplied is from sources deemed reliable and is furnished subject to errors, omissions, modifications, removal of the listing for sale or lease, and to any listing conditions, including the rates and manner of payment of commissions for particular offerings imposed by principals or agreed by this Company, the terms of which are available to principals or duly licensed brokers. Any square footage dimensions set forth are approximate.