

# THE TINSLEY

AT INTERSTATE 78

717 ROUTE 173, GREENWICH TOWNSHIP NJ 08804



ANTICIPATED DELIVERY Q1 2029



185,850 SF

36' CLEAR

43.36 ACRES

DIVISIBLE



THE TINSLEY @ I-78

# 185,850 SQ FT

717 ROUTE 173, GREENWICH TWP NJ 08804

## INTERIOR SPECIFICATIONS

185,850 SQ FT  
TOTAL AVAILABLE SPACE

TO SUIT  
OFFICE

210' x 885'  
BUILDING DIMENSIONS

56' x 56'  
COLUMN SPACING

60'  
SPEED-BAY

36'  
CLEAR HEIGHT

7"  
FLOOR SLAB

ESFR  
FIRE SPRINKLER

LED  
LIGHTING SYSTEM

4,000 A, 480 V, 3 PH (34.5 KV NEARBY)  
POWER

60 MIL TPO, R-25 (SOLAR READY)  
ROOFING SYSTEM

## EXTERIOR SPECIFICATIONS

43.36  
ACRES

335 (43 EV)  
CAR PARKING

74  
TRAILER PARKING

REAR SIDE  
LOADING FORMAT

32  
LOADING DOCK DOORS

4  
DRIVE-IN DOORS

185'  
TRUCK COURT DEPTH

PILOT & TA TRAVEL CENTER  
TRUCK FUELING STATIONS (0.1 MILES)

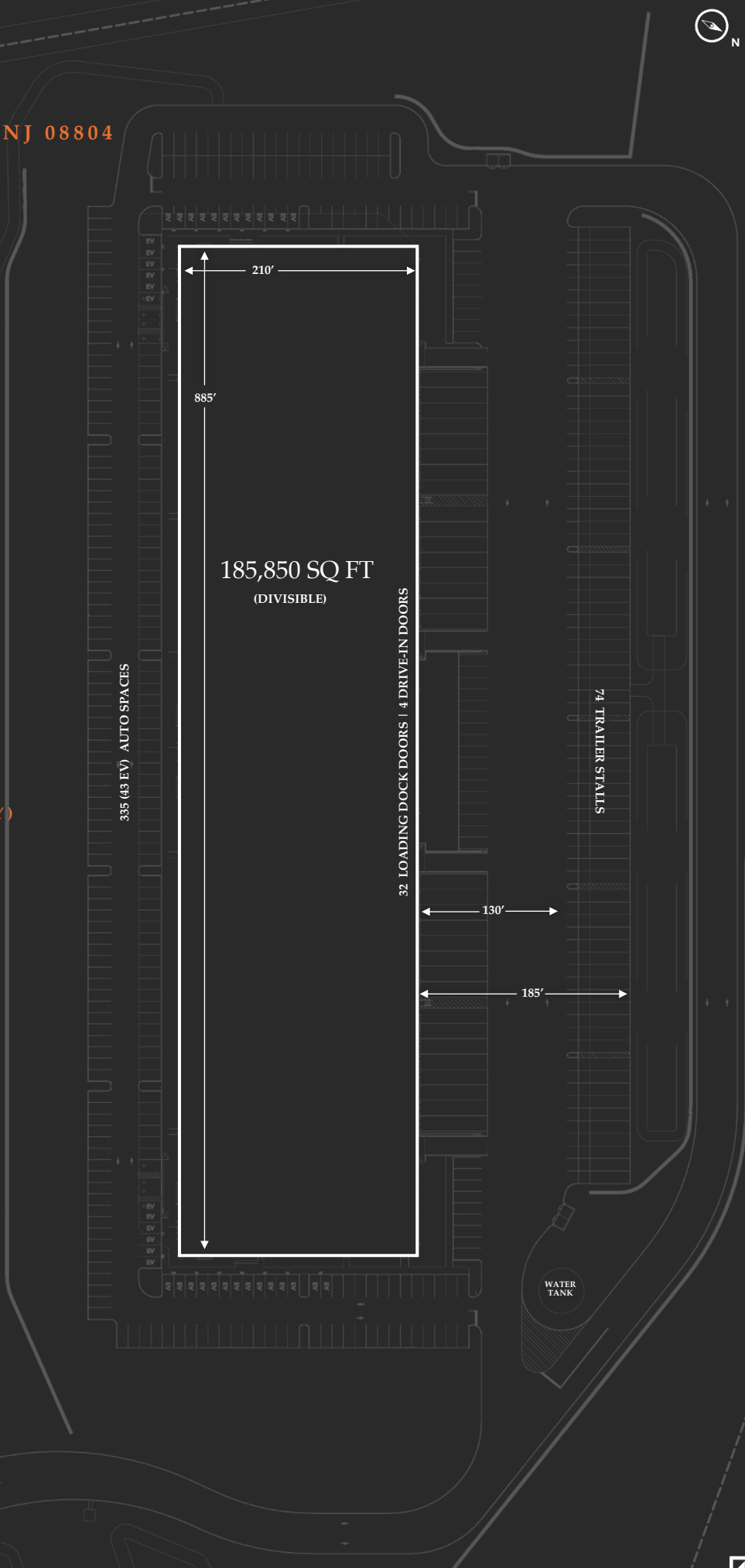

THE TINSLEY @ I-78

# 185,850 SQ FT

717 ROUTE 173, GREENWICH TWP NJ 08804



M. CUOMO BRIDGE



TINSLEY @ I-78

20 MILES

40 MILES

60 MILES

40°65'93.4"N 75°08'39.1"W

## CENTRAL NJ

DISTANCE TO MAJOR CITIES

NEW YORK CITY NY  
62 MILES (TOLL FREE)

PHILADELPHIA PA  
67 MILES (TOLL FREE)

WASHINGTON DC  
208 MILES

BOSTON MA  
275 MILES





# THE TINSLEY

AT INTERSTATE 78

717 ROUTE 173, GREENWICH TOWNSHIP NJ 08804

ROUTE 173

ANTICIPATED DELIVERY Q1 2029

LEASING INQUIRIES, PLEASE CONTACT

## NICK DEPAOLERA

(973) 270-4684 | [NICK@D4PROPERTIESLLC.COM](mailto:NICK@D4PROPERTIESLLC.COM)

62 MAIN ST, BLOOMINGDALE NJ 07403

Disclaimer. This is not an offer or acceptance of an offer to lease space. A lease will only be offered or made in a written agreement signed by landlord. No representation or warranty of any kind is made by landlord unless set forth in a written definitive lease executed by the landlord.

