

# 20 Pidgeon Hill Drive, Suite 201

Sterling, VA 20165 | 2nd Floor | 10 Offices + 5 Cubes + Conference + Kitchen

## 3,000 SF

v6 — Revised Layout | Feb 2026

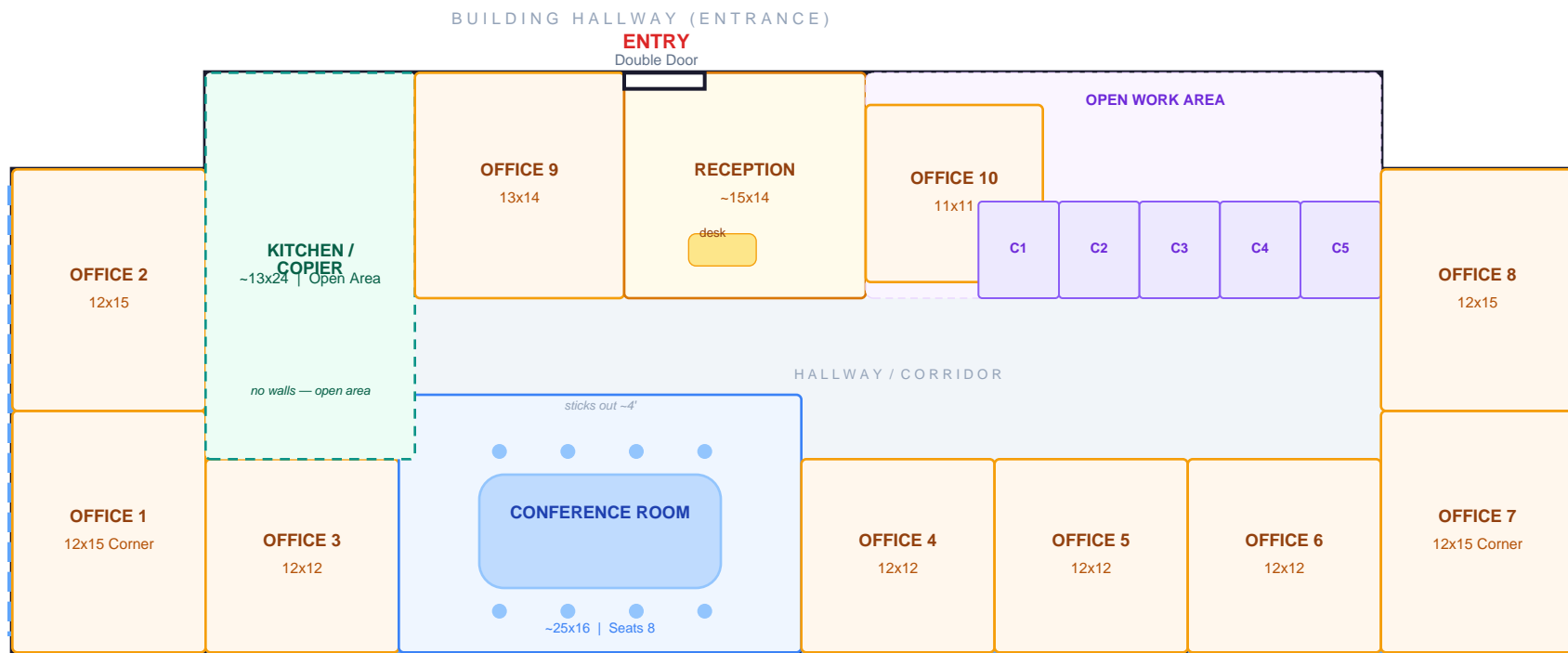

FRONT OF BUILDING — PARKING LOT VIEWS

- Private Office
- Cubicle
- Conference
- Kitchen (Open)
- Reception
- Hallway
- Window

Layout approximate — based on walkthrough. Not to scale. v6 Revised — Feb 2026.