

# 2344-2350 STANWELL DRIVE | FOR LEASE

OFFICE/FLEX SPACE IN CONCORD, CALIFORNIA

**\$1.65 PSF MG**



**Matt Hatfield**

Senior Director

925.296.3310

[matt.hatfield@tricommercial.com](mailto:matt.hatfield@tricommercial.com)

LIC: #01937755

**Clayton Temple**

Sales & Leasing Associate

925-296-3311

[clayton.temple@tricommercial.com](mailto:clayton.temple@tricommercial.com)

LIC: #02006440

# 2350 STANWELL DRIVE

**HIGHLY IMPROVED UNITS WITH  
±1,600 SF - 6,400 SF OF OFFICE/FLEX SPACE**

- Modified gross lease
- Well maintained building with attractive landscaping and good parking
- Excellent central, commuter Concord location with good freeway access

**LEASE AT \$1.65 PSF**

**\*2344-2346  
AVAILABLE W/90  
DAYS NOTICE**

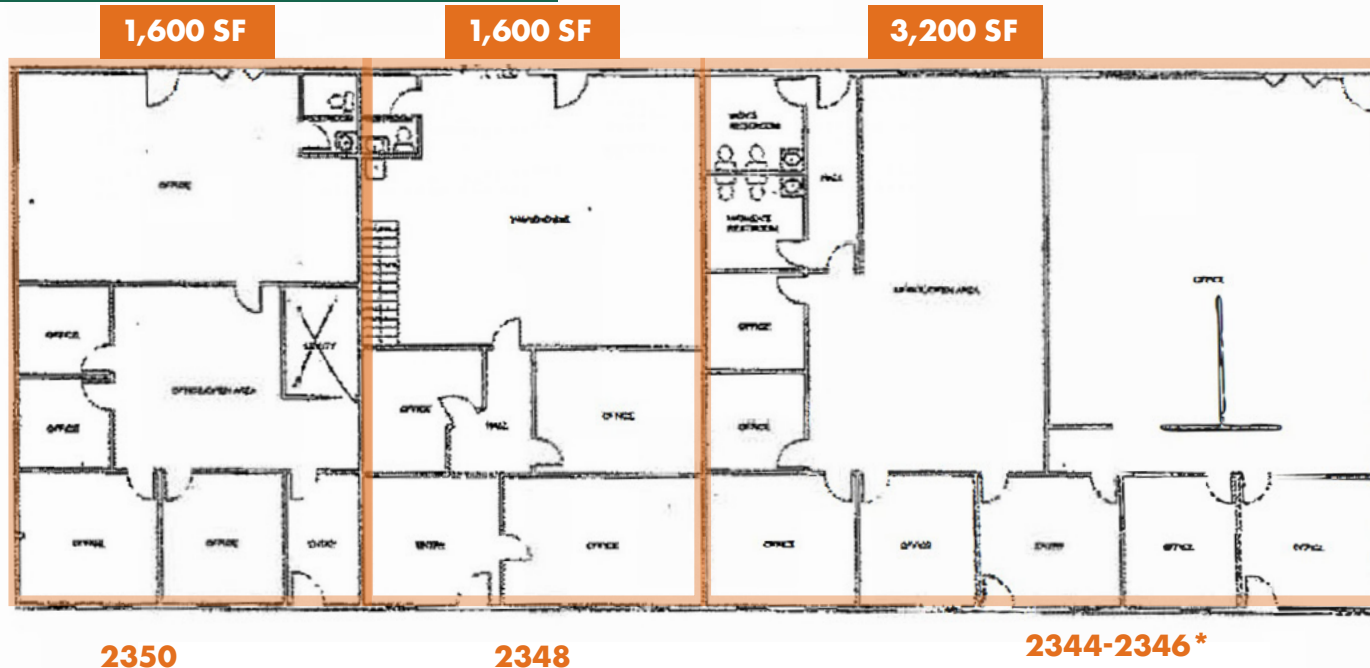

**Matt Hatfield**  
925-296-3310  
matt.hatfield@tricommercial.com  
LIC: #01937755

**Clayton Temple**  
925-296-3311  
clayton.temple@tricommercial.com  
LIC: #02006440



www.tricommercial.com

# 2344-2350 STANWELL DR

**HIGHLY IMPROVED UNIT WITH  
±6,400 SF OF OFFICE/FLEX SPACE**

**CONTIGUOUS SUITES UP TO ±6,400 SF**

**LEASE AT \$1.65 PSF**



## **Matt Hatfield**

925-296-3310  
matt.hatfield@tricommercial.com  
LIC: #01937755

## **Clayton Temple**

925-296-3311  
clayton.temple@tricommercial.com  
LIC: #02006440



[www.tricommercial.com](http://www.tricommercial.com)