



ENCINO *Village* *Coming Soon!*

Grocery | Restaurant | Retail | Beauty | Boutique Fitness | Medical



16650 VENTURA BOULEVARD | ENCINO, CALIFORNIA

Highlights



SUBJECT PROPERTY RENDERINGS



- Country Market Style Project featuring \pm 24,000 SF of tastefully curated flagship anchor and shop spaces, delivering 2025
- Located on 2+ AC at the prominent signalized corner of Ventura Blvd. & Petit Ave. in Encino - *perhaps the most affluent and yet under-serviced retail market in Los Angeles*
- Walking distance to over 4.8 Million SF of high-rise office & medical buildings with a daytime population of nearly 100,000+ people within 3 miles
- Excellent access & visibility with multiple points of ingress and egress
- Irreplaceable & massive pylon signage opportunities
- At grade parking ratio in excess of \pm 6 : 1000 SF with roughly 140 parking spots
- AHHI nearly \$200,000 within 1 mile
- All spaces entitled for food use

Proposed New Elevations

As Built

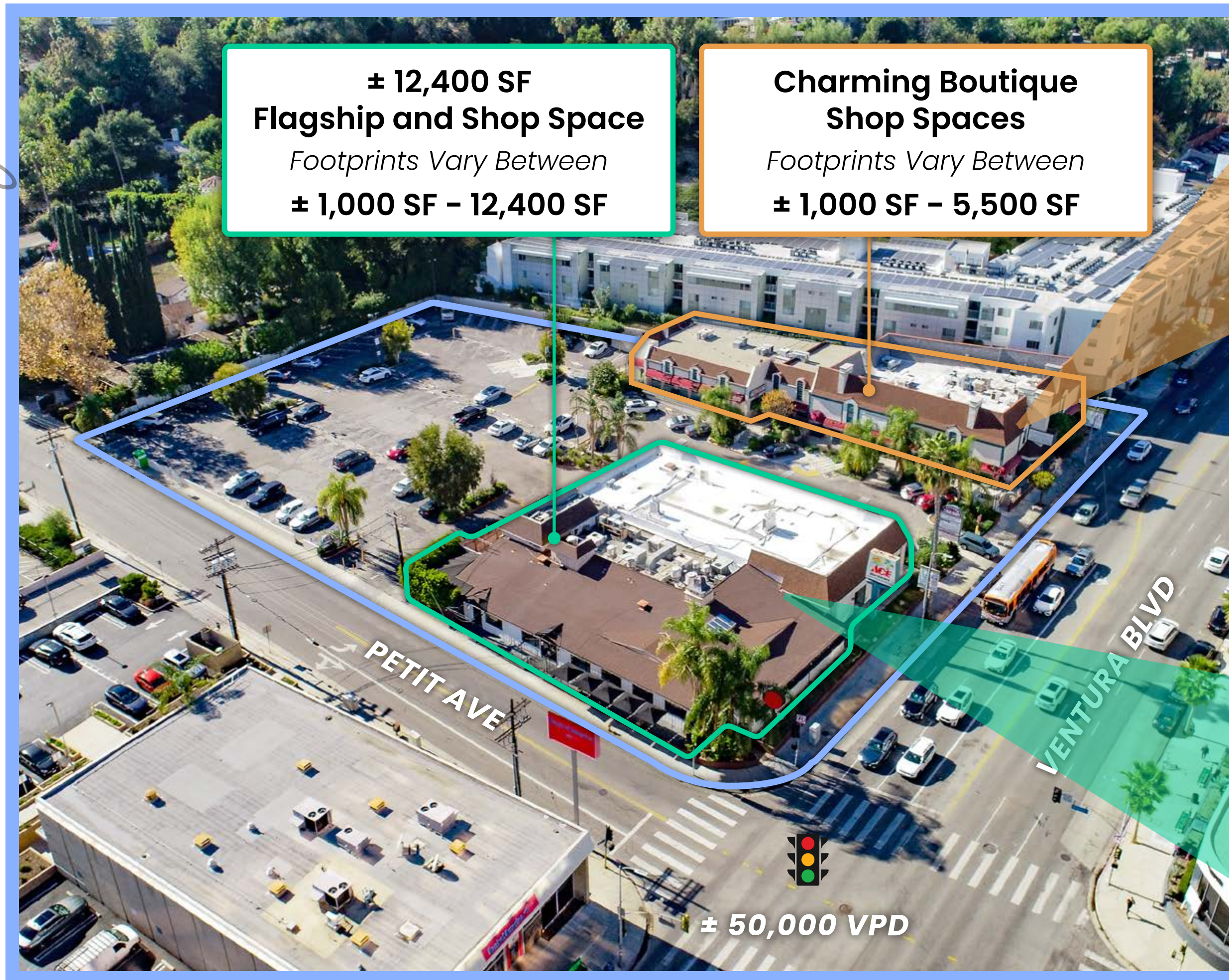

PROPOSED SITE PLAN | ENCINO VILLAGE

* FLOOR PLANS STILL FLEXIBLE

UNIT	SIZE
A1	± 1,740 SF
A2	± 1,740 SF
A3	± 1,740 SF
A4	± 1,740 SF
A5	± 1,086 SF
A6	± 1,092 SF
A7	± 1,092 SF
A8	± 1,092 SF
A9	± 1,092 SF
B1	± 1,585 SF
B2	± 2,172 SF
B3	± 1,627 SF
B4	± 1,213 SF
B5	± 1,342 SF
B6	± 1,211 SF
B7	± 1,013 SF

± 12,400 SF

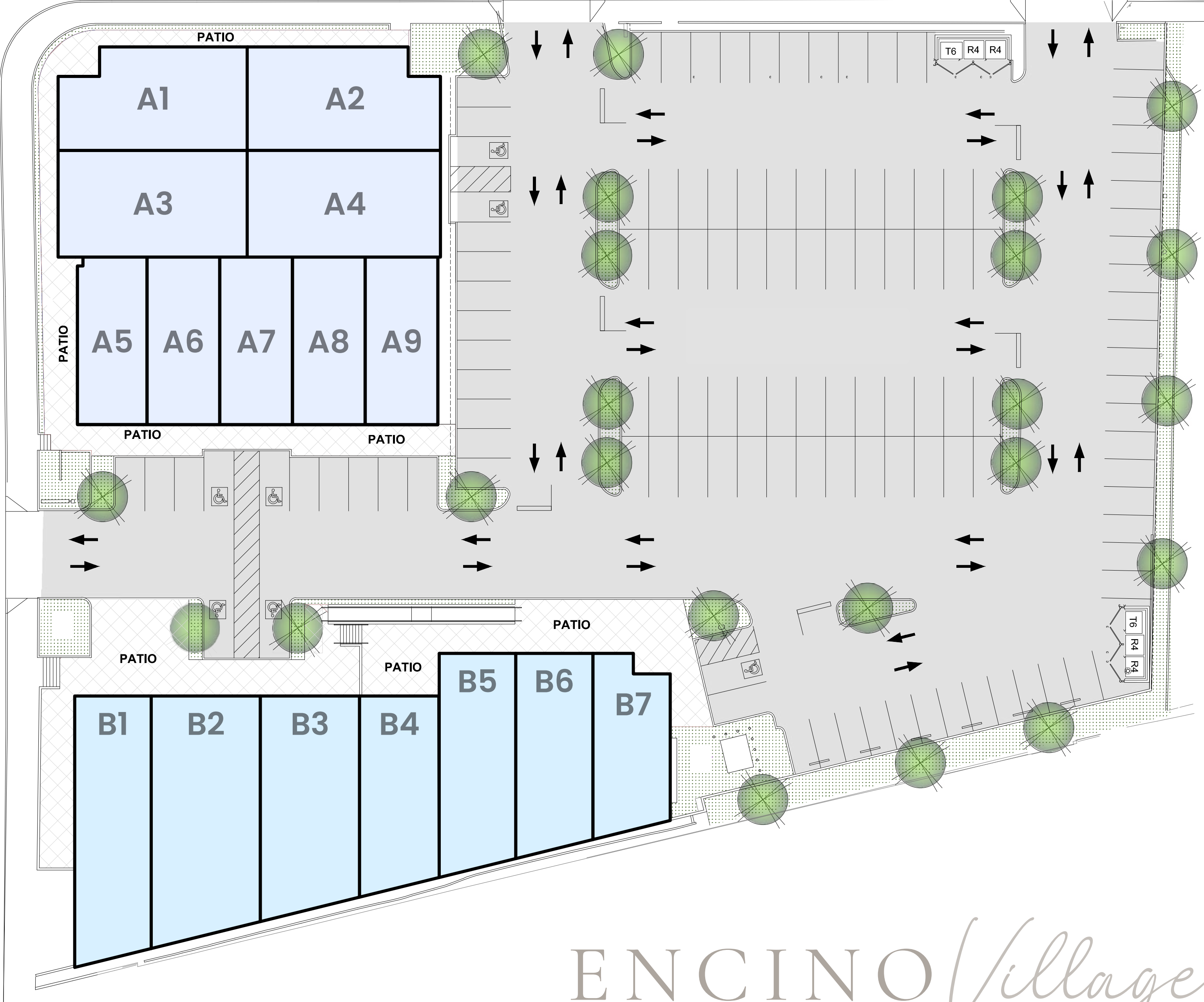

ENCINO Village

ENCINO PLACE



 California PIZZA KITCHEN
 Scratch | Bar & Kitchen
Cabaret Tehran



Walgreens
 DAVENPORT'S
RESTAURANT

BENIHANA
Lusy's Sadaf

AVALON
 APARTMENTS | 131 UNITS
 The UPS Store  
 THE MASSAGE PLACE · CLAUDINE ·
KITCHEN + BAKESHOP
Simple Ingredients. Expert Craft.

ENCINO MARKETPLACE



amazonfresh FedEx
CHASE  **Planet Beauty**
See's CANDIES  

 Encino Hospital Medical Center



Gelson's





Cane's
 CHICKEN FINGERS
 COMING SOON



SUPERCUTS

ENCINO
Village





Maria's
NEIGHBORHOOD + ITALIAN KITCHEN



BANK OF AMERICA 

Mercedes-Benz

VENTURA BLVD

PETIT AVE

± 50,000 VPD

EQUINOX

ENCINO Village

LEGADO ENCINO APARTMENTS
APARTMENTS | 125 UNITS

Smart & Final

Mercedes-Benz

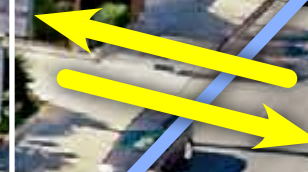

SIGNAGE OPPORTUNITY

SIGNAGE OPPORTUNITY

SIGNAGE OPPORTUNITY

BANK OF AMERICA



± 50,000 VPD

ENCINO *Village*

16650 VENTURA BOULEVARD | ENCINO, CALIFORNIA



PEGASUS ASSET MANAGEMENT INC.

1901 Avenue of the Stars, Suite 630

Los Angeles, CA 90067

(310) 691-1350

CA DRE LIC # 02119442

www.pegasusam.com

The information contained in this Leasing Package is proprietary and strictly confidential. It is intended to be reviewed only by the party receiving it from Pegasus Asset Management and should not be made available to any other person or entity without the written consent of Pegasus Asset Management. This Leasing Package has been prepared to provide summary, unverified information to prospective purchasers, and to establish only a preliminary level of interest in the subject property.

The information contained herein is not a substitute for a thorough due diligence investigation. Pegasus Asset Management has not made any investigation, and makes no warranty or representation, with respect to the income or expenses for the subject property, the future projected financial performance of the property, the size and square footage of the property and improvements, the presence or absence of contaminating substances, PCB's or asbestos, the compliance with State and Federal regulations, the physical condition of the improvements thereon, or the financial condition of the business prospects of any tenants, or any tenant's plans or intentions to continue its occupancy of the subject property.

The information contained in this Leasing Package has been obtained from sources we believe to be reliable; however, Pegasus Asset Management has not verified, and will not verify, any of the information contained herein, nor has Pegasus Asset Management conducted any investigation regarding these matters and makes no warranty or representation whatsoever regarding the accuracy or completeness of the information provided. Some or all of the photographs contained within may have been altered from their original format. All potential buyers must take appropriate measures to verify all of the information set forth herein.

LEASING TEAM (424) 363-7800

Andrew Cohen

EXECUTIVE VICE PRESIDENT | LEASING

acohen@pegasusam.com

LIC # 01996379 (CA)

Emmet Pierson

SENIOR ASSOCIATE | LEASING

epierson@pegasusam.com

LIC # 02048600 (CA)

Daniel Woznica

ASSOCIATE | LEASING

dwoznica@pegasusam.com

LIC # 02211034 (CA)

Josh Dembo

ASSOCIATE | LEASING

jdembo@pegasusam.com

LIC # 02242456 (CA)