

SKYPORT INDUSTRIAL PARK



FOR LEASE

6620 ESCONDIDO STREET | LAS VEGAS | NV | 89119

BRIAN RIFFEL, SIOR

+1 702 836 3773

brian.riffel@colliers.com

LIC. # NV-S.0043752

CHASE PAVLOV

+1 702 836 3731

chase.pavlov@colliers.com

LIC. # NV-S.0186416

TYLER JONES

+1 702 836 3754

tyler.jones@colliers.com

LIC. # NV-S.0169145

PROPERTY FEATURES

- ±9,904 SF – ±23,110 SF Available
- ±153,868 Total SF Industrial Park
- ±24' Clear Height
- ESFR Fire Sprinkler System
- Zoned IP (Industrial Park)
- 3-Phase Power
- Dock High Loading & Grade Level Doors
- ±150' Truck Court/Parking Area
- Skylights in Warehouse
- LED Lighting
- Close proximity to the I-215, I-15, the Las Vegas Strip, and Harry Reid International Airport

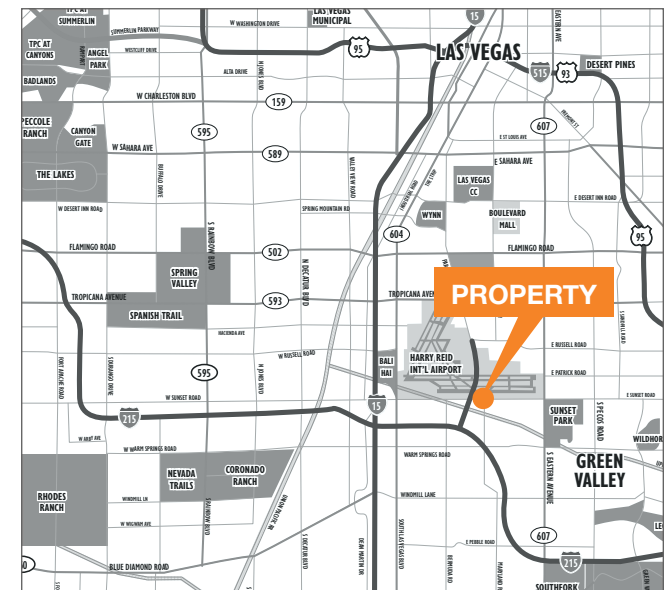

The information contained herein is believed to be accurate but is not warranted as to its accuracy and may change or be updated without notice. Seller or landlord makes no representation as to the environmental condition of the property and recommends purchaser's or tenant's independent investigation.

BUILDING B

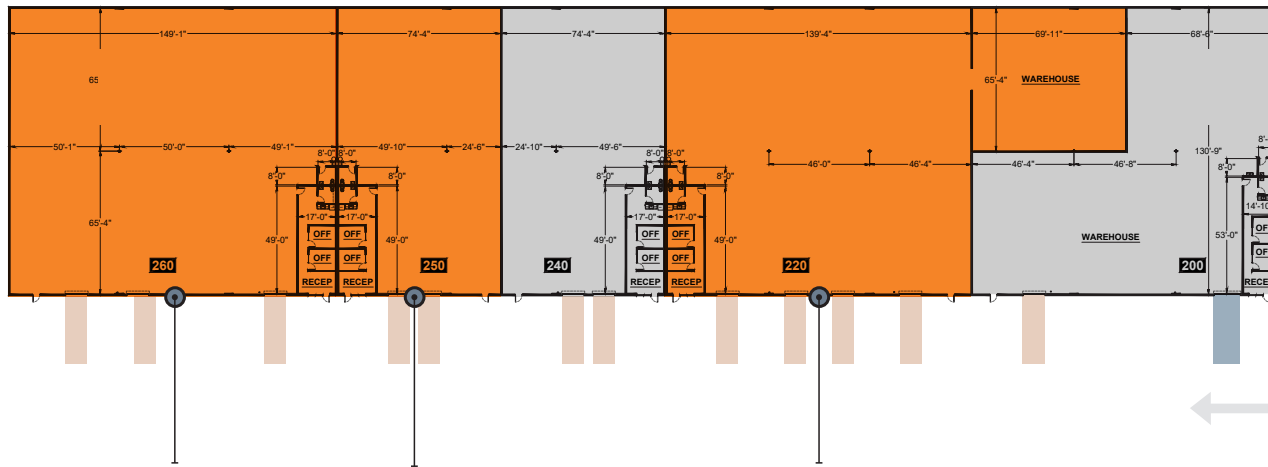

AVAILABLE
SUITE 260
±19,819 SF

AVAILABLE
SUITE 250
±9,904 SF

AVAILABLE
SUITE 220
±23,110 SF

ESCONDIDO STREET

SUITE 220

Building	B
Total SF	±23,110 SF
Office SF	±986 SF
WH SF	±22,124 SF
Asking Rate	\$1.20
NNN	\$0.19

SUITE 250

Building	B
Total SF	±9,904 SF
Office SF	±986 SF
WH SF	±8,918 SF
Asking Rate	\$1.30
NNN	\$0.19

SUITE 260

Building	B
Total SF	±19,819 SF
Office SF	±986 SF
WH SF	±18,833 SF
Asking Rate	\$1.22
NNN	\$0.19

For Illustration Purposes Only. Not To Scale.

DOCK LOADING DOOR
 GRADE LEVEL LOADING DOOR
 AVAILABLE
 OCCUPIED

SKYPORT INDUSTRIAL PARK



BUILDING B

SUITE 220

Building	B
Total SF	±23,110 SF
Office SF	±986 SF
WH SF	±22,124 SF
Asking Rate	\$1.20
NNN	\$0.19

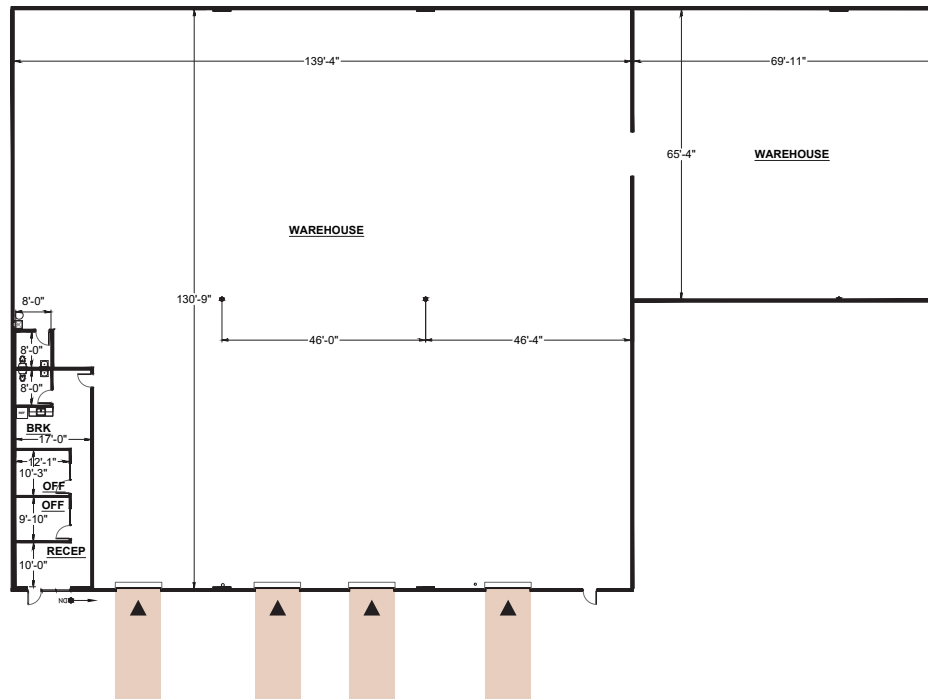

KEY PLAN



For Illustration Purposes Only. Not To Scale.

DOCK LOADING DOOR

FOR MORE INFORMATION

BRIAN RIFFEL, SIOR

+1 702 836 3773
 brian.riffel@colliers.com
 LIC. # NV-S.0043752

CHASE PAVLOV

+1 702 836 3731
 chase.pavlov@colliers.com
 LIC. # NV-S.0186416

TYLER JONES

+1 702 836 3754
 tyler.jones@colliers.com
 LIC. # NV-S.0169145

COLLIERS LAS VEGAS

6795 Agilysys Way, Suite 210
 Las Vegas, NV 89113
 www.colliers.com/lasvegas

SKYPORT INDUSTRIAL PARK

6620 Escondido Street
 Las Vegas, NV 89119



SKYPORT INDUSTRIAL PARK



BUILDING B

SUITE 250

Building	B
Total SF	±9,904 SF
Office SF	±986 SF
WH SF	±8,918 SF
Asking Rate	\$1.30
NNN	\$0.19

KEY PLAN

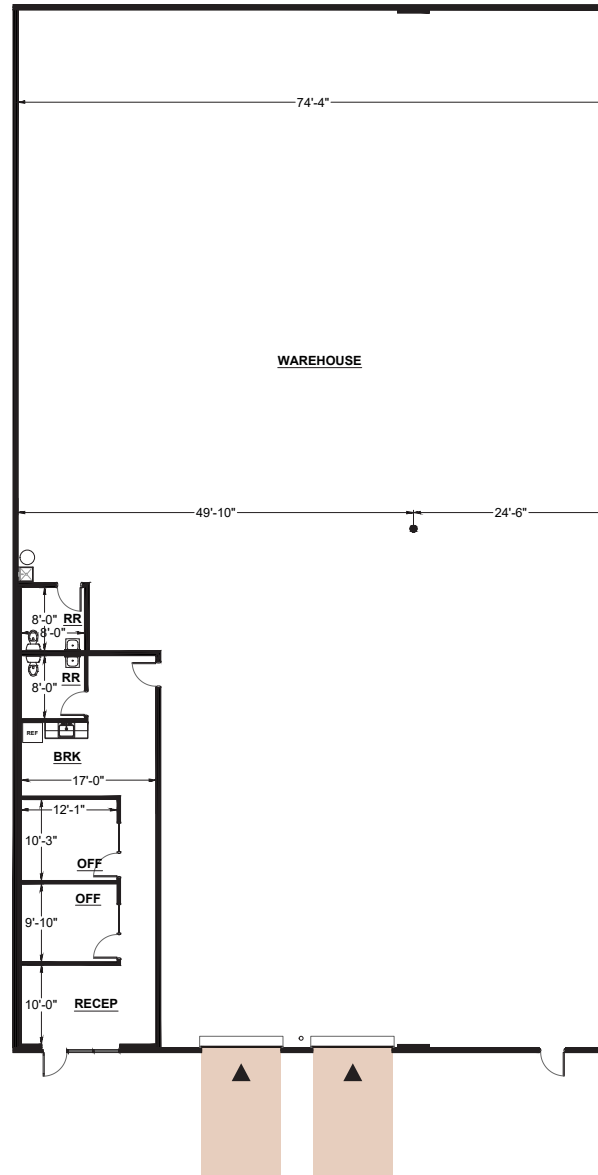
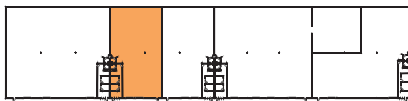

FOR MORE INFORMATION

BRIAN RIFFEL, SIOR

+1 702 836 3773
brian.riffel@colliers.com
LIC. # NV-S.0043752

CHASE PAVLOV

+1 702 836 3731
chase.pavlov@colliers.com
LIC. # NV-S.0186416

TYLER JONES

+1 702 836 3754
tyler.jones@colliers.com
LIC. # NV-S.0169145

COLLIERS LAS VEGAS

6795 Agilysys Way, Suite 210
Las Vegas, NV 89113
www.colliers.com/lasvegas

SKYPORT INDUSTRIAL PARK

6620 Escondido Street
Las Vegas, NV 89119



▲ For Illustration Purposes Only. Not To Scale.

▲ DOCK LOADING DOOR

SKYPORT INDUSTRIAL PARK



BUILDING B

SUITE 260

Building	B
Total SF	±19,819 SF
Office SF	±986 SF
WH SF	±18,833 SF
Asking Rate	\$1.22
NNN	\$0.19

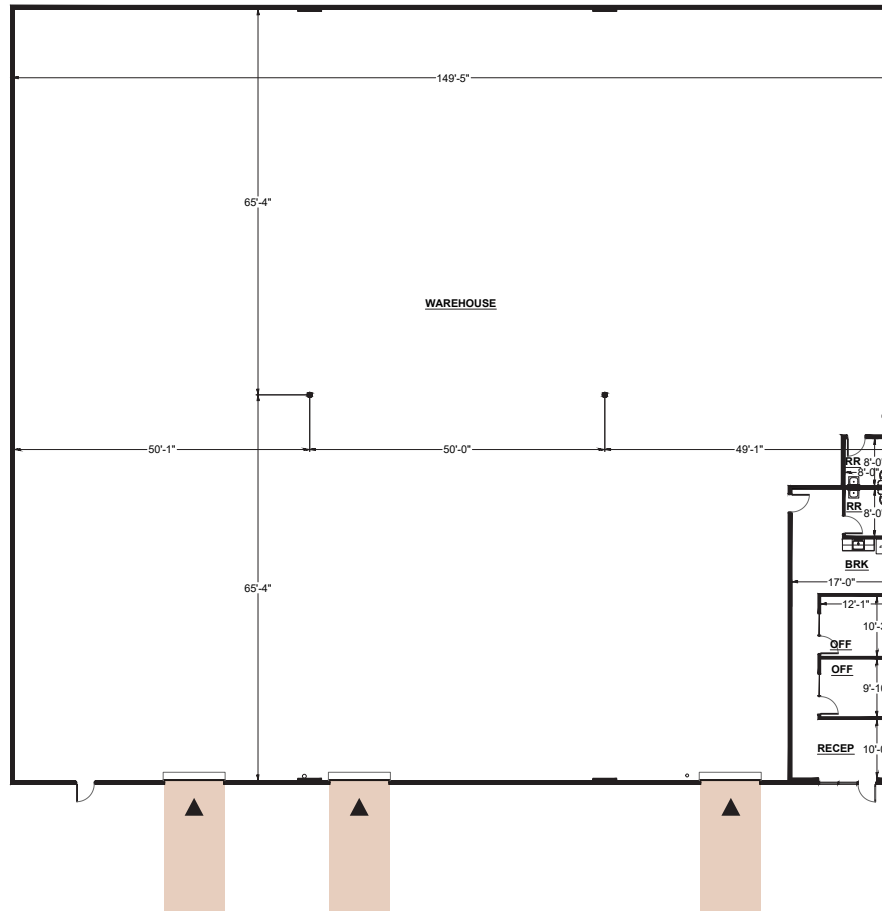

KEY PLAN

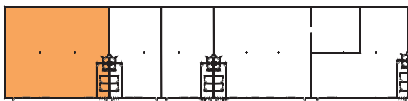

▲ For Illustration Purposes Only. Not To Scale.

▲ DOCK LOADING DOOR

FOR MORE INFORMATION

BRIAN RIFFEL, SIOR

+1 702 836 3773
brian.riffel@colliers.com
LIC. # NV-S.0043752

CHASE PAVLOV

+1 702 836 3731
chase.pavlov@colliers.com
LIC. # NV-S.0186416

TYLER JONES

+1 702 836 3754
tyler.jones@colliers.com
LIC. # NV-S.0169145

COLLIERS LAS VEGAS

6795 Agilysys Way, Suite 210
Las Vegas, NV 89113
www.colliers.com/lasvegas

SKYPORT INDUSTRIAL PARK

6620 Escondido Street
Las Vegas, NV 89119



SKYPORT INDUSTRIAL PARK



SKYPORT INDUSTRIAL PARK





SKYPORT INDUSTRIAL PARK

±9,904 SF – ±76,663 SF Available



FOR MORE INFORMATION

BRIAN RIFFEL, SIOR

+1 702 836 3773
brian.riffel@colliers.com
LIC. # NV-S.0043752

CHASE PAVLOV

+1 702 836 3731
chase.pavlov@colliers.com
LIC. # NV-S.0186416

TYLER JONES

+1 702 836 3754
tyler.jones@colliers.com
LIC. # NV-S.0169145

