

37-11 30th Street

Between 37th & 38th Avenues | Long Island City



37-11 30th Street

Between 37th & 38th Avenues | Long Island City

PROPERTY HIGHLIGHTS

- Brand new development in the heart of Long Island City
- Close to the Queensboro Bridge to Manhattan and Long Island Expressway
- Black iron venting & gas line in place

SIZE AVAILABLE:

7,000 SF Ground Floor
Commercial Space

FRONTAGE:

100' Wrap Around

CEILING HEIGHT:

14'

POSSESSION:

Immediate

TRANSPORTATION:

M R N W

NEIGHBORS:



ATOMIC WINGS

Vista
SKY LOUNGE



DUNKIN'

enterprise

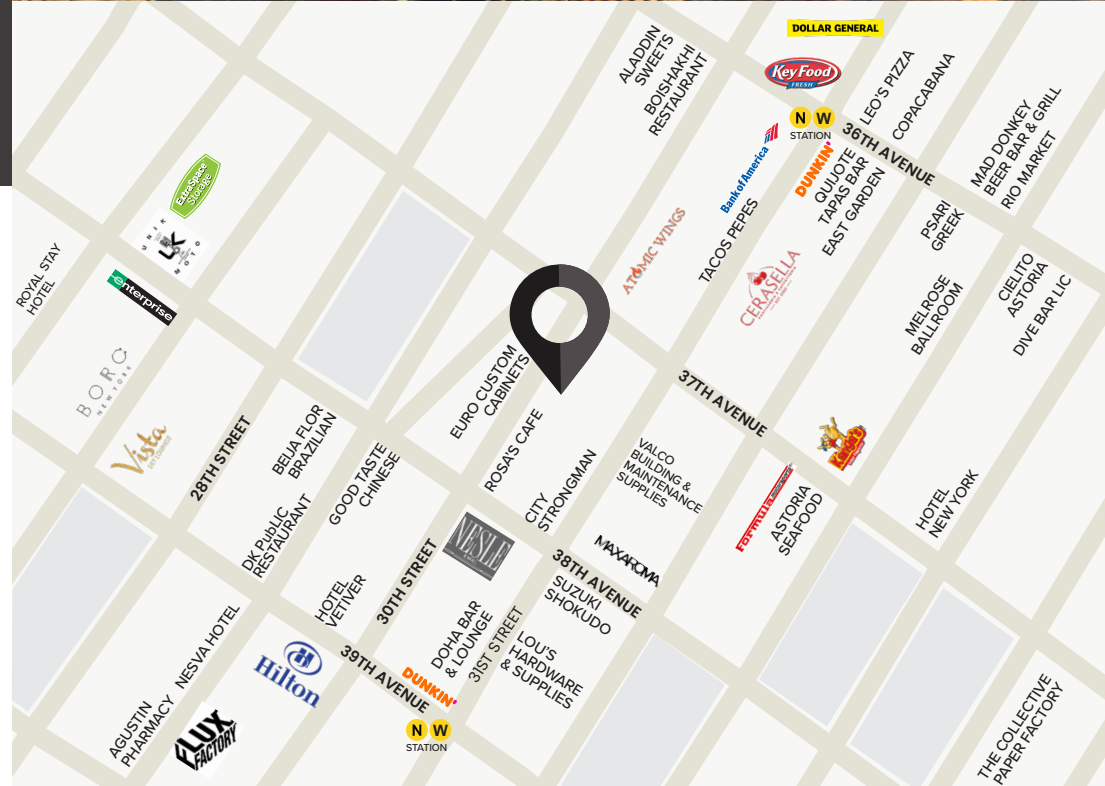

CONTACT OUR BROKERS FOR MORE INFORMATION:

JORDAN RAPHAN

JRaphan@ksrny.com

516.776.4771

MARC SITT

MSitt@ksrny.com

917.757.8863

AKRAM MOZEB

AMozeb@ksrny.com

646.897.4792



All information supplied in this marketing presentation and/or flyer is from sources deemed reliable and is furnished subject to errors, omissions, modifications, removal of listings from sale/lease and to any listing condition. Any square footage, dimensions, floor plans and/or technical data set forth are approximations and are subject to further elaboration/confirmation.

37-11 30th Street

Between 37th & 38th Avenues | Long Island City

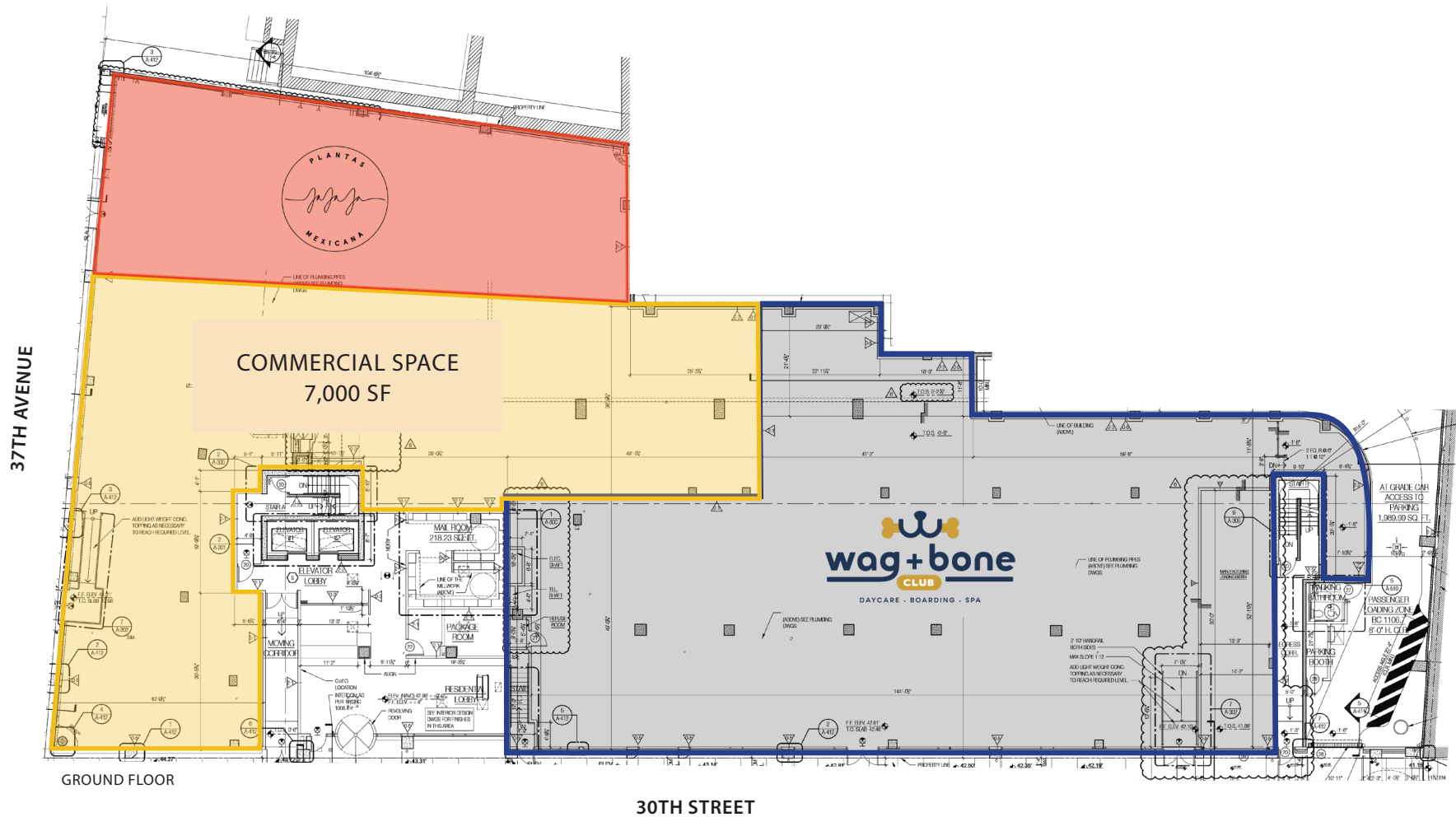

CONTACT OUR BROKERS FOR MORE INFORMATION:



All information supplied in this marketing presentation and/or flyer is from sources deemed reliable and is furnished subject to errors, omissions, modifications, removal of listings from sale/lease and to any listing condition. Any square footage, dimensions, floor plans and/or technical data set forth are approximations and are subject to further elaboration/confirmation.

JORDAN RAPHAN

JRaphan@ksrny.com

516.776.4771

MARC SITT

MSitt@ksrny.com

917.757.8863

AKRAM MOZEB

AMozebe@ksrny.com

646.897.4792