



PROPERTY AVAILABLE FOR LEASE OR GROUND LEASE



ALMA SCHOOL RD & BASELINE RD

MESA, AZ



property summary

| | | | |
|-------------|------------|---------|------------------|
| AVAILABLE | ±2,208 SF | PRICING | Call for Pricing |
| PARCEL SIZE | ±21,693 SF | ZONING | PAD |

LOCATION HIGHLIGHTS

- Located in Mesa, AZ half a mile south of U.S. 60
- Fully Improved Parcel.
- The surrounding area has a population of over 424,930 within a 5-mile radius, with average household incomes exceeding \$98,833 within a 5-mile radius.

NEARBY TENANTS



TRAFFIC COUNTS

Alma School Rd

N ±40,338 VPD (NB & SB)

S ±34,399 VPD (NB & SB)

Baseline Rd

E ±25,631 VPD (EB & WB)

W ±24,464 VPD (EB & WB)

ADOT 2023

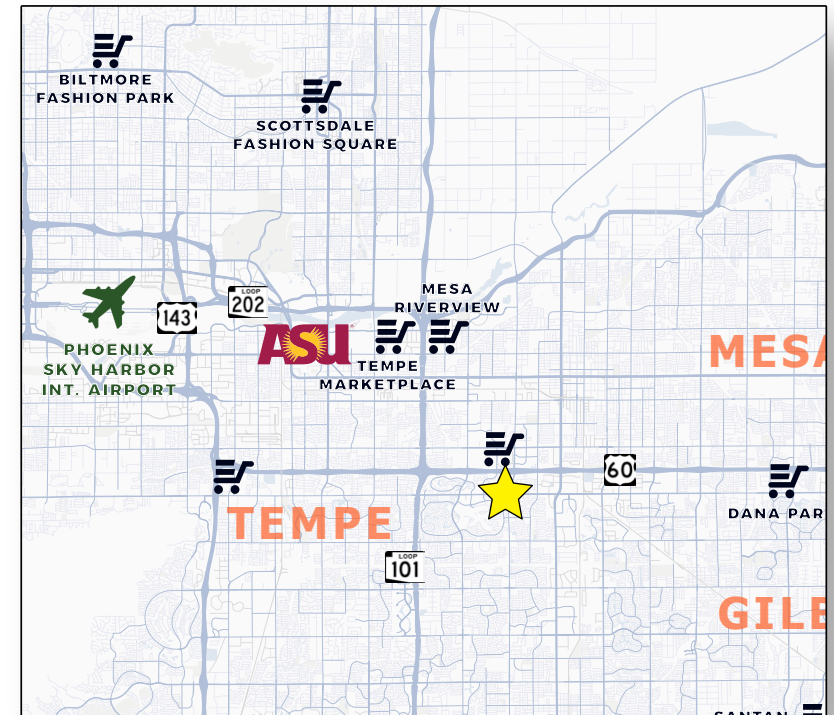

NWC

PROPERTY AVAILABLE FOR LEASE OR GROUND LEASE

ALMA SCHOOL RD & BASELINE RD





NWC

PROPERTY AVAILABLE FOR LEASE OR GROUND LEASE

ALMA SCHOOL RD & BASELINE RD





NWC

PROPERTY AVAILABLE FOR LEASE OR GROUND LEASE

ALMA SCHOOL RD & BASELINE RD



aerial zoom

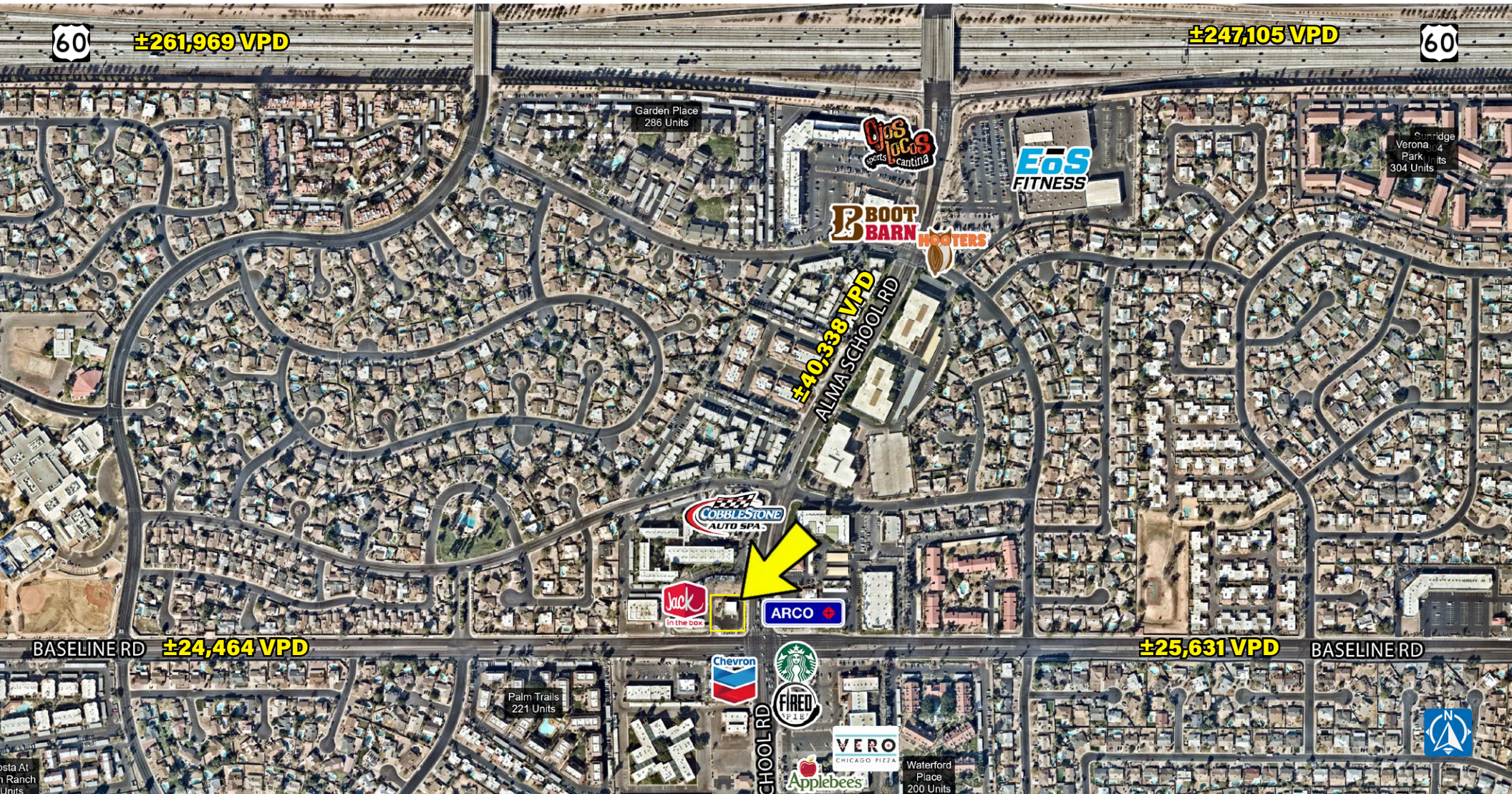

NWC

PROPERTY AVAILABLE FOR LEASE OR GROUND LEASE

ALMA SCHOOL RD & BASELINE RD



aerial wide

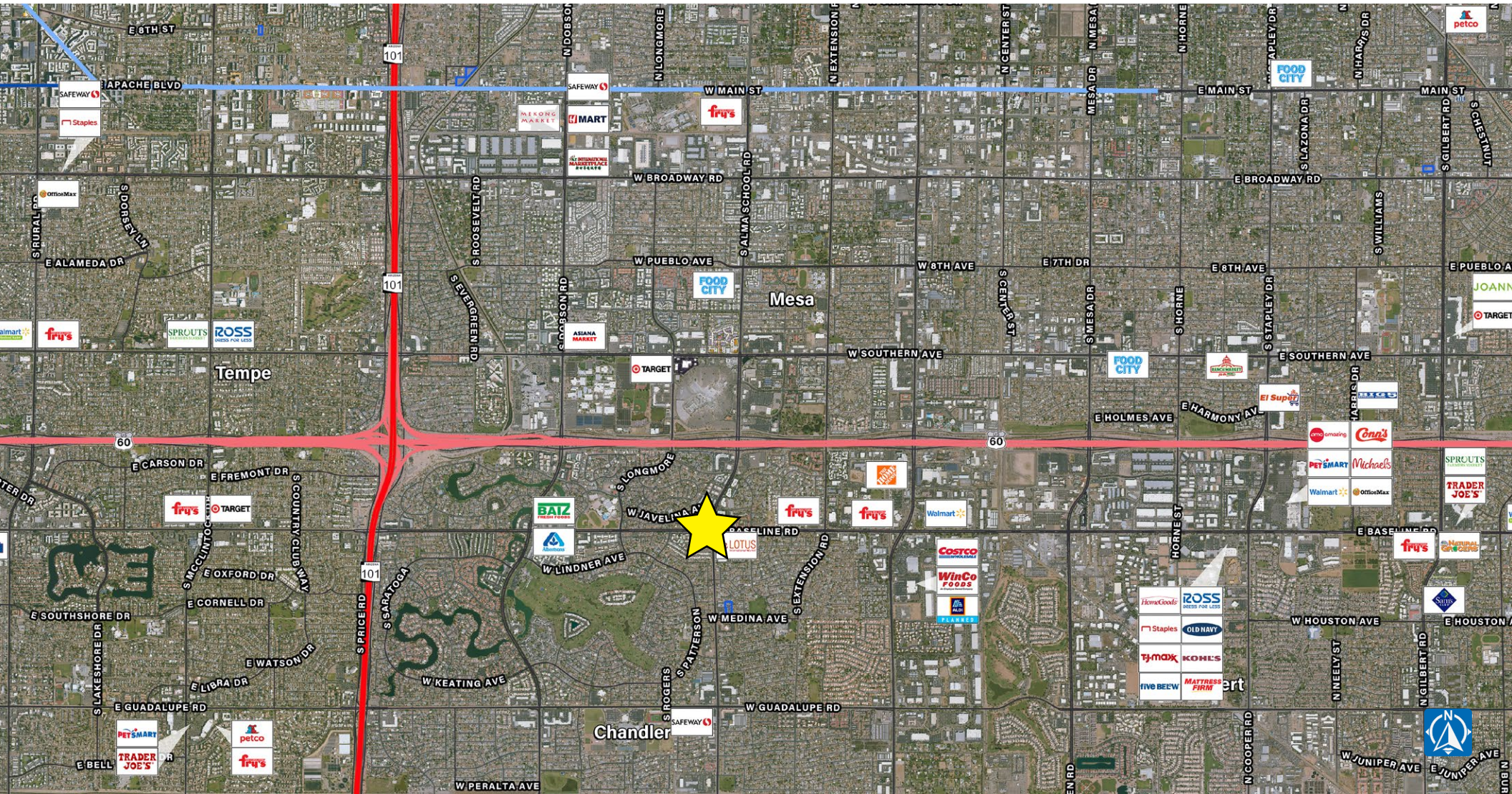

NWC

PROPERTY AVAILABLE FOR LEASE OR GROUND LEASE

ALMA SCHOOL RD & BASELINE RD



demographics

2024 ESRI

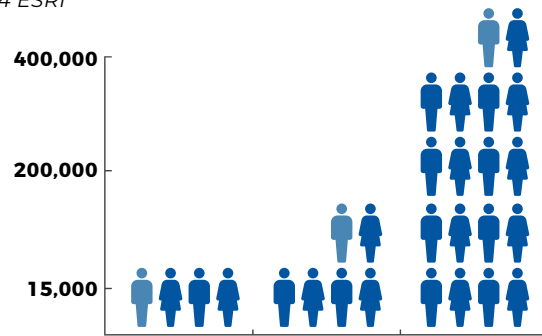

| | 1-Mile | 3-Mile | 5-Mile |
|-----------------------|--------|---------|---------|
| 2024 Total Population | 16,402 | 147,980 | 424,930 |
| 2029 Total Population | 16,277 | 152,203 | 436,857 |



| | Median HH Income | Average HH Income | Per Capita Income |
|--------|------------------|-------------------|-------------------|
| 1-Mile | \$80,592 | \$105,584 | \$45,328 |
| 3-Mile | \$73,348 | \$94,172 | \$38,289 |
| 5-Mile | \$75,950 | \$98,833 | \$39,026 |

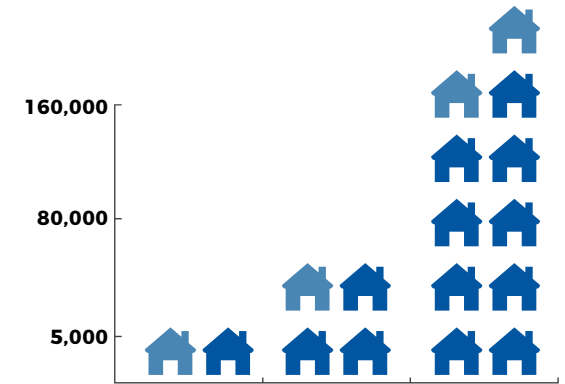

| | 1-Mile | 3-Mile | 5-Mile |
|-----------------|--------|--------|---------|
| 2024 Households | 7,004 | 59,461 | 166,732 |
| 2029 Households | 7,057 | 62,246 | 174,978 |

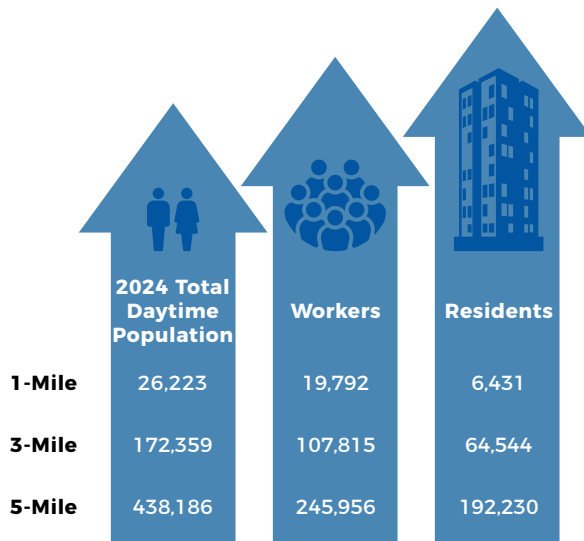

| | 2024 Total Daytime Population | Workers | Residents |
|--------|-------------------------------|---------|-----------|
| 1-Mile | 26,223 | 19,792 | 6,431 |
| 3-Mile | 172,359 | 107,815 | 64,544 |
| 5-Mile | 438,186 | 245,956 | 192,230 |

2024 Housing Units

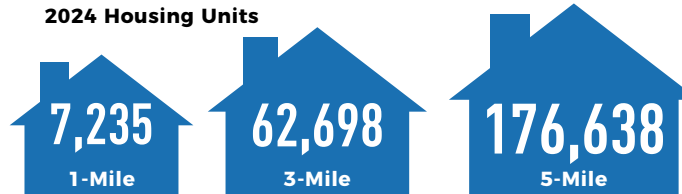

Owner Occupied

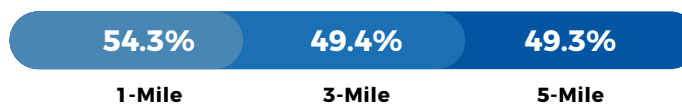

Renter Occupied

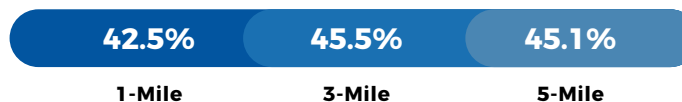

2024 Businesses

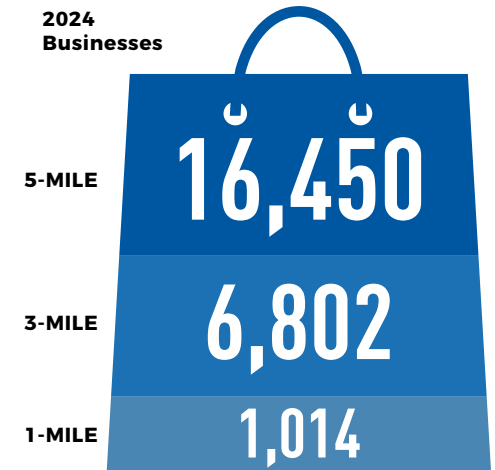

NWC

PROPERTY AVAILABLE FOR LEASE OR GROUND LEASE

ALMA SCHOOL RD & BASELINE RD





Exclusively listed by

LANCE UMBLE
(602) 734-7206
lumble@pcaemail.com

NICK DEDONA
(602) 734-7208
ndedona@pcaemail.com

The information contained herein has been obtained from sources believed reliable. While we do not doubt its accuracy, we have not verified it and make no guarantee, warranty or representation about it. It is your responsibility to independently confirm its accuracy and completeness. Any projections, opinions, assumptions or estimates used are for example only, and do not represent the current or future performance of the property. The value of this transaction to you depends on tax and other factors which should be evaluated by your tax, financial and legal advisors. You and your advisors should conduct a careful, independent investigation of the property to determine to your satisfaction the suitability of the property for your needs. 06/14/2021



3131 East Camelback Road, Suite 340 | Phoenix, Arizona 85016
P. (602) 957-9800 F. (602) 957-0889
www.pcainvestmentsales.com