

Former Rite Aid

3403 E. Genesee Ave, Saginaw MI 48601

± 11,096 Square Feet

± 1.49 Acres





3403 Genesee Ave

High Visibility Location

This former Rite Aid property is available for both ground lease and lease options, offering a spacious 11,096 square feet of retail space on 1.49 acres. Pricing for the ground lease is to be determined, while the lease rate is competitive at \$8.95 per square foot on a triple net (NNN) basis. Situated in a busy commercial corridor, the property is surrounded by a mix of retail, dining, and residential neighborhoods, making it an optimal spot for attracting customers. Ideal for retail, pharmacy, or service-oriented businesses.

\$8.95

PSF NNN Lease Rate

11K

Square Feet

1999

Year Built

Property Overview

Parcel #	21 4453 00200
Lease Rate	\$8.95/SF
Ground Lease Rate	Call Broker for Ground Lease Rate
Lease Type	NNN
Size	11,096 SF
Parking	64 Surface Spaces
Zoning	B-1
Built	1999



Highlights

- + Pylon Signage
- + On the corner of signalized intersection
- + Easy access with multiple entryways
- + Drive-thru



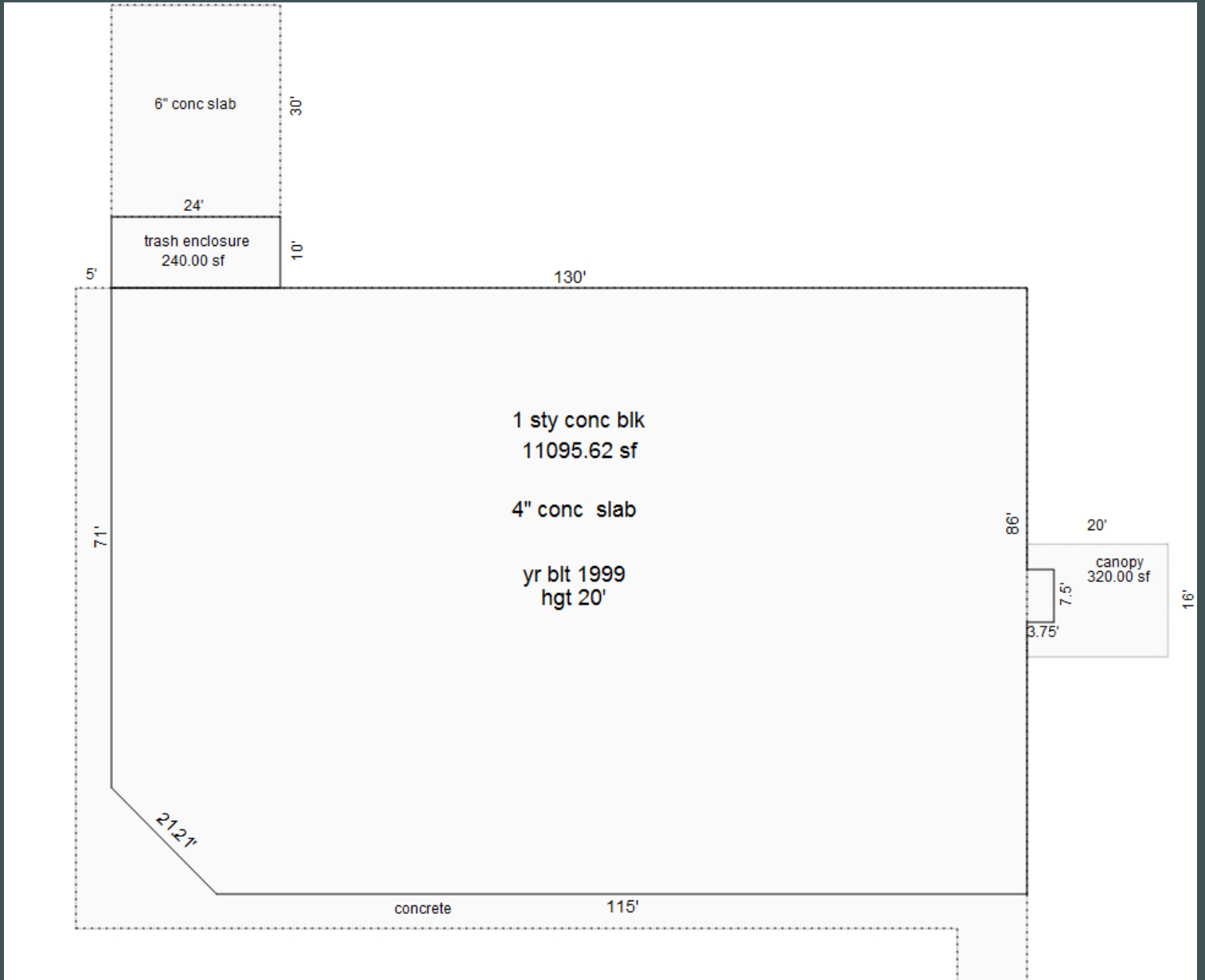

Contact Us

Russ Bono, CCIM

Vice President
+1 616 799 6629
russ.bono@cbre.com

Cameron Timmer

Vice President
+1 616 485 4131
cameron.timmer@cbre.com

Matt Croswell

First Vice President
+1 248 207 3128
matt.croswell@cbre.com

© 2025 CBRE, Inc. All rights reserved. This information has been obtained from sources believed reliable, but has not been verified for accuracy or completeness. You should conduct a careful, independent investigation of the property and verify all information. Any reliance on this information is solely at your own risk. CBRE and the CBRE logo are service marks of CBRE, Inc. All other marks displayed on this document are the property of their respective owners, and the use of such logos does not imply any affiliation with or endorsement of CBRE. Photos herein are the property of their respective owners. Use of these images without the express written consent of the owner is prohibited.