

**Evans
Elder
Brown &
Seubert**

COMMERCIAL REAL ESTATE

101 E. Broadway
Suite 101
Eugene, OR 97401
(541) 345-4860

eebcre.com

FOR LEASE

970 Pearl Street
Eugene, Oregon 97401

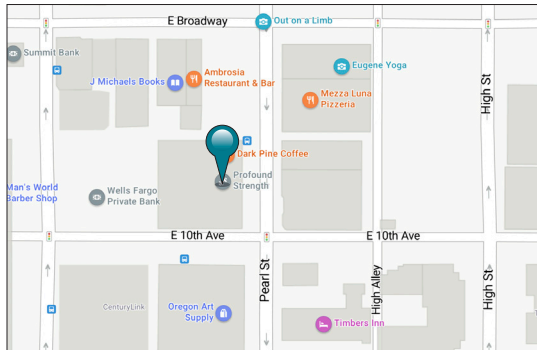

CONTACT

Stephanie Seubert
stephanie@eebcre.com

Lilly Storment
lilly@eebcre.com

(541) 345-4860

Licensed in the State of Oregon



Ground Floor Downtown Retail 970 Pearl Street

- Approximately 4,732 Square Feet (can be demised)
- Currently in shell condition
- High-traffic retail location in the center of Downtown Eugene
- Zoned C-3, Major Commercial
- \$1.50/SF/Month, NNN (Triple-Nets approximately \$0.35/SF/Month)

970 Pearl Street | Photos

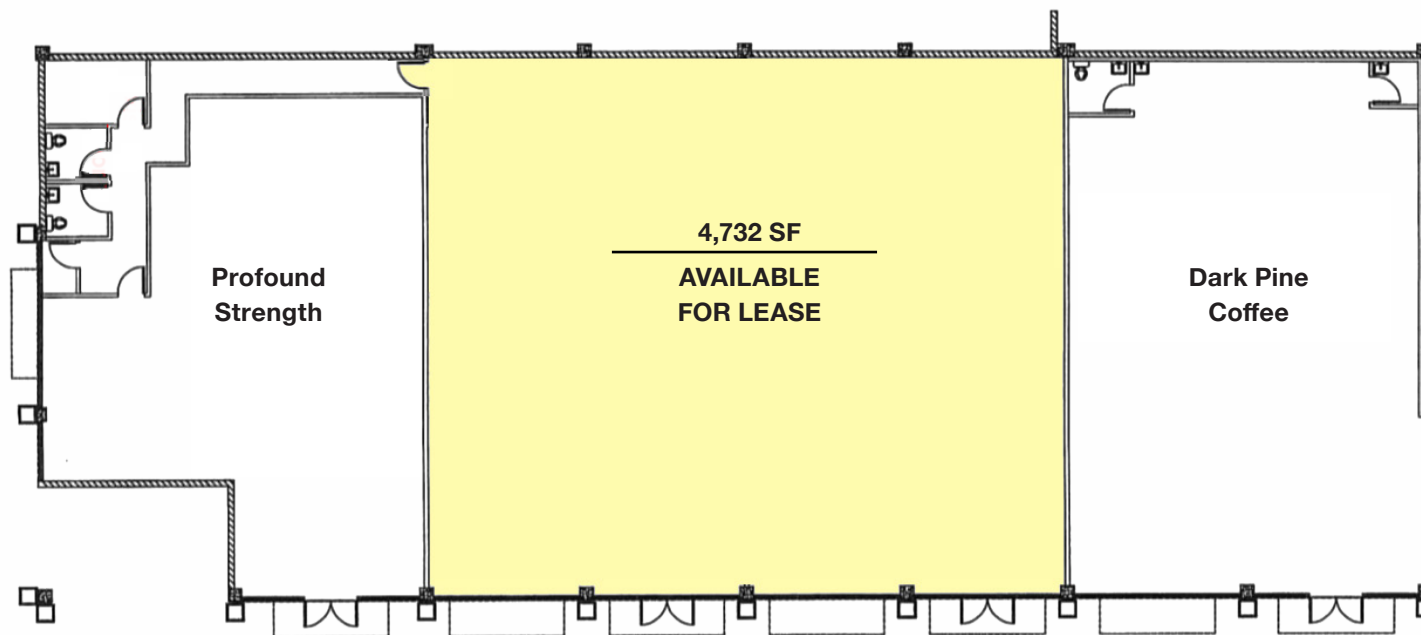

High-Traffic Retail for Lease

970 Pearl Street
Eugene OR 97401

For more property or leasing
information, please contact:

Stephanie Seubert
stephanie@eebcre.com

Lilly Storment
lilly@eebcre.com

(541) 345-4860

**Evans
Elder
Brown &
Seubert**

COMMERCIAL REAL ESTATE

