



20,800 sq.ft. for Lease

28825 Goddard Rd, Romulus, MI

Listing ID:

Status:

Property Type:

Industrial Type:

Contiguous Space:

Total Available:

Rental Rate:

Lease Types:

Loading:

Ceiling:

Drive-In Bays:

Active

Industrial For Lease

Flex Space, Food Processing

20,800 SF

20,800 SF

6.50

Modified Gross

4 Docks

20 - 22 ft.

4 Bays



Property Overview

20,800 sq.ft. available in the Airport Business Center. Ideal for logistics company or freight forwarding. Gross lease. We pay for snow removal, building taxes and insurance. Call REA Construction at 734-946-8730.

<https://youtu.be/faQecCtzTZA>
Fly Over



Listing Details

General Information

Listing Name: 20,800 sq.ft. for lease
Tax ID Number/APN: 263960770
Industrial Type: Flex Space, Food Processing, Industrial-Business Park, Manufacturing, Mixed Use, Heavy Industrial, Warehouse/Distribution

Zoning: MT2
Building Name: Airport Business Center

Available Space

Suite/Unit Number: 110-113
Suite Floor:
Space Available: 20,800
Minimum Divisible: 10,400
Maximum Contiguous: 20,800
Space Subcategory 1: Industrial-Business Park
Space Subcategory 2: Warehouse/Distribution
Space Type: Relet

Lease Rate:
Lease Type: Gross Lease
Rent Escalators: Fixed Lease
Parking Spaces: 24
Loading Docks: 4
Drive In Bays: 4
Ceiling Height: 22
Clear Height: 20

Space Description 20,800 sq.ft. available in the Airport Business Center. Ideal for logistics company or freight forwarding. Gross lease. We pay for snow removal, building taxes and insurance. Brokers protected.

Area & Location

Market Type: Large
Property Located Between: Middle-belt and Inkster Rd.
Side of Street: South
Road Type: Paved

Property Visibility: Excellent
Transportation: Highway
Highway Access: Close to I94 and I275
Airports: Detroit Metropolitan Airport

Site Description 28825 Goddard. 20,800 square feet. Great for air freight or logistics companies. Very reasonable terms, excellent services. Offered by Yves Rea. Call REA Construction for a showing. We have 2 million square feet under our management.<http://www.rea-construction.net/> 734-946-8730

Building Related

Tenancy:	Multiple Tenants	Total Parking Spaces:	15
Total Number of Buildings:	7	Amps:	200
Number of Stories:	1	X-Phase:	3
Property Condition:	Good	Heat Type:	Gas
Year Built:	1995	Heat Source:	Radiant
Roof Type:	Flat	Lighting:	Metal Halide
Construction/Siding:	Block	Interior Description:	4,000 sq.ft. of office, 4 truck-wells and 4 overhead doors.
Parking Type:	Surface		

Land Related

Zoning Description:	MT2
Land Area:	35 Acres

Location

Address:	28825 Goddard Rd, Romulus, MI 48174	MSA:	Detroit-Warren-Dearborn
County:	Wayne	Submarket:	Airport District



Property Images



aerial



aerial

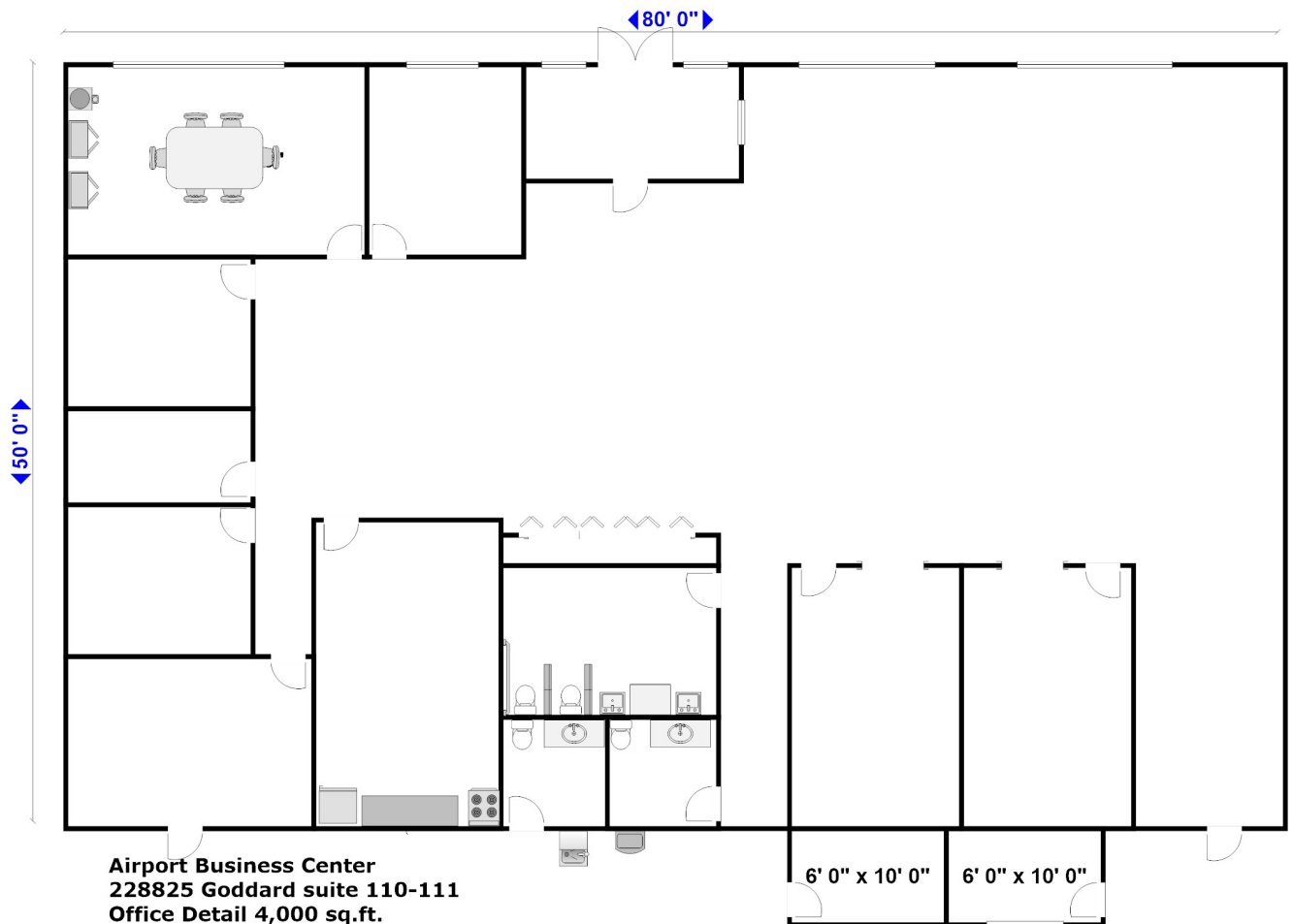

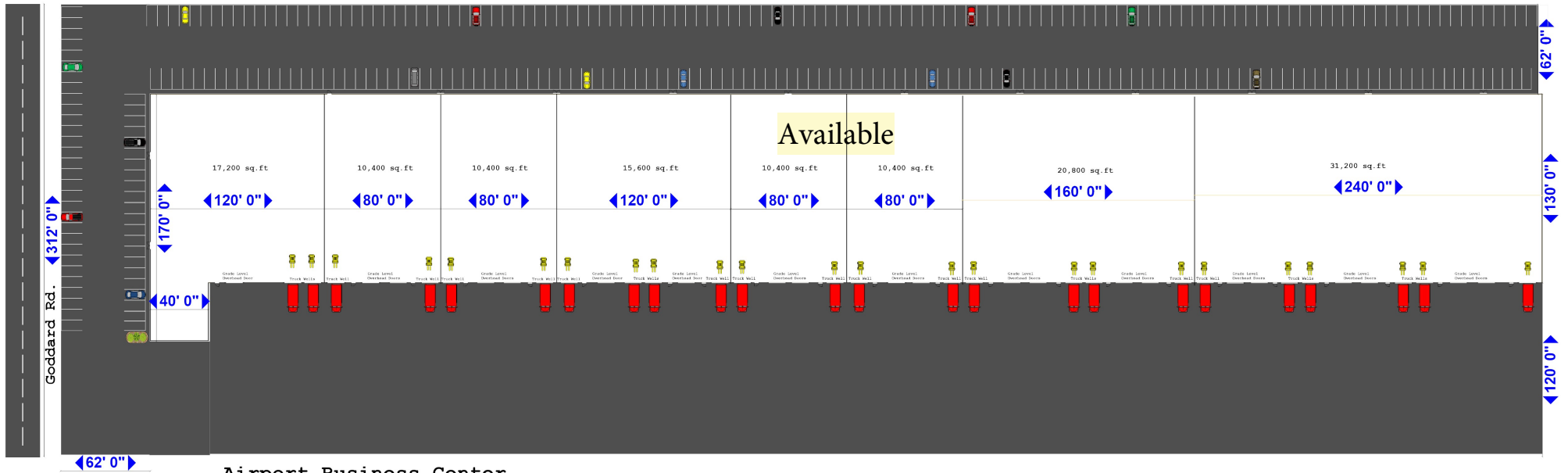

Airport Business Center
28825 Goddard rd. Romulus Mi. 48174
126,000 sq.ft.

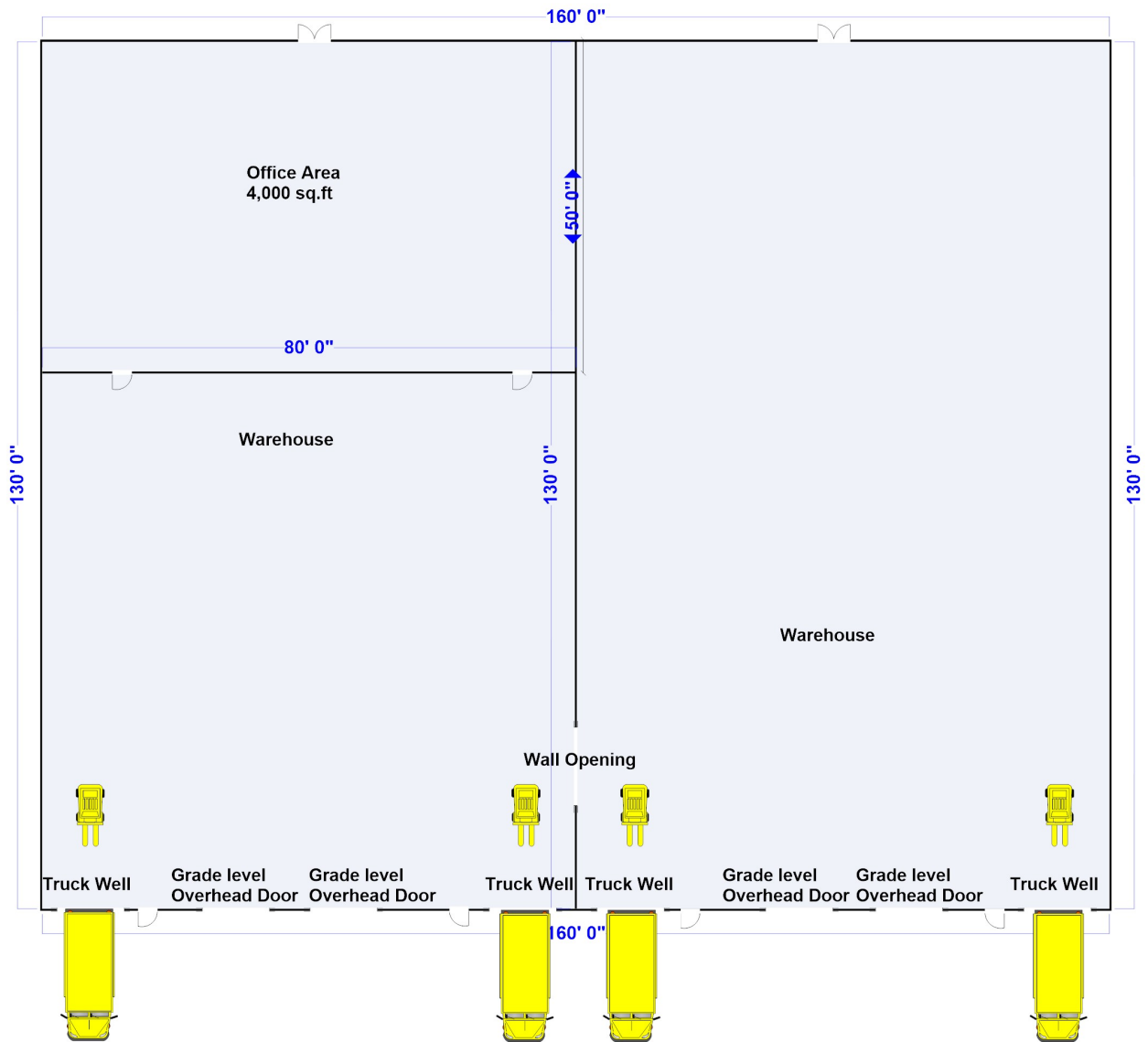

Airport Business Center
28825 Goddard Rd. Suites 110-113
20,800 sq.ft'

Property Contacts



Salvatore Giordano

Rea Construction

734-946-8730

rea@reaconstruction.net