

3 MIAMI CENTRAL

# The Modern Workplace: Redefined.

Perform  
Properties





3 Miami Central

# An elevated arrival experience.

Discover the newly renovated lobby at 3 Miami Central – an elevated arrival experience designed to meet the demands of the contemporary professional.

 [CLICK HERE FOR VIRTUAL TOUR](#)

Renovated Lobby





Amenities

# Enhanced amenities tailored for modern worklife.

Amenity offerings designed to enhance your work environment. Choose from collaborative, wellness and social spaces – an ideal extension of your workplace.



Expansive Outdoor Roof Deck



Fitness & Wellness Center



Private Work Lounge & Conference Center



Brightline Food Hall



Location

# The heart of Miami's transit hub.

3 Miami Central is directly adjacent to the Brightline Station which serves as a hub for mass transit. Tenants can enjoy access via Brightline from across the region allowing companies to attract and retain South Florida's top talent.

Brightline serves the following cities:

Miami  
Aventura  
Fort Lauderdale  
Boca Raton  
West Palm Beach  
Orlando  
Tampa (Future Station)



Brightline



Tri-Rail



Metrorail



Metrobus



Availability

# Forward thinking design.

## Spec Suite

Suite 1030 - 8,073 RSF

Est. Delivery 1<sup>ST</sup> Q 2026



Arrival and Reception Area



Board Room



Pantry and Collaboration Area



Open Workspace



Availability

# A plan for success.

## Spec Suite

Suite 1030 - 8,073 RSF

Est. Delivery 1<sup>ST</sup> Q 2026

One 12-Person Large Conference Room

12 Offices

Huddle Room

Lounge Area

Break Area/Kitchen

Welcome Area

Open Work Area (30 Seats)

Storage & IT Rooms

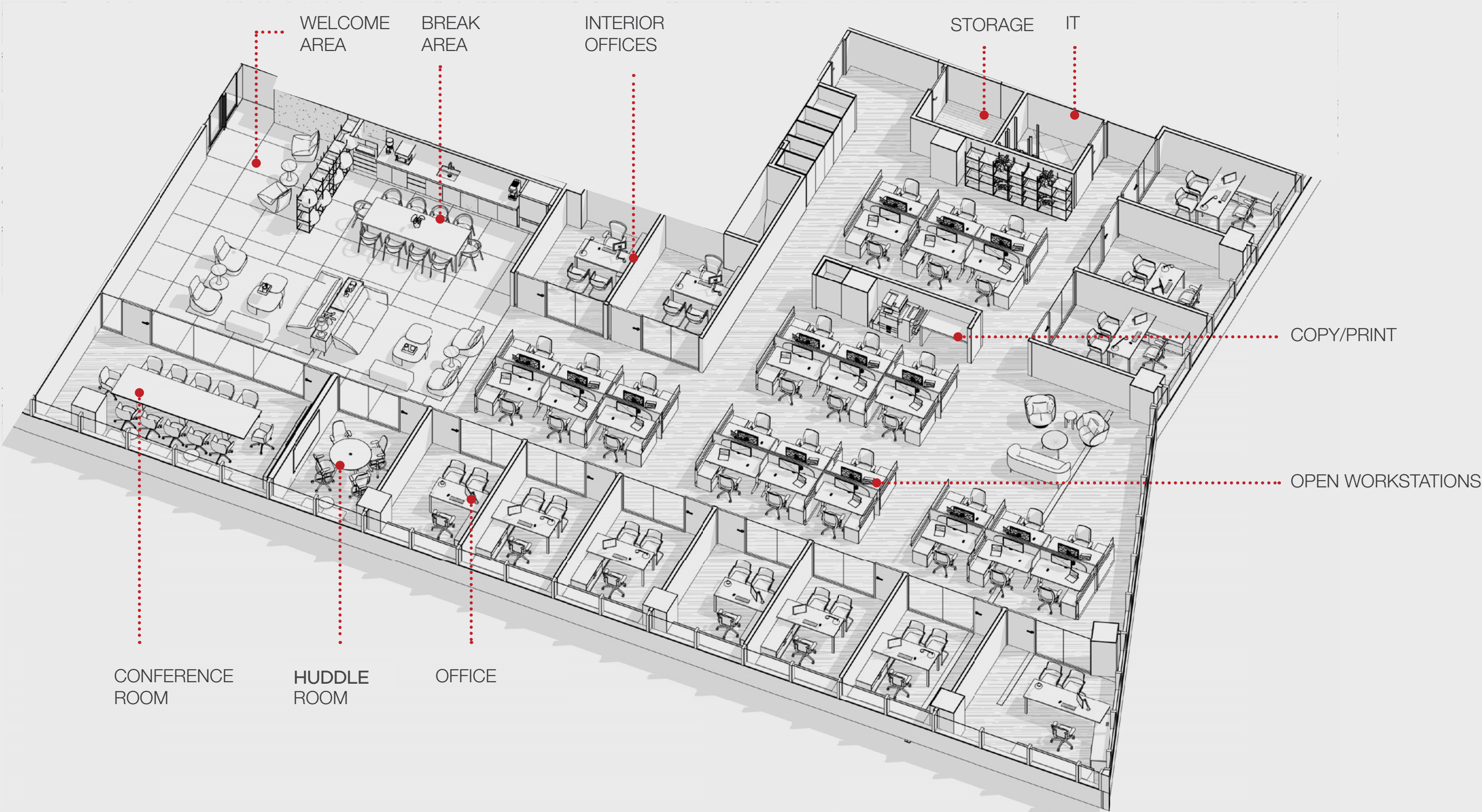





# Existing layout.

Suite 1000 - 9,270 RSF  
Suite 1030 - 8,073 RSF (Future Spec Suite)





Availability

# Existing layout.

9th Floor — 27,120 SF  
Available 1/1/2026

- 36 Offices
- 30 Open Workstations
- Reception Area
- 8 Conference Rooms
- 2 Training Rooms
- Phone Rooms
- Huddle Rooms
- Wellness Room
- Break Area/Kitchen
- Lounge Area
- Storage & IT Rooms

 [CLICK HERE FOR VIRTUAL TOUR](#)

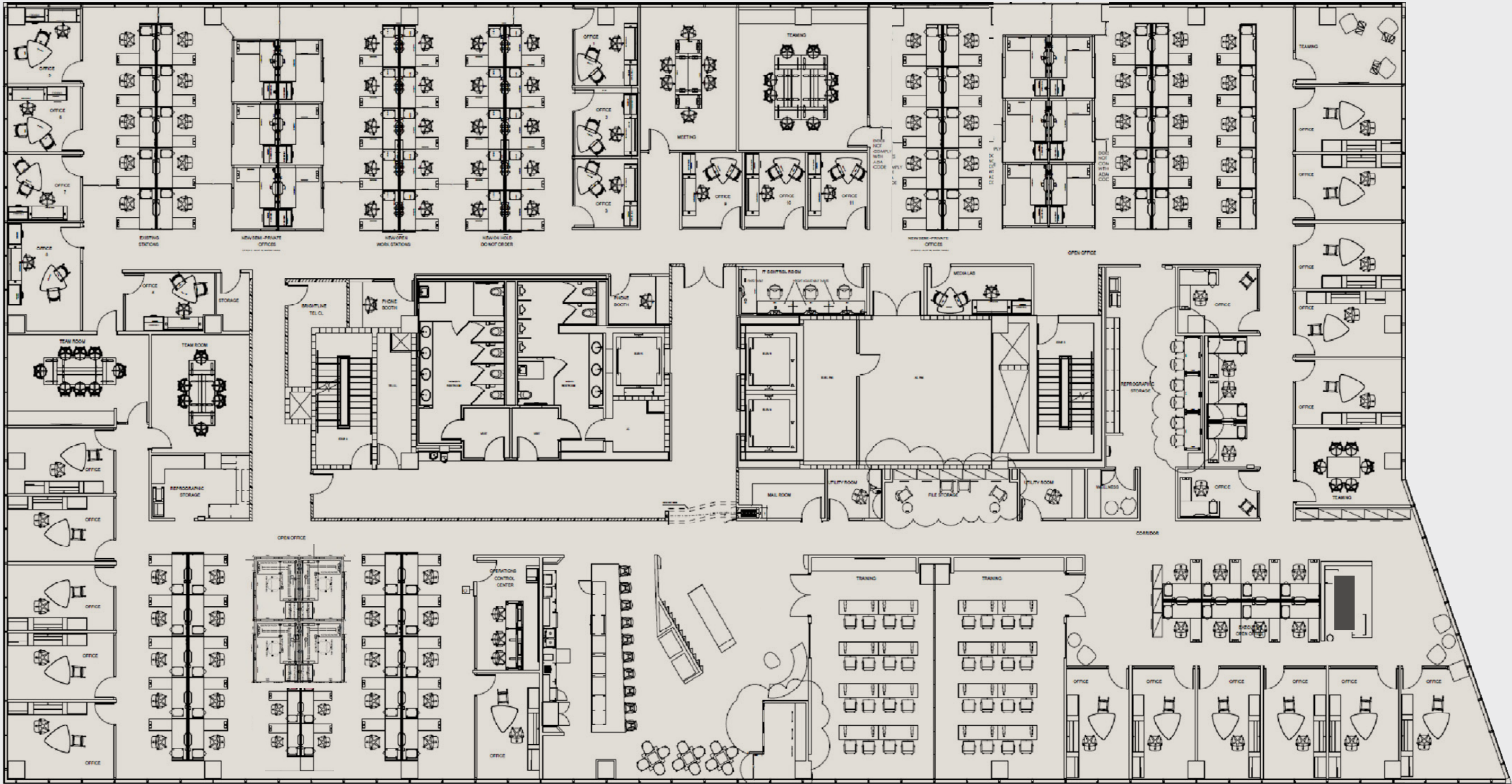



Location

# Commuter & amenities map.

 BRIGHTLINE ROUTES & TRAVEL TIMES FROM MIAMI CENTRAL

**ORLANDO**  
3 hrs 25 min.

**WEST PALM BEACH**  
1 hr 11 min.

**BOCA RATON RATON**  
51 min.

**FORT LAUDERDALE**  
33 min.

**AVENTURA**  
17 min.

**MIAMI CENTRAL**

TRANSIT

 BRIGHTLINE

 METROMOVER

 METRORAIL

 TRI-RAIL





Location

# Where everything you need is just steps away.

At 3 Miami Central, top-notch dining to high-end retail is just steps away, enhancing your worklife. Welcome to a workplace where everything is within reach.

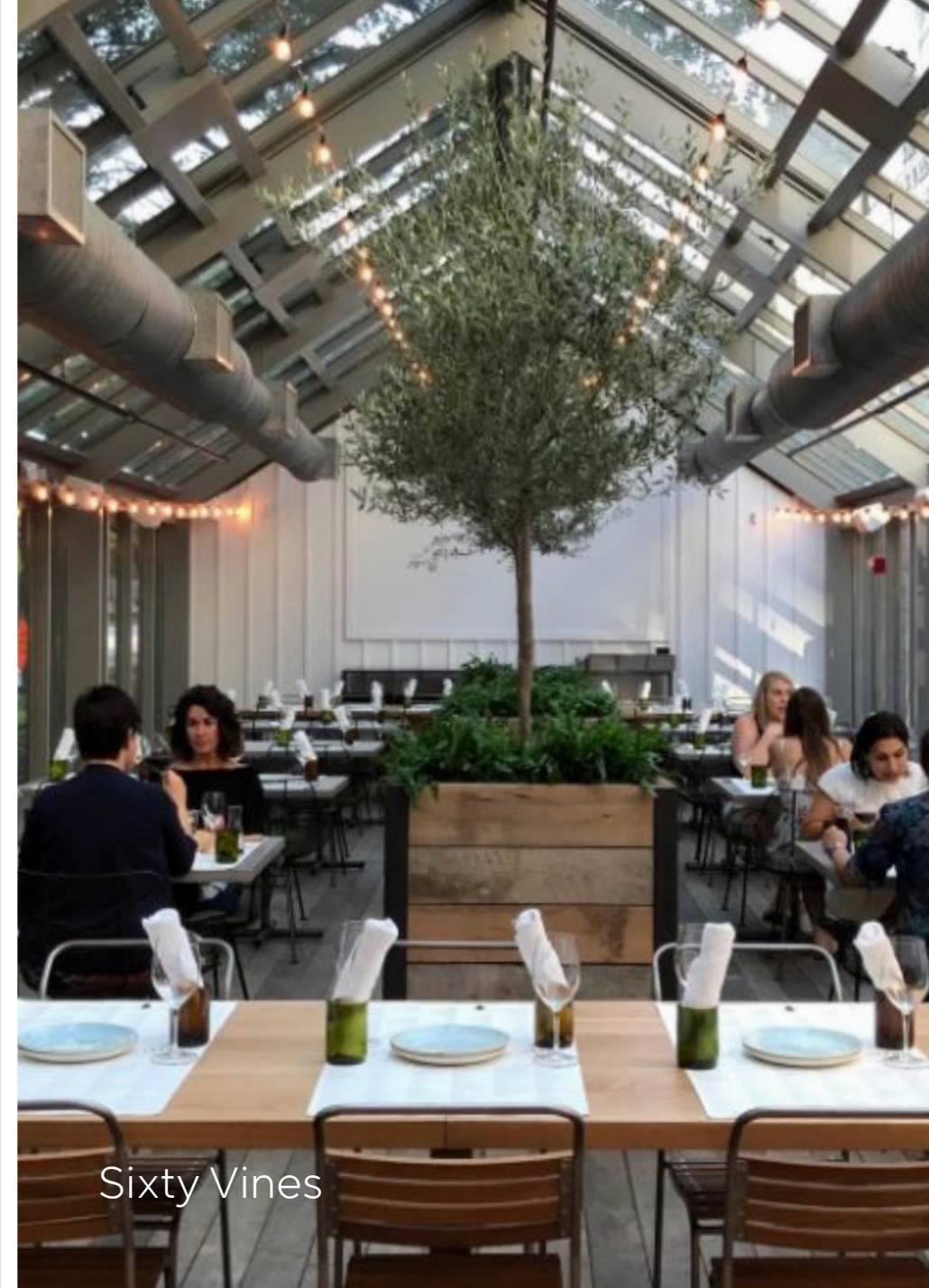

Sixty Vines



Apple Store



TAM TAM



Earls Kitchen & Bar



Maple & Ash



Red Rooster



# 3 Miami Central Building Facts

**BUILDING SIZE**  
108,000 RSF

**STORIES**  
12

**AVAILABLE**  
8,073 SF - 44,413 SF

**CEILING HEIGHT**  
13' slab-to-slab

**ELEVATORS**  
5 Passenger  
1 Dual Freight

- FEATURES**
- Direct access to Brightline Station
  - Private work lounge & conference center
  - Expansive outdoor roof deck
  - Fitness & wellness center

- RETAIL AT MIAMI CENTRAL**
- Publix
  - Rosetta Bakery
  - Chic fil A
  - Joe & the Juice
  - Brooklyn Dumpling Shop
  - Starbucks
  - Wells Fargo
  - AT&T
  - Face. Brow & Beauty Bar
  - The Green Chicken Miami
  - Powerhouse Gym
  - Verizon
  - Central Fare Food Collective

**TENANT ACCESS**  
24//7 access control system

**PARKING**  
2/1,000 SF (Direct access to suite)

**WINDOWS**  
Large Missile Impact (LMI)

**SUSTAINABILITY**  
LEED SILVER

**SECURITY**  
24/7 Attended Lobby





161 NW 6th Street  
Miami, FL 33128

## For Office Leasing, Please Contact:

Tere Blanca

305.577.8851

[tere.blanca@blancacre.com](mailto:tere.blanca@blancacre.com)

Danet Linares

305.577.8852

[danet.linares@blancacre.com](mailto:danet.linares@blancacre.com)

Andres del Corral

305.577.0251

[andres.delcorral@blancacre.com](mailto:andres.delcorral@blancacre.com)

## Perform Properties Leasing Contact:

Scott Silverstein

212.520.8016

[ssilverstein@performproperties.com](mailto:ssilverstein@performproperties.com)

DISCLAIMER: No warranty of representation, expressed or implied, is made as to the accuracy of the information contained herein, and same is submitted subject to errors, omissions, change of price rental or other conditions, withdrawal without notice, and to any special conditions imposed by our clients.



Perform  
Properties