

# 3,700 SF

## Industrial Property For Lease



**BROWN**  
COMMERCIAL GROUP, INC.

**700 NORTH LARCH AVENUE, ELMHURST, IL 60126**



### LOCATION DESCRIPTION

Established industrial park location with easy access to major transportation routes via nearby US Rt. 20, I-290, Rt. 83.

SPACES	LEASE RATE	SPACE SIZE
700	\$13.50 SF/yr	3,700 SF

### PROPERTY OVERVIEW

- 3,700 SF In-line Unit Available
- 400 ± SF Offices
- 12'6" Clear Ceilings
- 1 Drive-in Door (10' x 12')
- 400 Amp, 220 Volt Power
- Common Parking
- Lease Rate: \$13.50/SF Modified Gross

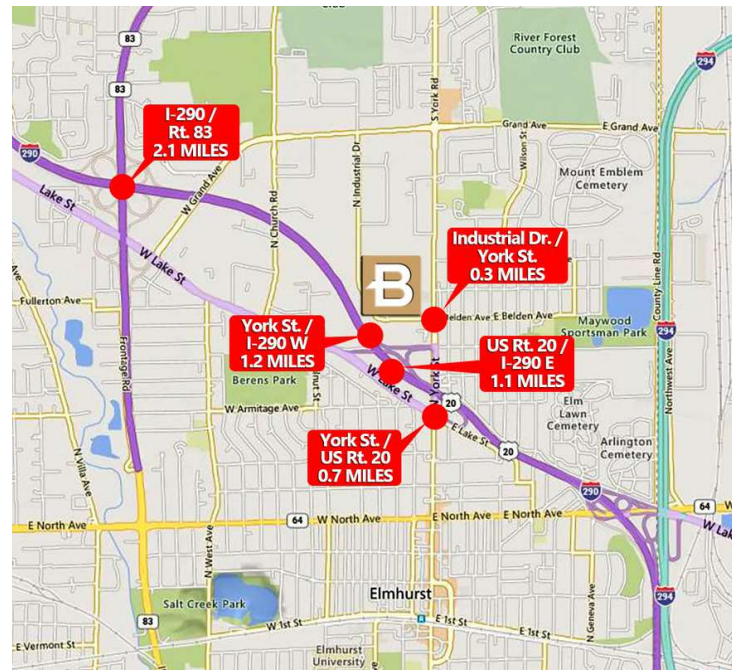

**PAT CROWLEY**

847.758.9200 x310

PCROWLEY@BROWNCOMMERCIAL.COM

**TRINITY SCURTO, SIOR**

847.758.9200 x304

TSCURTO@BROWNCOMMERCIAL.COM

BROWNCOMMERCIAL.COM

// 1400 E. HIGGINS RD. SUITE A, ELK GROVE VILLAGE, IL 60007

// 847.758.9200

No warranties or representations is made as to the accuracy of the foregoing information. Terms and availability are subject to changes or withdrawal without notice



# 3,700 SF

## Industrial Property For Lease



**BROWN**  
COMMERCIAL GROUP, INC.

**700 NORTH LARCH AVENUE, ELMHURST, IL 60126**

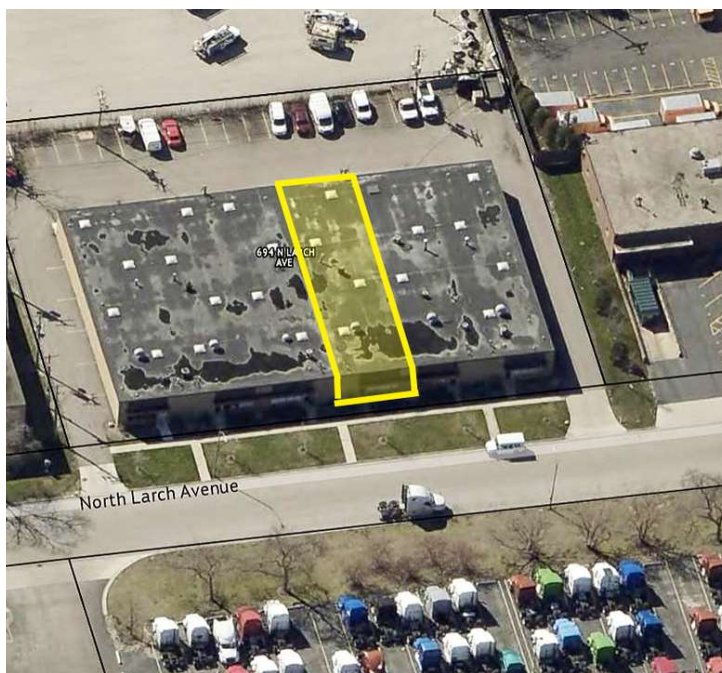
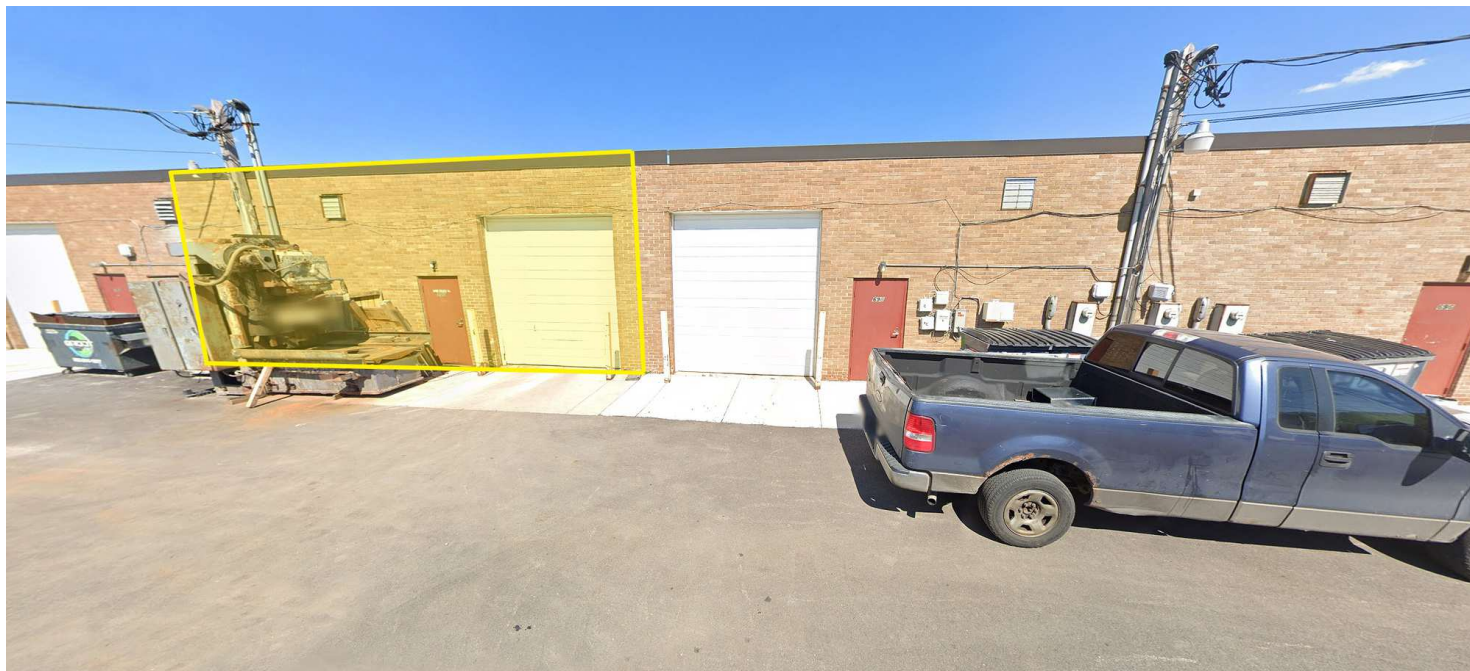

**PAT CROWLEY**

847.758.9200 x310

PCROWLEY@BROWNCOMMERCIAL.COM

**TRINITY SCURTO, SIOR**

847.758.9200 x304

TSCURTO@BROWNCOMMERCIAL.COM

BROWNCOMMERCIAL.COM

//

1400 E. HIGGINS RD. SUITE A, ELK GROVE VILLAGE, IL 60007

//

847.758.9200

No warranties or representations is made as to the accuracy of the foregoing information. Terms and availability are subject to changes or withdrawal without notice

# 3,700 SF

## Industrial Property For Lease



**BROWN**  
COMMERCIAL GROUP, INC.

700 NORTH LARCH AVENUE, ELMHURST, IL 60126



**PAT CROWLEY**

847.758.9200 x310

PCROWLEY@BROWNCOMMERCIAL.COM

**TRINITY SCURTO, SIOR**

847.758.9200 x304

TSCURTO@BROWNCOMMERCIAL.COM

BROWNCOMMERCIAL.COM

//

1400 E. HIGGINS RD. SUITE A, ELK GROVE VILLAGE, IL 60007

//

847.758.9200

No warranties or representations is made as to the accuracy of the foregoing information. Terms and availability are subject to changes or withdrawal without notice