

FOR SUBLEASE

CBRE

7220 Fisher Street SE



Property Information

Space Available: Suite 400: 12,177 SF
Suite 410: 2,515 SF
Total: 14,692 SF

Available: June 1, 2026 (TBV)

Expiry: March 31, 2029

Basic Rent: \$9.00 PSF

Operating Costs: TBV

Parking: 79 Surface Stalls, \$60/stall

28 reserved stalls designated to the
Tenant and fixed for the term

Suite 400: 12,177 SF

Suite 410: 2,515 SF

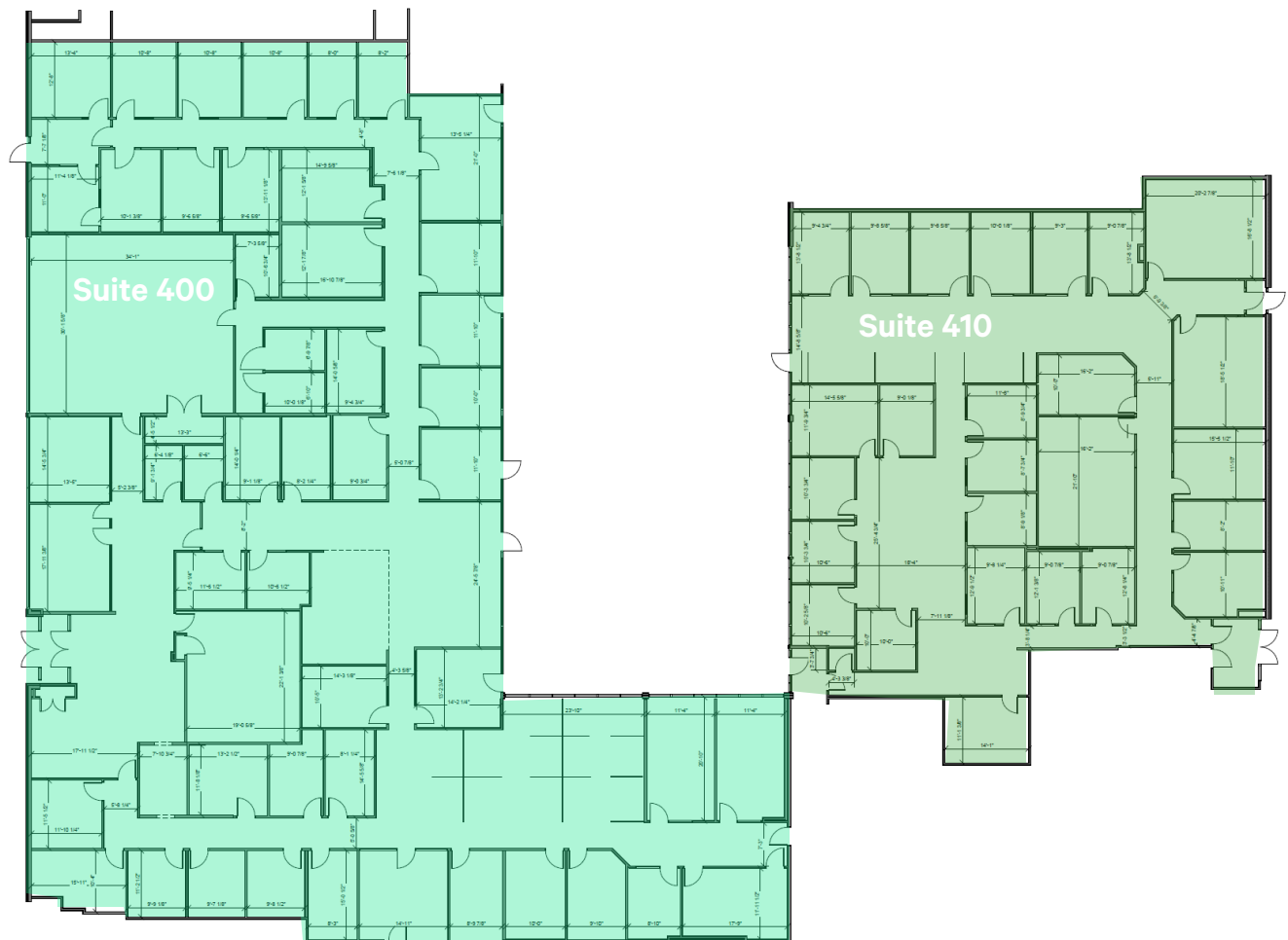

Can be leased together or separately.

Interior



Nearby Amenities

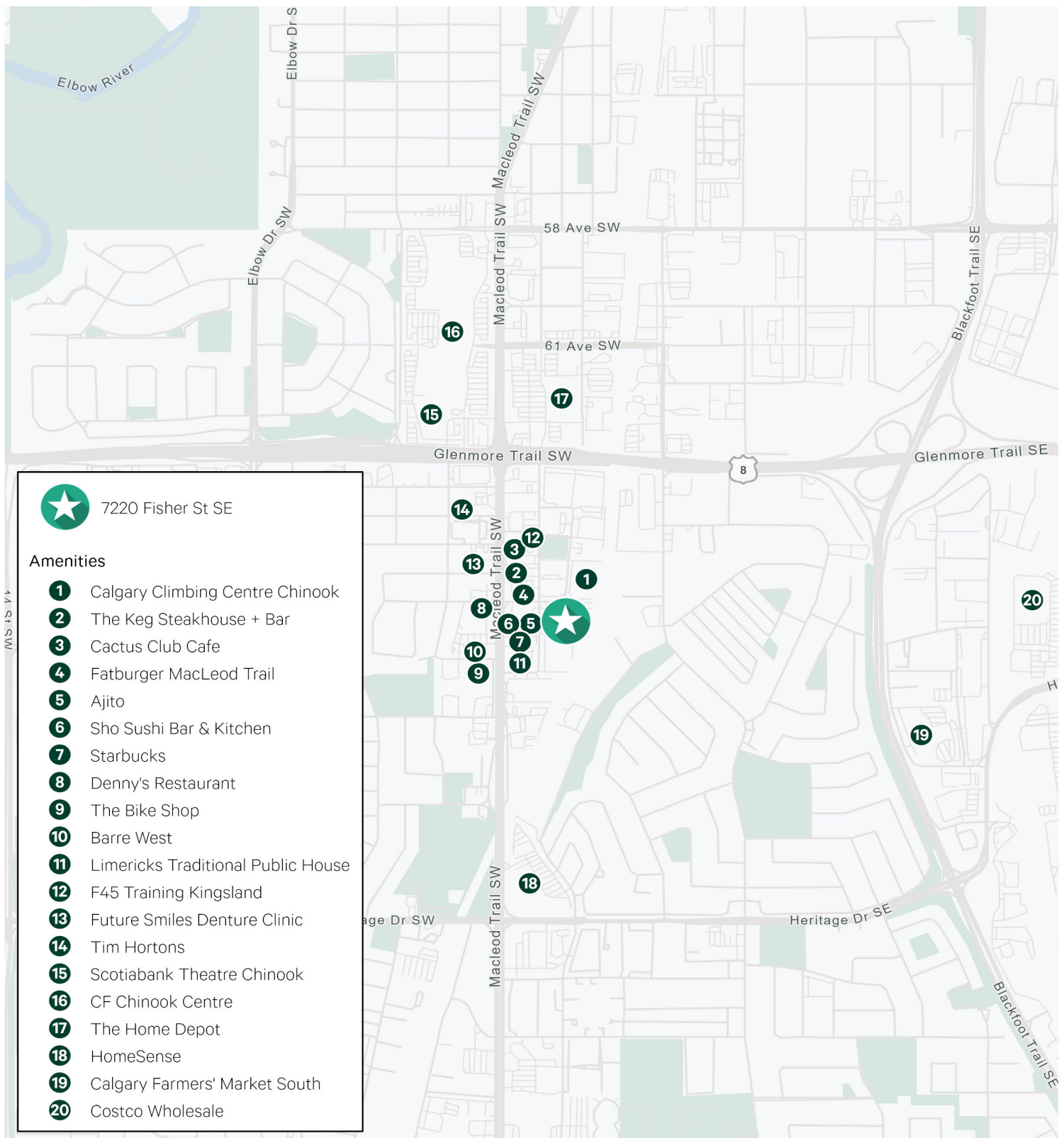



7220 Fisher Street SE

For more information, please contact

John Fisher

Executive Vice President
T 403 750 0505
John.Fisher@cbre.com

Jessica Basic

Transaction Manager
T 403 750 0804
Jessica.Basic@cbre.com

CBRE

This disclaimer shall apply to CBRE Limited, Real Estate Brokerage, and to all other divisions of the Corporation; to include all employees and independent contractors ("CBRE"). All references to CBRE Limited herein shall be deemed to include CBRE, Inc. The information set out herein, including, without limitation, any projections, images, opinions, assumptions and estimates obtained from third parties (the "Information") has not been verified by CBRE, and CBRE does not represent, warrant or guarantee the accuracy, correctness and completeness of the Information. CBRE does not accept or assume any responsibility or liability, direct or consequential, for the Information or the recipient's reliance upon the Information. The recipient of the Information should take such steps as the recipient may deem necessary to verify the Information prior to placing any reliance upon the Information. The Information may change and any property described in the Information may be withdrawn from the market at any time without notice or obligation to the recipient from CBRE. CBRE and the CBRE logo are the service marks of CBRE Limited and/or its affiliated or related companies in other countries. All other marks displayed on this document are the property of their respective owners. All Rights Reserved.