

# Prologis Gratiigny Industrial Park

## Industrial Trailer Parking / Yard

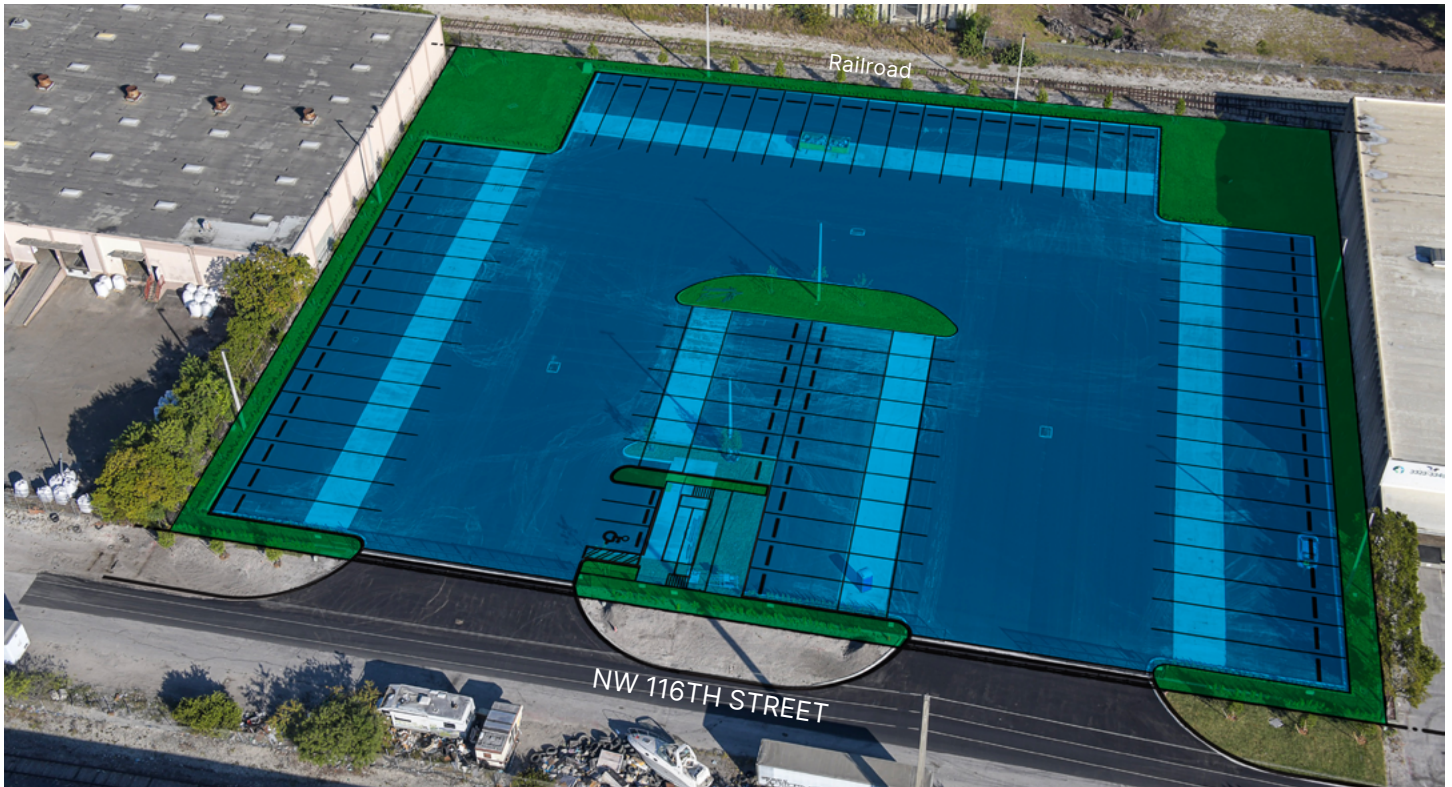

Available Now

## 2.58-acre Industrial Trailer Yard For Lease

3523 NW 116th Street, Miami, FL 33167

2.58-acre industrial yard  
or overflow trailer parking

Fully  
upgraded

Drainage, paved  
and lighting

Permitted and zoned for  
yard and/or trailer parking

Adjacent to a 110,000 SF  
warehouse available for lease

Institutionally owned  
and managed



## LEGEND

■ Available ■ Leased ■ Land

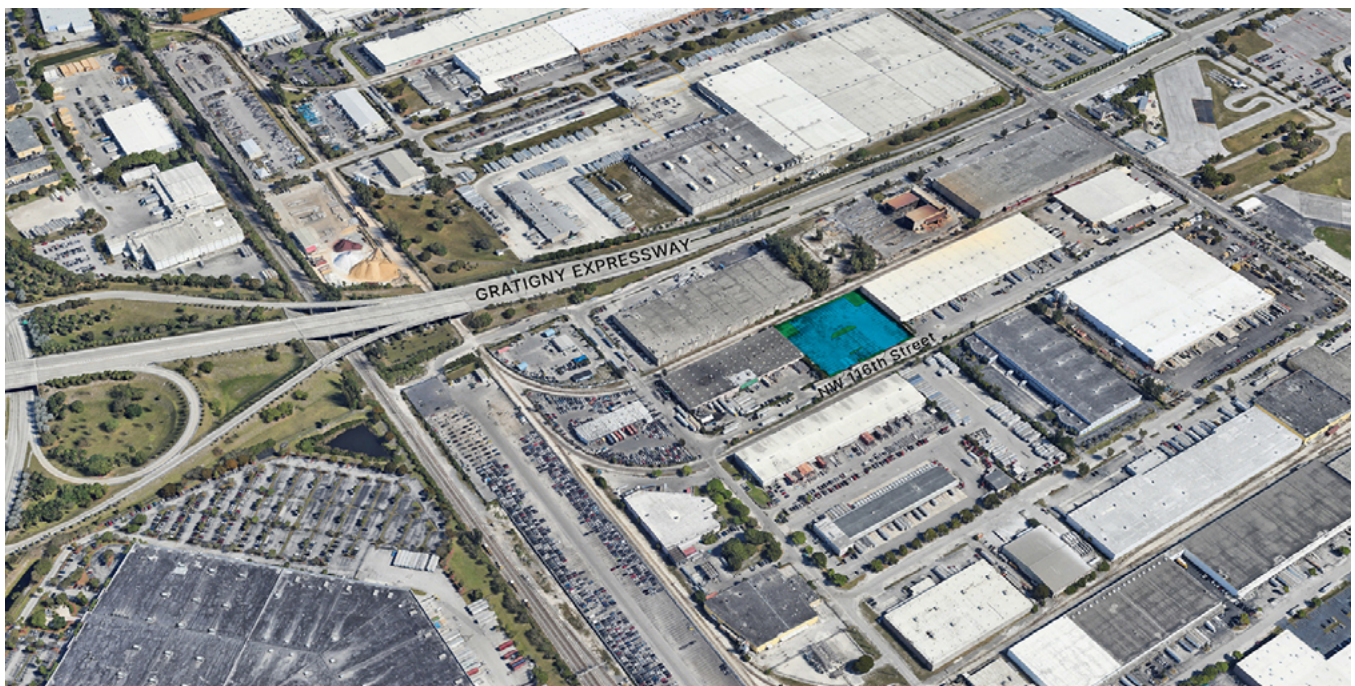
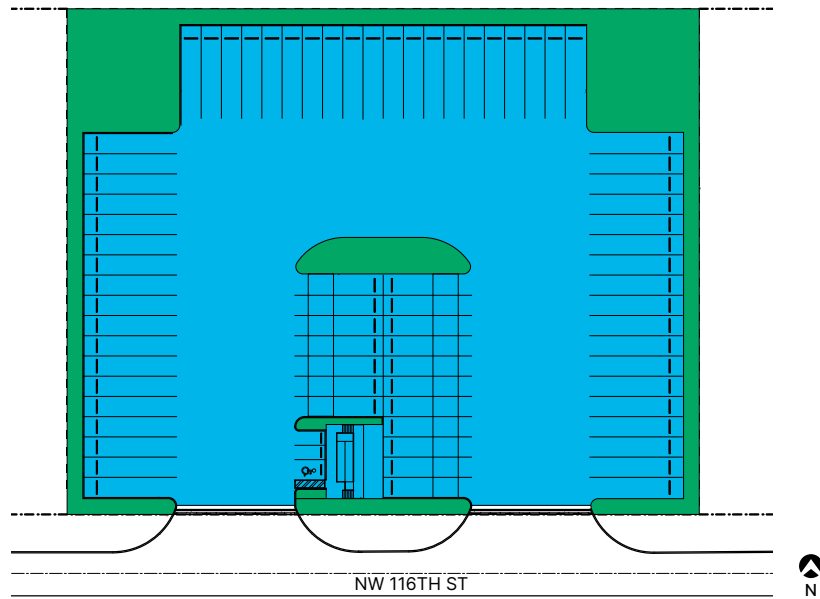

Brian Smith

[smith.brian@jll.com](mailto:smith.brian@jll.com)

+1 305 960 8403

Audley Bosch

[audley.bosch@jll.com](mailto:audley.bosch@jll.com)

+1 305 960 8404

Matt Maciag

[matt.maciag@jll.com](mailto:matt.maciag@jll.com)

+1 305 978 1530



Dylan Esquenazi

[desquenazi@prologis.com](mailto:desquenazi@prologis.com)

+1 305 599 6205

[prologis.com](http://prologis.com)