

FOR LEASE

Owned and Operated by 

2115 South 11th Avenue

Phoenix, AZ 85007

±34,865 SF

GREAT FREEWAY ACCESS AND VISIBILITY



**LEASING INFO
& CONTACT**

Jeff Conrad, SIOR
Allen Lowe, SIOR
Ryan Hingst

(602) 954-3743 / jconrad@leearizona.com
(602) 954-3747 / alowe@leearizona.com
(602) 954-3772 / rhingst@leearizona.com

 **LEE &
ASSOCIATES**
COMMERCIAL REAL ESTATE SERVICES

This is not an offer or acceptance of an offer to lease space. A lease will only be offered or made in a written agreement signed by landlord. No representation or warranty of any kind is made by landlord unless set forth in a written definitive lease executed by the landlord.

PROPERTY SUMMARY

Suite 100/110: ±34,865 SF

Adjacent to Full Diamond Interchange at Interstate 17 and 7th Avenue

Three Miles to Phoenix Sky Harbor International Airport

Grade Level Loading and Truckwells

A-2 Heavy Industrial Zoning, City of Phoenix

4 Building Project Totaling 336,665 SF

ESFR Sprinklers

Available: 4/1/2025

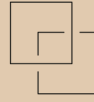

±34,865 SF

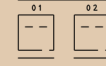

4 Docks
4 Grade Level



EVAP Cooled
Warehouse



24' Clear
Height



End Cap
Space



I-17 Access

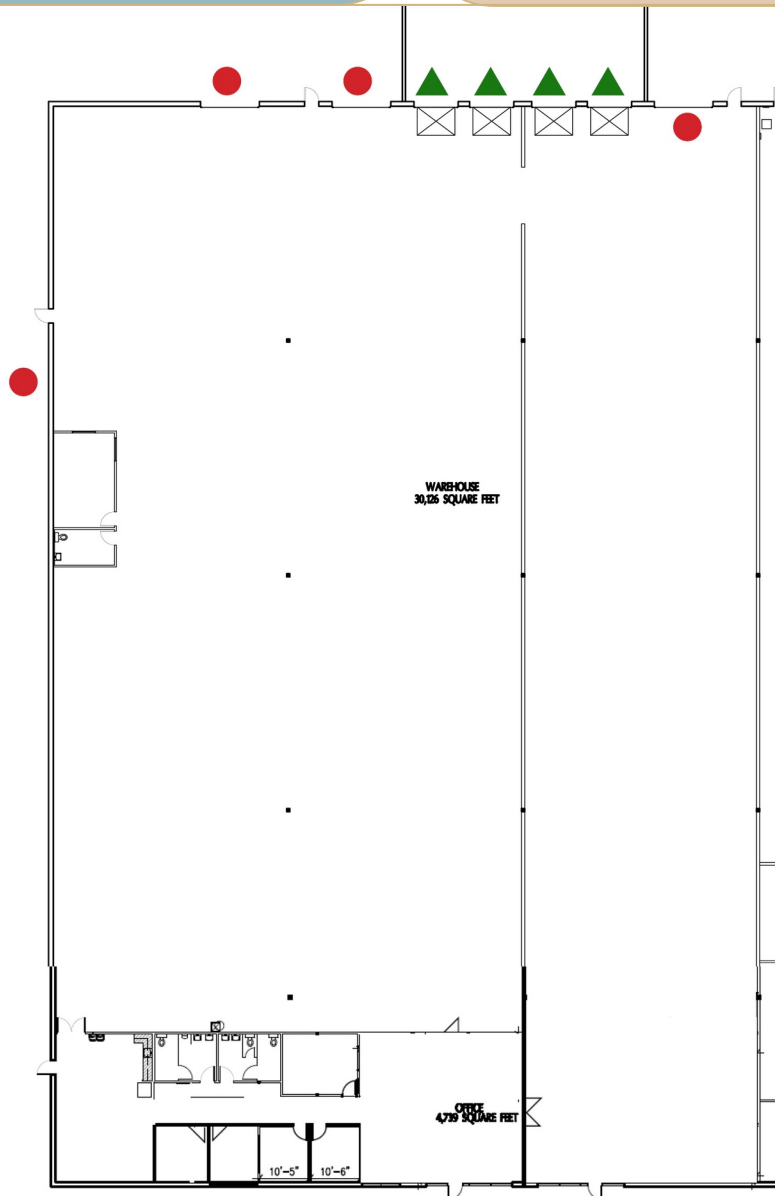

 Grade Level Door

 Truckwell Door

