

# Eastern Acres Business Park

4516 - 81<sup>st</sup> Avenue  
Edmonton, Alberta  
[www.cbre.ca](http://www.cbre.ca)

3,768 SF | Grade Loading



# Unit 4516

## Building 3

- + Excellent exposure to Sherwood Park Freeway
- + 363 sq. ft. wooden mezzanine not included in GLA
- + Small office build-out
- + Centered grade door
- + New paint and flooring

Municipal Address	4516 - 81 <sup>st</sup> Avenue	
Zoning	BE - Business Employment	
Available Area	Shop	3,424 sq. ft.
	Office	344 sq. ft.
	Total	3,768 sq. ft.
Mezzanine	363 sq. ft. <i>*Not included in GLA</i>	
Grade Loading	(1) 12' x 14'	
Construction	Concrete block	
Clear Height	22' clear	
Lighting	Fluorescent	
Heating	Forced air A/C in office	
Downdraft Fans	Yes	
Power	150 amp	
Sumps	Can be added	
Fibre	Yes	
Op Costs (2025)	\$5.88 per sq. ft. / annum	
Lease Rate	\$11.25 per sq. ft. / annum	
Available	October 1, 2025	



# Floorplan

Unit 4516

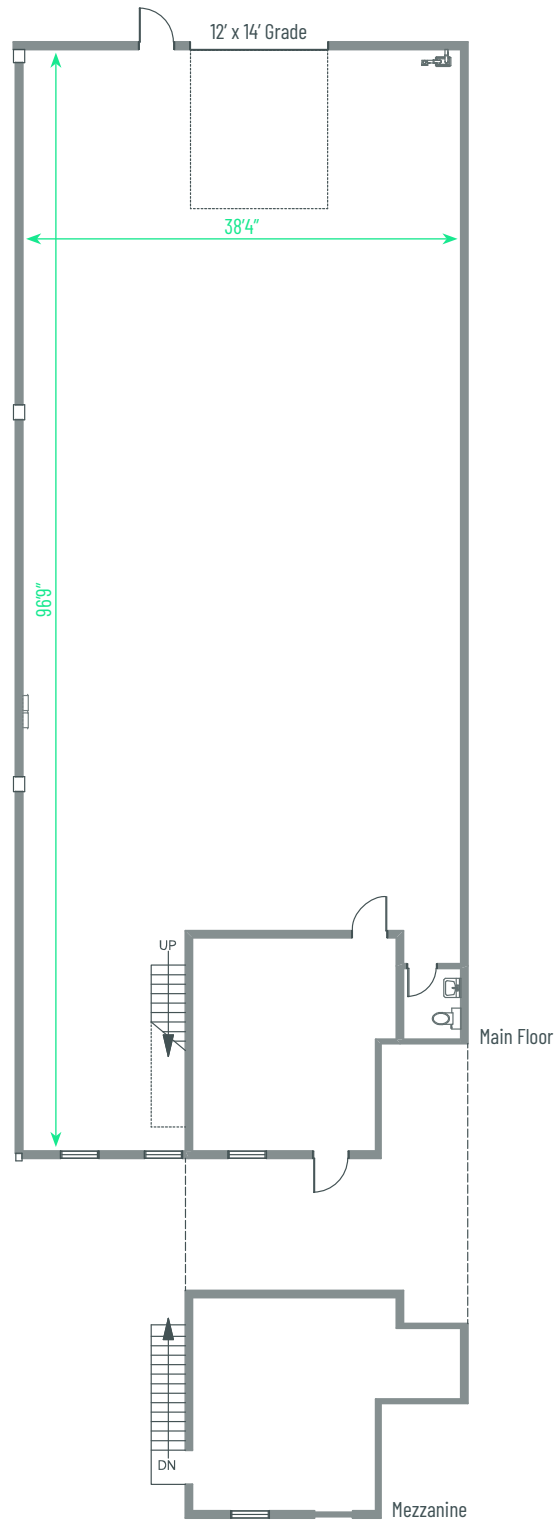





## Contact Us

**Kevin Hughes**

Senior Vice President  
+1 780 917 4634  
kevin.hughes@cbre.com

**Gregg Maimann**

Senior Vice President  
+1 780 917 4632  
gregg.maimann@cbre.com

**Trevor Schmidt**

Vice President  
+1 780 917 4641  
trevor.schmidt@cbre.com

**Jordan Adams**

Vice President  
+1 780 917 4645  
jordan.adams@cbre.com

**Braylon Klemchuk**

Vice President  
+1 780 229 4687  
braylon.klemchuk@cbre.com

**Jay Olmstead**

Sales Representative  
+1 780 554 1191  
jay.olmstead@cbre.com

**\*Lead Broker**

**John Allan McKay**

Associate  
+1 780 915 5020  
johnallan.mckay@cbre.com

**Lucas Neumeyer**

Associate  
+1 780 850 2267  
lucas.neumeyer@cbre.com

\*(Sub) Tenant / Purchaser is responsible to confirm the electrical service to the premises / building and ensure it is sufficient for their intended use.

This disclaimer shall apply to CBRE Limited, Real Estate Brokerage, and to all other divisions of the Corporation; to include all employees and independent contractors ("CBRE"). The information set out herein, including, without limitation, any projections, images, opinions, assumptions and estimates obtained from third parties (the "Information") has not been verified by CBRE, and CBRE does not represent, warrant or guarantee the accuracy, correctness and completeness of the Information. CBRE does not accept or assume any responsibility or liability, direct or consequential, for the Information or the recipient's reliance upon the Information. The recipient of the Information should take such steps as the recipient may deem necessary to verify the Information prior to placing any reliance upon the Information. The Information may change and any property described in the Information may be withdrawn from the market at any time without notice or obligation to the recipient from CBRE. CBRE and the CBRE logo are the service marks of CBRE Limited and/or its affiliated or related companies in other countries. All other marks displayed on this document are the property of their respective owners. All Rights Reserved.