

# Event Space at Lighthouse ArtSpace

For Lease | 850 E 72nd Street, Cleveland, Ohio 44103







## Features

- **Turnkey Event Venue:** Ready for immediate activation for art exhibits, pop-ups, performances, and large-format immersive events.
- **Extensively Renovated in 2021:** Upgraded roof, mechanicals, and modern finishes installed throughout key portions of the building.
- **Institutional-Quality Ownership:** Stable landlord with capacity to deliver additional improvements for the right user.
- **Prime Regional Access:** Quick connectivity to I-90 and minutes from Downtown Cleveland's restaurants, hotels, and entertainment amenities.
- **Ample On-Site Parking:** Redesigned lot offering 336 dedicated spaces for guests, staff, or high-volume events.
- **Proven Event Destination:** Previously hosted major attractions including **The Van Gogh Experience** and **The Magic of the Mouse**, drawing strong regional attendance.



## Availability

36,617 SF Event Space

## Neighborhood

Population	Businesses	Median Age	Average Income
216,298	11,610	36	\$73,615



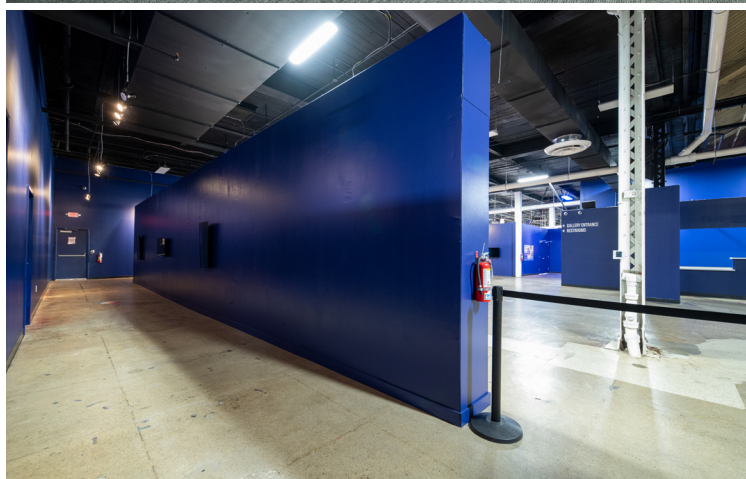



# First Floor

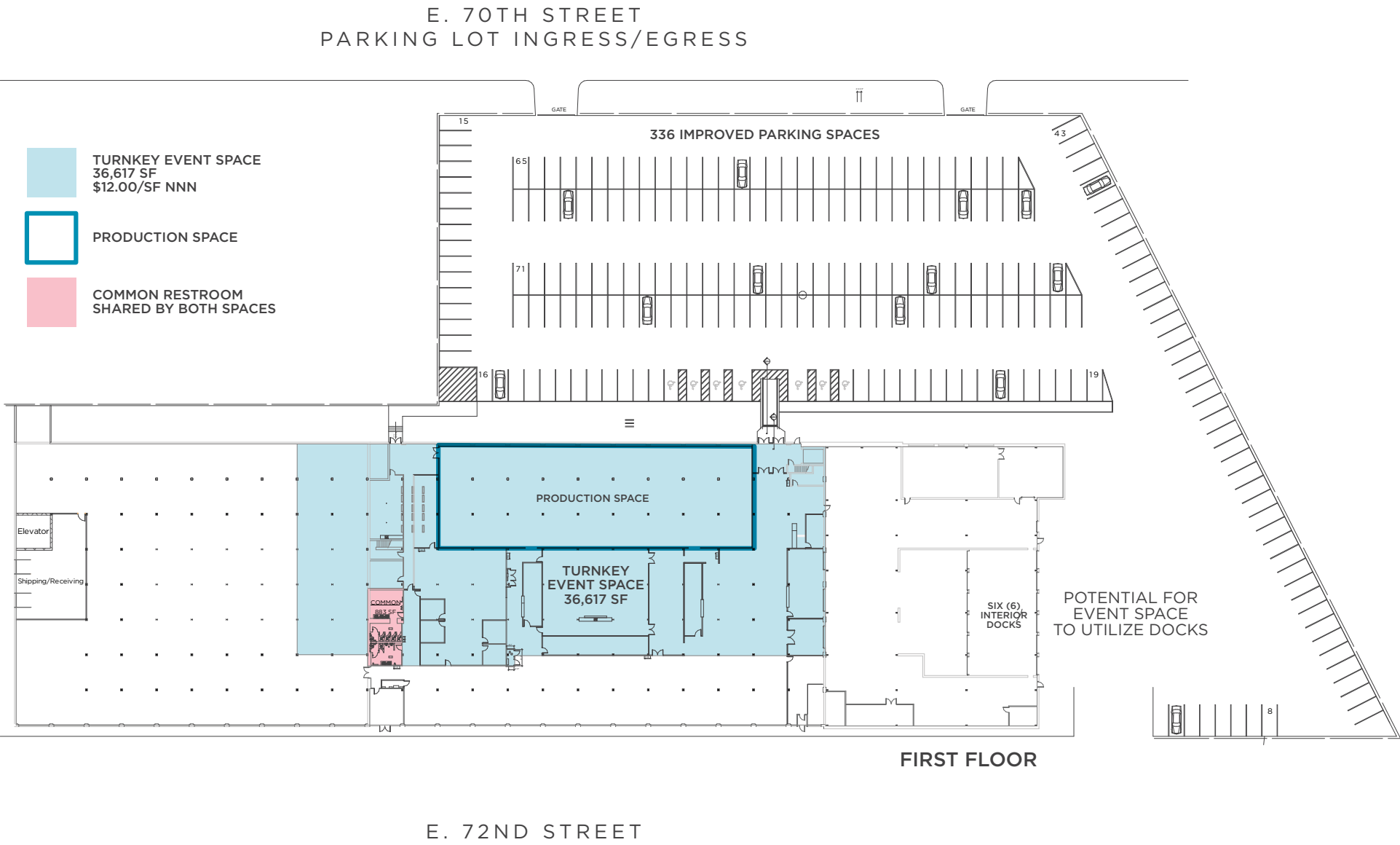



# Quick Stats

Building size: 171,680 SF

Land size: 4.99 SF

Refurbished: 2021

Construction: Masonry

Lighting: New 2021 LED

Sprinkler: Fully sprinklered

Heat: Gas fired 2021

Ceiling Height: 18'-30'

Column spacing: 20'x20'

Drive-in doors: One (1)

Dockss: Six (6) - Interior

Power: Heavy

Parking 336

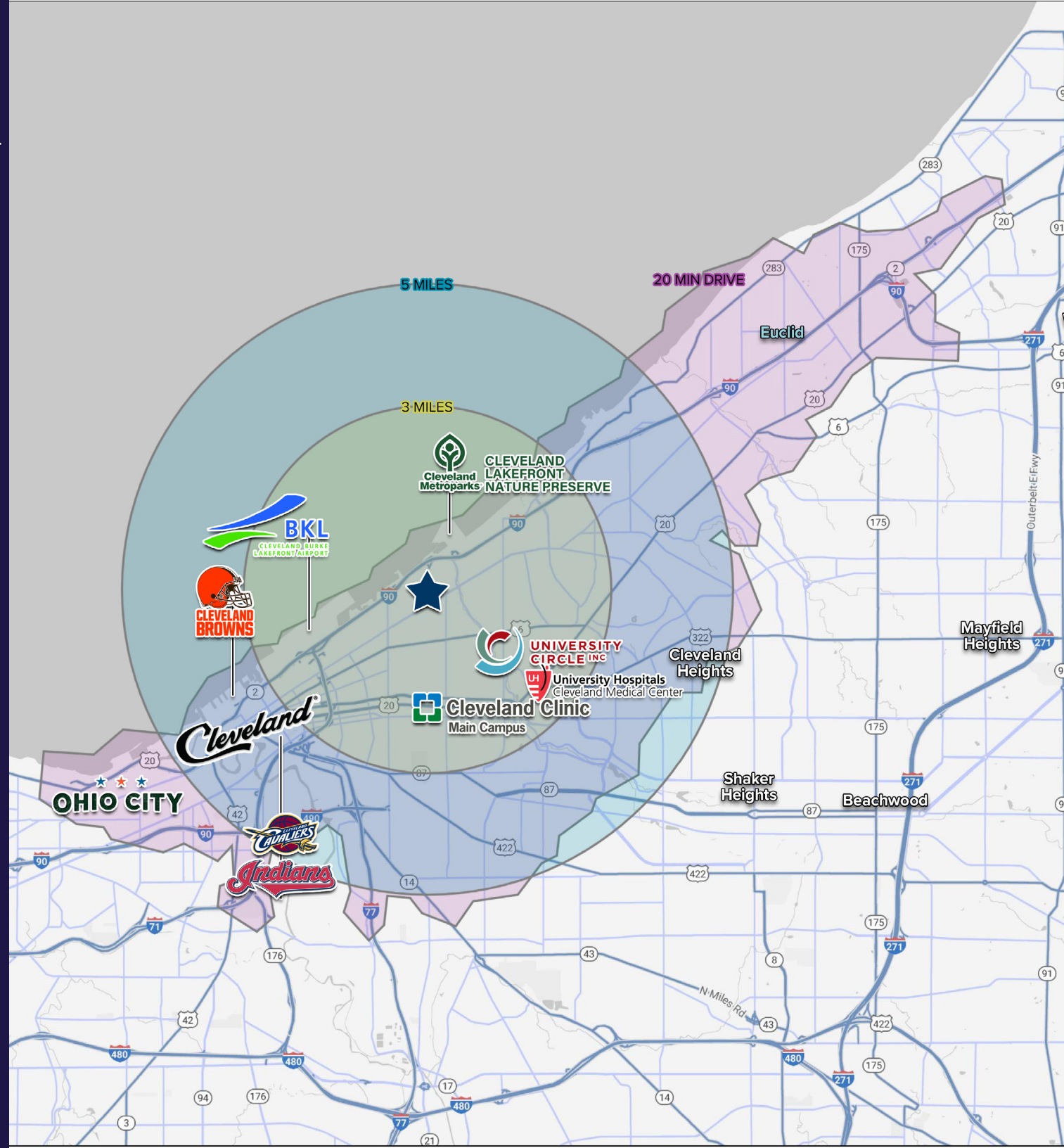



**LIGHTHOUSE ARTSPACE**  
**850 E 72ND STREET**  
**CLEVELAND, OHIO 44103**

**AUSTIN LOVE**

Associate

[alove@crescorealestate.com](mailto:alove@crescorealestate.com)

+1 216 525 1395



**Cushman & Wakefield | CRESCO**

6100 Rockside Woods Blvd, Suite 200

Cleveland, Ohio 44131

[crescorealestate.com](http://crescorealestate.com)

