



## A wide-angle photograph of a large, single-story brick building with a series of arched entrances, each covered by a dark awning. The building features a mix of brick and light-colored vertical siding. In the foreground, there is a paved parking lot with some wet patches and a grassy area. The sky is clear and blue.

# FOR LEASE

- Beautiful office/flex building located in Gunter Industrial Park. Adjacent to Gunter Air Force Base and convenient to the Eastern Blvd. and Congressman Dickinson Drive. ± 10,633 S.F. floor plan with large open areas, conference rooms, storage areas and private offices. 2743-B is ± 10,633 S.F. and is leased to TTL, Inc. Great value for the price for users needing office space and flex space for their business. Contact Nim Frazer, SIOR, for more information at (334) 271-2475.



02/01/20







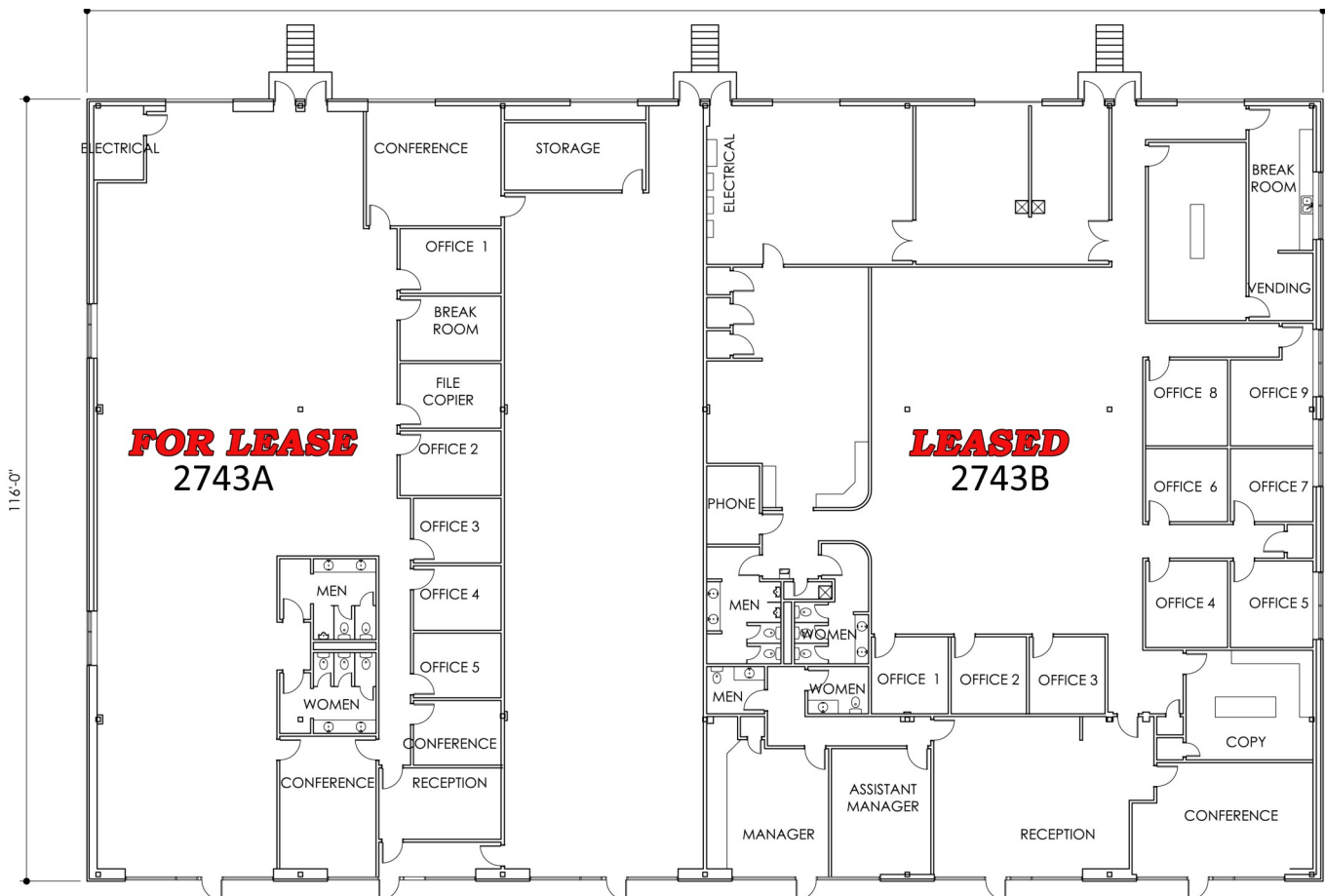

2743-A GUNTER PARK DRIVE  
10,633 SQ. FT.

2743-B GUNTER PARK DRIVE  
10,633 SQ. FT.

EXISTING FLOOR PLAN