

FOR SALE
Class "A" Medical
Office Space



361 W Southlake Blvd., Suite 120, Southlake, TX 76092



PROPERTY HIGHLIGHTS



- Class “A” Medical/Professional Building
- Great Mix of Professional Tenants in the Heart of Southlake
- Class “A” Office Finish Out
- Minutes from Restaurants, Retail and Southlake Town Square and City Hall

PROPERTY HIGHLIGHTS	
Address	361 W Southlake Blvd. Suite 120 Southlake, TX 76092
Space For Buyer	Suite 120: 1,917 SF
Year Built	2016
Zoning	Commercial Medical Office Zoning
Building Size	3,685 SF
Great Location	Convenient Access to Highway 114, SH26, SH121, & Southlake Blvd.
Purchase Price	\$1,501,500.00
Site Highlights	<ul style="list-style-type: none">• Available now!• This beautifully-designed Spa/ office space has a Very Nice Finish Out• Centrally Located Office Building in Prime Location• Easy Ingress/Egress to Major Roads
Excellent Demographics	Primed to serve Southlake affluent, rapidly growing community with households boasting an average income of \$176,385/year in 2 mile radius
Parking	Plenty Surface Parking Spaces





LOCATION OVERVIEW

FLOOR PLAN

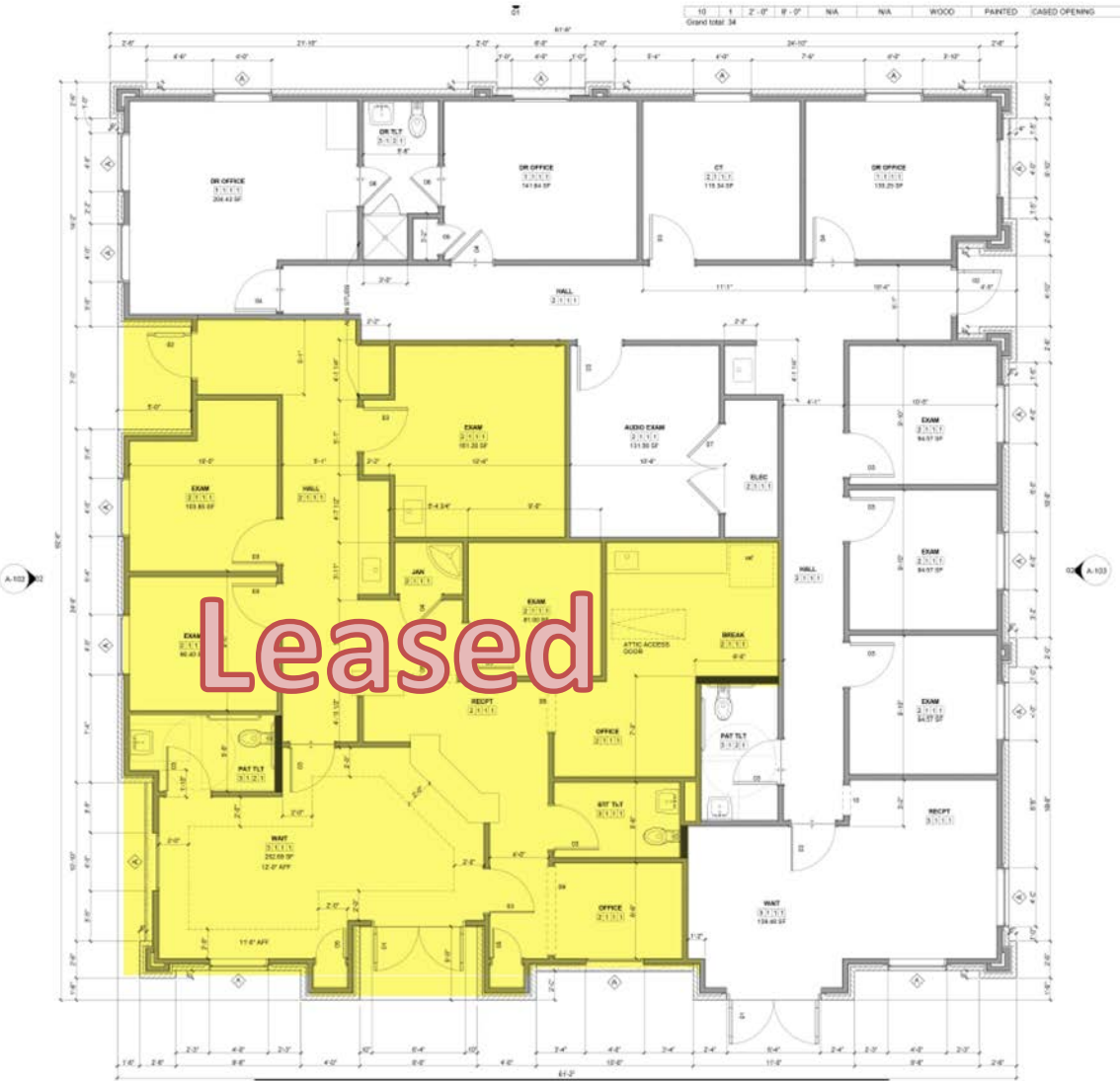



INTERIOR
PHOTOS



CONTACT INFORMATION



PAUL BLIGHT

Partner

C: 214.682.7192

O: 214.637.4300

pblight@glaciercommercial.com



STACEY YEARIAN

Vice President

C: 618.530.3550

O: 214.637.4300

yearian@glaciercommercial.com

361 W Southlake Blvd., Suite 120, Southlake, TX 76092 | OFFICE FOR SALE



glaciercommercial.com

©2024 Glacier Commercial Realty L.P.

All rights reserved. The information contained herein was obtained from sources believed to be reliable. It is subject to verification. The presentation of this property is submitted subject to errors, omissions, change of price or conditions, prior to sale or lease, or withdrawal without notice