

FOR LEASE

Goldenwest Business Park

7300-7404 Bolsa Ave & 15132-15192 Goldenwest Circle
Westminster, CA



±231,250 SF



CONTACT US

Brad Bierbaum (714) 371-9210 | brad.bierbaum@cbre.com | Lic. 00996170
Ryan Peterson (714) 371-9210 | ryan.peterson@cbre.com | Lic. 01336025



AVAILABILITY**PROPERTY PROFILE**

Address 7300-7404 Bolsa Avenue &
15132-15192 Goldenwest Circle
Westminster, CA

Total SF ±231,250 SF

Land Size ±12.63 Acres

Zoning M-2 (Medium Industrial)

Year Built 1967-1969

Clear Height 14-20 Feet

Parking Ratio 2:1,000

Power 100-400 Amps; 120/240 Volts

GL Doors 1-2 Doors per Unit

AVAILABILITY**15140 Goldenwest Circle**

Size: 3,000 SF

Rate: \$1.50/SF Modified Gross

Available: 3/1/2025

Description:

Reception area, two private offices, one restroom, large warehouse with 1 GL door.

15140 Goldenwest Circle – 3,000 SF

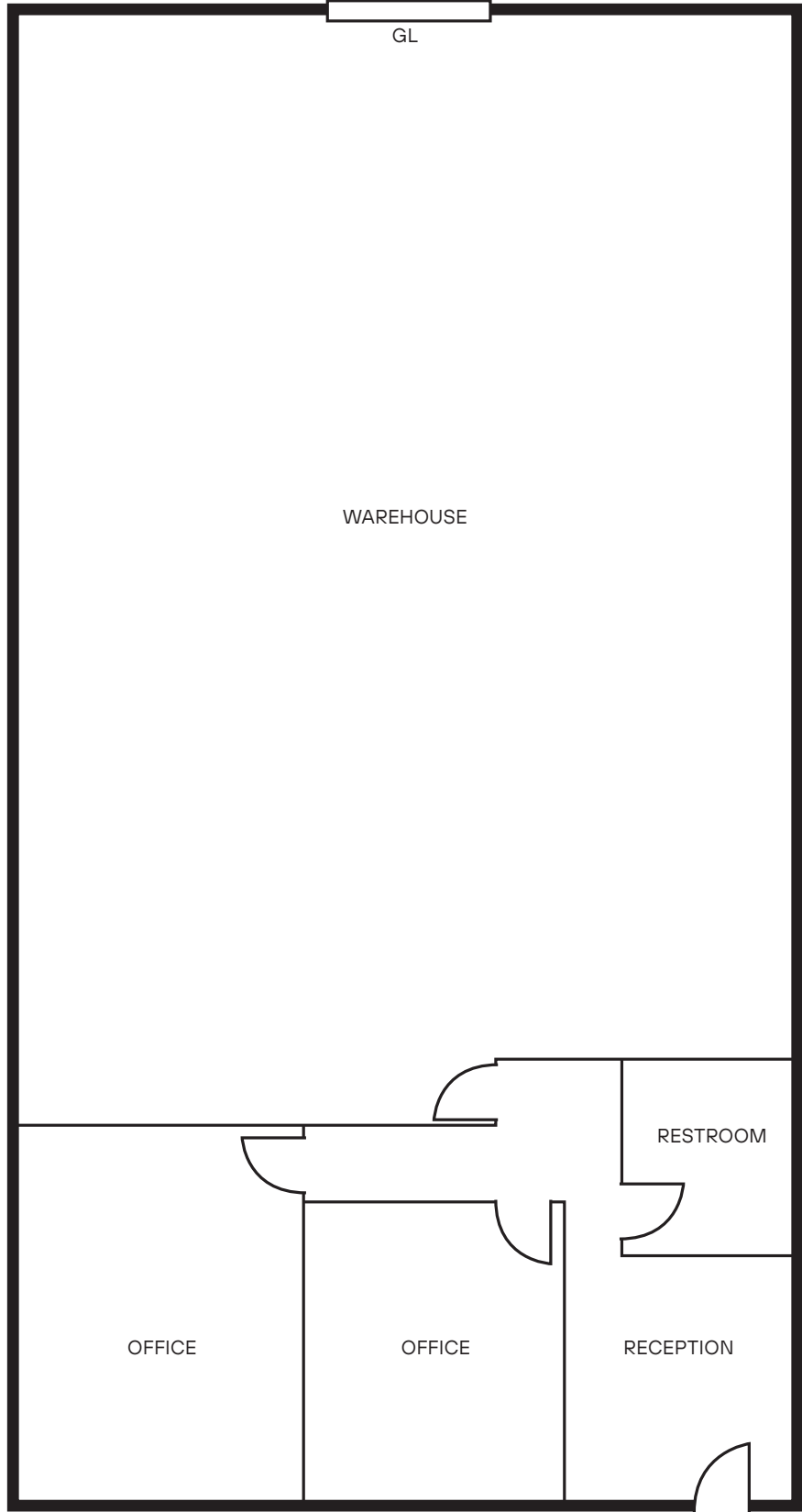

SITE PLAN



PHOTOS

