



## Shops at McNichols Square

19801-19845 W McNichols Rd, Detroit, MI 48219



**JMC MANAGEMENT** LLC  
A FULL SERVICE BROKERAGE AND MANAGEMENT FIRM

**Trena Edmondson**

JMC Management, LLC

24500 Northwestern Hwy, Suite 100, Southfield, MI 48075

[Trena.edmondson@jmcmanagement.com](mailto:Trena.edmondson@jmcmanagement.com)

(586) 427-9410 Ext: 113



# Shops at McNichols Square

\$15.69 - \$23.80 /SF/YR

Neighborhood retail center...

- Heavy daytime traffic
- Bus line
- Great tenant mix

Shops at McNichols Square  
19801 - 19845 West McNichols Road

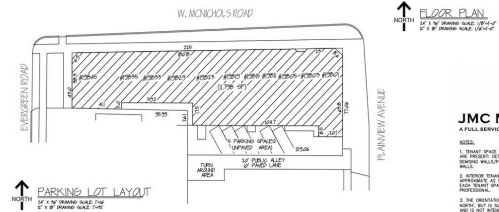
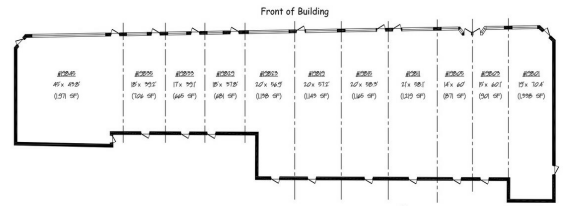

**JMC**  
**JMC MANAGEMENT**<sup>LLC</sup>  
A FULL SERVICE BROKERAGE AND MANAGEMENT FIRM  
NOTE:  
1. SHOWN GROSS AREA CALCULATION WHICH EXCLUDES DOORWAY WALLS AND INTERIOR WALLS. EXCLUDED BY AGREEMENT TO THE OWNER OR OTHER WALL PARTITIONS AND TO THE EXTERIOR FACE OF EXTERIOR WALLS.  
2. EXTERIOR FRONT FACING WITH ONE (1) STORE FRONTAGE AND INTERIOR TO BE SHOWN. THE EXTERIOR WALLS AND INTERIOR WALLS SHALL BE SHOWN AS SHOWN BY A SEPARATE PROFESSIONAL.  
3. THE LOCATION OF THE INDICATED AREA WHICH MAY NOT BE TRUE. NOTE: THIS IS A PRELIMINARY PLAN. THE PLAN IS "AS SHOWN" AND IS NOT INTENDED FOR CONSTRUCTION.

Rental Rate:	\$15.69 - \$23.80 /SF/YR
Total Space Available:	2,044 SF
Max. Contiguous:	1,338 SF
Property Type:	Shopping Center
Center Type:	Strip Center
Stores:	11
Center Properties:	1
Gross Leasable Area:	11,000 SF
Walk Score ®:	68 (Somewhat Walkable)
Transit Score ®:	51 (Good Transit)
Rental Rate Mo:	\$1.31 /SF/MO

### 1st Floor Ste 19801

1

Space Available	1,338 SF
Rental Rate	\$15.69 /SF/YR
Date Available	30 Days
Service Type	Modified Gross
Space Type	Relet
Space Use	Office
Lease Term	Negotiable

### 1st Floor Ste 19835

2

Space Available	706 SF
Rental Rate	\$23.80 /SF/YR
Date Available	Now
Service Type	Modified Gross
Space Type	Relet
Space Use	Retail
Lease Term	2 Years

Excellent open space for any business.



## 19801-19845 W McNichols Rd, Detroit, MI 48219

Neighborhood retail center