

Greenhouse Square

16040—16220 SE 82nd Ave, Clackamas, OR 97015

**New Façade
in 2026**



Greenhouse Square is a high traffic neighborhood center shadow anchored by Fred Meyer on 82nd Ave. Located just off of I-205 this shopping center is easily accessible and serves a broad trade area. This center has a great Tenant mix with neighbors including Dollar Tree, Black Rock Coffee, Wendy's, and Taco Bell. Greenhouse Square has ample parking, in addition to building signage and monument signage.

Available:

Suite 16060—3,700 SF*

Suite 16068—670 SF*

**Divisible to approx. 1,500 SF*

**Can combine to 4,370 SF*

\$28.00 SF/Year, NNN
Approx. \$10.00 NNN



503.675.0900 | Ashley Rhea or Craig Barnard
ashley@barnardcommercial.com or craig@barnardcommercial.com
www.barnardcommercial.com | 5200 Meadows Road, Suite 150, Lake Oswego, OR 97035

Suite	Tenant	GLA sq. ft.
16050	Willamette Veterinary	2,949
16052	My Gym Children's Fitness Ctr.	3,112
16054	Golden Dragon Foot Spa	963
16056	Lighthouse Fish & Chips	1,916
16058	NW Lice Centers, Inc.	868
16060	Available	3,700
16068	Available	670
16080	Lighthouse	2,148
16100	Conways Jazz Kitchen	4,000
16110	Once Upon a Child	5,244
16112	Arthur Murray Dance Studio	5,063
16116	Impact Jiu Jitsu	4,038
16120	Cosmic Vapor Lounge	1,280
16122	Bubble Tea	1,270
16132	Akira Sushi	2,855
16136	Remedy Salon	1,067
16138	Black Rock Coffee	540
16140	160 Driving	1,475
16142	U.L.C. Liquor Store	2,555
16144	O.C. Nails	1,319
16152	Swiss Denture Center	1,150
16180	Cigar Shop	982
16184	New Cathay Restaurant	3,150
16186	Mudpuppies Grooming	1,663
16190	Salon Centric/Maly's West	3,312
16200	Dollar Tree #5032	12,763

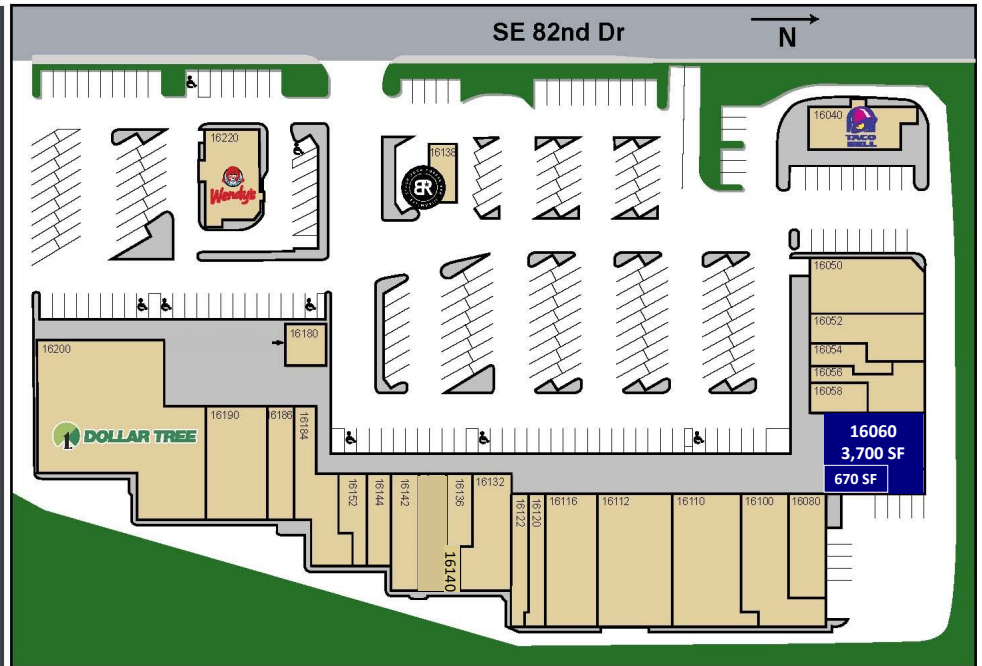

503.675.0900 | Ashley Rhea or Craig Barnard
 ashley@barnardcommercial.com or craig@barnardcommercial.com
 www.barnardcommercial.com | 5200 Meadows Road, Suite 150, Lake Oswego, OR 97035

EXTERIOR FAÇADE RENDERINGS

2026 PLANS



503.675.0900 | Ashley Rhea or Craig Barnard
ashley@barnardcommercial.com or craig@barnardcommercial.com
www.barnardcommercial.com | 5200 Meadows Road, Suite 150, Lake Oswego, OR 97035

Suite 16068—670 SF



SPACE HIGHLIGHTS:

- Break room
- Private Office
- Storage cabinets
- Restroom



503.675.0900 | Ashley Rhea or Craig Barnard
ashley@barnardcommercial.com or craig@barnardcommercial.com
www.barnardcommercial.com | 5200 Meadows Road, Suite 150, Lake Oswego, OR 97035