

all designs, ideas & plans represented by these drawings are the exclusive property of 3-1 development and shall not be reproduced in part or whole without the prior written permission. any unauthorized reuse of these plans other than for the project and location shown is strictly prohibited.

seal:

TENANT
IMPROVEMENT
FOR:

MAYWEATHER
BOXING + FITNESS

1650 S. Pacific Coast Highway
Suite 102
Redondo Beach, CA 90277

PLAN ISSUANCE

-	-
-	-

DELTA REVISIONS

△	-	-

PROJECT NUMBER
22-006

designer: dt

checked: dst

SHEET NUMBER
& NAME

FLOOR PLAN -
SCHEME D

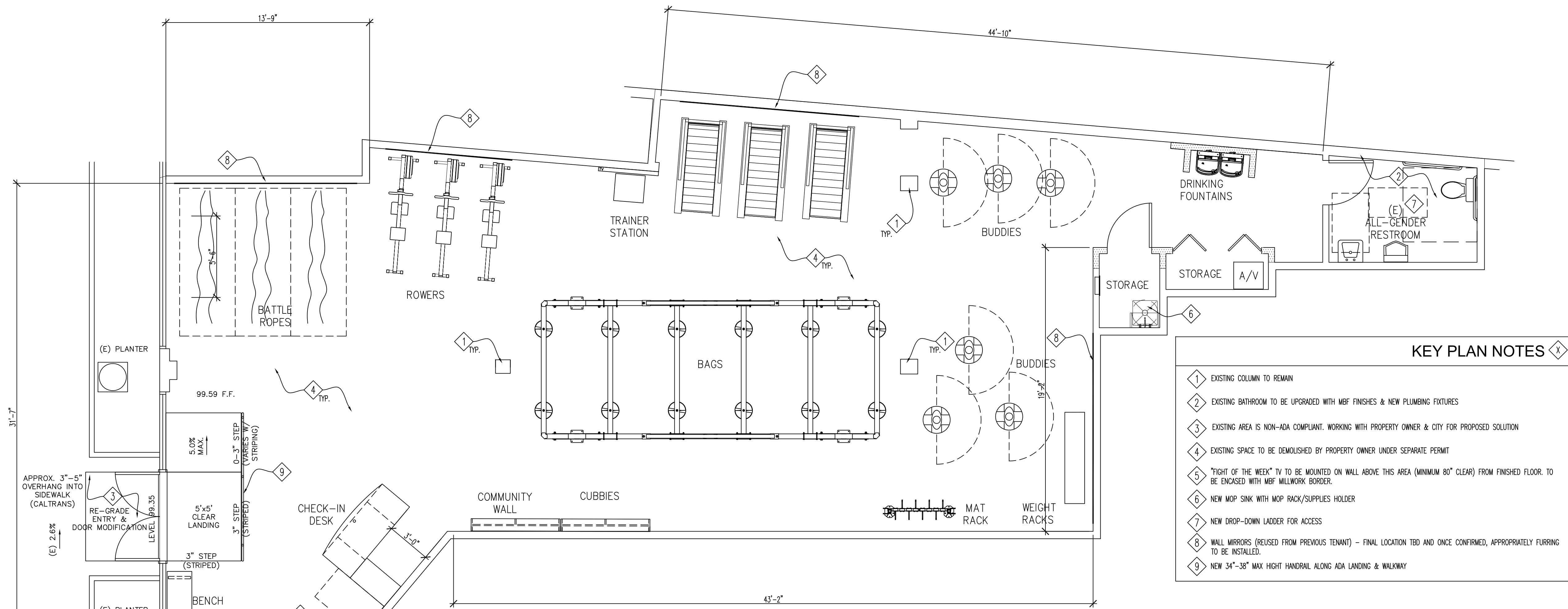

- KEY PLAN NOTES**
- EXISTING COLUMN TO REMAIN
 - EXISTING BATHROOM TO BE UPGRADED WITH MBF FINISHES & NEW PLUMBING FIXTURES
 - EXISTING AREA IS NON-ADA COMPLIANT. WORKING WITH PROPERTY OWNER & CITY FOR PROPOSED SOLUTION
 - EXISTING SPACE TO BE DEMOLISHED BY PROPERTY OWNER UNDER SEPARATE PERMIT
 - "FIGHT OF THE WEEK" TV TO BE MOUNTED ON WALL ABOVE THIS AREA (MINIMUM 80" CLEAR) FROM FINISHED FLOOR. TO BE ENCASED WITH MBF MILLWORK BORDER.
 - NEW MOP SINK WITH MOP RACK/SUPPLIES HOLDER
 - NEW DROP-DOWN LADDER FOR ACCESS
 - WALL MIRRORS (REUSED FROM PREVIOUS TENANT) - FINAL LOCATION TBD AND ONCE CONFIRMED, APPROPRIATELY FURRING TO BE INSTALLED.
 - NEW 34"-38" MAX HIGH HANDRAIL ALONG ADA LANDING & WALKWAY

- WALL LEGEND**
- NEW FULL HEIGHT INTERIOR WALL WITH INSULATION
 - EXISTING WALL

- PLAN NOTES**
- SCHEMATIC PLAN HAS NOT BEEN APPROVED BY CLIENT.
 - REFER TO MAYWEATHER DESIGN PACKAGE FOR ADDITIONAL INFORMATION.
 - SOUND INSULATION MATERIAL TO BE INSTALLED PER ACOUSTIC VENDOR RECOMMENDATION

01 PROPOSED FLOOR PLAN
SCALE: 1/4" = 1'-0"