

8/17/99

PROJECT REFERENCE NO. U-5798A		SHEET NO. 7	
RW SHEET NO.			
ROADWAY DESIGN ENGINEER	HYDRAULICS ENGINEER	ROADWAY DESIGN ENGINEER	HYDRAULICS ENGINEER
NOT A CERTIFIED DOCUMENT AS TO THE ORIGINAL DOCUMENT BUT ONLY AS TO THE REVISIONS.	NOT A CERTIFIED DOCUMENT AS TO THE ORIGINAL DOCUMENT BUT ONLY AS TO THE REVISIONS.	NOT A CERTIFIED DOCUMENT AS TO THE ORIGINAL DOCUMENT BUT ONLY AS TO THE REVISIONS.	NOT A CERTIFIED DOCUMENT AS TO THE ORIGINAL DOCUMENT BUT ONLY AS TO THE REVISIONS.
THIS DOCUMENT ORIGINALLY ISSUED AND SEALED BY: CHARLES J. YOUNG, PE	THIS DOCUMENT ORIGINALLY ISSUED AND SEALED BY: COLE BENJAMIN, PE	THIS DOCUMENT ORIGINALLY ISSUED AND SEALED BY: CHARLES J. YOUNG, PE	THIS DOCUMENT ORIGINALLY ISSUED AND SEALED BY: COLE BENJAMIN, PE
ON 02/02/2022	ON 02/02/2022	ON 02/02/2022	ON 02/02/2022
THIS DOCUMENT IS ONLY CERTIFIED AS TO THE REVISIONS.		THIS DOCUMENT IS ONLY CERTIFIED AS TO THE REVISIONS.	

ROADWAY DESIGN ENGINEER

HYDRAULICS ENGINEER

DOCUMENT NOT CONSIDERED FINAL UNLESS ALL SIGNATURES COMPLETED

RS&H 8521 SIX FORKS ROAD, SUITE 400 RALEIGH, NC 27615 NC FIRM LICENSE No: F-0493

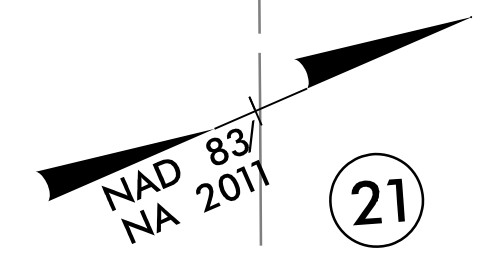

-L- CURVE DATA

PI Sta 85+35.62	PI Sta 93+91.02
$\Delta = 28^{\circ} 56' 41.9''$ (RT)	$\Delta = 8^{\circ} 17' 55.2''$ (LT)
$D = 3^{\circ} 19' 52.1''$	$D = 1^{\circ} 40' 48.8''$
$L = 868.92'$	$L = 493.90'$
$T = 443.94'$	$T = 247.38'$
$R = 1,720.00'$	$R = 3,410.00'$
$SE = 035$	$SE = RC'$
$RO = 126$	

REVISIONS
 1 CONST. REV. - 9/7/2022 - SHIFTED STR. 0705, REMOVED PIPE FROM 0702 TO 0705 TO AVOID SEWER CONFLICTS. (CMB)
 2 CONST. REV. - 01/31/2023; REDUCED GUARDRAIL ON -L- FROM 78+00 - 86+00 LT TO 78+00 - 81+18 LT WITH 4:1 SIDE SLOPES (JMB)

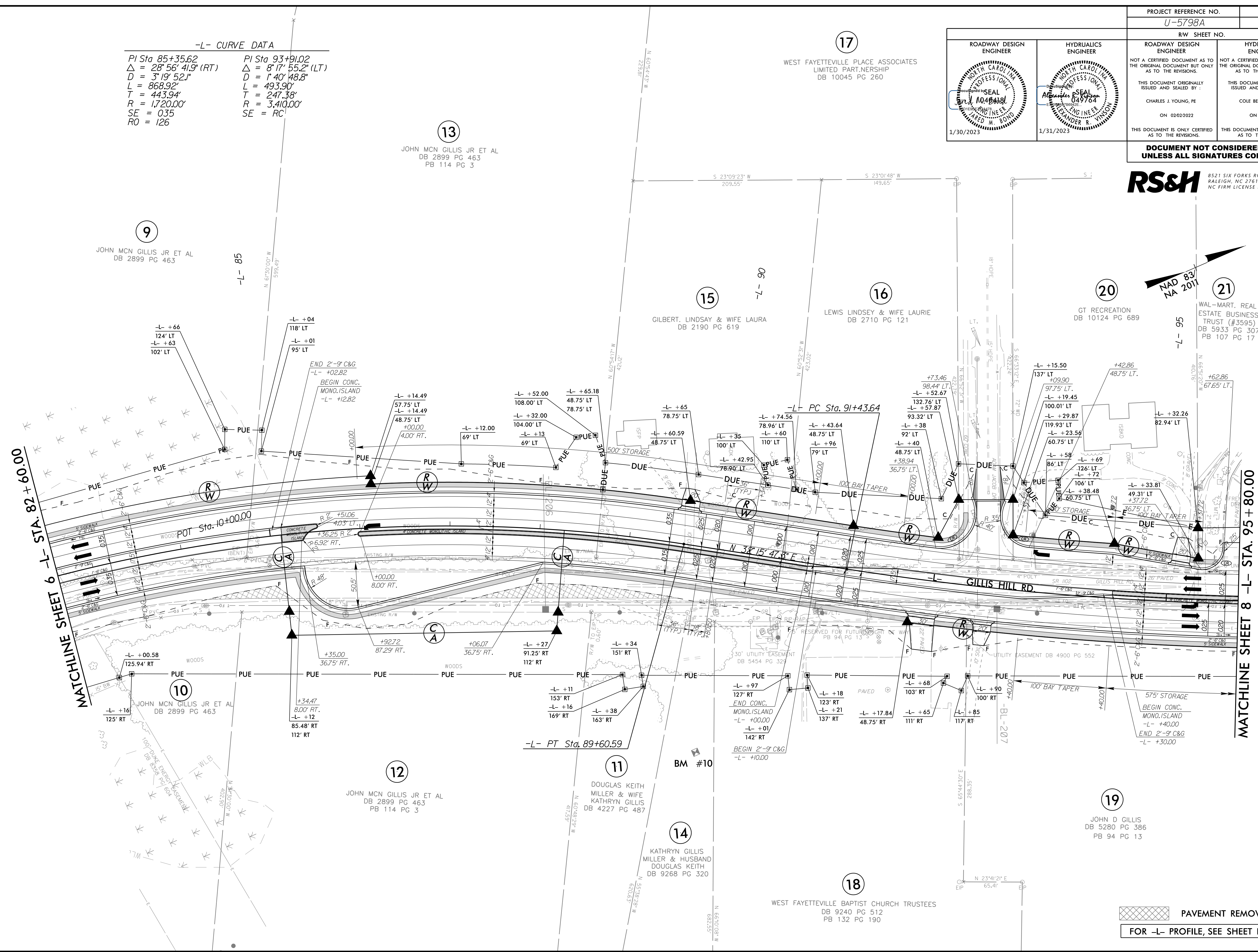

30-JAN-2023 12:28
 R:\Projects\U-5798A\U-5798A_U-5798A_Rdy_psh_7.dgn
 USER:RMB

PAVEMENT REMOVAL
 FOR -L- PROFILE, SEE SHEET NO. 11