

(206) 328 - 3333
Jill@hunterscapital.com
HuntersCapital.com



Moore Building

416 15th Ave E, Seattle, WA



Former grocery store, this 15,000 SF is open for storage, industrial use, or creative use! Located at 15th Ave E's local and lively retail corridor. Enjoy flexibility with a 1 year lease term then MTM - bring your idea to activate this blank canvas.

Property Features

- Available October 1
- \$10/SF + utilities, as-is
- 1-year lease term then MTM
- Street-level access
- 2 loading docks
- Parking in rear of building
- Front parking available only if user is open to the public



Accessibility/Parking

- On the bus 10 route
- Easy I-5 access
- University District - 10 min drive
- Light Rail Station - 15 min walk
- Surrounded by destination retail & restaurants.

Neighborhood

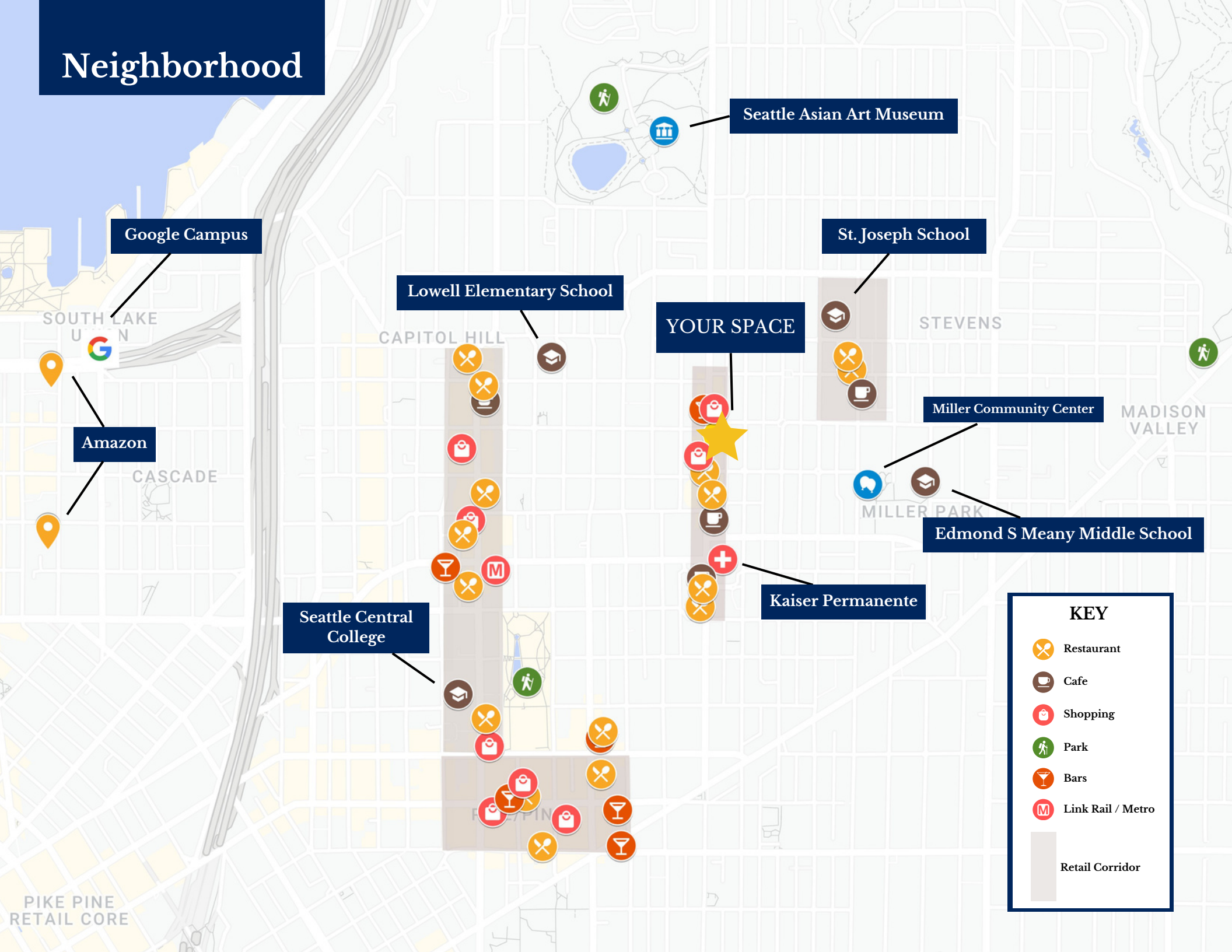

Google Campus

Seattle Asian Art Museum

St. Joseph School

Lowell Elementary School

YOUR SPACE

Miller Community Center

Amazon

Edmond S Meany Middle School

Kaiser Permanente

Seattle Central College

KEY

-  Restaurant
-  Cafe
-  Shopping
-  Park
-  Bars
-  Link Rail / Metro
-  Retail Corridor

PIKE PINE
RETAIL CORE

Demographic

(Within 1 Mile Radius)



69,254

POPULATION

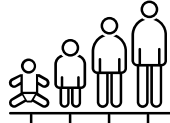

38

MEDIAN AGE



66%

COLLEGE DEGREE



38,352

HOUSEHOLDS



\$124,813

AVG. HOUSEHOLD INCOME



Floor Plan

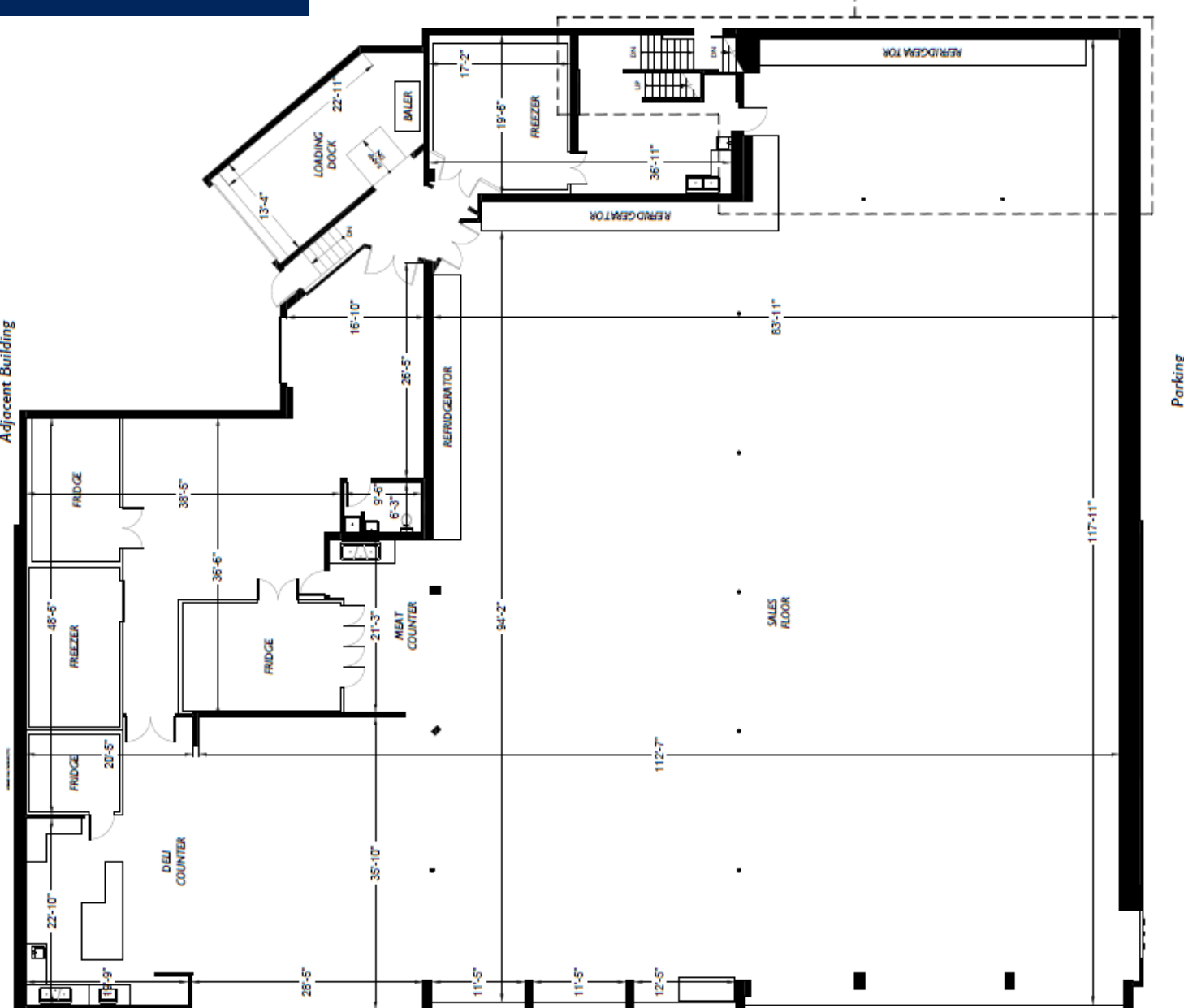

15TH AVE E

[Click to View
Video Tour](#)



Loading Dock



15th Ave E Street View



Station 7



Kaiser
Permanente



Bus 10 Stop



Rione XII

URBAN INSPIRED PRESERVATION MINDED COMMUNITY DRIVEN

Hunters Capital preserves and revitalizes the character of Seattle's most historic neighborhoods. We pride ourselves in creating meaningful relationships with our tenants and driving community engagement within our wonderfully diverse city.

WE HAVE SPACE FOR YOU

Give us a call, or visit our website to learn more about our unique properties.

(206) 328 - 3333

www.hunterscapital.com

Jill@hunterscapital.com

1620 Broadway, Suite 200



Above: 15th Ave E Street View



SCAN TO VISIT OUR WEBSITE

