

# FOR LEASE: +/- 8,985 SF OFFICE/WAREHOUSE SPACE

DUTCH SQUARE | 6730 AMSTERDAM WAY

WILMINGTON, NORTH CAROLINA, NEW HANOVER COUNTY





## SUMMARY

ADDRESS	<b>Dutch Square</b> 6730 Amsterdam Way Wilmington, NC 28405   New Hanover County
BUILDING SF	± 8,985 SF
LEASE RATE	\$14.00/SF   NNN
DATE AVAILABLE	December 1st, 2024 <i>(Approximately)</i>
DESCRIPTION	± 8,985 SF freestanding office/warehouse building for lease on ± 0.97 acres in Dutch Square, just off Market Street. The building consists of approximately 45% office space, with the remainder in climate-controlled warehouse. The building is equipped with 4 grade-level overhead doors. The office buildout consists of 15 private offices, a large cubicle area, conference room, break room, receptionist office, and 3 restrooms (to include one in the warehouse).

PHOTOS



PHOTOS



# FLOOR PLAN

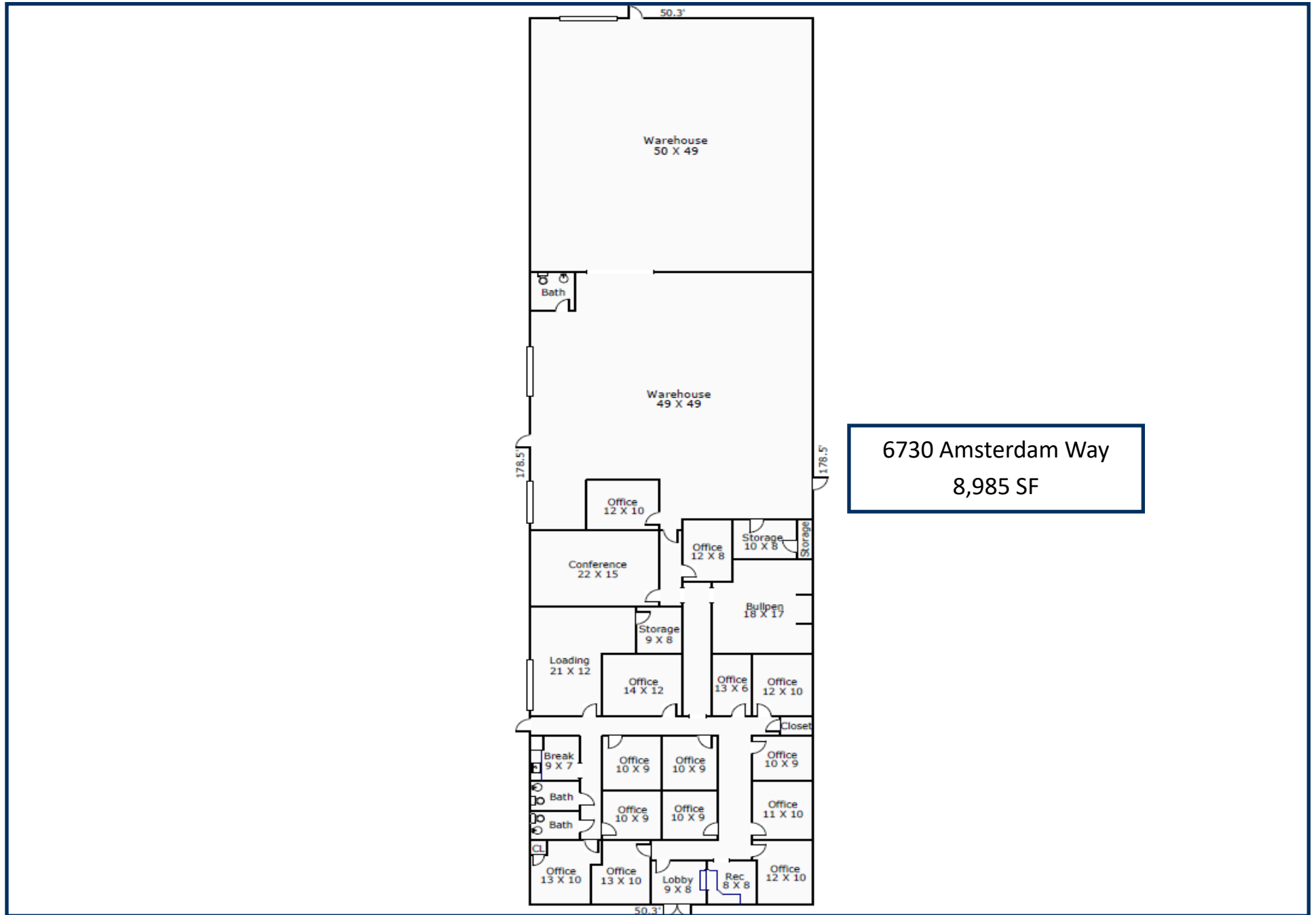

6730 Amsterdam Way  
8,985 SF

AERIAL MAP

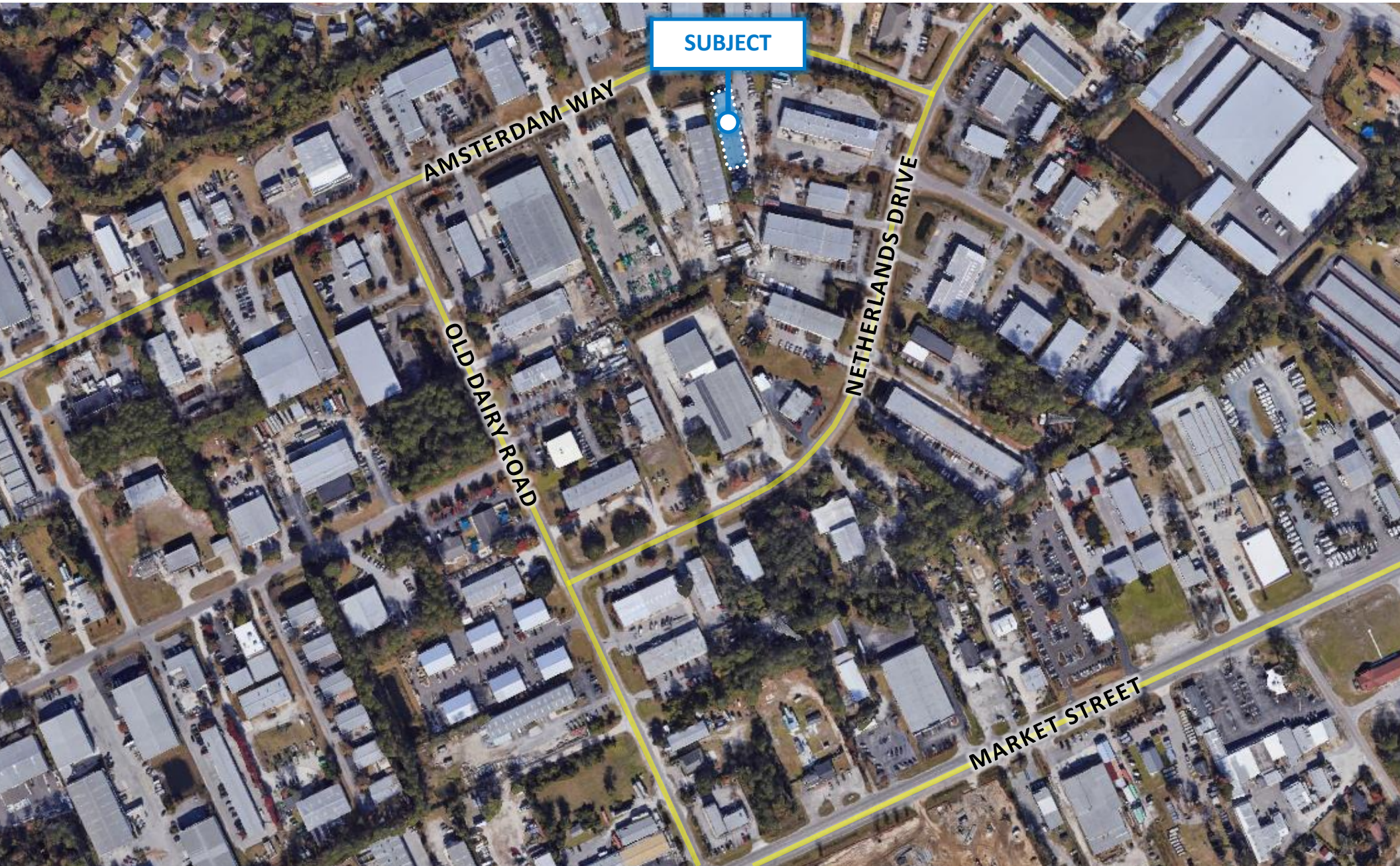

# LOCATION MAP





**WILL LEONARD**

Senior Vice President

910.344.1015 direct

910.233.5351 cell

wleonard@capefearcommercial.com



102 Autumn Hall Drive | Suite 210 | Wilmington, NC 28403  
capefearcommercial.com

© 2023 Cape Fear Commercial, LLC. All rights reserved. The information contained in the following Marketing Brochure is proprietary and strictly confidential. It is intended to be reviewed only by the party receiving it from Cape Fear Commercial and should not be made available to any other person or entity without the written consent of Cape Fear Commercial. This Marketing Brochure has been prepared to provide summary, unverified information to prospective purchasers, and to establish only a preliminary level of interest in the Subject property. The information contained herein is not a substitute for a thorough due diligence investigation. Cape Fear Commercial has not made any investigation, and makes no warranty or representation, with respect to the income or expenses for the Subject property, the future projected financial performance of the property, the size and square footage of the property and improvements, the presence or absence of contaminate substances, PCB's or asbestos, the compliance with State and Federal regulations, the physical condition of the improvements thereon, or the financial condition or the business prospects of any tenant's plans or intentions to continue its occupancy of the Subject property. The information contained in this Marketing Brochure has been obtained from sources we believe to be reliable; however, Cape Fear Commercial has not verified, and will not verify, any of the information contained herein, nor has Cape Fear Commercial conducted any investigation regarding these matters and makes no warranty or representation whatsoever regarding the accuracy or completeness of the Information provided. All potential buyers must take appropriate measures to verify all of the information set forth herein.