

FOR SALE

±11,562 SF INDUSTRIAL BUILDINGS

6430 & 6450 Roland St, Buena Park, CA 90621



Buildings Can be Sold Separately or Together

PROPERTY FEATURES

- Two Freestanding Buildings Totaling ±11,562 SF
 - 6430 Roland Street: ±5,829 SF
 - 6450 Roland Street: ±5,733 SF
- ±2,200 SF of Office Total
- Heavy Power: 1,400 AMPS of Power at 240 Volt (Verify)
- Secured Shared Fenced Yard Area
- Four (4) Ground Level Doors
- 12' - 15' Warehouse Clear Height
- 2.0/1,000 Parking Ratio (12 Spaces Total)
- HVAC in Warehouse of 6450 Building
- Sprinklers Throughout
- Immediate Access to I-5 & 91 Freeways



Note: Measurements and sizes are approximate and are subject to change.

STAN S. KWAK
Senior VP | Partner
Lic. #01824776
(714) 935-2327
skwak@voitco.com

SELDEN MCKNIGHT
Vice President | Partner
Lic. #2027919
(714) 935-2323
smcknight@voitco.com

ZAC KOLANDER
Senior Associate
Lic #02096759
(714) 935-2301
zkolander@voitco.com



2400 E. Katella Avenue, Suite 750
Anaheim, CA 92806
www.VoitCo.com

FOR SALE

±11,562 SF INDUSTRIAL BUILDINGS

6430 & 6450 Roland St, Buena Park, CA 90621

SITE PLAN

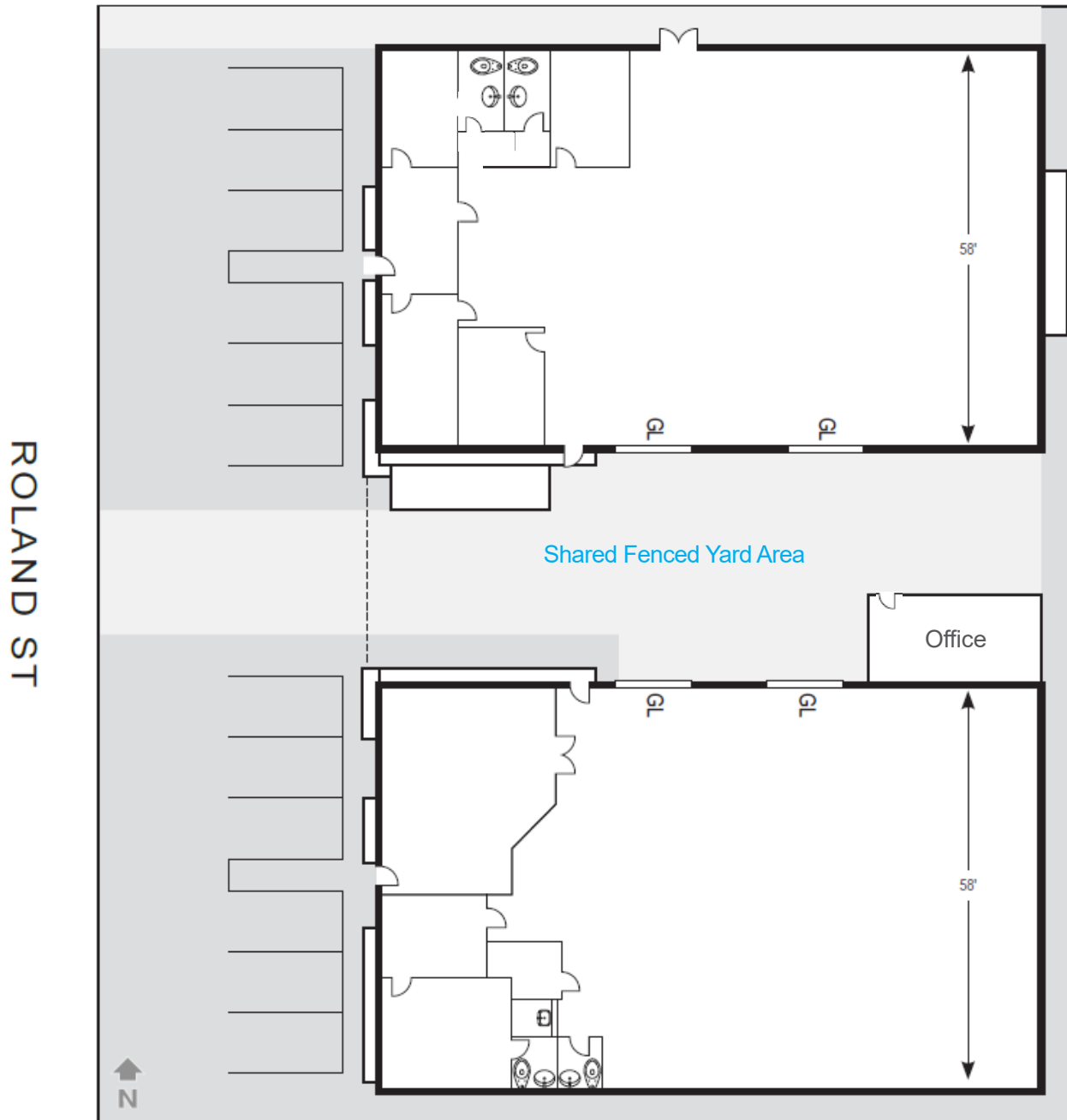

STAN S. KWAK
Senior VP | Partner
Lic. #01824776
(714) 935-2327
skwak@voitco.com

SELDEN MCKNIGHT
Vice President | Partner
Lic. #2027919
(714) 935-2323
smcknight@voitco.com

ZAC KOLANDER
Senior Associate
Lic #02096759
(714) 935-2301
zkolander@voitco.com

Voit

REAL ESTATE SERVICES

CLIENT
RESOURCE GROUP

2400 E. Katella Avenue, Suite 750
Anaheim, CA 92806
www.VoitCo.com