



RETAIL SPACE AVAILABLE

3229 W Cypress St | TAMPA



3229 W Cypress St, Tampa, FL 33607

ABOUT 3229 W CYPRESS

3229 W Cypress is a mixed use shopping center featuring multiple local businesses and ample parking. Situated in a rapidly growing urban Tampa market, the property draws from a high-income, professional customer base, making it well suited for boutique, wellness, restaurant, and service-oriented retail.

STANDOUT RETAIL SPACE

- TOTAL RETAIL SPACE 672 SF
- TURNKEY
- LOCATED JUST EAST OF 1.8M SF MIDTOWN
- 27 PARKS
- HH INCOME 1 MILE: \$129,601
- 198,688 WORKERS IN 3 MILES

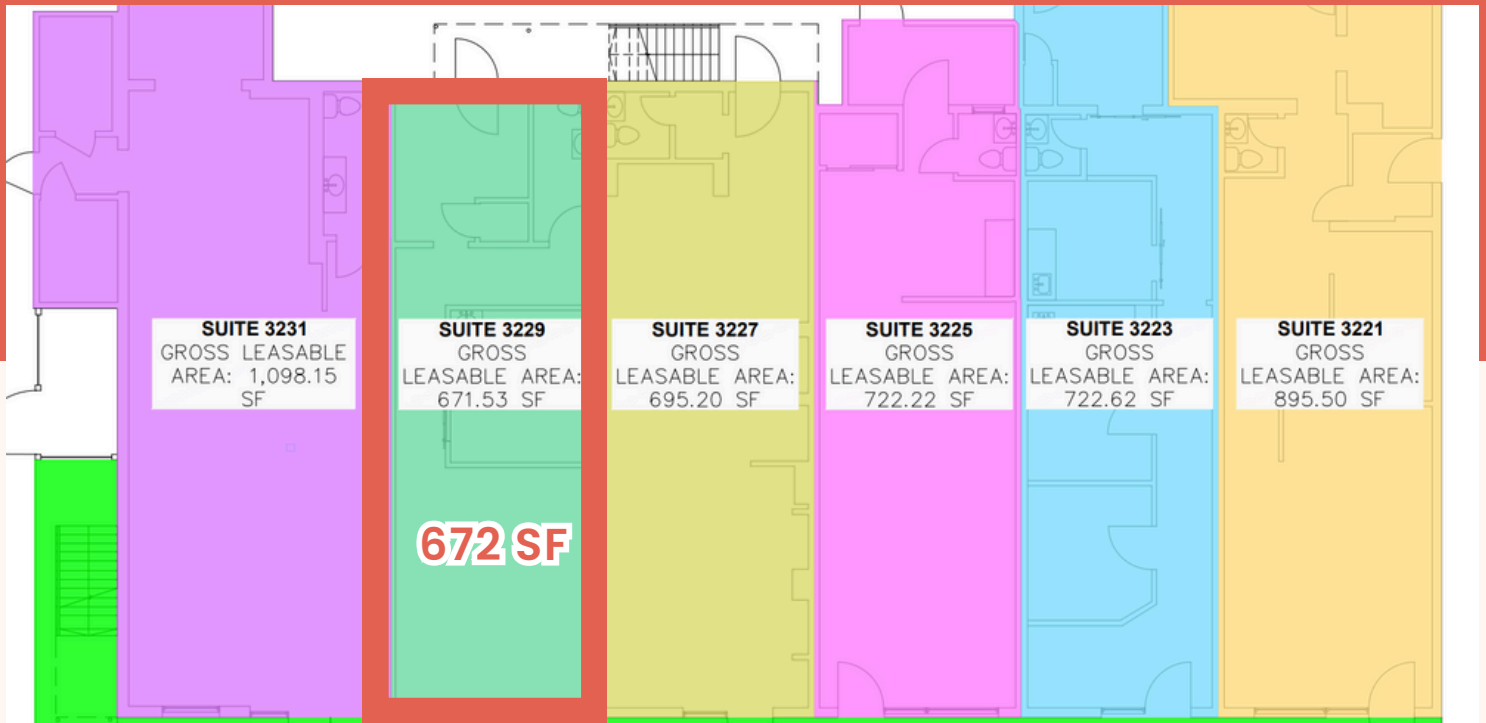

HANNAH LYNN

HANNAH@ARCHERGROUPE.COM
813.399.1904

LAUREN CAMPBELL

LAUREN@ARCHERGROUPE.COM
813.777.6258

813.463.0163

archergroupe.com

2412 Central Ave | St. Pete

LIC. REAL ESTATE BROKER