

PRESTON PARK TOWERS

4965-4975 Preston Rd.
Plano, TX 75093

Office For Lease



Leasing Information:
214.740.3300

Campbell Henry
214.740.4468
chenry@lpc.com

Chris Axley
214.740.3419
caxley@lpc.com

Hudson Dozier
214.740.3367
hdozier@lpc.com

Lincoln

Lincoln Property Company
8111 Douglas Avenue
Dallas, TX 75225

www.lpc.com

PRESTON PARK TOWERS

Office For Lease

4965-4975 Preston Rd. | Plano, TX 75093



Property Highlights

- Located in the heart of Plano
- Immediate access to President George Bush Turnpike (190) and the Dallas North Tollway
- Renovated 2016-2017
- Manned security
- Fitness center, tenant lounge and courtyard
- Two conference centers – one large 50-person conference facility; one small 20-person conference facility
- On-site deli and coffee shop

Availabilities

- | Availabilities | SF | Lease Rate | Date Available |
|------------------------|-----------|-------------|----------------|
| Suite 140 - Building 1 | 2,206 SF | \$31.50 + E | Now |
| Suite 225 - Building 1 | 1,469 SF | \$31.50 + E | Now |
| Suite 230 - Building 1 | 2,430 SF | \$31.50 + E | Now |
| Suite 235 - Building 1 | 2,154 SF | \$31.50 + E | Now |
| Suite 700 - Building 1 | 8,244 SF | \$31.50 + E | Now |
| Suite 750 - Building 1 | 3,404 SF | \$31.50 + E | Now |
| Suite 100 - Building 2 | 4,092 SF | \$31.50 + E | Now |
| Suite 120 - Building 2 | 1,195 SF | \$31.50 + E | Now |
| Suite 180 - Building 2 | 4,494 SF | \$31.50 + E | Now |
| Suite 425 - Building 2 | 5,059 SF | \$31.50 + E | Now |
| Suite 450 - Building 2 | 11,351 SF | \$31.50 + E | Now |
| Suite 505 - Building 2 | 1,226 SF | \$31.50 + E | Now |
| Suite 550 - Building 2 | 5,820 SF | \$31.50 + E | Now |
| Suite 600 - Building 2 | 4,383 SF | \$31.50 + E | Now |
| Suite 875 - Building 2 | 1,565 SF | \$31.50 + E | Now |

SF

Lease Rate

Date Available

Campbell Henry

214.740.4468
chenry@lpc.com

Chris Axley

214.740.3419
caxley@lpc.com

Hudson Dozier

214.740.3367
hdozier@lpc.com

Lincoln

PRESTON PARK TOWERS

Additional Photos

4965-4975 Preston Rd. | Plano, TX 75093

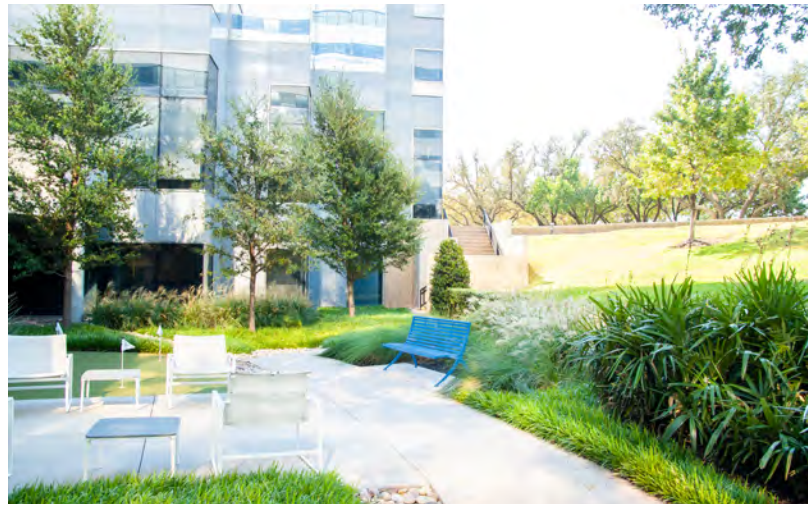
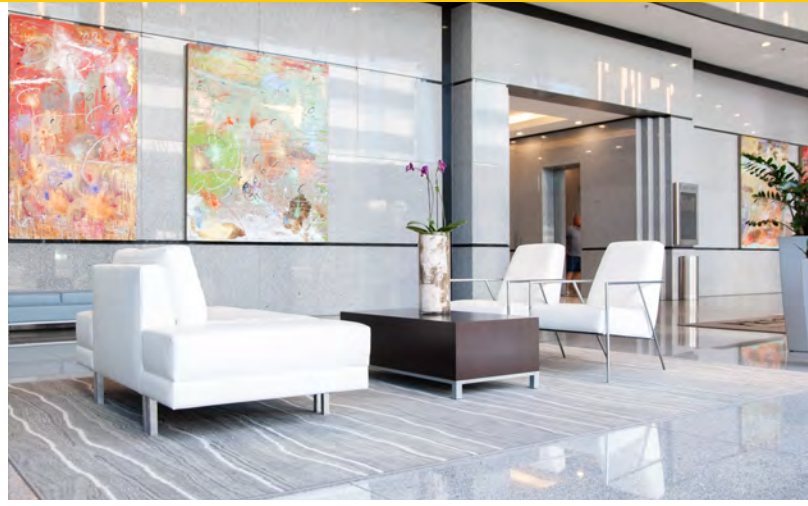

Campbell Henry

214.740.4468
chenry@lpc.com

Chris Axley

214.740.3419
caxley@lpc.com

Hudson Dozier

214.740.3367
hdozier@lpc.com

Lincoln

PRESTON PARK TOWERS

Demographics Map & Report

4965-4975 Preston Rd. | Plano, TX 75093

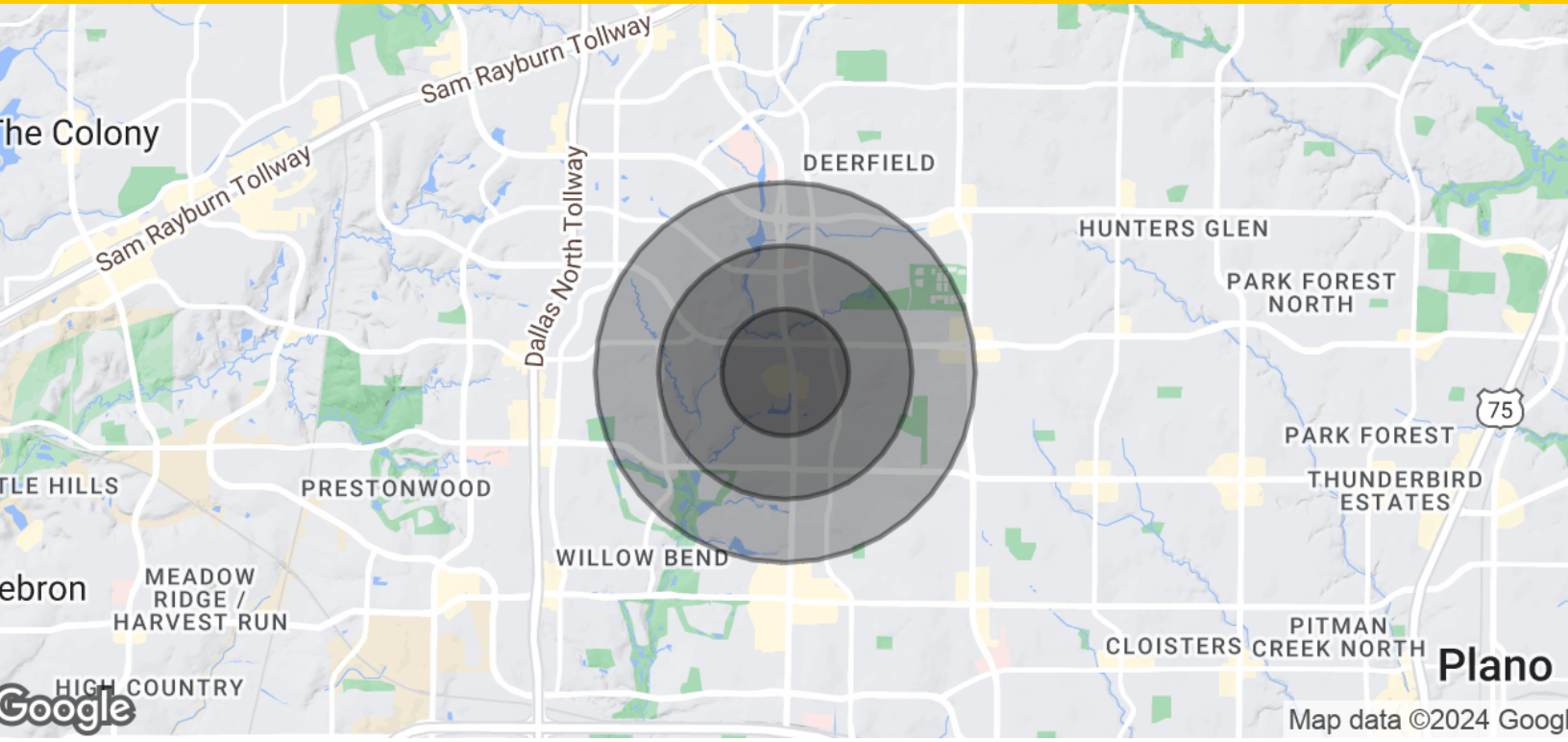

Population	0.5 Miles	1 Mile	1.5 Miles
Total Population	3,843	14,956	29,598
Average Age	42	41	41
Average Age (Male)	41	40	40
Average Age (Female)	44	42	42
Households & Income	0.5 Miles	1 Mile	1.5 Miles
Total Households	1,662	6,350	11,995
# of Persons per HH	2.3	2.4	2.5
Average HH Income	\$166,746	\$166,921	\$179,484
Average House Value	\$711,060	\$658,923	\$656,021

Demographics data derived from AlphaMap

Campbell Henry **Chris Axley** **Hudson Dozier**
214.740.4468 214.740.3419 214.740.3367
chenry@lpc.com caxley@lpc.com hdozier@lpc.com

Lincoln



PRESTON PARK TOWERS

4965-4975 Preston Rd.
Plano, TX 75093

Leasing Information:
214.740.3300

Campbell Henry
214.740.4468
chenry@lpc.com

Chris Axley
214.740.3419
caxley@lpc.com

Hudson Dozier
214.740.3367
hdozier@lpc.com

Lincoln

Lincoln Property Company
8111 Douglas Avenue
Dallas, TX 75225

www.lpc.com