

978

KAISER ROAD
NAPA, CALIFORNIA

STANDALONE BUILDING AVAILABLE (DIVISIBLE)



FOR LEASE: $\pm 1,750$ - $\pm 9,800$ SF

Alex Peck
apeck@lee-associates.com
D 925.239.1414

Tanner Mandelaris
tmandelaris@lee-associates.com
D 925.239.1421

LEE & ASSOCIATES
COMMERCIAL REAL ESTATE SERVICES

All information furnished regarding property for sale, rental or financing is from sources deemed reliable, but no warranty or representation is made to the accuracy thereof and same is submitted to errors, omissions, change of price, rental or other conditions prior to sale, lease or financing or withdrawal without notice. No liability of any kind is to be imposed on the broker herein.

INDUSTRIAL SPACES AVAILABLE FOR LEASE

978 KAISER RD, NAPA, CA



PROPERTY HIGHLIGHTS

• Entire Building:

- $\pm 9,800$ RSF (140' x 70')
- Four (4) grade-level doors (12'W x 10'H)
- 20% Office / 80% Warehouse
- Office can be reconfigured or partially demo'd
- Power: 600A, 240V, 3-Phase (To Be Verified)
- 13' - 15' Clear Height
- Sprinkled
- Asking Rate: Please Call

• Unit A:

- $\pm 4,550$ RSF
- One (1) grade-level door (12'W x 10'H)
- 50% Office / 50% Warehouse
- Office can be reconfigured or partially demo'd
- Power: 200A, 240V, 3-Phase (To Be Verified)
- 13' - 15' Clear Height
- Sprinkled
- Asking Rate: \$1.65/SF Gross

• Unit C:

- $\pm 1,750$ RSF
- One (1) grade-level door (12'W x 10'H)
- 3 Private Offices, Restroom
- Power: 125A, 240V, 3-Phase (To Be Verified)
- 13' - 15' Clear Height
- Sprinkled
- Asking Rate: \$1.75/SF Gross

• Unit D:

- $\pm 1,750$ RSF
- One (1) grade-level door (12'W x 10'H)
- 1 Private Office, Restroom
- Power: 125A, 240V, 3-Phase (To Be Verified)
- 13' - 15' Clear Height
- Sprinkled
- Asking Rate: \$1.75/SF Gross

PRESENTED BY:

Alex Peck
apeck@lee-associates.com
D 925.239.1414

Tanner Mandelaris
tmandelaris@lee-associates.com
D 925.239.1421



INDUSTRIAL SPACES AVAILABLE FOR LEASE

978 KAISER RD, NAPA, CA

FLOOR PLAN:

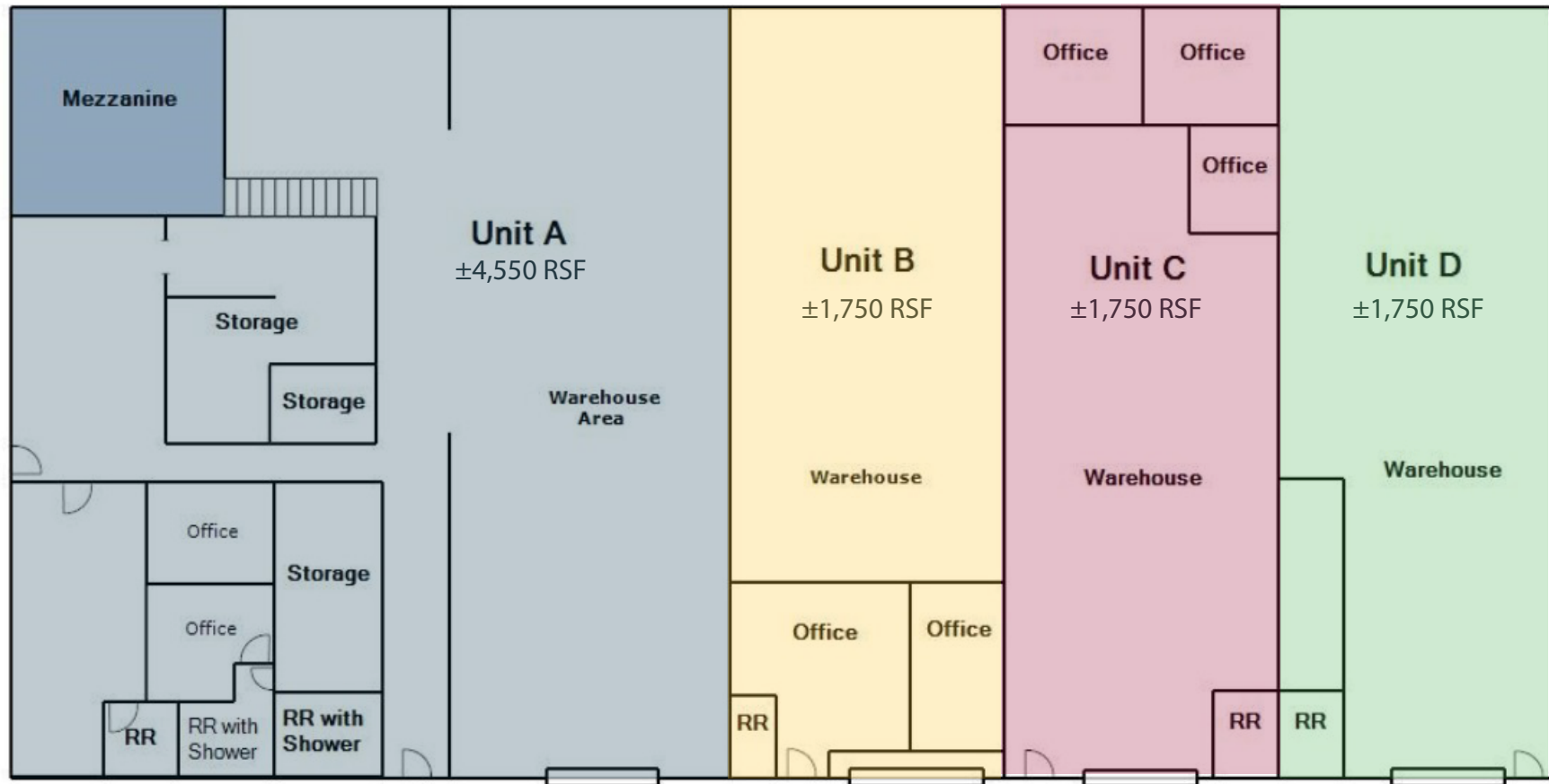

PRESENTED BY:

Alex Peck
apeck@lee-associates.com
D 925.239.1414

Tanner Mandelaris
tmandelaris@lee-associates.com
D 925.239.1421



INDUSTRIAL SPACES AVAILABLE FOR LEASE

978 KAISER RD, NAPA, CA

LOCATION OVERVIEW:

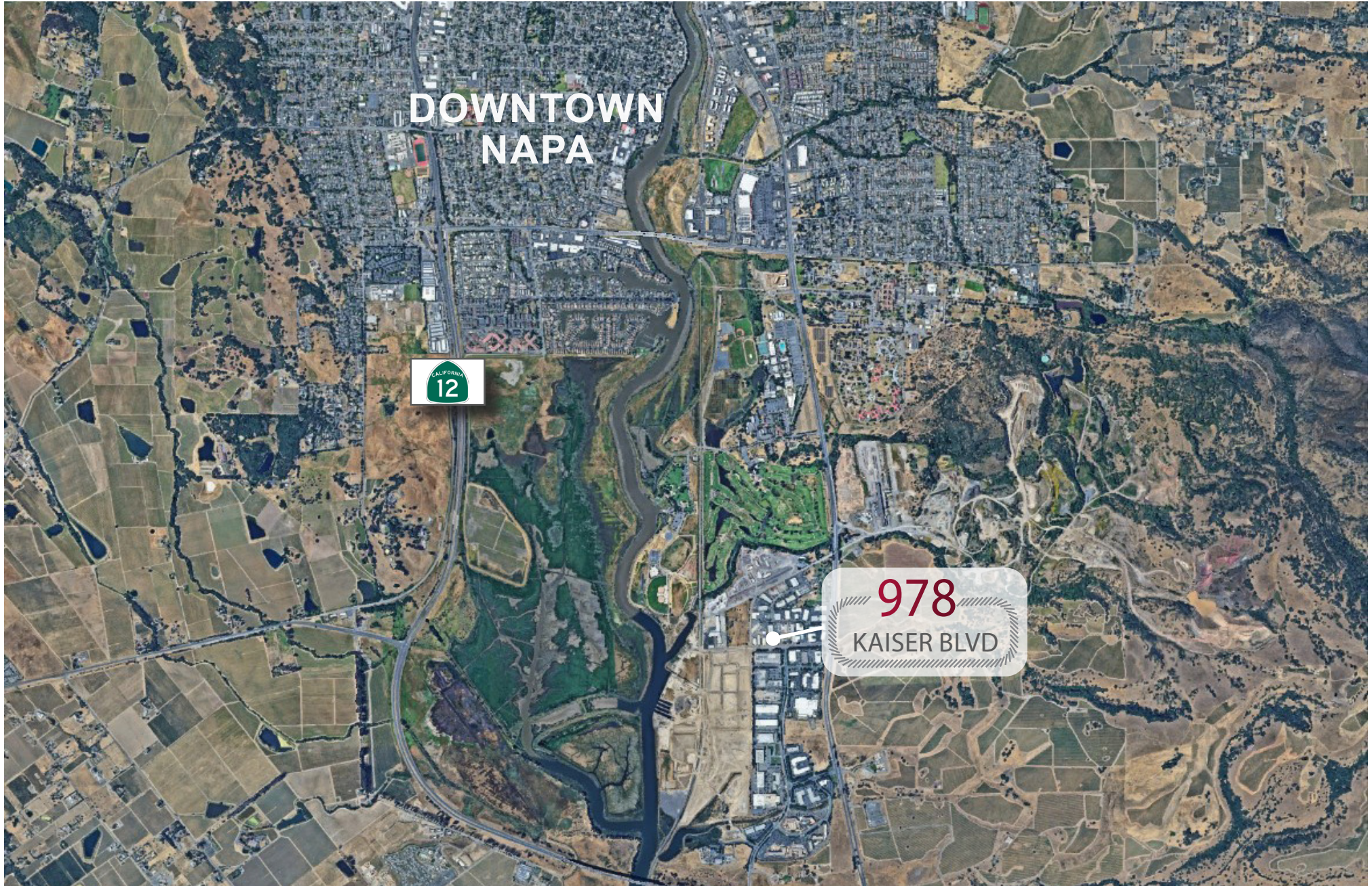

INDUSTRIAL SPACES AVAILABLE FOR LEASE

978 KAISER RD, NAPA, CA

NEARBY DEVELOPMENTS:



DEVELOPMENT

1. **Subject Project** - 978 Kaiser Rd, Napa
2. **Costco Napa** - 154,000 SF warehouse plus fuel open
3. **RiverSound Homes** - about 945 at buildout phases under construction
4. **RiverSound Hotel** - 150 rooms planned
5. **RiverSound Neighborhood Retail** - about 40,000 SF planned
6. **CMC Rebar steel supplier**

PRESENTED BY:

Alex Peck
apeck@lee-associates.com
D 925.239.1414

Tanner Mandelaris
tmandelaris@lee-associates.com
D 925.239.1421

