



1730 East Duval Street

Jacksonville, Florida 32202

Property Highlights

- Warehouse showroom space with 13' clear height
- Fresh exterior paint with two roll up doors
- Current layout includes showroom, 2 restrooms, and approximately 4,000 sf open space with high ceilings
- Located in the Stadium District next to TIAA Bank Field and Daily's Place Amphitheater
- Would be ideal for a fitness studio or other retail use
- Surrounding eateries include Social Ground Coffee, Toon Town Pizzeria, Touchdown Grill, and Russ Doe's Sandwich shop

Property Overview

Located near TIAA Bank Field and Daily's Place, this area keeps tenants close to the excitement of game days and live events. Nearby dining options include Social Ground Coffee, Toon Town Pizzeria, Touchdown Grill, and Russ Doe's Sandwich Shop. With quick access to the active Stadium District, the location is ideal for an industrial or flex user seeking to be at the center of Jacksonville's energy.

Offering Summary

Lease Rate:	Negotiable
Available SF:	4,840 SF
Lot Size:	0.9 Acres
Zoning:	CCDB
Ceiling Height:	13'
Warehouse Dimensions:	79'2" x 39'11"

For More Information



Camden Padgett

Senior Associate
O: 904 404 4460
cp@naihallmark.com



Chris Ware

Senior Associate
O: 904 512 7590 | C: 904 553 2677
cww@naihallmark.com



For Lease
4,840 SF | Negotiable
Warehouse Showroom







For Lease

4,840 SF | Negotiable
Warehouse Showroom

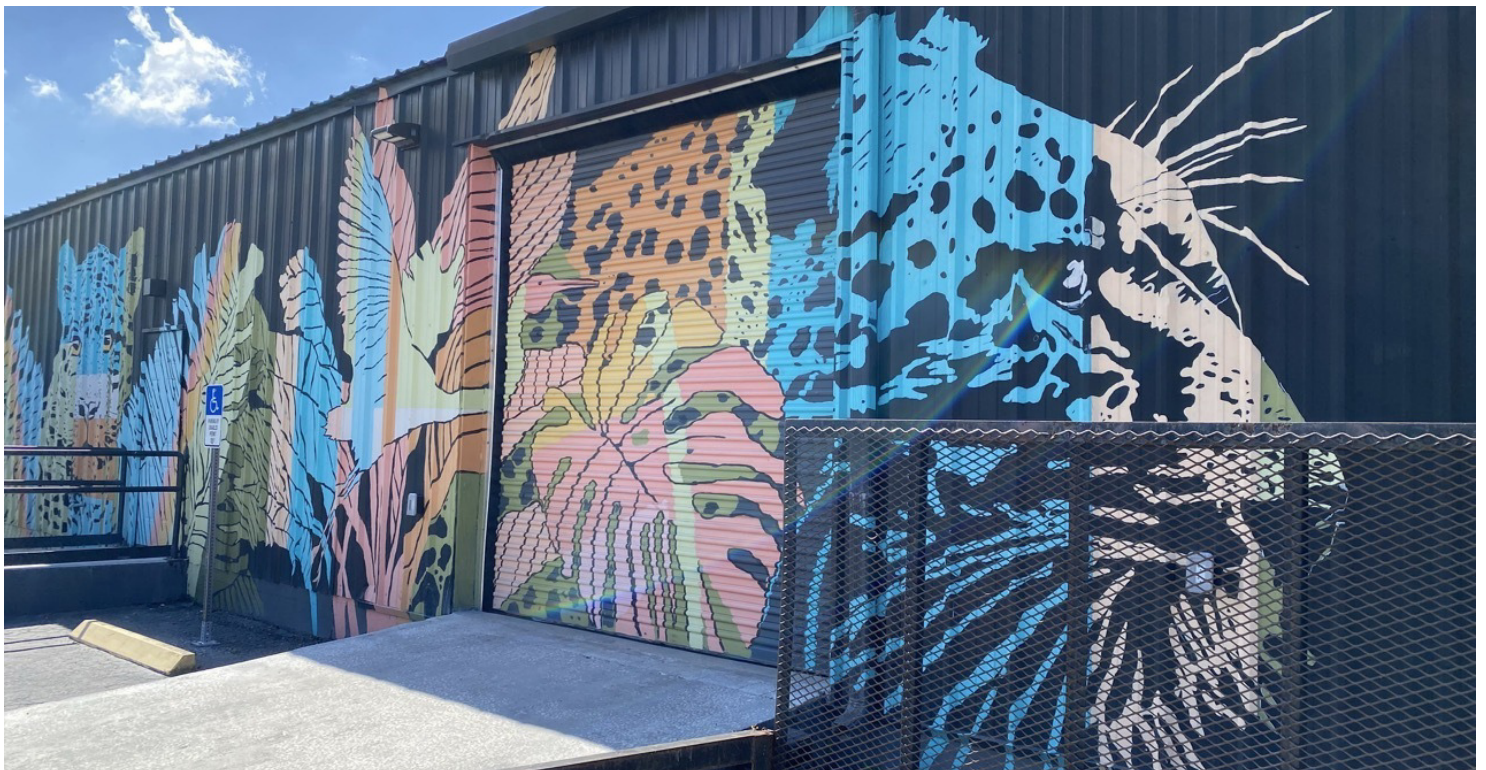



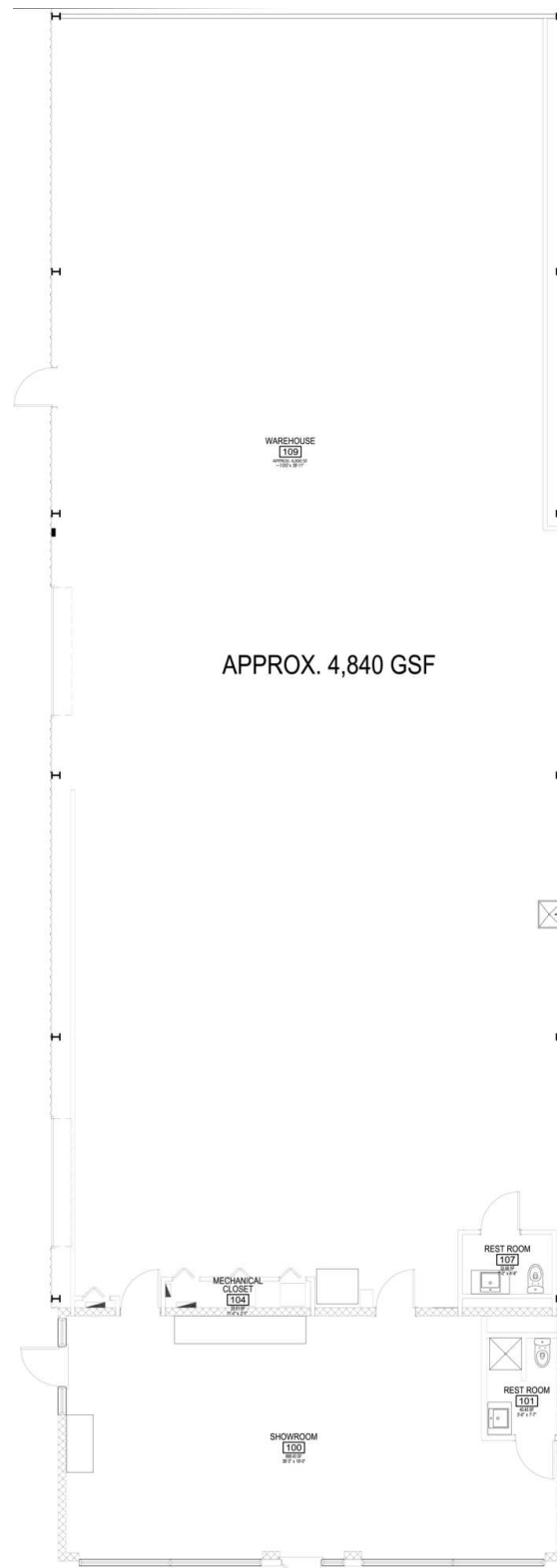

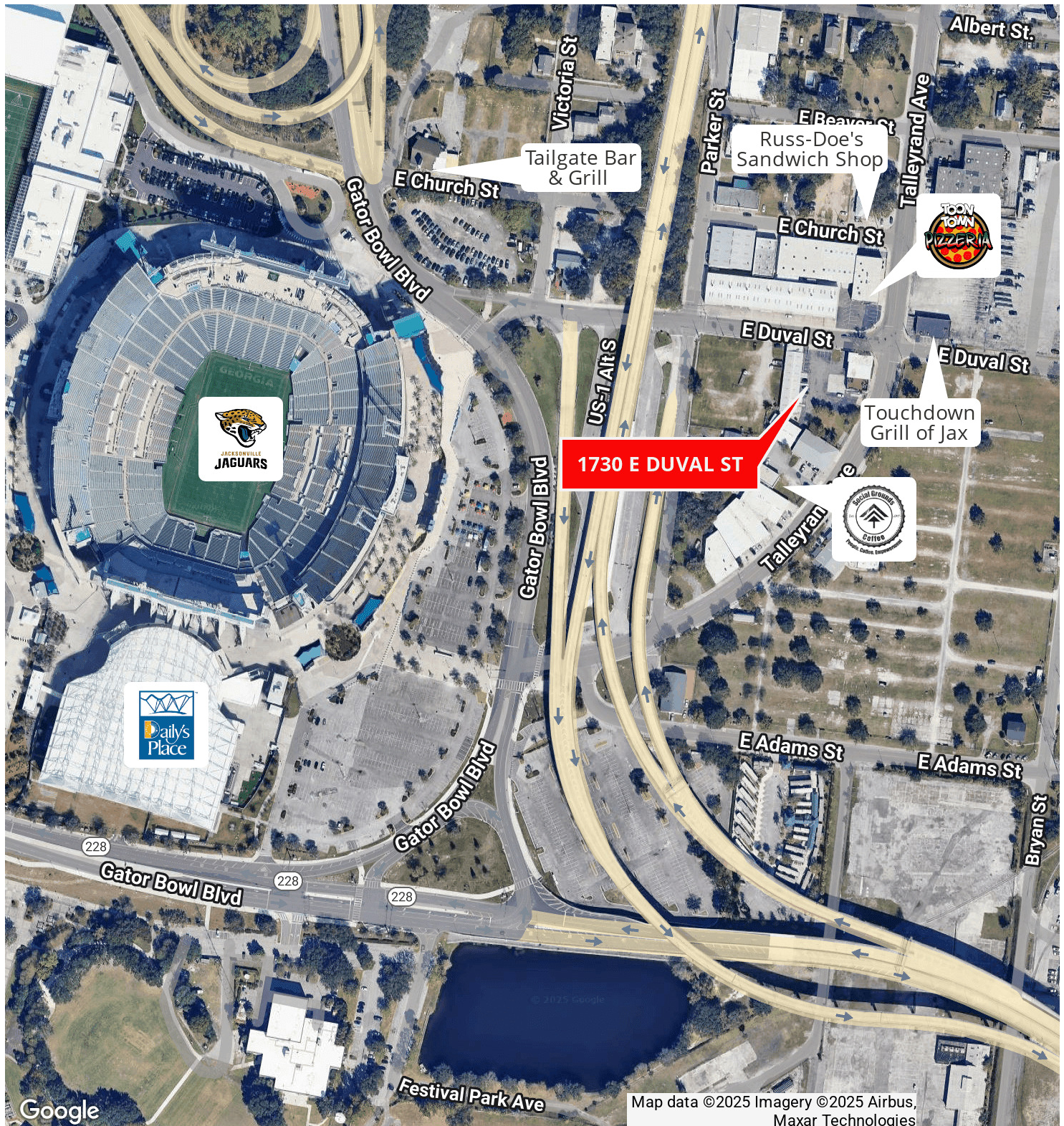

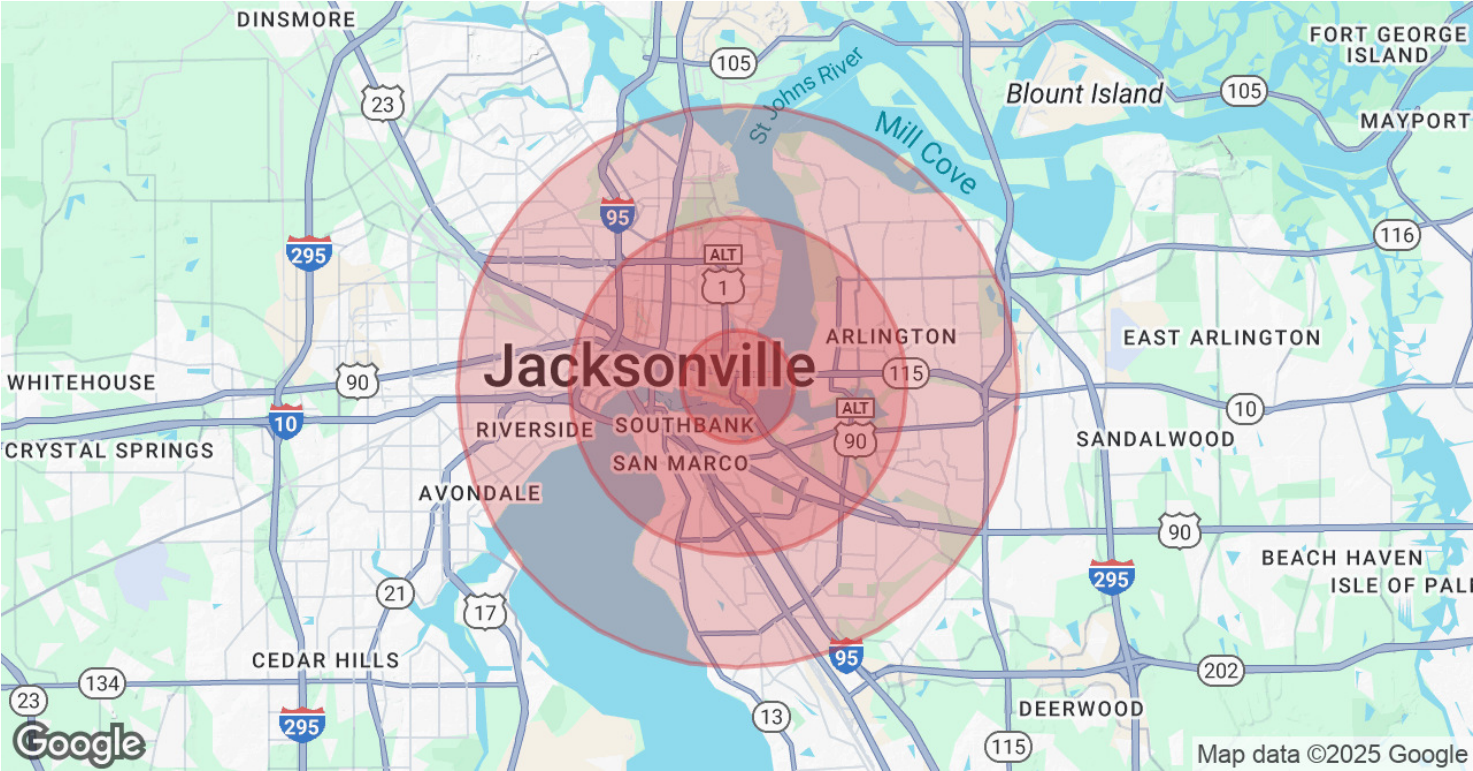

Population	1 Mile	3 Miles	5 Miles
Total Population	2,591	77,142	235,768
Average Age	38	40	40
Average Age (Male)	37	39	39
Average Age (Female)	41	42	41

Households & Income	1 Mile	3 Miles	5 Miles
Total Households	1,006	33,113	97,945
# of Persons per HH	2.6	2.3	2.4
Average HH Income	\$46,418	\$65,321	\$69,075
Average House Value	\$233,452	\$296,052	\$291,926

Demographics data derived from AlphaMap