

LAND OFFICE INDUSTRIAL RETAIL INVESTMENTS

Fully Renovated Automotive / Commercial Property For Sale

704 S. Monaco St. Pkwy., Denver, CO 80224



www.FullerRE.com



For Sale: \$1,279,000



PROPERTY INFORMATION

Building Size:	3,770± SF
Lot Size:	0.23 Acre (9,988± SF)
City/County:	Denver / Denver
YOC:	1966 (Renovated 2023)
Zoning:	S-MX-3A (Denver)
Parking Spaces:	9 Off-Street / 10 Indoors
Loading:	9 - 9'x9' Drive-In Doors
Taxes:	\$15,099.08 (2024)

PROPERTY NARRATIVE

Located just north of the S. Monaco St. Pkwy. and Leedsdale Drive intersection, this commercial building offers a new roof, dual combo HVAC units, and all new LED lighting. A newly resurfaced parking lot and improved drainage complement the new interior and exterior paint. On the inside, there is a fully rehabilitated office suite, two new bathrooms, a new kitchen, conference and meeting space, and two private offices. Floor drains are throughout the building, all leading to a recently jetted and serviced sand trap. New and owned security system. There is a large storage area with laundry facilities. Eleven vehicles are consistently and comfortably stored within the building, with 9 off-street parking spaces.

Fuller Real Estate
(303) 534-4822
www.FullerRE.com

**Brokerage Disclosure
to Buyer**

Brian Baker
(720) 287-5416 direct
(720) 280-4733 mobile
BBaker@FullerRE.com

Jason Russ
(720) 974-2794 direct
(609) 240-6549 mobile
JRuss@FullerRE.com

©2025 Fuller Real Estate. All Rights Reserved. Price, terms and availability subject to change without notice.



www.FullerRE.com

LAND OFFICE INDUSTRIAL RETAIL INVESTMENTS

5300 DTC Pkwy, #100 | Greenwood Village | CO | 80111 | FAX: 303-534-9021

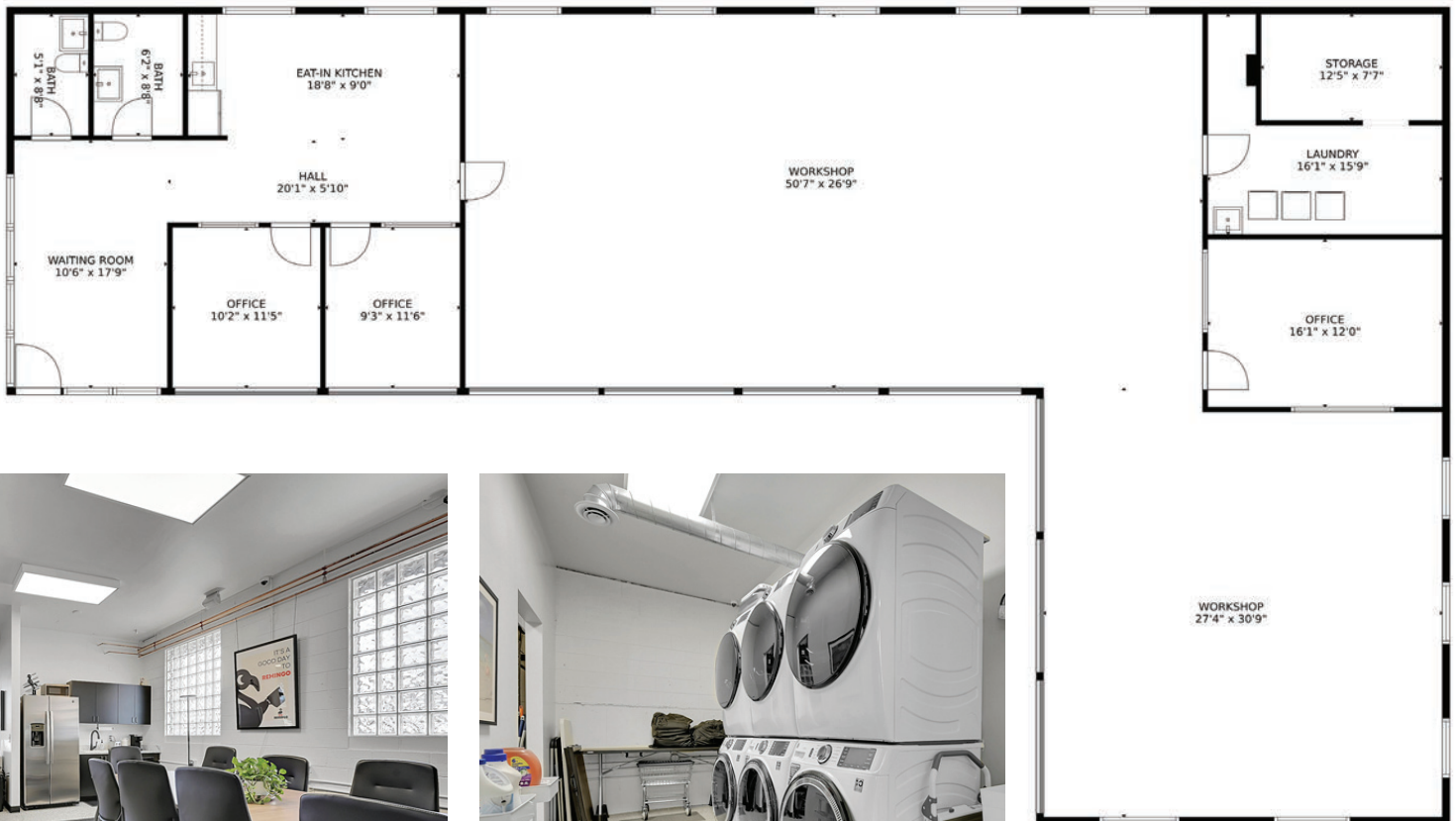
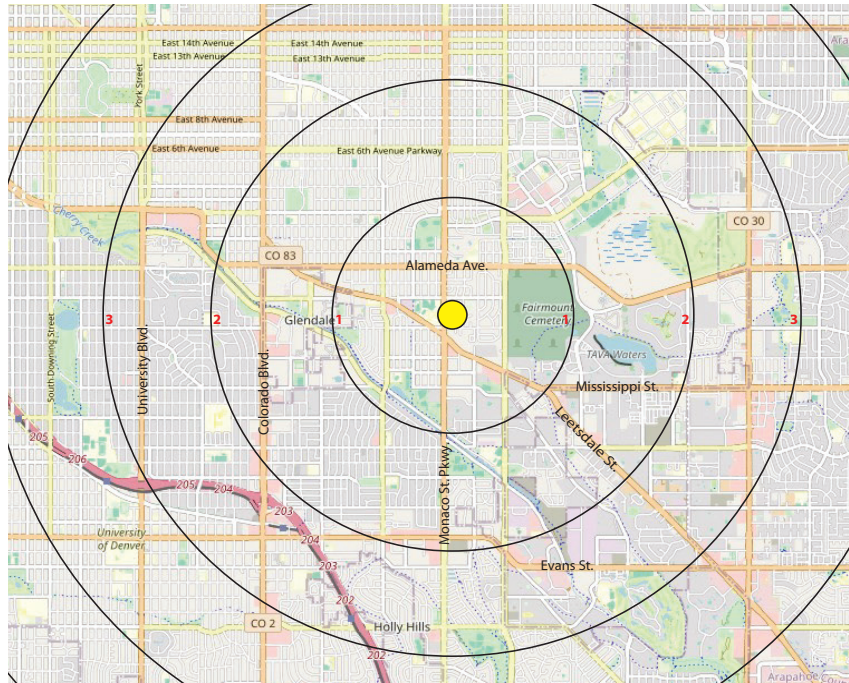

The information in this brochure was provided to Fuller Real Estate (FRE) by the owner of the property. FRE has not independently verified this information. Buyers have been advised by FRE to investigate the property including, without limitation, the physical condition of the property, access, availability of utility services, zoning, environmental risks, and soil conditions.