



FOR LEASE

11,256 SF Walgreens Space

1750 Noriega St | San Francisco, CA 94122





# Walgreens Space

1750 Noriega St | San Francisco, CA 94122



11,256 SF

Building

8/31/26

Lease End Date

\$22 PSF MG

Asking

## ABOUT THE PROPERTY

All offers are subject to approval by Walgreens Real Estate Committee.

- Corner location on Noriega St, one of the main streets in the Sunset Neighborhood.
- Noriega St is home to well known retailers Safeway, Citi Bank, Chase Bank and numerous local restaurants and cafes.
- Located 5 short blocks away from the heavy car traffic of 19th Ave, the main North South approach to the Golden Gate Bridge.

## NEARBY RETAILERS



## TRAFFIC COUNTS

Divisadero St  
O'Farrel St

Year: 2023 | Placer Labs, Inc.

67,521 VPD  
2,868 VPD



# Walgreens Space

1750 Noriega St | San Francisco, CA 94122

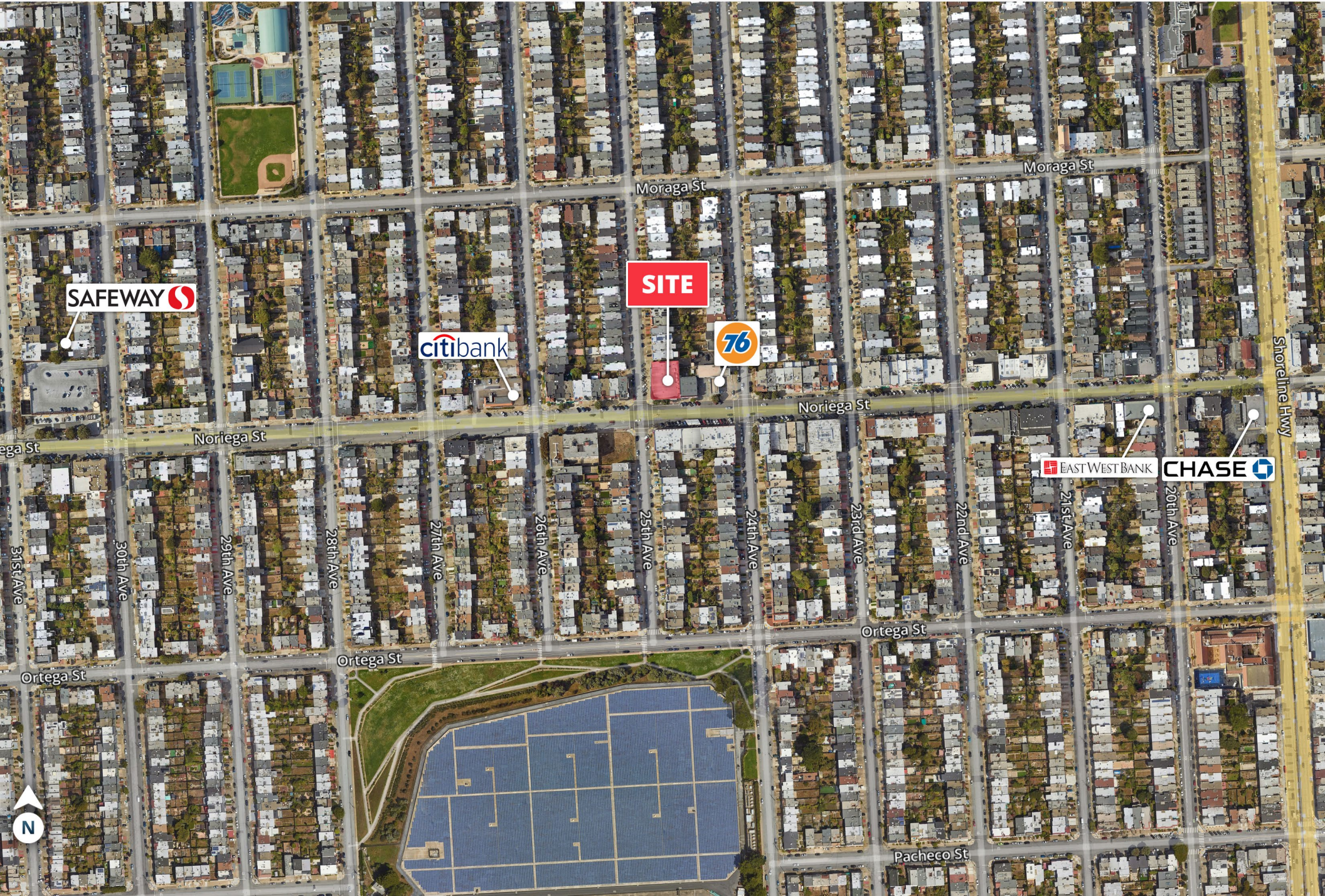



# Walgreens Space

1750 Noriega St | San Francisco, CA 94122

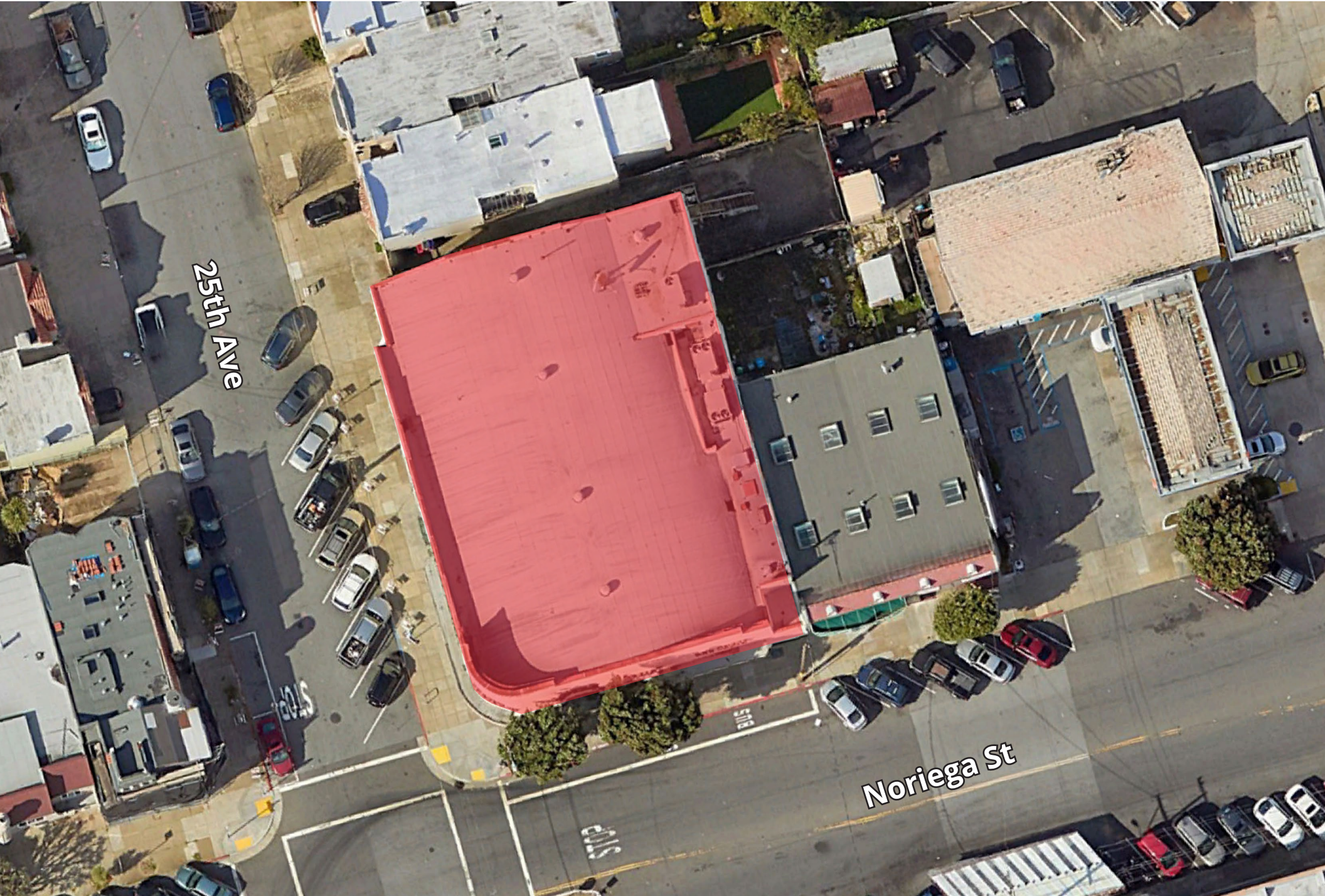



## DEMOGRAPHIC HIGHLIGHTS

Population	1 Mile	3 Miles	5 Miles
2024 Estimated Population	54,216	318,344	812,086
2029 Projected Population	54,502	320,156	822,996
Projected Annual Growth 2024 to 2029	0.11%	0.11%	0.27%
<b>2024 Daytime Population</b>			
Daytime Population	35,841	272,224	792,825
Workers	14,033	157,359	500,267
Residents	21,808	114,865	292,558
<b>2024 Income</b>			
Average Household Income	\$199,788	\$215,818	\$195,991
Median Household Income	\$150,081	\$160,976	\$138,315
<b>Households &amp; Growth</b>			
2024 Estimated Households	20,733	133,318	346,277
2029 Projected Households	20,754	133,935	350,482
Projected Annual Growth 2024 to 2029	0.02%	0.09%	0.22%
<b>2024 Race &amp; Ethnicity</b>			
White	32.84%	44.06%	37.93%
Black or African American	1.27%	2.95%	4.28%
Asian or Pacific Islander	53.81%	37.38%	36.76%
Other Race	3.04%	4.39%	9.40%
Two or More Races	8.67%	10.65%	10.45%
Hispanic	7.83%	10.80%	17.49%

> **Want more?** Contact us for a complete demographic, foot-traffic, and mobile data insights report.

SOURCE 

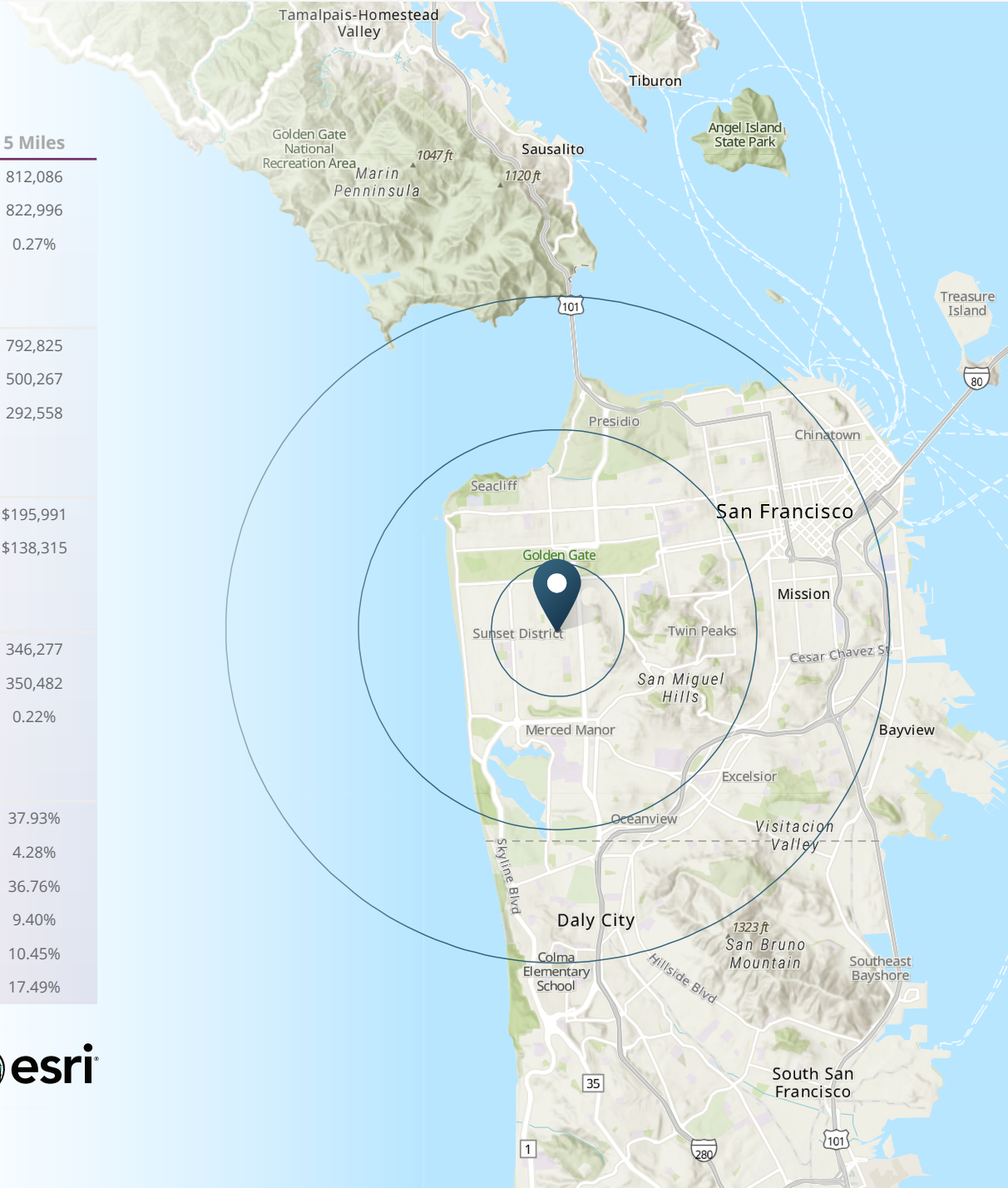





**SRS Real Estate Partners**  
150 California Street, 14th Fl  
San Francisco, CA 94111  
415.908.4930

**Matthew D. Alexander**  
**EVP & Principal**  
415.908.4938  
matt.alexander@srsre.com  
CA License No. 00883993

**Sarah D. Edwards**  
**First Vice President**  
408.216.2322  
sarah.edwards@srsre.com  
CA License No. 01297272

**SRSRE.COM**

© SRS Real Estate Partners

The information presented was obtained from sources deemed reliable;  
however SRS Real Estate Partners does not guarantee its completeness or accuracy.