

FOR SALE -TURNKEY EDUCATION, MEDICAL, OR CARE FACILITY

5225 NORTH 158TH AVENUE, OMAHA, NE 68116

FORMER CHILD CARE FACILITY | 9,622 SF | SALE PRICE - \$2,750,000; LEASE RATE - \$21.00 PSF (NNN)



Empowered Brokers. Exceptional Results.

PRESENTED BY:

Grace Newton

402.980.0111

gnewton@lee-associates.com

Benjamin Pearson

402.740.6791

bpearson@lee-associates.com

Omaha: 12020 Shamrock Plaza, Suite 333 | Omaha, NE 68154 | 531.721.2888

Lincoln: 200 South 21st Street, Suite A113 | Lincoln, NE 68510 | 531.721.2888



FOR SALE/LEASE

5225 NORTH 158TH AVENUE, OMAHA, NE 68116

Turnkey Education, Medical, or Care Facility | 9,622 SF



360° VIRTUAL TOUR

PROPERTY DESCRIPTION

9,622 SF single-story institutional facility offering a strong owner-user opportunity in the growing Bennington submarket. Originally built and operated as a licensed childcare facility, the building features multiple private rooms, extensive restroom and plumbing infrastructure, a large indoor assembly area, and a fully built-out commercial kitchen. Safety features include a full fire sprinkler system and storm shelter, providing meaningful cost savings for future users. MU zoning allows flexibility for education, medical, care, or professional office uses.

PROPERTY HIGHLIGHTS

- Fire sprinkler system and storm shelter
- Commercial kitchen with hood and built-in appliances
- Large indoor assembly / gym area
- Extensive restroom and plumbing infrastructure throughout
- Formerly licensed childcare facility with outdoor playground

CONTACT

Grace Newton

gnewton@lee-associates.com
C 402.980.0111

Benjamin Pearson

bpearson@lee-associates.com
C 402.740.6791

LOCATION DESCRIPTION

Located at 158th Street and Fort Street in the rapidly growing Bennington area, surrounded by strong residential growth and established neighborhoods. The area benefits from high household incomes, nearby schools, and convenient access to major east-west corridors, supporting long-term owner-user demand.

OFFERING SUMMARY

Building & Lot Size:

9,622 SF Building (Built in 2006)
1.31 Acres of Land

Sale Price:

\$2,750,000

Zoning:

MU (Allows a range of uses)

Lease Rate (Secondary Option):

\$21.00 PSF/yr (NNN)
Estimated NNN = \$6.00 PSF

We obtained the information above from sources we believe to be reliable. However, we have not verified its accuracy and make no guarantee, warranty or representation about it. It is submitted subject to the possibility of errors, omissions, change of price, rental or other conditions, prior sale, lease or financing, or withdrawal without notice. We include projections, opinions, assumptions or estimates for example only, and they may not represent current or future performance of the property. You and your tax and legal advisors should conduct your own investigation of the property and transaction. Images are for illustrative purposes only and may include computer-generated renderings, virtual staging, or digital enhancements. Actual conditions, features, and finishes may vary and are subject to change without notice.

5225 NORTH 158TH AVENUE, OMAHA, NE 68116

Turnkey Education, Medical, or Care Facility | 9,622 SF

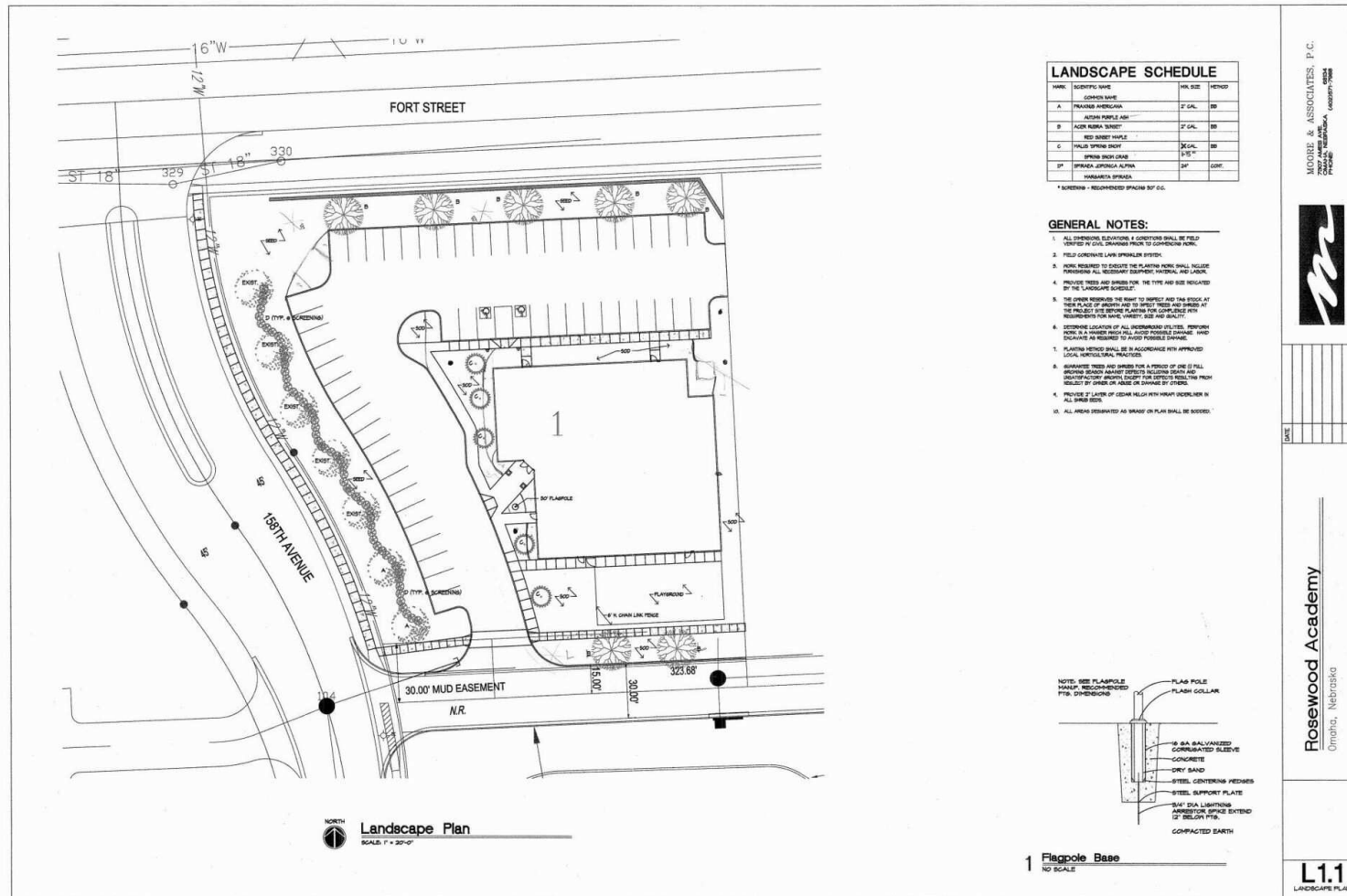

CONTACT

Grace Newton

gnewton@lee-associates.com
C 402.980.0111

Benjamin Pearson

bpearson@lee-associates.com
C 402.740.6791

We obtained the information above from sources we believe to be reliable. However, we have not verified its accuracy and make no guarantee, warranty or representation about it. It is submitted subject to the possibility of errors, omissions, change of price, rental or other conditions, prior sale, lease or financing, or withdrawal without notice. We include projections, opinions, assumptions or estimates for example only, and they may not represent current or future performance of the property. You and your tax and legal advisors should conduct your own investigation of the property and transaction. Images are for illustrative purposes only and may include computer-generated renderings, virtual staging, or digital enhancements. Actual conditions, features, and finishes may vary and are subject to change without notice.

Omaha: 12020 Shamrock Plaza, Suite 333 | Omaha, NE 68154 | 531.721.2888

Lincoln: 200 South 21st Street, Suite A113 | Lincoln, NE 68510 | 531.721.2888



FOR SALE/LEASE

5225 NORTH 158TH AVENUE, OMAHA, NE 68116

Turnkey Education, Medical, or Care Facility | 9,622 SF



SIZES AND DIMENSIONS ARE APPROXIMATE, ACTUAL MAY VARY.

CONTACT

Grace Newton

gnewton@lee-associates.com
C 402.980.0111

Benjamin Pearson

bpearson@lee-associates.com
C 402.740.6791

We obtained the information above from sources we believe to be reliable. However, we have not verified its accuracy and make no guarantee, warranty or representation about it. It is submitted subject to the possibility of errors, omissions, change of price, rental or other conditions, prior sale, lease or financing, or withdrawal without notice. We include projections, opinions, assumptions or estimates for example only, and they may not represent current or future performance of the property. You and your tax and legal advisors should conduct your own investigation of the property and transaction. Images are for illustrative purposes only and may include computer-generated renderings, virtual staging, or digital enhancements. Actual conditions, features, and finishes may vary and are subject to change without notice.

FOR SALE/LEASE

5225 NORTH 158TH AVENUE, OMAHA, NE 68116

Turnkey Education, Medical, or Care Facility | 9,622 SF



CONTACT

Grace Newton

gnewton@lee-associates.com
C 402.980.0111

Benjamin Pearson

bpearson@lee-associates.com
C 402.740.6791

We obtained the information above from sources we believe to be reliable. However, we have not verified its accuracy and make no guarantee, warranty or representation about it. It is submitted subject to the possibility of errors, omissions, change of price, rental or other conditions, prior sale, lease or financing, or withdrawal without notice. We include projections, opinions, assumptions or estimates for example only, and they may not represent current or future performance of the property. You and your tax and legal advisors should conduct your own investigation of the property and transaction. Images are for illustrative purposes only and may include computer-generated renderings, virtual staging, or digital enhancements. Actual conditions, features, and finishes may vary and are subject to change without notice.

FOR SALE & LEASE

5225 NORTH 158TH AVENUE, OMAHA, NE 68116

Turnkey Education, Medical, or Care Facility | 9,622 SF

POPULATION	1 MILE	3 MILES	5 MILES
Total Population	13,149	79,714	174,636
Average Age	39	37	38
Average Age (Male)	38	37	37
Average Age (Female)	40	38	39

HOUSEHOLDS & INCOME	1 MILE	3 MILES	5 MILES
Total Households	5,057	29,195	68,442
# of Persons per HH	2.6	2.7	2.6
Average HH Income	\$133,576	\$143,442	\$130,680
Average House Value	\$346,327	\$382,859	\$365,706

Demographics data derived from AlphaMap

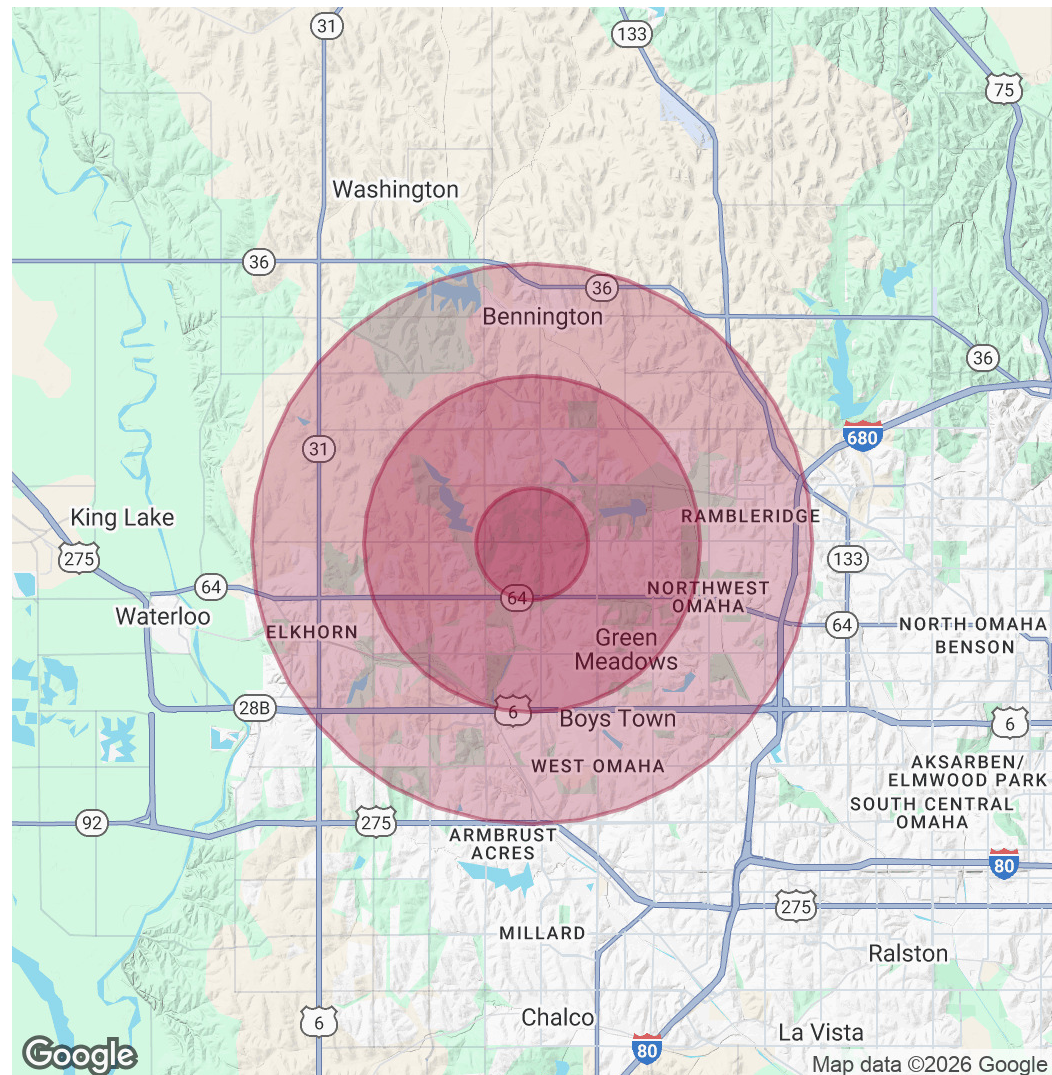

CONTACT

Grace Newton

gnewton@lee-associates.com
C 402.980.0111

Benjamin Pearson

bpearson@lee-associates.com
C 402.740.6791

We obtained the information above from sources we believe to be reliable. However, we have not verified its accuracy and make no guarantee, warranty or representation about it. It is submitted subject to the possibility of errors, omissions, change of price, rental or other conditions, prior sale, lease or financing, or withdrawal without notice. We include projections, opinions, assumptions or estimates for example only, and they may not represent current or future performance of the property. You and your tax and legal advisors should conduct your own investigation of the property and transaction. Images are for illustrative purposes only and may include computer-generated renderings, virtual staging, or digital enhancements. Actual conditions, features, and finishes may vary and are subject to change without notice.